

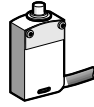

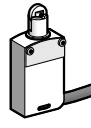
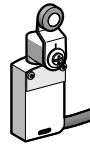
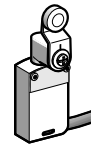
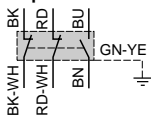

Type of head	Plunger (fixing by the body)		Rotary (fixing by the body)	
				
Type of operator	Metal end plunger	Roller plunger	Thermoplastic roller lever	Steel roller lever
<b>References</b>				
<b>3-pole N/C + N/C + N/O snap-action</b>	<b>XCS-M3910L1</b> 	<b>XCS-M3902L1</b> 	<b>XCS-M3915L1</b> 	<b>XCS-M3916L1</b> 
<b>3-pole N/C + N/C + N/O break before make, slow break</b>	<b>XCS-M3710L1</b> 	<b>XCS-M3702L1</b> 	<b>XCS-M3715L1</b> 	<b>XCS-M3716L1</b> 
<b>4-pole N/C + N/C + N/O + N/O snap-action</b>	<b>XCS-M4110L1</b> 	<b>XCS-M4102L1</b> 	<b>XCS-M4115L1</b> 	<b>XCS-M4116L1</b> 
Weight (kg)	0.165	0.170	0.205	0.210
Contact operation			(A) = cam displacement (P) = positive opening point ⊕ N/C contact with positive opening operation	
<b>Characteristics</b>				
Switch actuation	On end	By 30° cam		
Type of actuation				
Maximum actuation speed	0.5 m/s	0.1 m/s	1.5 m/s	
Mechanical durability	10 million operating cycles			
Minimum force or torque	for tripping	7.5 N	5 N	0.05 N.m
	for positive opening	37.5 N	25 N	0.15 N.m
Cabling	3-pole contacts	Pre-cabled, PUR, 7 x 0.5 mm <sup>2</sup> , length 1 m (1).		
	4-pole contacts	Pre-cabled, PUR, 9 x 0.34 mm <sup>2</sup> , length 1 m (1).		

(1) For a 2 m long cable, replace L1 by L2.  
For a 5 m long cable, replace L1 by L5.

#### Dimensions

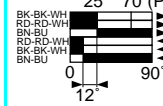
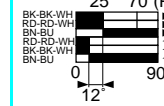
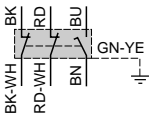
##### XCS-M●●10L1

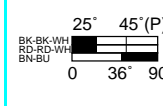
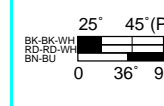
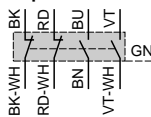
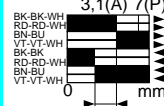
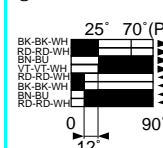
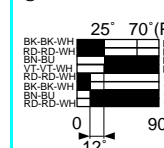
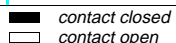
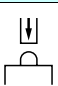
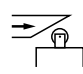
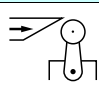
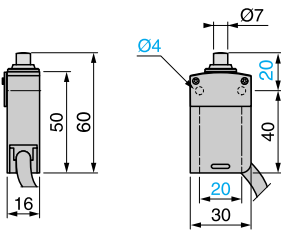

##### XCS-M●●02L1

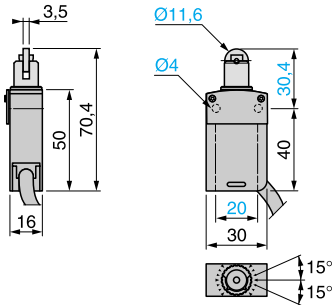

##### XCS-M●●15L1

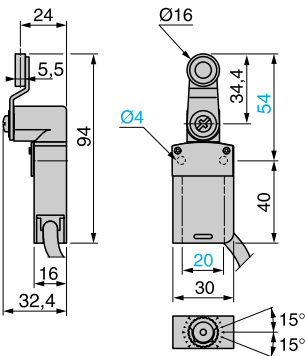

##### XCS-M●●16L1

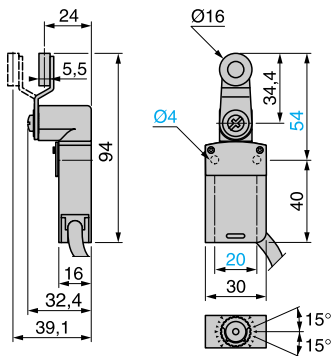

#### Schemes

##### Wiring to category 1 conforming to EN 954-1

Example with 3-pole N/C + N/C + N/O contact and protection fuse to prevent shunting of the N/C contacts, either by cable damage or by tampering.

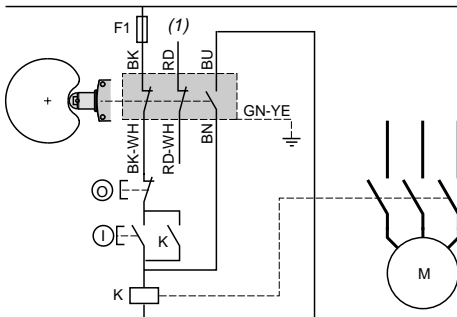

##### Wiring to category 3 conforming to EN 954-1

Example with 3-pole N/C + N/C + N/O contact with mixed redundancy of the contacts and the associated control relays.

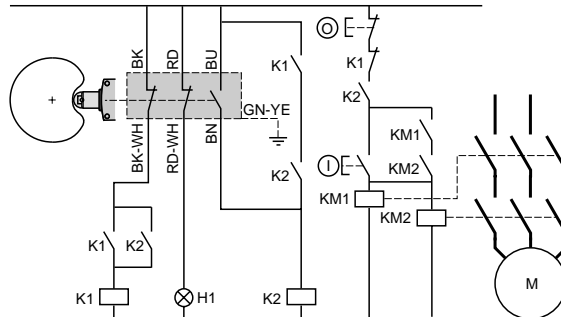

(1) Signalling contact.

H1: "limit switch not actuated" indicator.

##### Example for guard monitoring using 2 switches and 1 safety module (category 4)

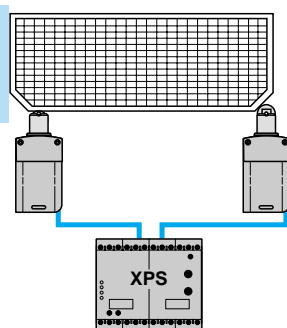

Operation in positive and negative (combined) mode