

Type: **P1-32/V/SVB**
 Article No.: **095676**



Ordering information

| | | | |
|--|----------------------|-----|--|
| Design | | | Rear mounting |
| Description | | | Without auxiliary contacts |
| Main conducting paths No. of poles | | M | 3 |
| Auxiliary contacts | | N/O | 0 |
| Auxiliary contacts | | B | 0 |
| Max. three-phase motor rating (per set of 3 contacts) 50–60 Hz AC–3 400/415 V 50–60 Hz | <i>P</i> | kW | 15 |
| Rated uninterrupted current | <i>I_u</i> | A | 32 |
| Note for table header | | | According to IEC/EN 60204–1, VDE 0113 Part 1; with red rotary handle and yellow locking collar, lockable in 0 position |

Contact sequence

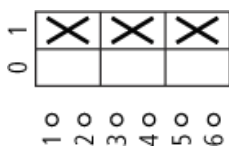

General

| | | | |
|-----------|--|--|--|
| Standards | | | IEC/EN 60 947, VDE 0660, IEC/EN 60 204, CSA,UL |
|-----------|--|--|--|

| | | | |
|--|--------------|---------------|--|
| | | | Switch–disconnectors to IEC/EN 60 947–3 NEMA3R, NEMA12 |
| Lifespan, mechanical | Operations | $\times 10^6$ | 0,3 |
| Maximum operating frequency | Operations/h | | 50 |
| Climatic proofing | | | Damp heat, constant, to IEC 60068–2–78; Damp heat, cyclical, to IEC 60068–2–30 |
| Ambient temperature | | | |
| Open | | °C | --25/50 |
| Enclosed | | °C | --25/40 |
| Mounting position | | | As required |
| Documentation | | | Main catalogue HPL |
| Mechanical shock resistance (shock duration 20 ms) | | g | > 15 |

Contacts

| | | | |
|--|-----------|--------------|-------|
| Rated operational voltage | U_e | V AC | 690 |
| Rated impulse withstand voltage | U_{imp} | V AC | 6000 |
| Overvoltage category/pollution degree | | | III/3 |
| Rated uninterrupted current | | | |
| open | I_u | A | 25 |
| Enclosed | I_u | A | 25 |
| Load–carrying capacity in intermittent operation, Class 12 | | | |
| AB 25 % DF | | $\times I_e$ | 2 |
| AB 40 % DF | | $\times I_e$ | 1,6 |
| AB 60 % DF | | $\times I_e$ | 1,3 |
| Short–circuit rating | | | |
| Fuse | | A gG/gL | 25 |
| Rated short–time withstand current (1 s current) | I_{cw} | A_{rms} | 640 |
| Switching angles | | ° | 90 |
| Current heat loss per contact at I_e | | W | 1,1 |

Terminal capacities

| | | | |
|------------------------------------|--|-----------------|--------------------------------|
| Solid or stranded | | mm ² | 1 × (1.5 – 6) 2 × (1.5 – 6) |
| Flexible with ferrule to DIN 46228 | | mm ² | 1 × (1 – 4) 2 × (1 – 4) |
| Terminal screw | | | M4 |
| Tightening torque | | Nm | 1.6 |

| Switching capacity | | | |
|---|-------|----------|-----|
| AC | | | |
| Rated making capacity $\cos \phi = 0.35$ | | A | 240 |
| Rated breaking capacity, motor load switch $\cos \phi = 0.35$ | | | |
| 230 V | | A | 190 |
| 400 V | | A | 150 |
| 500 V | | A | 170 |
| 690 V | | A | 150 |
| Rated operational current 440 V load-break switch AC-21A | I_e | A | 25 |
| AC-3 motor load switch motor rating | | | |
| 230 V | P | kW | 5,5 |
| 400 V | P | kW | 7,5 |
| 500 V | P | kW | 7,5 |
| 690 V | P | kW | 7,5 |
| AC-23A Motor load switches (main switches maintenance switches) | | | |
| 230 V | P | kW | 7 |
| 400 V | P | kW | 13 |
| 500 V | P | kW | 11 |
| 690 V | P | kW | 11 |
| DC | | | |
| DC-1, Load-break switches L/R = 1 ms | | | |
| Rated operational current | I_e | A | 25 |
| Voltage per contact pair in series | | V | 60 |
| DC-23A, Motor load switches L/R = 15 ms | | | |
| 24 V | | | |
| Rated operational current | I_e | A | 25 |
| Contacts | | Quantity | 1 |
| 48 V | | | |
| Rated operational current | I_e | A | 25 |
| Contacts | | Quantity | 2 |
| 60 V | | | |
| Rated operational current | I_e | A | 25 |
| Contacts | | Quantity | 3 |

| | | | |
|---------------------------|-------|----------|--|
| 120 V | | | |
| Rated operational current | I_e | A | 12 |
| Contacts | | Quantity | 3 |
| Notes | | | |
| | | | <p>Main switch characteristics to IEC/EN 60204; positive opening of contacts, operator element positively located on shaft</p> <p>The rated uninterrupted current I_U is stated at max. connected cross-section.</p> <p>For terminal capacity solid, stranded and flexible: Max. 2 cross-section sizes difference admissible when using 2 conductors.</p> |
| Dimensions | | | |
| | | | Shaft can be extended using ZVV-... + ZAV-..., max. F 4 × 25 = 100 mm |
| | | | Diameter of drilled hole Bottom |
| | | | Diameter of drilled hole Door |
| | | | 3 Padlocks |
| Explanation | | | <p>For utilisation category AC-4 (extreme load: 100 % inching, reversing or plugging)</p> <p>The blocked rotor current of the motor should not exceed the rated current of the switch for AC-21A to ensure a reasonable device lifespan.</p> |

Dimensions

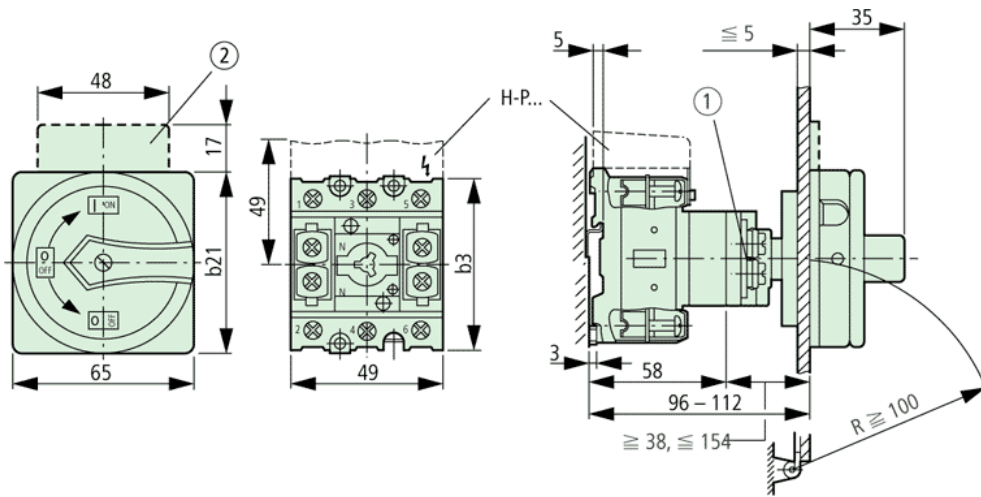

Dimensions

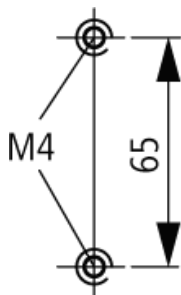

Dimensions

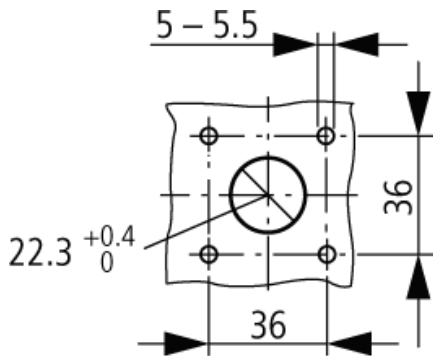

Dimensions

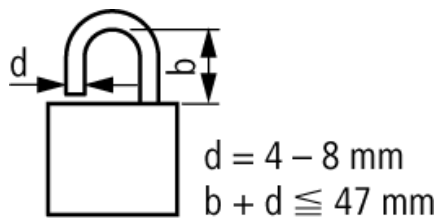

Characteristic curve

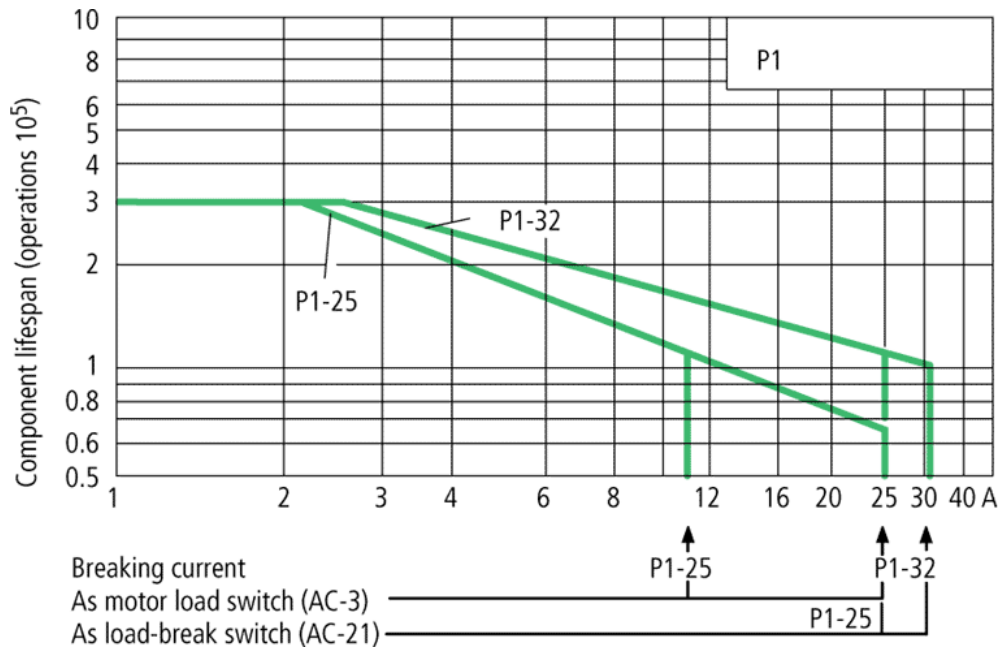

Moeller GmbH, Hein-Moeller-Str. 7-11, D-53115 Bonn
 E-Mail: catalog@moeller.net, Internet: www.moeller.net, <http://catalog.moeller.net>
 Copyright 2006 by Moeller GmbH. Subject to modifications. HPL-C2006GB-INT V2.3