

ALL RIGHTS RESERVED. NO PORTION OF THIS PUBLICATION, WHETHER IN WHOLE OR IN PART CAN BE REPRODUCED WITHOUT THE EXPRESS WRITTEN CONSENT OF SPC TECHNOLOGY.

REVISIONS			DOC. NO. SPC-F004 * Effective: 12/21/98 * DCP No: 680					
DCP #	REV	DESCRIPTION	DRAWN	DATE	CHECKD	DATE	APPRVD	DATE
149	A	RELEASED	J.W.M.	11/18/99	J.C.	1/10/00	DJC	4/5/00

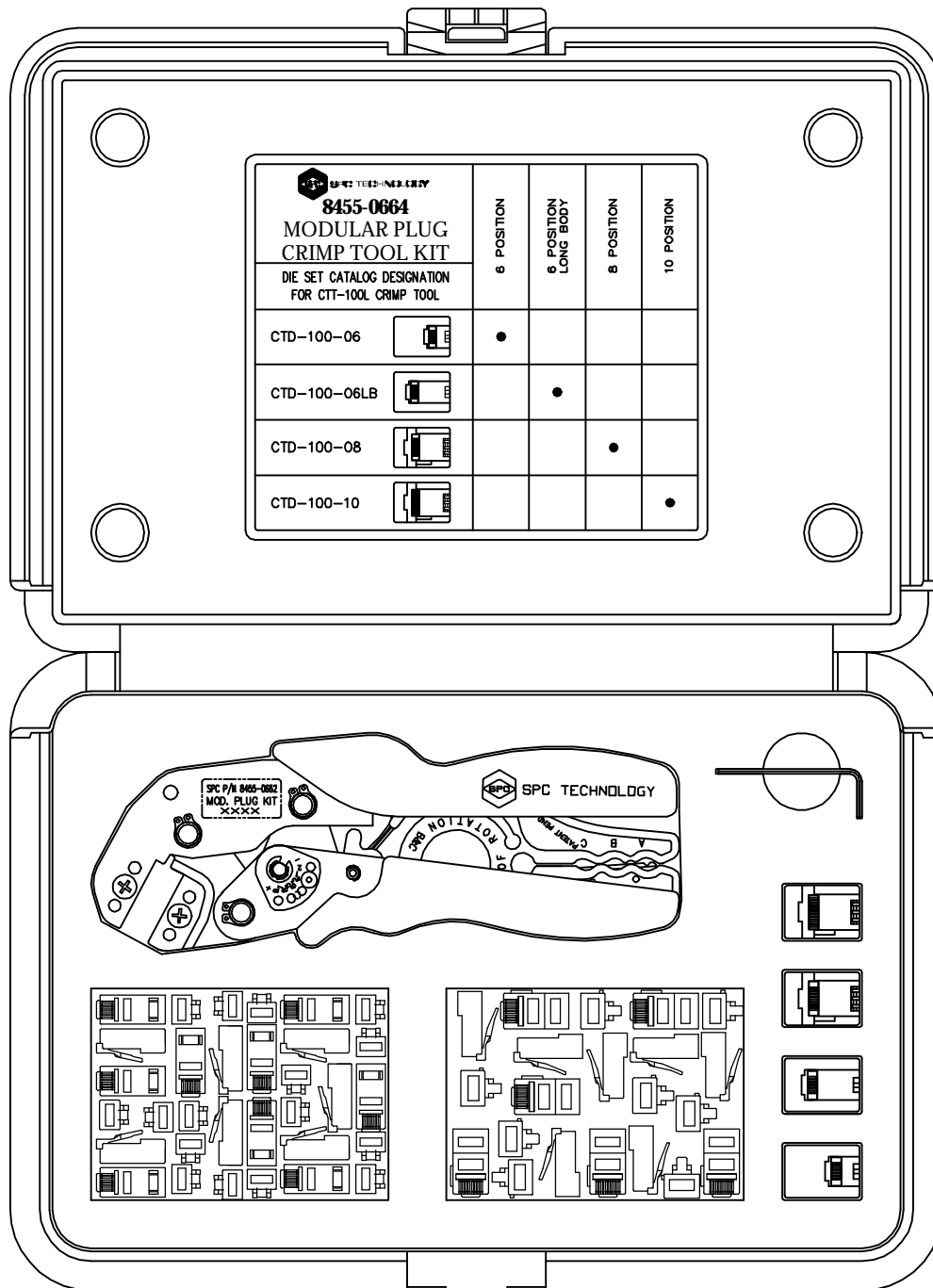

NOTES:

1. HEAT TREATED FRAME COMPONENTS.
2. BLACK OXIDE FINISH ON FRAME
3. FULL CYCLE RATCHET CONTROLLED RELEASE
4. RATCHET SET TO RELEASE WHEN A 20-35 LB.
5. LOAD IS APPLIED APPROX. 1 3/4" FROM END OF HANDLES.
6. YELLOW MOLDED TEXTURED EURO-STYLE GRIPS

SPC-F004.DWG

**DISCLAIMER:**  
ALL STATEMENTS AND TECHNICAL INFORMATION CONTAINED HEREIN ARE BASED UPON INFORMATION AND/OR TESTS WE BELIEVE TO BE ACCURATE AND RELIABLE. SINCE CONDITIONS OF USE ARE BEYOND OUR CONTROL, THE USER SHALL DETERMINE THE SUITABILITY OF THE PRODUCT FOR THE INTENDED USE AND ASSUME ALL RISK AND LIABILITY WHATSOEVER IN CONNECTION THEREWITH.



**SPC TECHNOLOGY**

UNLESS OTHERWISE SPECIFIED, DIMENSIONS ARE FOR REFERENCE PURPOSES ONLY.	DRAWN BY:	DATE:	DRAWING TITLE:					
	Jeff McVicker	11/18/99	Modular Plug Crimp Tool Kit					
	CHECKED BY:	DATE:	SIZE	DWG. NO.	ELECTRONIC FILE		REV	
	JOHN COLE	1/10/00	A	8455-0664	16N1883.dwg		A	
APPROVED BY:	DATE:	SCALE:		U.O.M.: INCHES [mm]		SHEET: 1 OF 1		
DANIEL CAREY	4/5/00	NTS						