

REVISIONS			DOC. NO. SPC-F004 * Effective: 7/8/02 * DCP No: 1398						
DCP #	REV	DESCRIPTION	DRAWN	DATE	CHECKD	DATE	APPRVD	DATE	
1737	D	Revise Specifications	HO	6/9/04	JW	6/9/04	JW	6/9/04	
1896	E	Update To RoHS Compliant	EO	3/27/06	HO	3/28/06	HO	3/28/06	

**NOTES:**

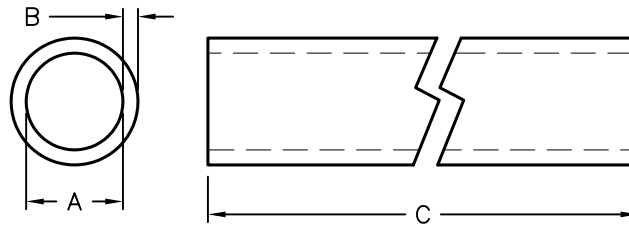

1. Material: FEP/PTFE
2. Shrink Rate: 1.25:1
3. Shrink Temperature: 680°F (360°C)
4. Continuous Use Temperature Range:  
-100 °F to 450 °F (-75 °C to -231 °C)
5. Longitudinal Change: +10%
6. Color: Translucent to Opaque
7. Dual shrink consists of an outer layer of PTFE heat shrink with an inner layer of FEP tubing. Dual shrink is especially effective for protecting cable assemblies from moisture.
8. Dielectric Strength: 1400 V/MIL
9. Dielectric Constant: 2.2 @ 100Hz - 60MHz
10. Volume Resistivity: 10<sup>18</sup> ohms - CM min.
11. Tensil Strength: 2000 PSI
12. Specific Gravity: 2.12 to 2.17 g/cm<sup>2</sup>



Size	Dimensions		Recovered Nominal Wall Thickness	C					
	A			2 Foot Lengths			6 Inch Lengths		
	Expanded I.D. (Min)	Recovered I.D. (Max)		Type No.	Qty	Total Footage	Type No.	Qty	Total Footage
3/32"	.036"	.000"	.023"	TFM-002-2050-NAT	50	100 FT	TFM-002-6025-NAT	25	12.5
1/16"	.060"	.000"	.028"	TFM-004-2050-NAT	50	100 FT	TFM-004-6025-NAT	25	12.5
1/8"	.130"	.000"	.032"	TFM-008-2050-NAT	50	100 ft	TFM-008-6025-NAT	25	12.5
3/16"	.190"	.062"	.035"	TFM-012-2025-NAT	25	50FT	TFM-012-6025-NAT	25	12.5
1/4"	.250"	.125"	.035"	TFM-016-2025-NAT	25	50 ft	TFM-016-6010-NAT	10	5
3/8"	.450"	.312"	.055"	TFM-024-2010-NAT	10	20FT	TFM-024-6010-NAT	10	5
3/4"	.700"	.440"	.055"	TFM-048-2005-NAT	5	10FT	TFM-048-6005-NAT	5	2.5

SPC-F004.DWG

TOLERANCES: UNLESS OTHERWISE SPECIFIED, DIMENSIONS ARE FOR REFERENCE PURPOSES ONLY.	DRAWN BY:	DATE:	DRAWING TITLE: Inner Melt Teflon Tubing Standard Wall				
	J.A.P.		SIZE	DWG. NO.	ELECTRONIC FILE	REV	
	CHECKED BY:	DATE:	A	TA-175	TA-175.DWG	E	
	JOHN COLE	2/20/92					
APPROVED BY:	DATE:	SCALE: NTS		U.O.M.: INCHES		SHEET: 1 OF 1	

ALL RIGHTS RESERVED. NO PORTION OF THIS PUBLICATION, WHETHER IN WHOLE OR IN PART CAN BE REPRODUCED WITHOUT THE EXPRESS WRITTEN CONSENT OF SPC TECHNOLOGY. DISCLAIMER: ALL STATEMENTS AND TECHNICAL INFORMATION CONTAINED HEREIN ARE BASED UPON INFORMATION AND/OR TESTS WE BELIEVE TO BE ACCURATE AND RELIABLE. SINCE CONDITIONS OF USE ARE BEYOND OUR CONTROL, THE USER SHALL DETERMINE THE SUITABILITY OF THE PRODUCT FOR THE INTENDED USE AND ASSUME ALL RISK AND LIABILITY WHATSOEVER IN CONNECTION THEREWITH.