



Designers' Choice

METAL CABLE CLAMPS

STEEL CABLE CLAMPS

MATERIAL: Steel Zinc Alloy

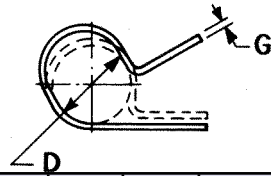
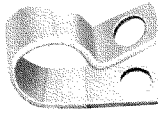
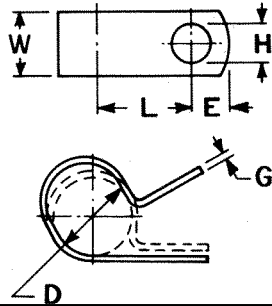

CAT. NO.	D FOR DIA	H HOLE DIA	L CTR TO CTR	W	E HOLE CTR	G THK
8100	.187	.203	.375	.500	.218	.032
8101	.250	.203	.406	.500	.218	.032
8102	.312	.203	.437	.500	.218	.032
8103	.375	.203	.468	.500	.218	.032
8104	.437	.203	.500	.500	.218	.032
8105	.500	.203	.531	.500	.218	.032
8106	.562	.203	.562	.500	.218	.032
8107	.625	.203	.594	.500	.218	.032
8108	.687	.203	.625	.500	.218	.032
8109	.750	.203	.656	.500	.218	.032
8110	.812	.203	.687	.500	.218	.032
8111	.875	.203	.718	.500	.218	.032
8112	.937	.203	.750	.500	.218	.032
8113	1.000	.203	.781	.500	.218	.032

STEEL HALF CLAMPS

MATERIAL: Steel Zinc Alloy

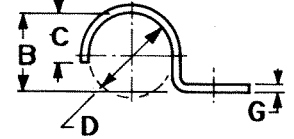
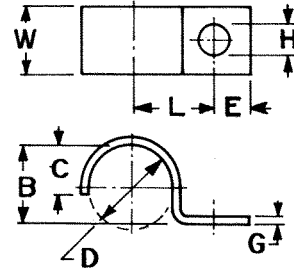

CAT. NO.	D FOR DIA	H HOLE DIA	L CTR TO CTR	E	B	C	G THK	W
8140	.125	.218	.437	.250	.125	.093	.032	.500
8141	.187	.218	.437	.250	.156	.093	.032	.500
8142	.250	.218	.437	.250	.187	.156	.032	.500
8143	.312	.218	.500	.250	.250	.187	.048	.500
8144	.375	.218	.531	.312	.312	.218	.048	.625
8145	.437	.218	.562	.312	.375	.281	.048	.625
8146	.500	.218	.625	.312	.437	.312	.060	.625
8147	.562	.218	.687	.312	.500	.343	.060	.625
8148	.625	.218	.750	.312	.562	.437	.060	.625
8149	.687	.218	.812	.312	.625	.406	.060	.625
8150	.750	.218	.812	.312	.687	.437	.060	.625
8151	.812	.218	.875	.312	.750	.468	.060	.625
8152	.875	.281	.937	.375	.812	.531	.060	.750
8153	.937	.281	.968	.437	.812	.593	.060	.750
8154	1.000	.281	1.000	.437	.937	.625	.060	.750

INSULATED STEEL CABLE CLAMPS

MATERIAL: Steel Zinc Alloy
CUSHION: Black Vinyl, .032 Thick

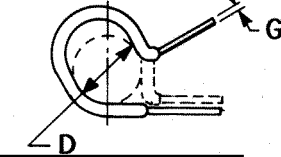
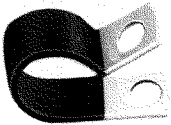
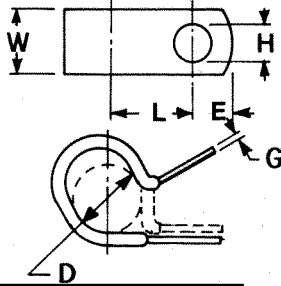

CAT. NO.	D FOR DIA	H HOLE DIA	L CTR TO CTR	W	E	G THK
8120	.125	.203	.375	.500	.218	.032
8121	.187	.203	.406	.500	.218	.032
8122	.250	.203	.437	.500	.218	.032
8123	.312	.203	.468	.500	.218	.032
8124	.375	.203	.500	.500	.218	.032
8125	.437	.203	.531	.500	.218	.032
8126	.500	.203	.562	.500	.218	.032
8127	.562	.203	.594	.500	.218	.032
8128	.625	.203	.625	.500	.218	.032
8129	.687	.203	.656	.500	.218	.032
8130	.750	.203	.687	.500	.218	.032
8131	.812	.203	.718	.500	.218	.032
8132	.875	.203	.750	.500	.218	.032
8133	.937	.203	.781	.500	.218	.032
8134	1.000	.203	.812	.500	.218	.032

INSULATED STEEL HALF CLAMPS

MATERIAL: Steel Zinc Alloy
CUSHION: Black Vinyl, .032 Thick

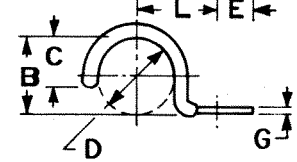
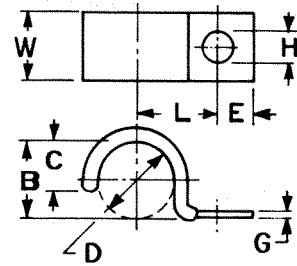

CAT. NO.	D FOR DIA	H HOLE DIA	L CTR TO CTR	E	B	C	G THK	W
8160	.187	.218	.437	.250	.187	.156	.032	.500
8161	.250	.218	.500	.250	.250	.187	.048	.500
8162	.312	.218	.531	.312	.312	.218	.048	.625
8163	.375	.218	.562	.312	.375	.281	.048	.625
8164	.437	.218	.625	.312	.437	.312	.060	.625
8165	.500	.218	.687	.312	.500	.343	.060	.625
8166	.562	.218	.750	.312	.562	.437	.060	.625
8167	.625	.218	.812	.312	.625	.406	.060	.625
8168	.687	.218	.812	.312	.687	.437	.060	.625
8169	.750	.218	.875	.312	.750	.468	.060	.625
8170	.812	.281	.937	.375	.812	.531	.060	.750
8171	.875	.281	.968	.437	.812	.593	.060	.750
8172	.937	.281	1.000	.437	.937	.625	.060	.750
8173	1.000	.281	1.062	.437	1.000	.687	.060	.750