

Materials		
No.	Component name	Finish
1	Housing	ALKYD, GREEN, UL94 V-0
2	End terminal	silver clad copper alloy
3	Center terminal	copper alloy
4	Rocker contact	silver clad copper alloy
5	Actuator	Phenol resin, UL94 HB, black
6	Plunger	stainless steel
7	Spring	music wire
8	Toggle	brass
9	Retainer	brass
10	Frame	polyamide, UL94 HB, black
11	Bushing	STAINLESS STEEL
12	Mounting nut	Zinc
13	Internal tooth lockwasher	brass
14	O-Ring, toggle seal	steel
15	O-ring, panel seal	100 microinches min. bright nickel, electrodeposited

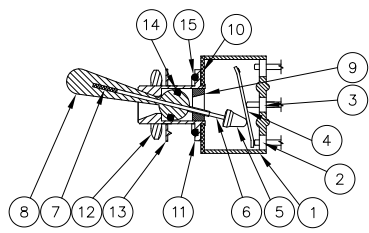

NOT TO SCALE

Specifications—see note 3			
Current rating UL & CSA	6A @ 125 VAC (resistive)		
	3A @ 250 VAC (resistive)		
	4A @ 28 VDC (resistive)		
Termination resistance	20 milliohms max @		
	2-4 VDC, 1A		
Insulation resistance	1,000 megohms min.		
Withstanding voltage	1,000 VAC		
Travel	24 +/- 2 degrees		
Actuation force	95 to 115 lbf		
Operating temperature	-20C to +85C		
Storage temperature	-40C to +85C		
Contact timing	break before make		
Terminal seal	epoxy		
Durability	Parameter	2 Position	3 Position
	mechanical (no load)	150,000	100,000
	250 VAC (3A resistive)	80,000	60,000
	125 VAC (4A resistive)	80,000	60,000
	28 VDC (4A resistive)	60,000	50,000

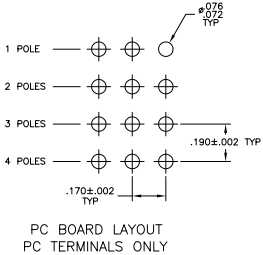
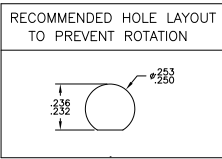

PART NUMBER	Alco P/N	Poles	Throws	Function	Terminal	Diagram 1	Diagram 2	Diagram 3	Comments
1-1571924-9	MTE406P04	4	2	ON OFF ON	Wire lug	2-3, 5-6, 8-9, 11-12	Off	2-1, 5-4, 8-7, 11-10	
1-1571924-8	MTE406N04	4	2	ON ON	Wire lug	2-3, 5-6, 8-9, 11-12	---	2-1, 5-4, 8-7, 11-10	
1-1571924-7	MTE306E04	3	2	ON OFF ON	Wire lug	2-3, 5-6, 8-9	Off	2-1, 5-4, 8-7	
1-1571924-6	MTE306D04	3	2	ON ON	Wire lug	2-3, 5-6, 8-9	---	2-1, 5-4, 8-7	
1-1571924-5	MTE206T04	2	2	ON OFF (ON)	Wire lug	2-3, 5-6	OFF	2-1, 5-4	
1-1571924-4	MTE206S04	2	2	(ON) OFF (ON)	Wire lug	2-3, 5-6	OFF	2-1, 5-4	
1-1571924-3	MTE206R04	2	2	ON (ON)	Wire lug	2-3, 5-6	---	2-1, 5-4	
1-1571924-2	MTE206PA04	1	3	ON ON ON	Wire lug	5-6	5-3	5-1	note 6
1-1571924-1	MTE206P04	2	2	ON OFF ON	Wire lug	2-3, 5-6	OFF	2-1, 5-4	
1-1571924-0	MTE206N04	2	2	ON ON	Wire lug	2-3, 5-6	---	2-1, 5-4	
OBSOLETE	1571924-9	MTE206K04	2	1	ON OFF	PC	2-3, 5-6	---	OFF
OBSOLETE	1571924-8	MTE206K04	2	1	ON OFF	Wire lug	2-3, 5-6	---	OFF
	1571924-7	MTE106H04	1	2	ON OFF (ON)	Wire lug	2-3	---	2-1
	1571924-6	MTE106G04	1	2	(ON) OFF (ON)	Wire lug	2-3	---	2-1
	1571924-5	MTE106F04	1	2	ON (ON)	Wire lug	2-3	---	2-1
	1571924-4	MTE106E04	1	2	ON OFF ON	Wire lug	2-3	Off	2-1
	1571924-3	MTE106D04	1	2	ON ON	Wire lug	2-3	---	2-1
OBSOLETE	1571924-2	MTE106AP04	1	1	ON OFF	PC	2-3	---	OFF
OBSOLETE	1571924-1	MTE106A04	1	1	ON OFF	Wire lug	2-3	---	OFF

- NOTES:
- TERMINAL NUMBERS ARE FOR REFERENCE ONLY AND DO NOT APPEAR ON THE SWITCHES.
 - EACH SWITCH SUPPLIED WITH THE FOLLOWING MOUNTING HARDWARE:
 (1) 1/4-40 UNS-2B HEX NUT
 (1) INTERNAL TOOTH LOCKWASHER
 (1) O-RING
 - SWITCHES TESTED TO AND MEET THE REQUIREMENTS OF UL 61058-1A. SWITCHES FOR APPLIANCE SWITCHES WILL ALSO BE TESTED TO AND MEET THE REQUIREMENTS OF TE 102-2469, REV 0, MINATURE SWITCH QUALIFICATION REQUIREMENTS.
 - SWITCHES ARE PENDING UL RECOGNITION TO US AND CANADIAN STANDARDS.
 - WIRE LUG CONTACTS WILL ACCEPT 2 #20 AWG SOLID OR STRANDED WIRES.
 - CUSTOMER INSTALLED EXTERNAL JUMPER BETWEEN TERMINALS 2 AND 4 REQUIRED FOR 1 POLE 3 THROW FUNCTION.
 - SWITCHES ARE MARKED PER TE SPEC 202-37 WITH ALCO BENEATH LOGO AS SHOWN.
 - ALL MATERIALS AND FINISHES SHALL COMPLY WITH EU DIRECTIVE 2002/95/EC OF 27/JAN/2003 (ROHS).

THIS DRAWING IS A CONTROLLED DOCUMENT. THE ONLY ORIGINAL IS IN THE OFFICE OF THE DESIGN ENGINEER.

DESIGNING: []
 CHECKED: []
 APPROVED: []

DATE: 11/15/10
 REV: 1

ALCOSWITCH GREEN SERIES TOGGLE SWITCH
 MTE VERTICAL MOUNT

TITLE: 007791G-1571924
 PART: 4.1
 SHEET: 1 OF 3
 REV: A1

THIS DRAWING IS UNPUBLISHED. ALL RIGHTS RESERVED.
 © 2015 ELECTRONICS CORPORATION

REVISONS		DATE	BY	APP'D
AD	00			

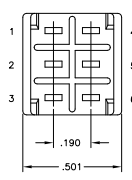
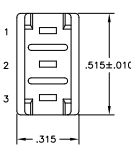
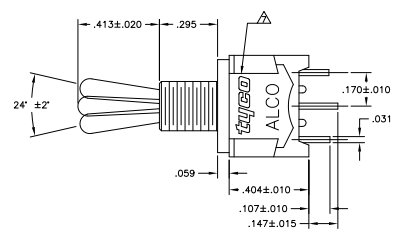

MTE106

MTE206

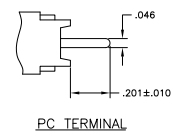
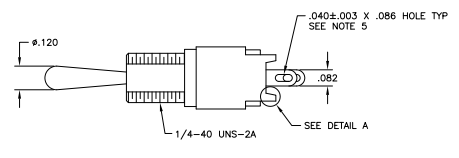
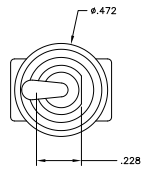

PC TERMINAL

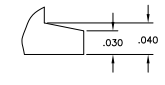

DETAIL A
SCALE 16:1

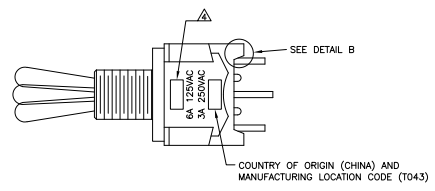

WIRE LUG TERMINAL

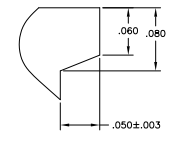

DETAIL B
SCALE 16:1

THIS DRAWING IS A CONTROLLED DOCUMENT.		REV	00	DATE		DESIGNED BY		DATE		APPROVED BY	
DRAWN BY		CHECKED BY		DATE		TITLE		PART NO.		REVISED TO	
MTE		MTE		MTE		ALCO SWITCH GREEN SERIES TOGGLE SWITCH		MTE VERTICAL MOUNT		REVISED TO	
MTE		MTE		MTE		SEE		DATE		DRAWING NO.	
MTE		MTE		MTE		A1		00779		1571924	
MTE		MTE		MTE		CUSTOMER DRAWING		PAGE		2	
MTE		MTE		MTE				OF		3	
MTE		MTE		MTE				REV		A1	

THIS DRAWING IS UNPUBLISHED. ALL RIGHTS RESERVED.
 © 2015 ELECTRONICS CORPORATION. ALL RIGHTS RESERVED.

REVISONS		DATE	BY	APP'D
AD	00			

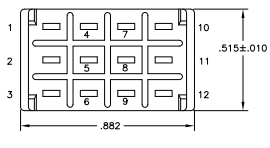
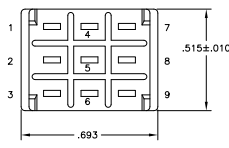
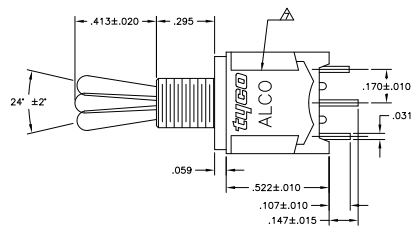

MTE306

MTE406

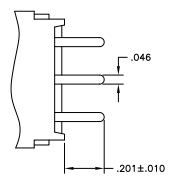
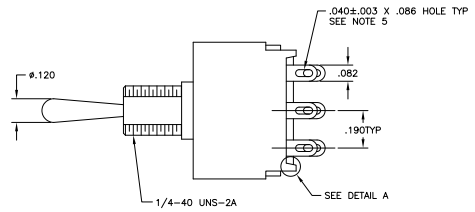
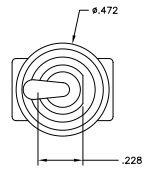

PC TERMINAL

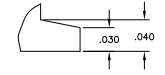

DETAIL A
SCALE 16:1

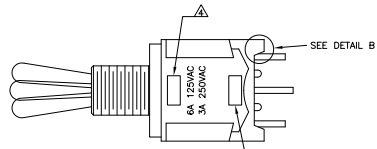

WIRE LUG TERMINAL

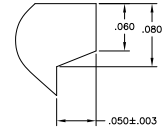

DETAIL B
SCALE 16:1

THIS DRAWING IS A CONTROLLED DOCUMENT.		REV	DATE	QUANTITY	BY	DATE	DESCRIPTION
DRAWING NO.		REV	DATE	QUANTITY	BY	DATE	DESCRIPTION
REVISIONS		REV	DATE	QUANTITY	BY	DATE	DESCRIPTION
APPROVED		REV	DATE	QUANTITY	BY	DATE	DESCRIPTION
CUSTOMER DRAWING		REV	DATE	QUANTITY	BY	DATE	DESCRIPTION