

No.	Component name	Base material	Finish
1	Housing	ALKYD, GREEN, UL94 V-0	
2	End terminal	silver clad copper alloy	5 microinches min. gold
3	Center terminal	copper alloy	5 microinches min. gold
4	Rocker contact	silver clad copper alloy	5 microinches min. gold
5	Actuator	Phenol resin, UL94 HB, black	
6	Plunger	stainless steel	
7	Spring	music wire	
8	Leaflet	brass	100 microinches min. bright nickel, electrodeposited
9	Retainer	Polyamide, UL94 HB, black	
10	Frame	STAINLESS STEEL	
11	Bushing	Zinc	100 microinches min. nickel electrodeposited over 200 microinches min. copper
12	Mounting nuts (2)	brass	100 microinches min. bright nickel electrodeposited
13	Locating ring	cold rolled steel	100 microinches min. bright nickel, electrodeposited
14	Internal tooth lockwasher	steel	100 microinches min. bright nickel, electrodeposited

**OBSOLETE**

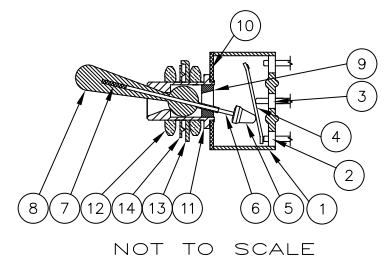

Current rating UL & CSA	Specifications—see note 3
6A @ 125 VAC (resistive)	
3A @ 250 VAC (resistive)	
4A @ 28 VDC (resistive)	
20 milliamps max @ 2-4 VDC, 1A	
Insulation resistance	1,000 megohms min.
Withstanding voltage	1,000 VAC
Travel	24 +/- 2 degrees
Actuation force	0.85 to 1.5 lbf
Operating temperature	-20C to +85C
Storage temperature	-40C to +85C
Contact timing	break before make
Terminal seal	epoxy
Durability	Parameter 2 Position 3 Position Momentary
mechanical (no load)	150,000 100,000 80,000
250 VAC (3A resistive)	80,000 60,000 50,000
125 VAC (6A resistive)	80,000 60,000 50,000
28 VDC (4A resistive)	60,000 50,000 40,000

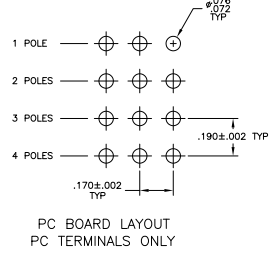
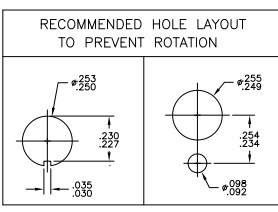

- TERMINAL NUMBERS ARE FOR REFERENCE ONLY AND DO NOT APPEAR ON THE SWITCHES.
- EACH SWITCH SUPPLIED WITH THE FOLLOWING MOUNTING HARDWARE:
  - 1/4-40 UNS-2B HEX NUTS
  - INTERNAL TOOTH LOCKWASHER
  - LOCATING RING
- SWITCHES TESTED TO AND MEET THE REQUIREMENTS OF UL 61058-1A. SWITCHES FOR APPLIANCES SWITCHES WILL ALSO BE TESTED TO AND MEET THE REQUIREMENTS OF TE CONNECTIVITY 102-2469, REV O, MINATURE SWITCH QUALIFICATION REQUIREMENTS.
- SWITCHES ARE PENDING UL RECOGNITION TO US AND CANADIAN STANDARDS.
- WIRE LUG CONTACTS WILL ACCEPT 2 #20 AWG SOLID OR STRANDED WIRES.
- CUSTOMER INSTALLED EXTERNAL JUMPER BETWEEN TERMINALS 2 AND 4 REQUIRED FOR 1 POLE 3 THROW FUNCTION.
- CUSTOMER INSTALLED EXTERNAL JUMPER BETWEEN TERMINALS 2 AND 4 AS WELL AS 8 AND 10 REQUIRED FOR 2 POLE 3 THROW FUNCTION.
- SWITCHES ARE MARKED PER TE CONNECTIVITY SPEC 202-37 WITH ALCO BENEATH LOGO AS SHOWN.
- ALL MATERIALS AND FINISHES SHALL COMPLY WITH EU DIRECTIVE 2002/95/EC OF 27JAN2003 (ROHS).
- CASE LENGTH .512.

PART NUMBER	Alco P/N	Poles	Throws	Function	Terminal	Terminal Diagram	Comments
4-1571920-3	MTA06PPC04	4	2	ON OFF ON	PC	2-3, 5-6, 8-9, 11-12	OFF
4-1571920-2	MTA06PPC04	2	3	ON ON ON	PC	5-6, 11-12	5-3, 11-9
4-1571920-1	MTA06PPC04	2	3	ON ON ON	Wire lug	5-6, 11-12	5-3, 11-9
4-1571920-0	MTA06PPC04	4	2	ON OFF ON	Wire lug	2-3, 5-6, 8-9, 11-12	OFF
3-1571920-9	MTA06NP04	4	2	ON ON	PC	2-3, 5-6, 8-9, 11-12	---
3-1571920-8	MTA06NP04	4	2	ON ON	Wire lug	2-3, 5-6, 8-9, 11-12	---
3-1571920-7	MTA06NP04	3	2	ON OFF(ON)	PC	2-3, 5-6, 8-9	OFF
3-1571920-6	MTA06NP04	3	2	ON OFF(ON)	Wire lug	2-3, 5-6, 8-9	OFF
3-1571920-5	MTA06NP04	3	2	ON (ON)	PC	2-3, 5-6, 8-9	---
3-1571920-4	MTA06NP04	3	2	ON (ON)	Wire lug	2-3, 5-6, 8-9	---
3-1571920-3	MTA06NP04	3	2	ON OFF ON	PC	2-3, 5-6, 8-9	OFF
3-1571920-2	MTA06NP04	3	2	ON OFF ON	Wire lug	2-3, 5-6, 8-9	OFF
3-1571920-1	MTA06NP04	3	2	ON ON	PC	2-3, 5-6, 8-9	---
3-1571920-0	MTA06NP04	3	2	ON ON	Wire lug	2-3, 5-6, 8-9	---
2-1571920-9	MTA06PC04	2	2	ON OFF(ON)	PC	2-3, 5-6	OFF
2-1571920-8	MTA06PC04	1	3	ON ON (ON)	Wire lug	5-6	5-3
2-1571920-7	MTA06PC04	2	2	ON OFF(ON)	Wire lug	2-3, 5-6	OFF
2-1571920-6	MTA06PC04	2	2	(ON) OFF (ON)	PC	2-3, 5-6	OFF
2-1571920-5	MTA06SP04	1	3	(ON) ON (ON)	PC	5-6	5-3
2-1571920-4	MTA06SA04	1	3	(ON) ON (ON)	Wire lug	5-6	5-3
2-1571920-3	MTA06SA04	2	2	(ON) OFF (ON)	Wire lug	2-3, 5-6	OFF
2-1571920-2	MTA06RP04	2	2	ON (ON)	PC	2-3, 5-6	---
2-1571920-1	MTA06RP04	2	2	ON (ON)	Wire lug	2-3, 5-6	---
2-1571920-0	MTA06PPC04	2	2	ON OFF ON	PC	2-3, 5-6	OFF
1-1571920-9	MTA06PPC04	1	3	ON ON ON	PC	5-6	5-3
1-1571920-8	MTA06PA04	1	3	ON ON ON	Wire lug	5-6	5-3
1-1571920-7	MTA06PPC04	2	2	ON OFF ON	Wire lug	2-3, 5-6	OFF
1-1571920-6	MTA06NP04	2	2	ON ON	PC	2-3, 5-6	---
1-1571920-5	MTA06NP04	2	2	ON ON	Wire lug	2-3, 5-6	---
1-1571920-4	MTA06KP04	2	1	ON OFF	PC	2-3, 5-6	---
1-1571920-3	MTA06K04	2	1	ON OFF	Wire lug	2-3, 5-6	---
1-1571920-2	MTA106PPC04	1	2	ON OFF(ON)	PC	2-3	OFF
1-1571920-1	MTA106PPC04	1	2	ON OFF(ON)	Wire lug	2-3	OFF
1-1571920-0	MTA106PPC04	1	2	(ON) OFF (ON)	PC	2-3	OFF
1571920-9	MTA106G04	1	2	(ON) OFF (ON)	Wire lug	2-3	OFF
1571920-8	MTA106PPC04	1	2	ON (ON)	PC	2-3	---
1571920-7	MTA106PPC04	1	2	ON (ON)	Wire lug	2-3	---
1571920-6	MTA106PPC04	1	2	ON OFF ON	PC	2-3	OFF
1571920-5	MTA106G04	1	2	ON OFF ON	Wire lug	2-3	OFF
1571920-4	MTA106PPC04	1	2	ON ON	PC	2-3	---
1571920-3	MTA106G04	1	2	ON ON	Wire lug	2-3	---
1571920-2	MTA106PPC04	1	1	ON OFF	PC	2-3	---
1571920-1	MTA106G04	1	1	ON OFF	Wire lug	2-3	---

THIS DRAWING IS A CONTROLLED DOCUMENT. REV. 00

TE Connectivity  
ALCO SWITCH GREEN SERIES TOGGLE SWITCH  
MTA VERTICAL MOUNT

DATE: 11/07/99  
DRAWN BY: [Signature]  
CHECKED BY: [Signature]  
APPROVED BY: [Signature]

CUSTOMER DRAWING: A100779 (G=1571920)  
PAGE: 4.1 OF 3

THIS DRAWING IS UNPUBLISHED  
 ALL RIGHTS RESERVED

REVISES		DATE	BY	APP'D
AD	00			

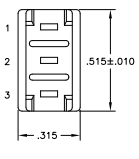
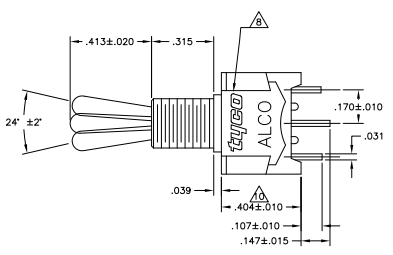

MTA106

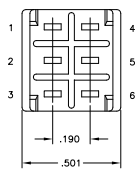

MTA206

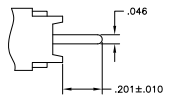
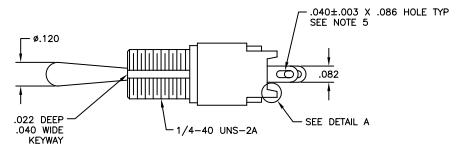

PC TERMINAL

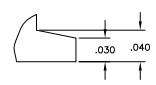

DETAIL A  
SCALE 16:1

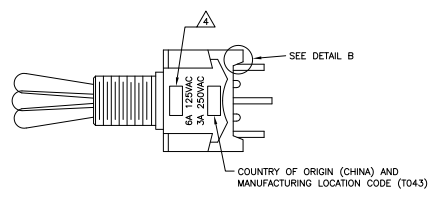

WIRE LUG TERMINAL

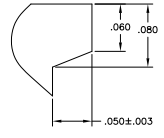

DETAIL B  
SCALE 16:1

THIS DRAWING IS A CONTROLLED DOCUMENT.		REV	DATE	BY	CHKD	DATE	BY
REVISIONS		REV	DATE	BY	CHKD	DATE	BY
AD 00							
DESCRIPTION		ALCO SWITCH GREEN SERIES TOGGLE SWITCH MTA VERTICAL MOUNT					
DRAWN		M. ZITTO					
CHECKED		M. ZITTO					
APPROVED		M. ZITTO					
CUSTOMER DRAWING		SIZE	DATE	ISSUE	DRAWING NO.	REVISIONS	
		A1	00779	G=1571920			
		SCALE	4:1	SHEET	2	OF	3
		TE Connectivity					

THIS DRAWING IS UNPUBLISHED  
ALL RIGHTS RESERVED

REV	REVISI ONS	
	DATE	BY
00		
SEE SHEET 1		

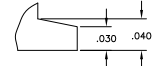
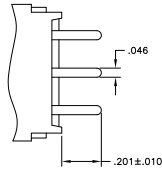
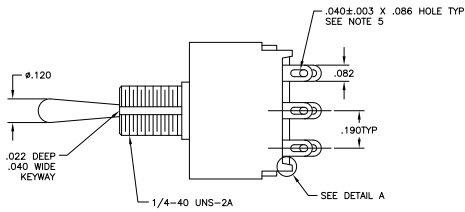
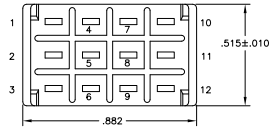
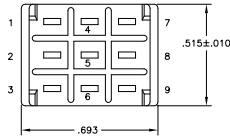
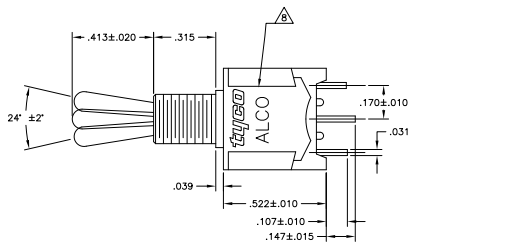

DETAIL A  
SCALE 16:1

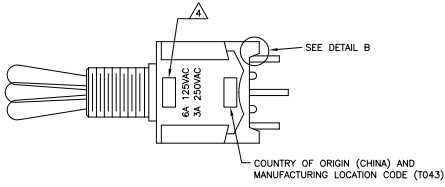

WIRE LUG TERMINAL

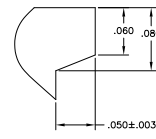

DETAIL B  
SCALE 16:1

THIS DRAWING IS A CONTROLLED DOCUMENT.		REV	DATE	DESCRIPTION	BY	CHK
REVISIONS						
1						
2						
3						
4						
5						
6						
7						
8						
CUSTOMER DRAWING						

TE Connectivity  
ALCOSWITCH GREEN SERIES TOGGLE SWITCH  
MTA VERTICAL MOUNT  
DATE 100779  
DRAWING NO 1571920  
REV 4.1  
SHEET 3 OF 3