

FO-55111-A

HONEYWELL  
PART NUMBER  
311SM3-H2  
PRODUCT CODE  
TZA1180

REV	DOCUMENT	CHANGED BY	CHECK
5	0038113	PRS 12JUN08	BLR

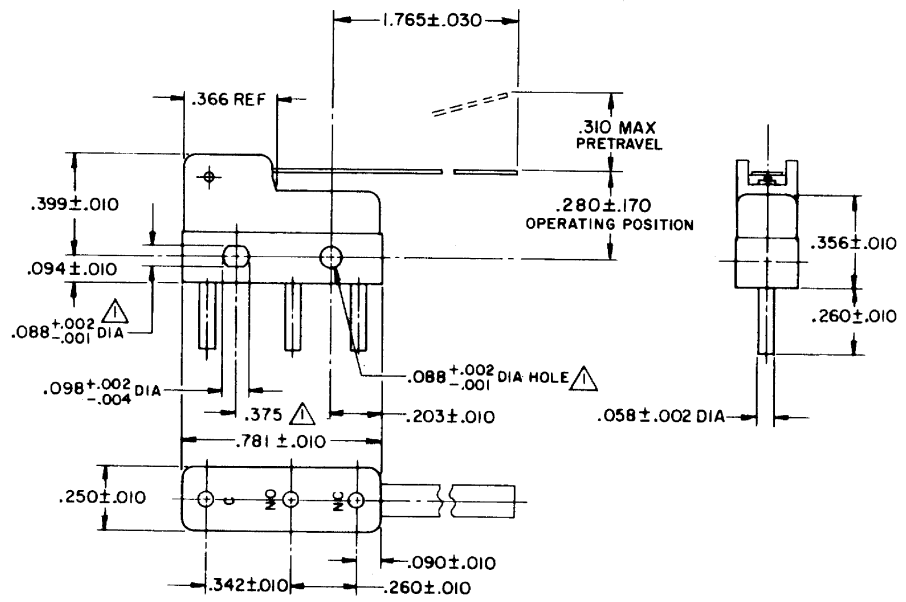
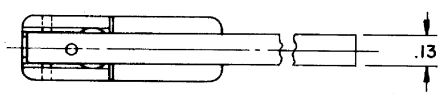

NOTE -  
 ▲ MOUNTING HOLES WILL ACCEPT PINS OR SCREWS OF .087 MAX DIA ON .375 ± .002 CENTERS  
 2- SWITCH WILL WITHSTAND TEMPERATURE OF 250°F  
 3- PLATED TERMINALS WILL ACCEPT AIRCRAFT MARINE PRODUCTS CO. NO. 42429 CONNECTOR

RELEASE NO. PR - 3572  
 REPLACES -

CHARACTERISTICS
OPERATING FORCE -- 15 GRAM MAX
RELEASE FORCE -- 2 GRAM MIN
DIFFERENTIAL TRAVEL -- .110 MAX
OVERTRAVEL -- .057 MIN

ELECTRICAL DATA
CONTACT ARRANGEMENT S-P-D-T
30 VOLTS DC RATING
SEA LEVEL 50,000 FT
INDUCTIVE 3 AMP 2.5 AMP
RESISTIVE 5 AMP 5 AMP
MAXIMUM INRUSH 24 AMP
KEMA CE 5A, 250V ~ T85 1E4
UL CSA 5A, 250 VAC ~

DESIGN UNITS: INCH
TOLERANCES UNLESS NOTED:
NO PLACE .X ± 0.030
ONE PLACE .XX ± 0.015
TWO PLACE .XXX ± 0.005
THREE PLACE .XXXX ±
FOUR PLACE .XXXX ±
ANGLES ±
THIRD ANGLE PROJECTION

DRAWN VK 05 NOV 07
CHECK RJ 05 NOV 07
THIS DRAWING COVERS A PROPRIETARY ITEM AND IS THE PROPERTY OF HONEYWELL. THIS DRAWING IS NOT TO BE COPIED OR USED WITHOUT THE PERMISSION OF HONEYWELL.
INTERPRET PER ANSI Y14.5M-1982 OTHER HONEYWELL ENGINEERING STANDARDS MAY APPLY
RASTER

<b>Honeywell</b>			
TITLE SWITCH - BASIC			
SIZE B	TYPE I	DRAWING NAME 311SM3-H2	REV 5
SCALE -	WEIGHT .006 LB MAX	SHEET 1 OF 1	

4

3

2

1