

**MICRO SWITCH**  
a Honeywell Division

FED. MFG. CODE 91929

**SWITCH-BASIC**

CATALOG LISTING

V7-7H25D8-263-1

CW-C6220

CATALOG LISTING  
V7-7H25D8-263-1

ISSUE  
**M**  
9

REPLACES  
RELEASE NO. PR-16571

CHECK

REVISIONS

A	CORR	WJM	20 MAY 88
B	CORR	WJM	10 JUN 88
C	PR-16571	KAG	16 JUL 88
D	C066350	JAP	22 SEP 89
E	CO-69205	CO-	7 JAN 91
F	CO-78215	LJF	11 NOV 93
G	CO-78584	DCS	29 JUN 94
H	CO-84318	DCS	2 APR 97

CHECK

JAP

CHECK

JAP

CHECK

JAP

CHECK

JAP

CHECK

JAP

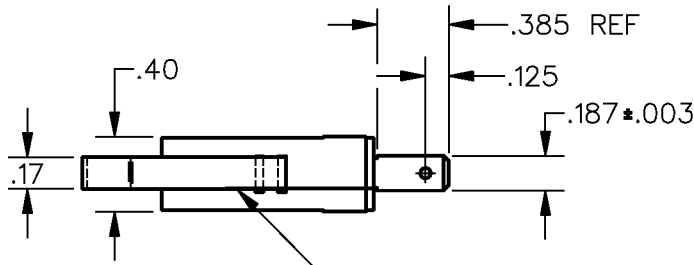

CORROSION RESISTANT  
STEEL ACTUATOR

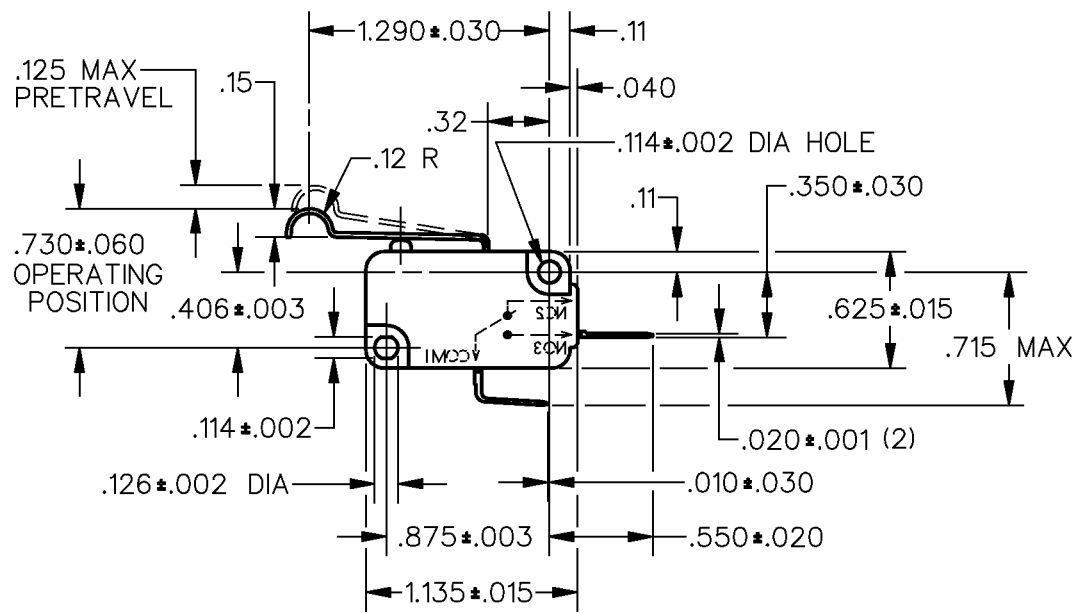

NOTES  
1 - SERRATED STATIONARY CONTACTS  
2 - MARK CATALOG LISTING AND DATE CODE ONLY ON SWITCH  
3 - SILVER PLATED TERMINALS

THIS DRAWING COVERS A PROPRIETARY ITEM AND IS THE PROPERTY OF MICRO SWITCH, A DIVISION OF HONEYWELL. THIS DRAWING IS NOT TO BE COPIED OR USED WITHOUT THE APPROVAL OF MICRO SWITCH.

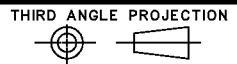

CHARACTERISTICS	ELECTRICAL DATA	SCALE FULL	DO NOT SCALE PRINT
OPERATING FORCE — — — — 4 OZ MAX	CONTACT ARRANGEMENT S P N O	<b>UNLESS OTHERWISE SPECIFIED TOLERANCES ARE</b>	
RELEASE FORCE — — — — 1/2 OZ MIN		ONE PLACE (.0)	±.030
RELEASE TRAVEL — — — — .015 MIN		TWO PLACE (.00)	±.015
DIFFERENTIAL TRAVEL — — .050 MAX		THREE PLACE (.000)	±.005
OVERTRAVEL — — — — .080 MIN		ANGLES	±
		WEIGHT	

DDM/CAD  
DRAWN

WJM 17 MAY 88