

**RAFIX 22 QR mushroom-headed pushbutton**



Pict.: Front ring, metallized

Front ring, slate grey

panel cut-out acc. to IEC 60947-5-1

**2**

**Technical data**

**General information**

Form of lens	mushroom formed
Colour of mushroom	see order block
Colour of front ring	see order block
Form of collar	see order block

**Dimensions**

Length of collar	see order block
Width of collar	see order block
Overall height	20.10 mm
Mounting depth	56.4 mm
Mounting hole	22.3 mm
Key grid	50 x 30 mm
Diameter of collar	see order block

**Mechanical design**

Mounting	ring nut
Contact function	see order block
Illuminability	see order block

**Mechanical characteristics**

Operating force max.	approx. 5 N for 1 switching element
Robustness min.	100 N

**Electrical characteristics**

Protection class	II
------------------	----

**Other specifications**

Operating life	1000000
Degree of protection from front side	IP65
Storage temperature min.	-40 °C
Storage temperature max.	80 °C
Resistance to constant environment	according to IEC 600 68-2-3 and 2-30
Resistance at variable environment	according to IEC 600 68-2-14 and 2-33

**Accessories RAFIX 22 QR mushroom-headed pushbutton**

Description	Photo	Order no.	Page
RAFIX 22 QR contact block with silver contacts, with coupling, without lamp socket, screw terminals, 1 NC + 1 NO		<b>1.20.124.017/0000</b>	2 - 140
RAFIX 22 QR contact block with gold contacts, with coupling, without lamp socket, cage clamp terminals, 1 NO		1.20.125.102/0000	2 - 144
Contact block with coupling, gold contacts, RJ 12 connector, 1 NO, without LED		1.20.128.002/0000	2 - 147
Fixing spanner for ring nut and front ring		<b>5.05.800.062/0000</b>	5 - 25

For other contact blocks, refer to the chapter „Contact blocks“; for additional accessories, refer to „RAFIX 22 QR special accessories“.

**RAFIX 22 QR mushroom-headed pushbutton 40 mm, round collar**

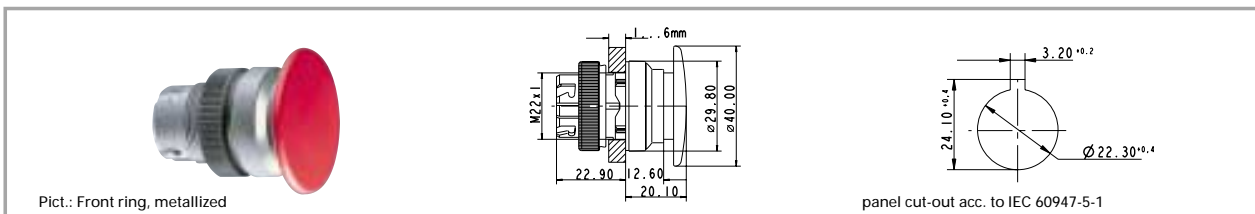

Illuminability	Colour of mushroom	Order no. momentary		Order no. latching	
		Plastic front ring	Metallized front ring	Plastic front ring	Metallized front ring
no	opaque black	1.30.246.501/01xx	1.30.246.502/0100	1.30.246.511/01xx	1.30.246.512/0100
no	opaque red	1.30.246.501/03xx	1.30.246.502/0300	1.30.246.511/03xx	1.30.246.512/0300

Technical data see page 2 - 120

xx = Front ring colour: black = 01, slate grey = 07, silver grey = 08  
 Order number **1.30.246.501/0308** (with silver grey plastic front ring) is a **stock item**.

2

**RAFIX 22 QR mushroom-headed pushbutton 40 mm, illuminated, round collar**

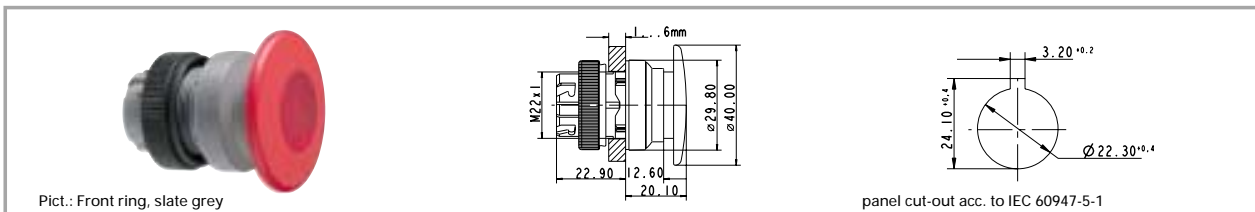

Illuminability	Colour of mushroom	Order no. momentary		Order no. latching	
		Plastic front ring	Metallized front ring	Plastic front ring	Metallized front ring
yes	opaque red/ transparent red	1.30.246.001/03xx	<b>1.30.246.002/0300</b>	1.30.246.011/03xx	1.30.246.012/0300

Technical data see page 2 - 120

xx = Front ring colour: black = 01, slate grey = 07, silver grey = 08  
 Order number **1.30.246.001/0308** (with silver grey plastic front ring) is a **stock item**.

RAFIX  
22 QR

**RAFIX 22 QR mushroom-headed pushbutton 60 mm, round collar**

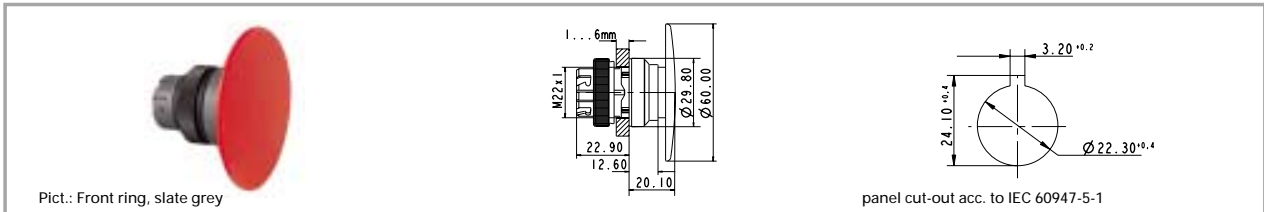

Illuminability	Colour of mushroom	Order no. momentary		Order no. latching	
		Plastic front ring	Metallized front ring	Plastic front ring	Metallized front ring
no	opaque red	1.30.246.601/03xx	1.30.246.602/0300		

Technical data see page 2 - 120  
 xx = Front ring colour: black = 01, slate grey = 07, silver grey = 08

2

**RAFIX 22 QR mushroom-headed pushbutton 40 mm, square collar**

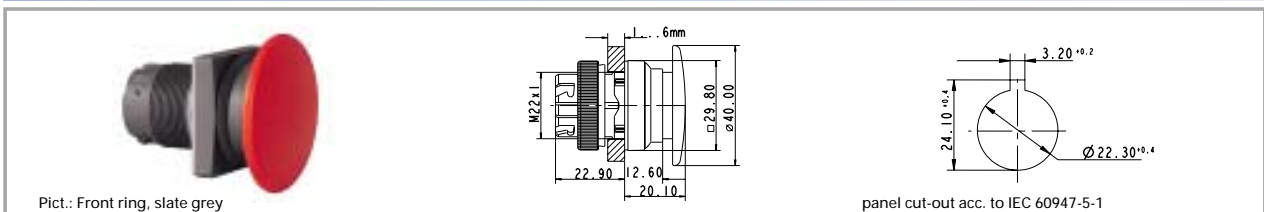

Illuminability	Colour of mushroom	Order no. momentary		Order no. latching	
		Plastic front ring	Metallized front ring	Plastic front ring	Metallized front ring
no	opaque black	1.30.246.551/01xx	1.30.246.552/0100	1.30.246.561/01xx	1.30.246.562/0100
no	opaque red	1.30.246.551/03xx	1.30.246.552/0300	1.30.246.561/03xx	1.30.246.562/0300

Technical data see page 2 - 120  
 xx = Front ring colour: black = 01, slate grey = 07, silver grey = 08  
 Order number **1.30.246.551/0308** (with silver grey plastic front ring) is a **stock item**.

RAFIX 22 QR

**RAFIX 22 QR mushroom-headed pushbutton 40 mm, illuminated, square collar**

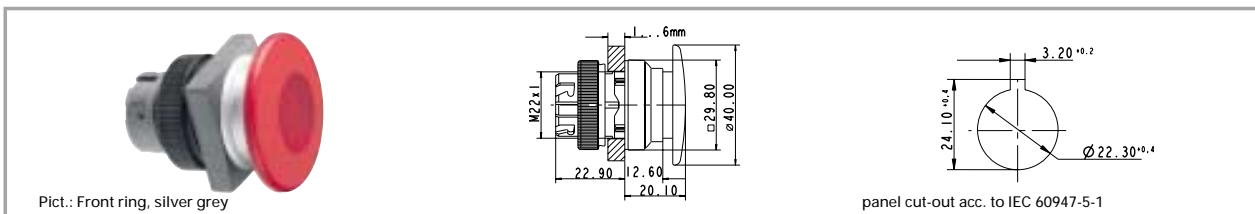

Illuminability	Colour of mushroom	Order no. momentary		Order no. latching	
		Plastic front ring	Metallized front ring	Plastic front ring	Metallized front ring
yes	opaque red/ transparent red	1.30.246.051/03xx	<b>1.30.246.052/0300</b>	1.30.246.061/03xx	1.30.246.062/0300

Technical data see page 2 - 120

xx = Front ring colour: black = 01, slate grey = 07, silver grey = 08

Order number **1.30.246.051/0308** (with silver grey plastic front ring) is a **stock item**.

2

**RAFIX 22 QR mushroom-headed pushbutton 60 mm, square collar**

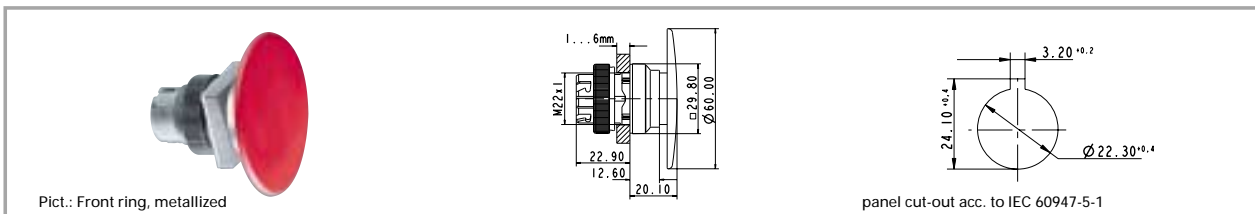

Illuminability	Colour of mushroom	Order no. momentary		Order no. latching	
		Plastic front ring	Metallized front ring	Plastic front ring	Metallized front ring
no	opaque red	1.30.246.651/03xx	1.30.246.652/0300		

Technical data see page 2 - 120

xx = Front ring colour: black = 01, slate grey = 07, silver grey = 08

RAFIX  
22 QR

**RAFIX 22 QR emergency stop pushbutton, dupe-proof to EN 418**

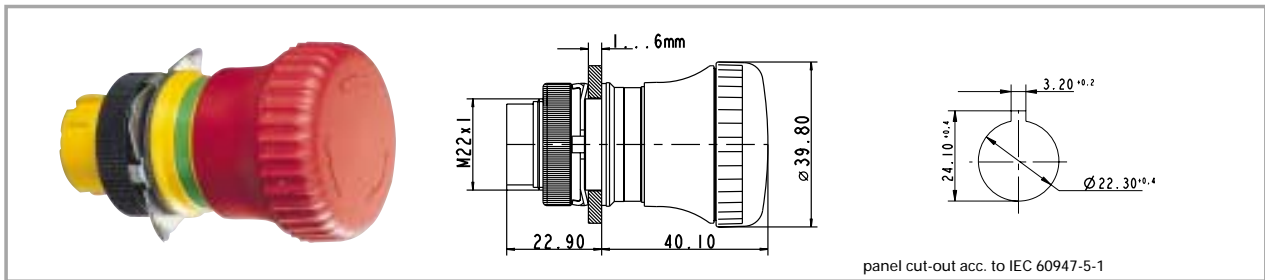

**2**

**General data**

The emergency stop pushbuttons comply with IEC 60 204, IEC 60 073, IEC 60 947 and VDE 0113 Part 1. They are designed dupe-proof according to EN 418 with a positive mechanical movement sequence. A certain operating force must be exerted at the action point in order to prevent inadvertent operation. The pushbutton latches when pressed and is reset by turning it in a clockwise direction. The special shape of the actuator prevents the emergency stop pushbutton from being blocked. This means that the emergency stop process - once initiated - cannot be impeded by any jamming objects. Only use contact block 1.20.126.4xx.

**Technical data**

<b>General information</b>		<b>Robustness min.</b>	100 N
Form of lens	mushroom formed	<b>Robustness</b>	acc. IEC 60947-5-5
Colour of lens	see order block	<b>Other specifications</b>	
Form of collar	round	Operating life	see order block
<b>Dimensions</b>		Degree of protection	from front side
Overall height	see order block	Ambient temp. operating min.	IP65
Mounting depth with contact block without cable	56.4 mm	Ambient temp. operating max.	-25 °C
Mounting hole	22.3 mm	Storage temperature min.	+70 °C
Key grid	50 x 30 mm	Storage temperature max.	-40 °C
Diameter of collar	39.8 mm	Resistance to constant environment	+80 °C
<b>Mechanical design</b>		Resistance at variable environment	according to IEC 600 68-2-3 and 2-30
Mounting	ring nut		
Contact function	latching		
Illuminability	see order block		
<b>Mechanical characteristics</b>			
Operating force max.	approx. 5 N for 1 switching element		

**Accessories RAFIX 22 QR emergency stop pushbutton, dupe-proof to EN 418**

Description	Photo	Order no.	Page
RAFIX 22 QR contact block with silver contacts, with coupling, without lamp socket, screw terminals, 1 NC		<b>1.20.124.001/0000</b>	2 - 140
RAFIX 22 QR contact block with silver contacts, with coupling, without lamp socket, screw terminals, 2 NC		<b>1.20.124.019/0000</b>	2 - 140
Contact block with coupling, gold contacts, RJ 12 connector, 1 NC, without LED		1.20.128.001/0000	2 - 147
Fixing spanner for ring nut and front ring		<b>5.05.800.062/0000</b>	5 - 25
Emergency stop label, yellow, round 60 mm, PVC adhesive, without legend		5.76.204.100/0400	2 - 161

**Accessories RAFX 22 QR emergency stop pushbutton, dupe-proof to EN 418**

Description	Photo	Order no.	Page
Emergency stop label, yellow, round 60 mm, PVC adhesive, with legend "NOT-AUS"		5.76.204.101/0400	2 - 161
Emergency stop label, yellow, round 60 mm, PVC adhesive, with legend "ARRET D'URGENCE"		5.76.204.102/0400	2 - 161
Emergency stop label, yellow, round 60 mm, PVC adhesive, with legend "EMERGENCY-STOP"		5.76.204.103/0400	2 - 161
Emergency stop label, yellow 36 x 64 mm, PVC adhesive, without legend		5.76.205.011/0400	2 - 161
Emergency stop label, yellow, round 60 mm, rigid PVC, with legend "EMERGENCY-STOP/ARRET D'URGENCE"		5.76.207.002/0400	2 - 161

For other contact blocks, refer to the chapter „Contact blocks“; for additional accessories, refer to „RAFIX 22 QR special accessories“.

**RAFIX 22 QR emergency stop pushbutton, dupe-proof to EN 418**

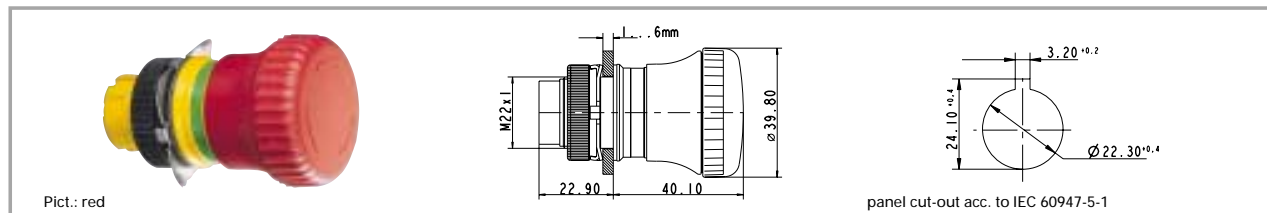

Form of lens	Colour of lens	Illuminability	Operating life	Order no. complete
mushroom formed	opaque red	no	100000	<b>1.30.243.501/0300</b>

Technical data see page 2 - 124

Included: Ring nut with claw.

Switching position indication: In the non-operated condition, a green ring is visible on the side.

**RAFIX 22 QR emergency stop pushbutton, dupe-proof to EN 418, with indication to EN 60947-1**

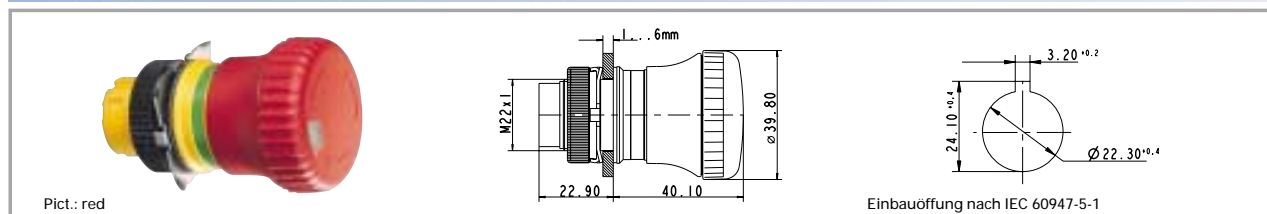

Form of lens	Colour of lens	Illuminability	Operating life	Order no. complete
mushroom formed	opaque red	no	100000	<b>1.30.243.601/0300</b>

Technical data see page 2 - 124

Included: Ring nut with claw.

Switching position indication: In the non-operated condition, a green ring is visible on the side.

This switching position is visible in addition from the front; a mechanical indicator integrated into the mushroom head changes from green to red when actuated.

Control components

Stock items are marked by **bold printed** order numbers.

2 - 125

2

RAFIX 22 QR

**RAFIX 22 QR emergency stop pushbutton, dupe-proof to EN 418, with keylock**

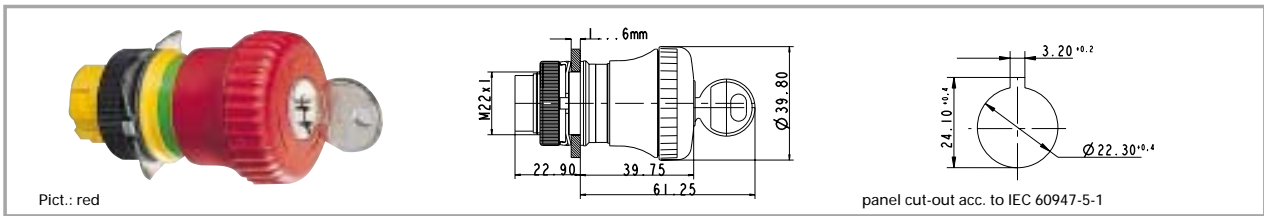

Form of lens	Colour of lens	Illuminability	Operating life	Order no. complete
mushroom formed	opaque red	no	50000	<b>1.30.243.701/0300</b>

2

Technical data see page 2 - 124

Included: Ring nut with claw, 2 keys.

Switching position indication: In the non-operated condition, a green ring is visible on the side. Once actuated, the emergency stop pushbutton can only be reset with the key.

**RAFIX 22 QR emergency stop pushbutton, dupe-proof to EN 418, illuminated**

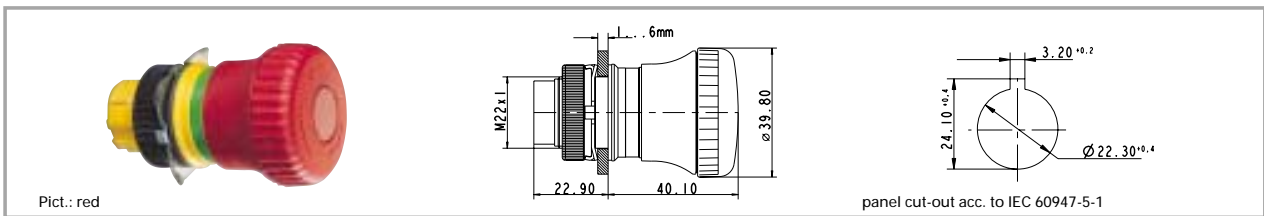

Form of lens	Colour of lens	Illuminability	Operating life	Order no. complete
mushroom formed	opaque red/ translucent red	yes	100000	<b>1.30.243.001/0300</b>

Technical data see page 2 - 124

Included: Ring nut with claw.

Switching position indication: In the non-operated condition, a green ring is visible on the side.

RAFIX  
22 QR