



PART NO.

MCD A/DP Series

REVISIONS

ECN #	REV	DESCRIPTION	DRAWN	DATE	CHECKD	DATE	APPRVD	DATE
-	A	RELEASED	Venkat	07/3/08	Suresh	07/3/08	G. C	21/3/08

MCD A

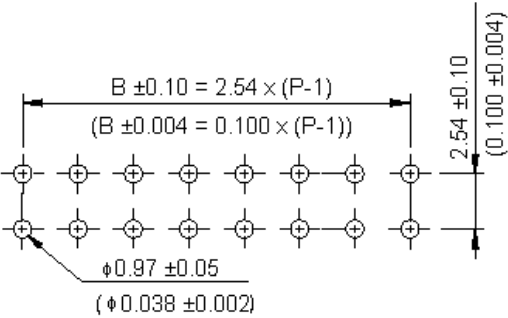
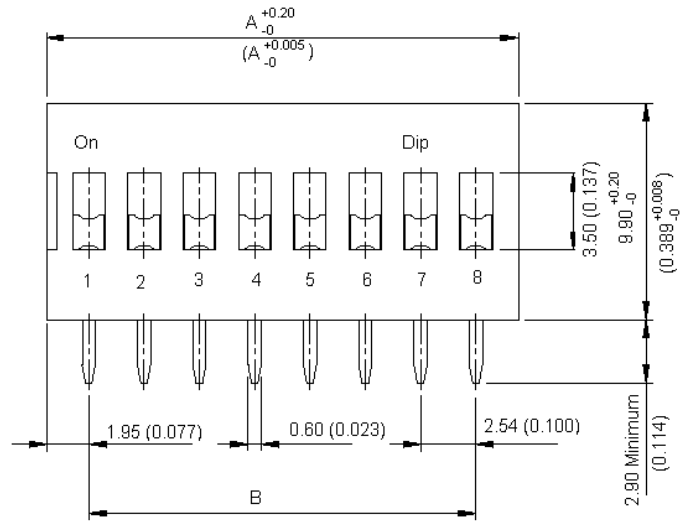
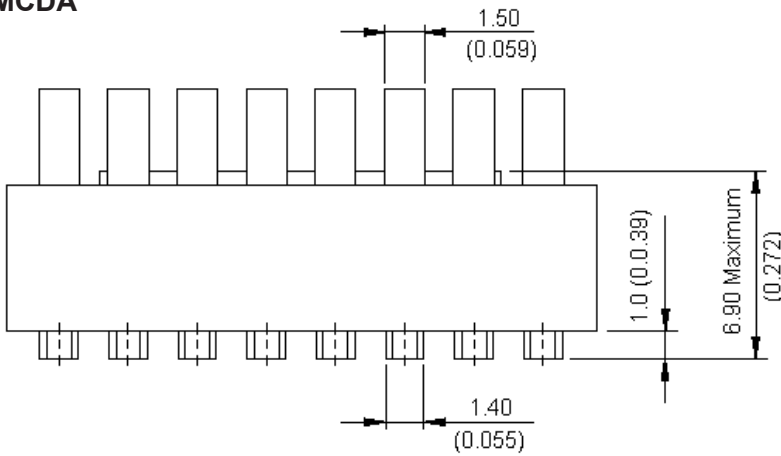

Dimensions : Millimetres (Inches)

PCB Layout

This data sheet and its contents (the "Information") belong to the Premier Farnell Group (the "Group") or are licensed to it. No licence is granted for the use of it other than for information purposes in connection with the products to which it relates. No licence of any intellectual property rights is granted. The Information is subject to change without notice and replaces all data sheets previously supplied. The Information supplied is believed to be accurate but the Group assumes no responsibility for its accuracy or completeness, any error in or omission from it or for any use made of it. Users of this data sheet should check for themselves the Information and the suitability of the products for their purpose and not make any assumptions based on information included or omitted. Liability for loss or damage resulting from any reliance on the Information or use of it (including liability resulting from negligence or where the Group was aware of the possibility of such loss or damage arising) is excluded. This will not operate to limit or restrict the Group's liability for death or personal injury resulting from its negligence. SPC MULTICOMP is the registered trademark of the Group. © Premier Farnell plc 2008.

TOLERANCES:
UNLESS OTHERWISE SPECIFIED, DIMENSIONS ARE FOR REFERENCE PURPOSES ONLY.

DRAWN BY:	DATE:
Venkat	07/03/08
CHECKED BY:	DATE:
Suresh	07/03/08
APPROVED BY:	DATE:
G.Cook	21/03/08

DRAWING TITLE:			
Dual In Line Switches-Right Angle and Piano types			
SIZE	DWG NO.	ELECTRONIC FILE	REV
A	M10000813	DS,DP,DA-V_DWG	A
SCALE: NTS		U.O.M.: mm (Inches)	SHEET: 1 OF 6



PART NO.

MCD,DA-V

REVISIONS

ECN #	REV	DESCRIPTION	DRAWN	DATE	CHECKD	DATE	APPRVD	DATE
-	A	RELEASED	Venkat	07/3/08	Suresh	07/3/08	G. C	21/3/08

Schematic (Typical)



2, 3, 4, 5, 6, 7, 8, 9, 10, 12 Positions Available

Specifications Table

Number of Positions	A	B	Part Number
3	8.98 (0.354)	5.08 (0.200)	MCDA03
5	14.06 (0.554)	10.16 (0.400)	MCDA05
7	19.14 (0.754)	15.24 (0.600)	MCDA07
9	24.22 (0.954)	20.32 (0.800)	MCDA09

Dimensions: Millimetres (Inches)

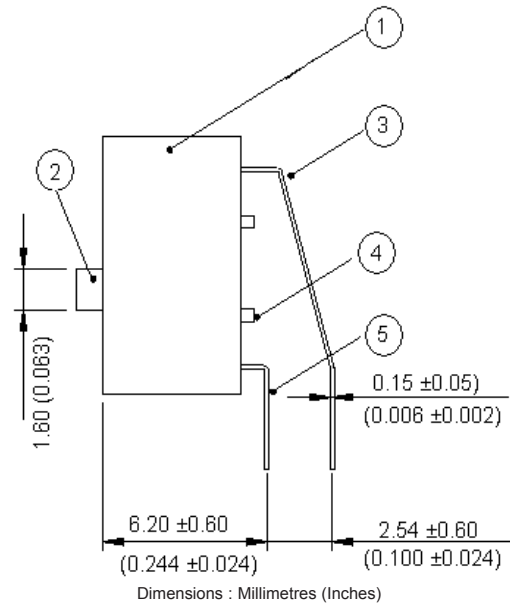

Dimensions : Millimetres (Inches)

This data sheet and its contents (the "Information") belong to the Premier Farnell Group (the "Group") or are licensed to it. No licence is granted for the use of it other than for information purposes in connection with the products to which it relates. No licence of any intellectual property rights is granted. The Information is subject to change without notice and replaces all data sheets previously supplied. The Information supplied is believed to be accurate but the Group assumes no responsibility for its accuracy or completeness, any error in or omission from it or for any use made of it. Users of this data sheet should check for themselves the Information and the suitability of the products for their purpose and not make any assumptions based on information included or omitted. Liability for loss or damage resulting from any reliance on the Information or use of it (including liability resulting from negligence or where the Group was aware of the possibility of such loss or damage arising) is excluded. This will not operate to limit or restrict the Group's liability for death or personal injury resulting from its negligence. SPC MULTICOMP is the registered trademark of the Group. © Premier Farnell plc 2008.

TOLERANCES:
UNLESS OTHERWISE SPECIFIED, DIMENSIONS ARE FOR REFERENCE PURPOSES ONLY.

DRAWN BY:	DATE:
Venkat	07/03/08
CHECKED BY:	DATE:
Suresh	07/03/08
APPROVED BY:	DATE:
G.Cook	21/03/08

DRAWING TITLE:			
Dual In Line Switches-Right Angle and Piano types			
SIZE	DWG NO.	ELECTRONIC FILE	REV
A	M10000813	DS,DP,DA-V_DWG	A
SCALE: NTS		U.O.M.: mm (Inches)	SHEET: 2 OF 6



PART NO.

MCPDA/DP Series

REVISIONS

ECN #	REV	DESCRIPTION	DRAWN	DATE	CHECKD	DATE	APPRVD	DATE
-	A	RELEASED	Venkat	07/3/08	Suresh	07/3/08	G. C	21/3/08

MCDP

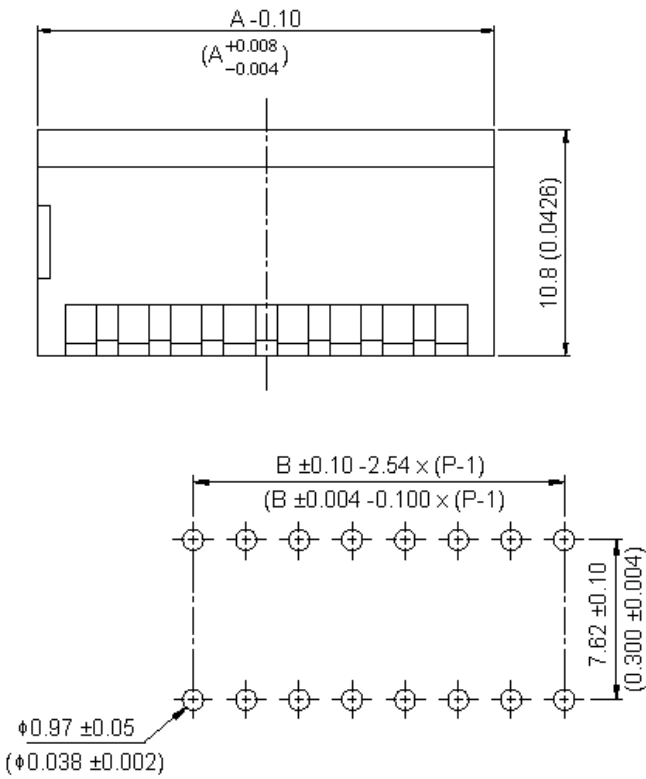

PCB Layout

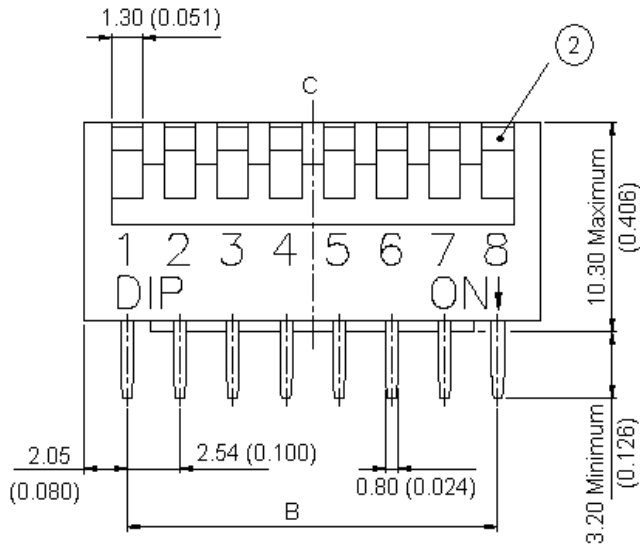

Dimensions: Millimetres (Inches)

This data sheet and its contents (the "Information") belong to the Premier Farnell Group (the "Group") or are licensed to it. No licence is granted for the use of it other than for information purposes in connection with the products to which it relates. No licence of any intellectual property rights is granted. The Information is subject to change without notice and replaces all data sheets previously supplied. The Information supplied is believed to be accurate but the Group assumes no responsibility for its accuracy or completeness, any error in or omission from it or for any use made of it. Users of this data sheet should check for themselves the Information and the suitability of the products for their purpose and not make any assumptions based on information included or omitted. Liability for loss or damage resulting from any reliance on the Information or use of it (including liability resulting from negligence or where the Group was aware of the possibility of such loss or damage arising) is excluded. This will not operate to limit or restrict the Group's liability for death or personal injury resulting from its negligence. SPC MULTICOMP is the registered trademark of the Group. © Premier Farnell plc 2008.

TOLERANCES:
UNLESS OTHERWISE SPECIFIED, DIMENSIONS ARE FOR REFERENCE PURPOSES ONLY.

DRAWN BY:	DATE:
Venkat	07/03/08
CHECKED BY:	DATE:
Suresh	07/03/08
APPROVED BY:	DATE:
G.Cook	21/03/08

DRAWING TITLE:			
Dual In Line Switches-Right Angle and Piano types			
SIZE	DWG NO.	ELECTRONIC FILE	REV
A	M10000813	DS,DP,DA-V_DWG	A
SCALE: NTS		U.O.M.: mm (Inches)	SHEET: 3 OF 6



PART NO.

MCD A/DP Series

REVISIONS

ECN #	REV	DESCRIPTION	DRAWN	DATE	CHECKD	DATE	APPRVD	DATE
-	A	RELEASED	Venkat	07/3/08	Suresh	07/3/08	G. C	21/3/08

Schematic (Typical)

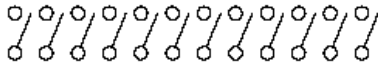

2, 3, 4, 5, 6, 7, 8, 9, 10, 12 Positions Available

Specifications Table

Number of Positions	A	B	Part Number
3	9.18 (0.361)	5.08 (0.200)	MCDP03
5	14.26 (0.561)	10.16 (0.400)	MCDP05
7	19.34 (0.761)	15.24 (0.600)	MCDP07
9	24.42 (0.961)	20.32 (0.800)	MCDP09

Dimensions: Millimetres (Inches)

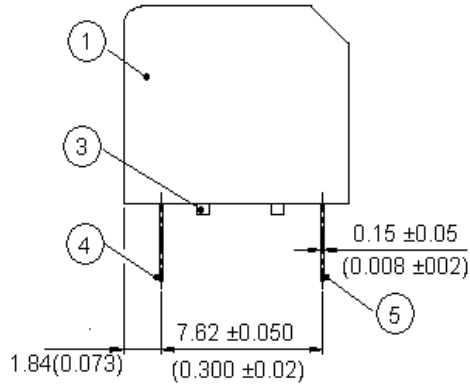

Dimensions: Millimetres (Inches)

This data sheet and its contents (the "Information") belong to the Premier Farnell Group (the "Group") or are licensed to it. No licence is granted for the use of it other than for information purposes in connection with the products to which it relates. No licence of any intellectual property rights is granted. The Information is subject to change without notice and replaces all data sheets previously supplied. The Information supplied is believed to be accurate but the Group assumes no responsibility for its accuracy or completeness, any error in or omission from it or for any use made of it. Users of this data sheet should check for themselves the Information and the suitability of the products for their purpose and not make any assumptions based on information included or omitted. Liability for loss or damage resulting from any reliance on the Information or use of it (including liability resulting from negligence or where the Group was aware of the possibility of such loss or damage arising) is excluded. This will not operate to limit or restrict the Group's liability for death or personal injury resulting from its negligence. SPC MULTICOMP is the registered trademark of the Group. © Premier Farnell plc 2008.

TOLERANCES:

UNLESS OTHERWISE SPECIFIED, DIMENSIONS ARE FOR REFERENCE PURPOSES ONLY.

DRAWN BY:	DATE:
Venkat	07/03/08
CHECKED BY:	DATE:
Suresh	07/03/08
APPROVED BY:	DATE:
G.Cook	21/03/08

DRAWING TITLE:

Dual In Line Switches-Right Angle and Piano types

SIZE A	DWG NO. M10000813	ELECTRONIC FILE DS,DP,DA-V_DWG	REV A
SCALE: NTS	U.O.M.: mm (Inches)	SHEET: 4 OF 6	



PART NO.

MCDA/DP Series

REVISIONS

ECN #	REV	DESCRIPTION	DRAWN	DATE	CHECKD	DATE	APPRVD	DATE
-	A	RELEASED	Venkat	07/3/08	Suresh	07/3/08	G. C	21/3/08

Part Number Explanation

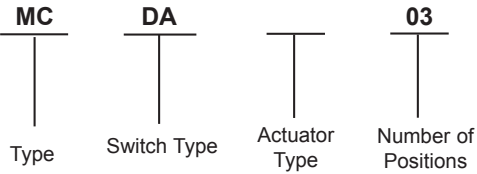

- Switch Type** : DA = Right Angle Type Dip Switch.
 DP = Piano Type Dip Switch.
- Actuator Type** : = Raised Actuator for MCDA series,
 Short Key for MCDP series.
- Number of Positions** : 03 = 3 Positions.
 05 = 5 Positions.
 07 = 7 Positions.
 09 = 9 Positions.

<http://www.farnell.com>
<http://www.newark.com>
<http://www.cpc.co.uk>

This data sheet and its contents (the "Information") belong to the Premier Farnell Group (the "Group") or are licensed to it. No licence is granted for the use of it other than for information purposes in connection with the products to which it relates. No licence of any intellectual property rights is granted. The Information is subject to change without notice and replaces all data sheets previously supplied. The Information supplied is believed to be accurate but the Group assumes no responsibility for its accuracy or completeness, any error in or omission from it or for any use made of it. Users of this data sheet should check for themselves the Information and the suitability of the products for their purpose and not make any assumptions based on information included or omitted. Liability for loss or damage resulting from any reliance on the Information or use of it (including liability resulting from negligence or where the Group was aware of the possibility of such loss or damage arising) is excluded. This will not operate to limit or restrict the Group's liability for death or personal injury resulting from its negligence. SPC MULTICOMP is the registered trademark of the Group. © Premier Farnell plc 2008.

TOLERANCES:
UNLESS OTHERWISE SPECIFIED, DIMENSIONS ARE FOR REFERENCE PURPOSES ONLY.

DRAWN BY:	DATE:
Venkat	07/03/08
CHECKED BY:	DATE:
Suresh	07/03/08
APPROVED BY:	DATE:
G.Cook	21/03/08

DRAWING TITLE:			
Dual In Line Switches-Right Angle and Piano types			
SIZE	DWG NO.	ELECTRONIC FILE	REV
A	M10000813	DS,DP,DA-V_DWG	A
SCALE: NTS		U.O.M.: mm (Inches)	SHEET: 6 OF 6