

MICRO SWITCH
 FREEPORT, ILLINOIS, U.S.A.
 A DIVISION OF HONEYWELL
 FED. MFG. CODE 81929

SWITCH-TOGGLE

CATALOG LISTING
3TL32-1 SERIES
 CHART 1

THIS DRAWING COVERS A PROPRIETARY ITEM AND IS THE PROPERTY OF MICRO SWITCH, A DIVISION OF HONEYWELL. THIS DRAWING IS NOT TO BE COPIED OR USED WITHOUT THE APPROVAL OF MICRO SWITCH.

CATALOG LISTING	CIRCUIT MADE WITH TOGGLE LEVER IN REFER TO (1,2,3-A,B,C,D)		
	KEYWAY SIDE	CENTER	OPPOSITE KEYWAY
9 3TL32-1-3D	A1-A2 C1-C2 D1-D2	A2-A3 C1-C2 D2-D3	A2-A3 C2-C3 D2-D3
2 (6)	ON	ON	ON

ELECTRICAL DATA

28 VDC
10 AMPS RESISTIVE
4 AMPS INDUCTIVE
2 AMPS MOTOR
1 AMP LAMP

L91
 15A 125, 250, 277 VAC
 1/2HP 125 VAC
 1HP 250, 277 VAC
 5A 125 VAC "L"

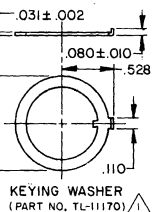
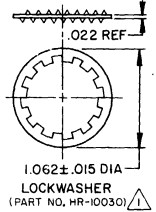
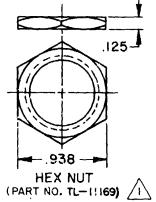

- NOTES
- 1 - EACH FURNISHED UNASSEMBLED
 - 2 - LEVER LOCKED IN ALL POSITIONS FOR 3TL32-1-12A
 - 3 - 28 VOLT T-1 3/4 LAMP PER MS 25237-387 FURNISHED WITH SWITCH
 - 4 - LAMP TERMINALS ARE B4 & B6. 6-32 UNC X .260 REF BINDING HEAD TERMINAL SCREW AND LOCKWASHER (SEMS) ASSEMBLED FOR TERMINALS B1 & B3
 - 5 - SWITCHES ARE CAPABLE OF WITHSTANDING A TEMPERATURE OF 131°F CONTINUOUSLY AT FULL RATED LOAD
 - 6 - MICRO SWITCH CATALOG LISTING STAMPED ON SIDE OF SWITCH
 - 7 - BUSHING IS SEALED TO PREVENT ENTRY OF NON TOXIC LIQUID SPILLS
 - 8 - THIS DIMENSION APPLIES WITH PANEL KEY WASHER INSTALLED ON BUSHING SHOULDER, & WITH 3TL32-1-12A TOGGLE LEVER IN THE CENTER DETENT POSITION
 - 9 - LEVER LOCKED OUT OF CENTER DETENT POSITION FOR 3TL32-1-3D
 - 10 - LAMP TERMINALS ARE SOLDER DIPPED
 - 11 - PRODUCTS BUILT TO ISSUE 9 INCORPORATE THE FOLLOWING COMPONENTS: TL-11526 LEVER, TL-11527 BRACKET, TL-11528 RING, TL-11515 TERMINAL, & TL-11520 TERMINAL

DRAWING NUMBER: 3TL32-1 SERIES CHART 1
 ISBITE: 12
 REVISIONS:
 A 10R 3891
 4 FEB 88
 B PR16550
 5 JUL 88
 C 066577
 27 APR 89
 D 066067
 14 JUN 90
 E 066019
 15 MAY 91
 F 073571
 11 SEP 92
 G 05183
 5 MAY 99
 H 84440
 23 NOV 99
 CHECKED: T.S.K. 24 MAR 87
 DRAWN: T.S.K.
 WEIGHT: 9 OZ MAX
 SCALE: FULL
 DO NOT SCALE PRINT
 UNLESS OTHERWISE SPECIFIED TOLERANCES ARE:
 ONE PLACE (.01) ±.030
 TWO PLACE (.00) ±.015
 THREE PLACE (.000) ±.005
 ANGLES ± 5°