

0600 Lever Switches 1A 250Vac

In house test 1A 250Vac
10A 6/24Vdc

3mm contact gap
Technical data on pages 4 & 5



C0600HD - - -

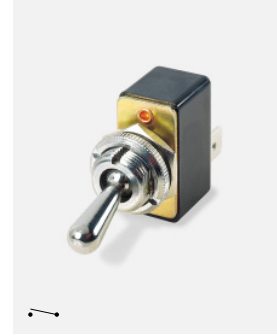

C0600CC - - -

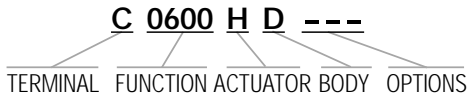

▶ TERMINAL	▶ FUNCTION	▶ ACTUATOR	▶ BODY	▶ OPTIONS
<p>C</p> <p>6.3 x 0.8 10.1</p>	<p>0600</p> <p>ON - OFF</p> <p>0602</p> <p>ON - OFF (momentary ON)</p>	<p>C Chromed brass (0600)</p> <p>15.0</p> <p>U Nylon (0600)</p> <p>12.1</p> <p>G Nylon (0600)</p> <p>27.0</p> <p>H Nylon (0600)</p> <p>17.0</p> <p>S Chromed brass stem/ nylon paddle (0602 only)</p> <p>41.8</p>	<p>D Nylon neck and top plate (Used with actuator codes U, G and H)</p> <p>C Metal neck and top plate (Used with actuator codes C and S)</p> <p>1.3 ø12.7 11.1</p> <p>Panel thickness - 3.5mm Back nut must be fitted</p> <p>Fixing nuts (Standard is M506 & T92)</p> <p>T5 Hex brass 15.2</p> <p>M506 Hex nylon 3.0 (M506) 2.0 (T5)</p> <p>T92 Knurled brass 16.0 2.6</p> <p>M279 Knurled nylon 16.2 4.1</p>	<p>Cover M331 (C Actuator only)</p> <p>Seal M539 (C,H & U Actuators) Actuator visible</p> <p>Cover M1080 (C Actuator only)</p> <p>Covers have internal nylon nuts</p>

Dimensions (mm)

0600 (U actuator shown)

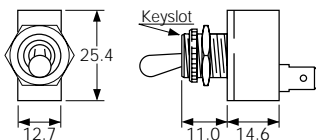

0602

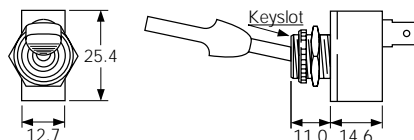



C3900BA ---



C3920BA ---



C3950BB ---



C3972BB ---



Guard R17-10

Anti-rotation tab can be specified for guard fitted in On or Off position

BODY

A

Without terminal barrier
Single pole

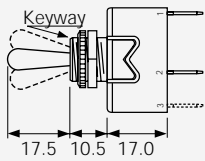

B

With terminal barrier
Double pole only

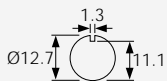
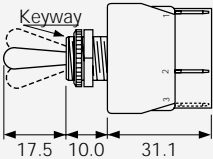

Panel hole (all types)

OPTIONS

Neck Seal M539

Actuator is visible



Cover M1080



Covers have internal nylon nuts

Fixing nuts

Nickel plated brass are supplied

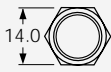

Hex Back nut



Knurled Front nut

Panel thickness 4.0 with backnut

DIMENSIONS (mm) * Indicates ON position (for On - Off switches)

Single Pole

(C terminals shown)

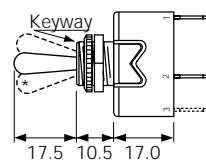
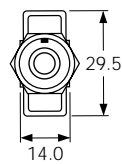

Optional P232 plate
SP or DP

Double Pole

(C terminals shown)

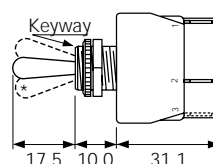
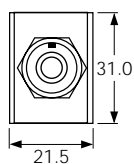



C1700RO ---



C1700HO ---

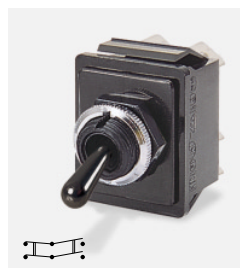

C1760RO ---



C1750HO ---

BODY

0
Single pole

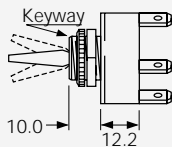

0
Double pole

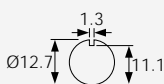
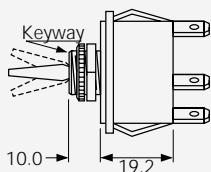

Panel hole (all types)

Panel thickness (Max)
Both nuts - 3.5mm
Less backnut - 6.5mm

OPTIONS

Neck Seal M539

Rubber -57T145
(H & R Actuators)
Actuator visible



Cover M1080

Rubber -57T145
(R Actuator only)



Cover M331

PVC -5T85
(R Actuator only)



Covers have internal nylon nuts

Fixing nuts (Standard is M506 & T92)

T5 Hex brass
M506 Hex nylon

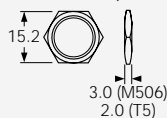

T92 Knurled brass

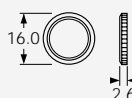

M279 Knurled nylon

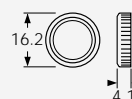

DIMENSIONS (mm)

Single Pole

(C terminals shown)

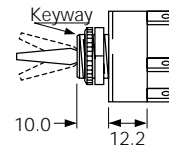
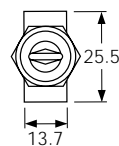

Optional
P232 plate
SP or DP

Double Pole

(C terminals shown)

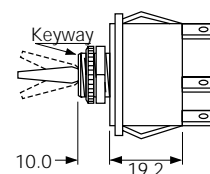
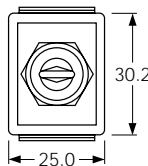

Optional terminal barrier M441 is available