

multimec® 3F + 1D/1E/1F

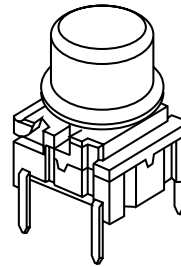

Technical Data:

- through-hole or SMD
- 50mA/24VDC
- single pole/momentary
- 10.000.000 operations life time
- IP67 sealing
- temperature range:
low temp: -40/+115°C
high temp: -40/+160°C

Dimensions (through-hole)

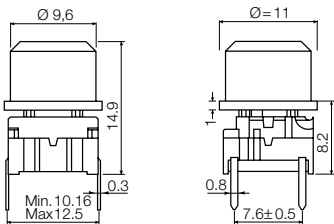

PCB layout

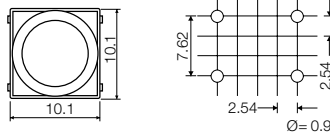

Dimensions (w/LED)

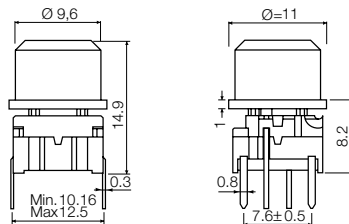

PCB layout

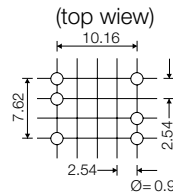

Dimensions (SMD)

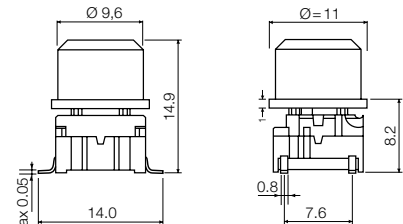

PCB layout

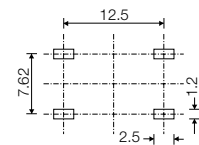

HOW TO ORDER

3 F

Switch

Mounting

T through-hole
S surface mount

L 6 low temp.
H 9 high temp.

+

1 D

Cap



00 blue
02 green
03 grey
04 yellow
06 white
08 red
09 black

30 ultra blue
40 dusty blue
42 aqua blue
32 mint green
33 tele grey
34 melon
38 noble red

50 metal dark blue
53 metal light grey
57 metal dark grey
58 metal bordeaux

Standard versions:

3FTL6
3FTH9
3FSH9
3FSH9R

3 F

Switch

T

Mounting

T through-hole

L 6 low temp.
H 9 high temp.

LED

00 blue
20 green
40 yellow
80 red
2040 green/yellow
8020 red/green
8040 red/yellow

Cap 1D



Cap 1E



Cap 1F



1 1

transparent

Lens

Standard versions:

3FTL600
3FTL620
3FTL640
3FTL680
3FTL62040
3FTL68020
3FTL68040

00 blue
02 green
03 grey
04 yellow
06 white
08 red
09 black

1 transparent
2 green
4 yellow
8 red

Ordering example: 3FTL620 + 1E032

mec · Industriparken 23 · P.o. Box 26 · DK-2750 Ballerup · Denmark

Tel.: +45 44 97 33 66 · Fax: +45 44 68 15 14 · Web: www.mec.dk · E-mail: danmec@mec.dk

multimec® 3F + 1K + 2K

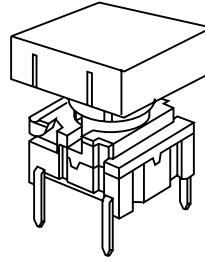
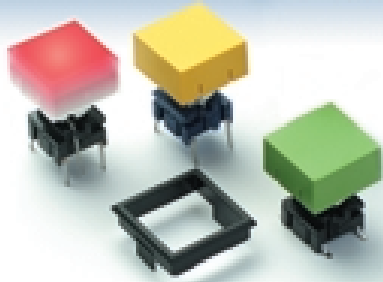

Technical Data:

- through-hole or SMD
- 50mA/24VDC
- single pole/momentary
- 10.000.000 operations life time
- IP67 sealing
- temperature range:
low temp: -40/+115°C
high temp: -40/+160°C

Dimensions (through-hole)

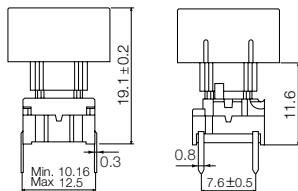

PCB layout

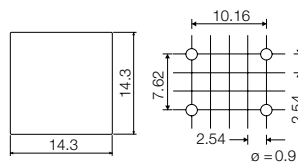

Dimensions (w/LED)

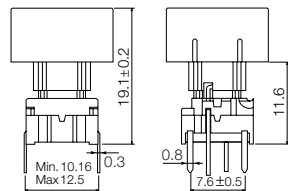

PCB layout
(top view)

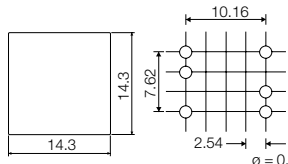

Dimensions (SMD)

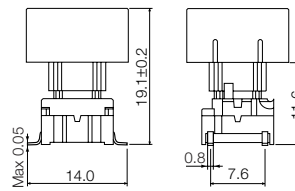

PCB layout

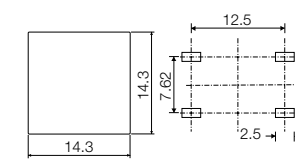

Dimensions (Bezel) (Optional)

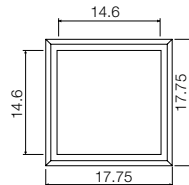
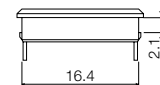

HOW TO ORDER

3 F

Switch



Mounting

T through-hole
S surface mount



L 6 low temp.
H 9 high temp.

+

1 K

1 6

Cap

00 blue
02 green
03 grey
04 yellow
06 white
08 red
09 black

+

2 K

Bezel

03 grey
06 white
08 red
09 black

Standard versions:

3FTL6
3FTH9
3FSH9
3FSH9R

3 F

Switch



Mounting

T through-hole



L 6 low temp.
H 9 high temp.

+

1 K

1 1 1 6

Cap

transparent

+

2 K

Bezel

03 grey
06 white
08 red
09 black

Standard versions:

3FTL622
3FTL644
3FTL688

Ordering example: 3FTL688 + 1K1116

mec Industriparken 23 · P.o. Box 26 · DK-2750 Ballerup · Denmark

Tel.: +45 44 97 33 66 · Fax: +45 44 68 15 14 · E-mail: danmec@mec.dk · www.mec.dk.

multimec® 3F + 1P/1Q/1R

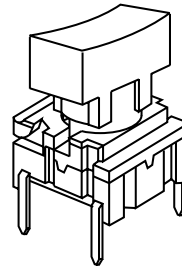

Technical Data:

- through-hole or SMD
- 50mA/24VDC
- single pole/momentary
- 10.000.000 operations life time
- IP67 sealing
- temperature range:
low temp: -40/+115°C
high temp: -40/+160°C

Dimensions (through-hole)

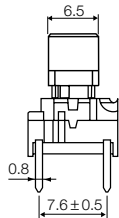
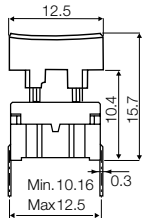

PCB layout

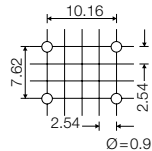
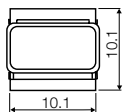

Dimensions (w/LED)

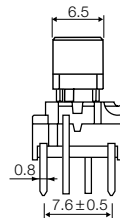
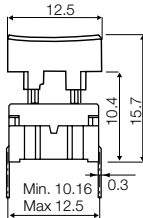

PCB layout

(top view)

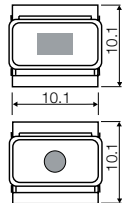
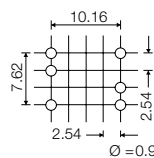

Dimensions (SMD)

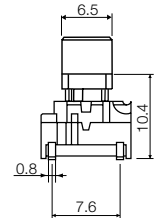
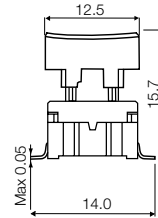

PCB layout

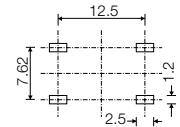
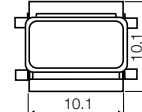

How to order

3 F

Switch



Mounting

T through-hole
S surface mount



L 6 low temp.
H 9 high temp.

+

1 P

Cap



00 blue
02 green
03 grey
04 yellow
06 white
08 red
09 black

Standard versions:

3FTL6
3FTH9
3FSH9
3FSH9R

3 F

Switch



Mounting

T through-hole



L 6 low temp.
H 9 high temp.



LED

00 blue
20 green
40 yellow
80 red
2040 green/yellow
8020 red/green
8040 red/yellow

+

1 Q

Cap



00 blue
03 grey
08 red
09 black

1

Lens

1 transparent

Standard versions:

3FTL600
3FTL620
3FTL640
3FTL680
3FTL62040
3FTL68020
3FTL68040

Ordering example: 3FTL680 + 1Q091

mec · Industriparken 23 · P.o. Box 26 · DK-2750 Ballerup · Denmark

Tel.: +45 44 97 33 66 · Fax: +45 44 68 15 14 · Web: www.mec.dk · E-mail: danmec@mec.dk

multimec® RAS + 1D/1K/1P/1S

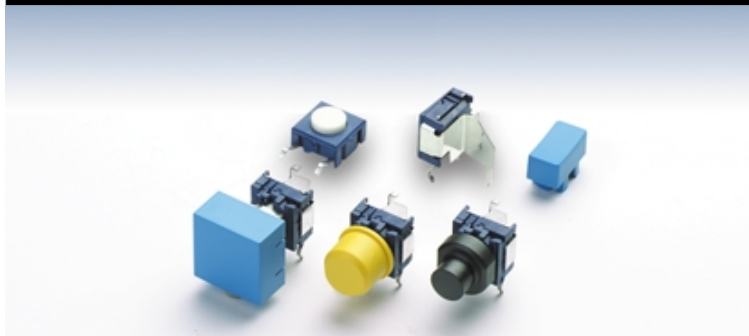

Technical Data:

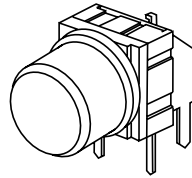

- through-hole only
- 50mA/24VDC
- single pole/momentary
- 10.000.000 operations life time
- IP67 sealing
- temperature range:
low temp: -40/+115°C

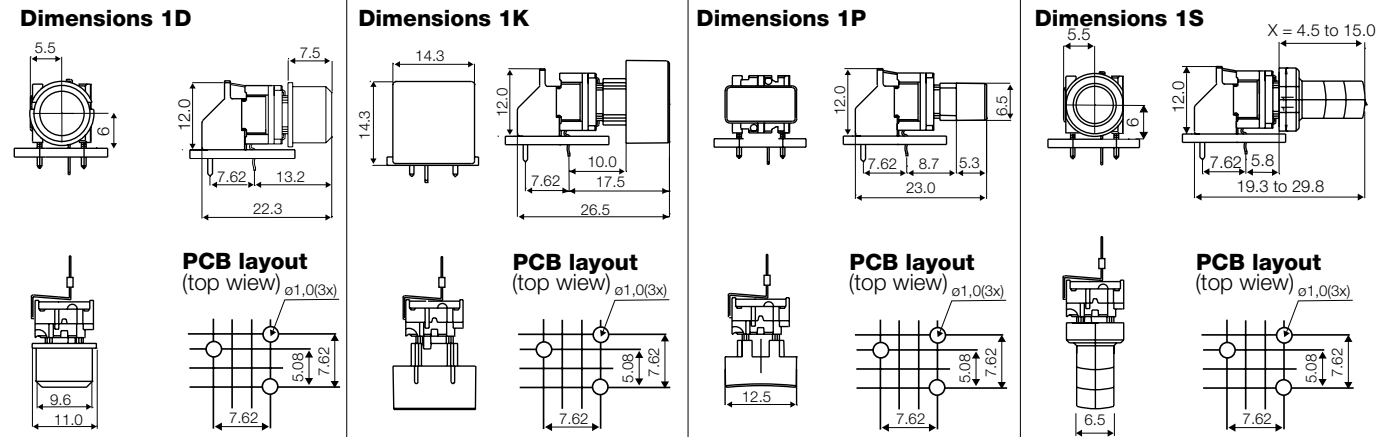

HOW TO ORDER

| | | | | | | |
|---------------|-----------------------------------|----------------------|---------------------|--------------------|------------------|----------------------|
| 3 F | T | L 6 | R A S + | 1 D | | |
| Switch | Mounting T through-hole | L 6 low temp. | Right angle support | Cap | 00 blue | 30 ultra blue |
| | | | | | 02 green | 40 dusty blue |
| | | | | | 03 grey | 42 aqua blue |
| | | | | | 04 yellow | 32 mint green |
| | | | | | 06 white | 33 tele grey |
| | | | | | 08 red | 34 melon |
| | | | | | 09 black | 38 noble red |
| | | | | 1 P | | |
| | | | | Cap | 00 blue | |
| | | | | | 03 grey | |
| | | | | | 08 red | |
| | | | | | 09 black | |
| | | | | 1 K | 1 6 | + 2 K |
| | | | | Cap | 00 blue | Bezel 03 grey |
| | | | | | 02 green | 06 white |
| | | | | | 03 grey | 08 red |
| | | | | | 04 yellow | 09 black |
| | | | | | 06 white | |
| | | | | | 08 red | |
| | | | | | 09 black | |
| | | | | 1 S 0 9 - . | Cap black | H |
| | | | | | | 16.0 |
| | | | | | | 19.0 |
| | | | | | | 22.5 |
| | | | | | | X * |
| | | | | | | 8.5 |
| | | | | | | 11.5 |
| | | | | | | 15.0 |

Standard versions:

3FTL6RAS, 3CTL6RAS,

*Any cap height X from 8.5 to 15.0 mm is available. Please order 1S09-H, where H = X+7.5 mm

Min. order Qty for custom heights is 2.000 pcs. A start-up charge will apply.

3CTL6 also available as right angle switch 3CTL6RAS. Please see multimec basic switch modules.

Ordering example: 3FTL6RAS + 1K0016 + 2K03

mec · Industriparken 23 · P.o. Box 26 · DK-2750 Ballerup · Denmark

Tel.: +45 44 97 33 66 · Fax: +45 44 68 15 14 · Web: www.mec.dk · E-mail: danmec@mec.dk

multimec® basic switch modules

| Through-hole Version | | | | | | |
|--|------------------|----------------------|----------------------|--|-------------------------------------|---------------------------|
| 3A | | 3C | 3E | 3F | | |
| For 1A/1B/1M | w/LED for 1C/1H | | | For 1D/1K/1N/1P/1S/1T/ 1U/1V/1X/1GA/1GC | w/LED for 1E/1F/1N/1Q/1R/1S/1X | w/LED for 1K1116/1T/1U/1V |
| | | | | | | |
| Standard Versions | | | | | | |
| 3ATL6 3ATH9 | 3ATL600/20/40/80 | 3CTL6/3CTL9 3CTH9 | 3ETL9-H* 3ETH9-H* | 3FTL6 3FTH9 | 3FTL600/20/40/80/ 2040/8020/8040 | 3FTL623/44/88 |
| * 3E available in 6 standard heights: 08.0, 09.5, 10.4, 11.0, 12.0, 15.0 mm Other heights between 08.0 and 15.0 mm are available upon request | | | | | | |
| Specials: Gold contacts, quiet version and actuation force other than 3.0N | | | | | | |

| Surface Mount Versions | | | |
|------------------------|--------------|--------------|--|
| 3A | 3C | 3E | 3F |
| | | | |
| 3ASH9/3ASH9R | 3CSH9/3CSH9R | 3ESH9/3ESH9R | 3FSH9 / 3FSH9R |
| For 1A/1B/1M | | | For 1D/1K/1N/1P/1S/1T/ 1U/1V/1X/1GA/1GC |

| Right Angle Versions | |
|----------------------|-----------------|
| 3C | 3F |
| | |
| 3CTL6RAS | 3FTL6RAS |
| | For 1D/1K/1P/1S |

multimec® Cross Section

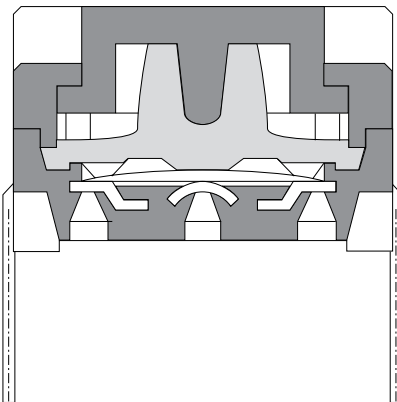

DIMENSIONS (mm) Unless otherwise specified, all tolerances ± 0.2

Recommended PCB layout

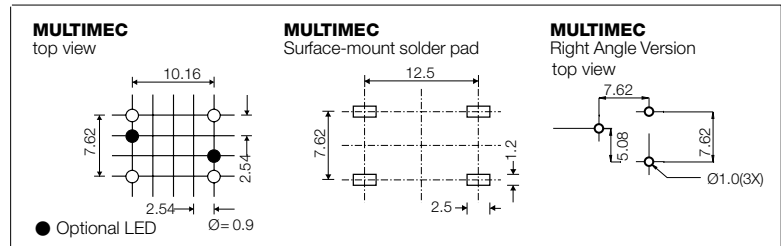

Operating Force
(Typical example)

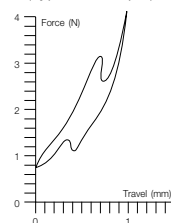

Circuit diagram

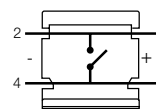

multimec® technical specifications

| | Low Temperature Versions | | High Temperature Versions | |
|--|---|-------------------------------|--|-------------------------------|
| | Silver | Gold | Silver | Gold |
| Electrical Specifications | | | | |
| Contact resistance | <30 m Ω - typically 10m Ω | | | |
| Insulation resistance | >10M Ω | | | |
| Recommended load | 0.5-50mA 24VDC | 0.5μ-50mA 24VDC | 0.5-50mA 24VDC | 0.5μ-50mA 24VDC |
| Contact bounce | <2mS - typically 0.5mS | | | |
| Mechanical Specifications | | | | |
| Standard actuation force (switch) | 3.0N typ. | | | |
| Max. actuation force without cap | 100N for 10 sec. | | | |
| Key travel (switch) | 1 mm | | | |
| Life time (switch) | >10.000.000 cycles | | | |
| Temperature Range | | | | |
| Working temperature | Min. -40°C Max. +115°C | | Min. -40°C Max. +160°C | |
| Storage temperature | Min. -40°C Max. +115°C | | Min. -40°C Max. +160°C | |
| Soldering IEC 68-2-20 | Wave -max. 260°C for max. 10 sec., please refer to usage guidelines | | Infrared, vapour phase, wave - max. 260°C for max. 30 sec. | |
| | Soldering iron - max. 350°C for max. 3 sec. Flux tight. | | Soldering iron - max. 350°C for max. 3 sec. Flux tight. | |
| Environmental Endurance IEC-68-2-3 | | | | |
| Temperature | +40°C | | | |
| Humidity | 93% RH | | | |
| Duration | 56 Days | | | |
| Temperature Cycling IEC 68-2-14 | | | | |
| Temperature limit | Min. -55°C - Max. +85°C | | | |
| Number of cycles | 200 | | | |
| Exposure time at each temperature | 10 min. | | | |
| Recovery time before measurements | 16 hrs. | | | |
| Sealing IEC 529 | IP-67 | | | |
| Cleaning | Standard methods such as freon and water | | | |
| Material Specifications - Switches | | | | |
| Housing | PBT UL94VO | | PPS UL94VO | |
| Actuator | PBT UL94VO | | PPS UL94VO | |
| Sealing + spring | Silicone rubber | | | |
| Contact spring | Stainless steel + 3μAg | Stainless steel + 3μAg + 1μAu | Stainless steel + 3μAg | Stainless steel + 3μAg + 1μAu |
| Fixed Contacts | SnCu + 2μNi + 3μAg | SnCu + 2μNi + 3μAg + 1μAu | SnCu + 2μNi + 3μAg | SnCu + 2μNi + 3μAg + 1μAu |
| Terminals | SnCu + 2μNi + 3μSnPb | SnCu + 2μNi + 3μSnPb | SnCu + 2μNi + 3μSnPb | SnCu + 2μNi + 3μSnPb |
| Material Specifications - Caps & Bezels | | | | |
| Material | Parts | Temp limit | UL rating | |
| ABS Standard | Standard parts except the below mentioned | Max 65°C | UL94HB | |
| Polycarbonate | All lenses | Max. 85°C | UL94V1 | |
| LCP | Actuator of 3E | Max. 160°C | UL94VO | |
| PPS | 1S, 2S | Max. 160°C | UL94VO | |
| Polyamide | Actuator of Varimec , 1GA/ 1GC | Max. 160°C | UL94VO | |
| Legends Adhesion | ISO Class.: 1/ ASTM Class.: 4B DIN EN ISO 2409 | | | |

Specifications are subject to change without notice

Existing and New Part Nos. for Lead Free, RoHS compatible and Proces compatible mec products

MULTIMEC

| Part No. | Part Name | Lead Free | RoHS Comp. | Proces Comp. | New Part No. Comments | Lead Free | RoHS Comp. | Proces Comp. | UL |
|-------------|-----------------------------------|-----------|------------|--------------|-----------------------|-----------|------------|--------------|----|
| 3ASH9 | Switch Surface Ag/High Temp | N | N | Y | RA3ASH9 | Y | Y | Y | V0 |
| 3AXXXG | All 3A Switches with Au | N | N | Y | RA3AXXXG | Y | Y | Y | V0 |
| 3AXXXQ | All 3A Quiet Switches | N | N | Y | RA3AXXXQ | Y | Y | Y | VO |
| 3ASH9R | All 3A Switches delivered on Tape | N | N | Y | RA3ASH9R | Y | Y | Y | V0 |
| 3ATH9 | Switch Th Ag/High Temp. | N | N | Y | RA3ATH9 | Y | Y | Y | V0 |
| 3ATL6 | Switch Th Ag/White But/Low Temp. | N | N | Y | RA3ATL6 | Y | Y | Y | V0 |
| 3ATL6 w/LED | Switch Th Ag/Low Temp w/LED | N | N | Y | RA3ATL6 w/LED | Y | Y | Y | V0 |
| 3CSH9 | Switch Surface Ag/High Temp. | N | N | Y | RA3CSH9 | Y | Y | Y | V0 |
| 3CXXXG | All 3C Switches with Au | N | N | Y | RA3CXXXG | Y | Y | Y | V0 |
| 3CXXXQ | All 3C Quiet Switches | N | N | Y | RA3CXXXQ | Y | Y | Y | V0 |
| 3CSH9R | All 3C Switches delivered on Tape | N | N | Y | RA3CSH9R | Y | Y | Y | V0 |
| 3CTH9 | Switch Th Ag/High Temp | N | N | Y | RA3CTH9 | Y | Y | Y | V0 |
| 3CTL6 | Switch Th/White But/Low Temp | N | N | Y | RA3CTL6 | Y | Y | Y | V0 |
| 3CTL6-2SL | Switch Low Temp. 2 Straight Legs | N | N | Y | RA3CTL6-2SL | Y | Y | Y | V0 |
| 3CTL6RAS | Right Angle Switch Low Temp. | N | N | Y | RA3CTL6RAS | Y | Y | Y | V0 |
| 3CTL9 | Switch Th Ag/Black But/Low Temp | N | N | Y | RA3CTL9 | Y | Y | Y | V0 |
| 3ESH9 | Switch Surface Ag High Temp. | N | N | Y | RA3ESH9 | Y | Y | Y | V0 |
| 3ESH9-XX.X | Switch Ag/High Temp./w Actuator | N | N | Y | RA3ESH9-XX.X | Y | Y | Y | V0 |
| 3EXXXG | All 3E Switches with Au | N | N | Y | RA3EXXXG | Y | Y | Y | V0 |
| 3EXXXQ | All 3E Quiet Switches | N | N | Y | RA3EXXXQ | Y | Y | Y | V0 |
| 3ESH9R | All 3E Switches delivered on Tape | N | N | Y | RA3ESH9R | Y | Y | Y | V0 |
| 3ETH9 | Switch Th Ag High Temp. | N | N | Y | RA3ETH9 | Y | Y | Y | V0 |

041213

1/4

| | | | | | | | | | |
|-------------|------------------------------------|---|---|---|---------------------------|---|---|---|----|
| 3ETH9-XX.X | Switch Th Ag/High Temp. w/Actuator | N | N | Y | RA3ETH9-XX.X | Y | Y | Y | V0 |
| 3ETL9 | Switch Th Ag/Low Temp. | N | N | Y | RA3ETL9 | Y | Y | Y | V0 |
| 3ETL9-XX.X | Switch Th Ag/Low Temp. w/Actuator | N | N | Y | RA3ETL9-XX.X | Y | Y | Y | V0 |
| 3FSH9 | Switch Surface Ag/High Temp. | N | N | Y | RA3FSH9 | Y | Y | Y | V0 |
| 3FXXXG | All 3F Switches with Au | N | N | Y | RA3FXXXG | Y | Y | Y | V0 |
| 3FXXXQ | All 3F Quiet Switches | N | N | Y | RA3FXXXQ | Y | Y | Y | V0 |
| 3FSH9R | All 3F Switches delivered on Tape | N | N | Y | RA3FSH9R | Y | Y | Y | V0 |
| 3FTH9 | Switch Th Ag/High Temp. | N | N | Y | RA3FTH9 | Y | Y | Y | V0 |
| 3FTH9 w/LED | Switch Th High Temp w/ LED | N | N | Y | RA3FTH9 w/LED | Y | Y | Y | V0 |
| 3FTL6 | Switch Th Ag/Low Temp. | N | N | Y | RA3FTL6 | Y | Y | Y | V0 |
| 3FTL6 w/LED | Switch Th Ag/Low Temp w/LED | N | N | Y | RA3FTL6 w/LED | Y | Y | Y | V0 |
| 3FTL6-2SL | Switch Low Temp. 2 Straight Legs | N | N | Y | RA3FTL6-2SL | Y | Y | Y | V0 |
| 3FTL6RAS | Right Angle Switch Low Temp. | N | N | Y | RA3FTL6RAS | Y | Y | Y | V0 |
| 1CXXXX | Leds for 1C or 1H Button | N | N | N | RA1CXXXX | Y | Y | Y | |
| 2BXXXX | Leds for 2B Bezel | N | N | N | RA2BXXXX | Y | Y | Y | |
| 3FXXXXX | Leds Bent for 3F | N | N | N | RA3FXXXXX | Y | Y | Y | |
| 1AXX | DI Buttons all colours for 3A | Y | Y | N | No change, pls see note 1 | | | | HB |
| 1BXX | DI Buttons f. Bezels all colours | Y | Y | N | No change, pls see note 1 | | | | HB |
| 1CXXX | DI Buttons w/Lens all colours | Y | Y | N | No change, pls see note 1 | | | | HB |
| 1DXX | Lk Buttons all colours | Y | Y | N | No change, pls see note 1 | | | | HB |
| 1EXXX | Lk Buttons w/Lens all colours | Y | Y | N | No change, pls see note 1 | | | | HB |
| 1FXXX | Lk Buttons w/Lens all colours | Y | Y | N | No change, pls see note 1 | | | | HB |
| 1GA09 | Cap black 11 | Y | Y | Y | No change | | | | V0 |
| 1GC09 | Cap black 15 | Y | Y | Y | No change | | | | V0 |
| 1HXXX | DI Buttons w/Lens all colours | Y | Y | N | No change, pls see note 1 | | | | HB |
| 1KXX | Lk Lid all colours | Y | Y | N | No change, pls see note 1 | | | | HB |
| 1KXX16 | Lid all colours/Lens/Reflector | Y | Y | N | No change, pls see note 1 | | | | HB |

041213

2/4

| | | | | | | | | |
|------------|--------------------------------------|---|---|---|---------------------------|--|--|----|
| 1KXX1 | Lens Milky White For 1K Button | Y | Y | N | No change, pls see note 1 | | | HB |
| 1KXXX6 | Reflector For 1K Button White | Y | Y | N | No change, pls see note 1 | | | HB |
| 1MXX | DI Button Double Width all colours | Y | Y | N | No change, pls see note 1 | | | HB |
| 1NXX | Teardrop Buttons all colours | Y | Y | N | No change, pls see note 1 | | | HB |
| 1PXX | Gf Buttons all colours | Y | Y | N | No change, pls see note 1 | | | HB |
| 1QXXX | 1P But. W/Square Hole, all colours | Y | Y | N | No change, pls see note 1 | | | HB |
| 1RXXX | 1P Button w/Round Hole, all colours | Y | Y | N | No change, pls see note 1 | | | HB |
| 1S09-XX.X | Lk Button Black, all heights | Y | Y | Y | No change | | | V0 |
| 1S11-XX.X | Lk Button Transparent, all heights | Y | Y | N | No change, pls see note 2 | | | V1 |
| 1TXX | Sq. Button, all colours | Y | Y | N | No change, pls see note 1 | | | HB |
| 1UXX | Round Button, all colours | Y | Y | N | No change, pls see note 1 | | | HB |
| 1VXX | Arrow Button, all colours | Y | Y | N | No change, pls see note 1 | | | HB |
| 1X XX | Rectangular Button, all colours | Y | Y | N | No change, pls see note 1 | | | HB |
| 1ZAXX | DL Button, all colours | Y | Y | N | No change, pls see note 1 | | | HB |
| 1ZBXX | Curved Button, all colours | Y | Y | N | No change, pls see note 1 | | | HB |
| 1ZCXX | Round Button, all colours | Y | Y | N | No change, pls see note 1 | | | HB |
| 3E-XX.X | Actuator f. 3E Switch, all heights | Y | Y | Y | No change | | | V0 |
| 3E-AXXXX | Varimec cap 5.2 Round, all heights | Y | Y | Y | No change | | | V0 |
| 3E-BXXXX | Varimec cap 5.2 Square, all heights | Y | Y | Y | No change | | | V0 |
| 3E-EXXXX | Varimec cap 7.8 Round, all heights | Y | Y | Y | No change | | | V0 |
| 3E-FXXXX | Varimec cap 7.8 Square, all heights | Y | Y | Y | No change | | | V0 |
| 3E-KXXXX | Varimec cap 11.6 Round, all heights | Y | Y | Y | No change | | | V0 |
| 3E-LXXXX | Varimec cap 11.6 Square, all heights | Y | Y | Y | No change | | | V0 |
| AQB01XX | Sealing Boot (incl. Sea.ring) | Y | Y | Y | No change | | | |
| AQB0111 | Sealing Boot Trans. (incl. Sea.ring) | Y | Y | Y | No change | | | |
| AQC09-XX.X | Cap Black, all overall heights | Y | Y | Y | No change | | | V0 |
| AQC11-XX.X | Cap Trans. all overall heights | Y | Y | N | No change, pls see note 2 | | | V1 |

| | | | | | | | | |
|-----------|---------------------------------------|---|---|---|---------------------------|--|--|----|
| AQN-X.X | Bushing, all heights | Y | Y | Y | No change | | | |
| 1CXXX | Lens f. 1C/1H/1Q Buttons, all colours | Y | Y | N | No change, pls see note 2 | | | V1 |
| 1EXXX | Lens f. 1E Buttons, all colours | Y | Y | N | No change, pls see note 2 | | | V1 |
| 1FXXX | Lens f. 1F Buttons, all colours | Y | Y | N | No change, pls see note 2 | | | V1 |
| 1RXX1 | Round Transparent Lens For 1R | Y | Y | N | No change, pls see note 2 | | | V1 |
| 2AXX | DI Bezel, all colours | Y | Y | N | No change, pls see note 1 | | | HB |
| 2BXXX | Bezel/Lens, all colours | Y | Y | N | No change, pls see note 1 | | | HB |
| 2BXXX | Lens f. 2B Bezel, all colours | Y | Y | N | No change, pls see note 2 | | | V1 |
| 2KXX | Lk Bezel f. 1K, all colours | Y | Y | N | No change, pls see note 1 | | | HB |
| 2RAS | Right Angle Support. | Y | Y | Y | No change | | | |
| 2S09-XX.X | Extender, Black Pps, all heights | Y | Y | Y | No change | | | V0 |
| 1A09DXXX | Button 1A Down/all legends | Y | Y | N | No change, pls see note 1 | | | HB |
| 1A09UXXX | Button 1A Up/all legends | Y | Y | N | No change, pls see note 1 | | | HB |
| 1B09DXXX | Button 1b Down/0 | Y | Y | N | No change, pls see note 1 | | | HB |
| 1B09UXXX | Button 1B Up/all legends | Y | Y | N | No change, pls see note 1 | | | HB |
| 1D09XXX | Round Button/all legends | Y | Y | N | No change, pls see note 1 | | | HB |
| 1F096XXX | 1F Button/Inverse legends | Y | Y | N | No change, pls see note 1 | | | HB |
| 1ZB09DXXX | Button 1ZB09 Down / all legends | Y | Y | N | No change, pls see note 1 | | | HB |
| 1ZC09XXX | Button 1ZC09 / all legends | Y | Y | N | No change, pls see note 1 | | | HB |

Note 1: Complies with RoHS, however plastic material limited to 65°C.
Accessories must be mounted after soldering.

Note 2: Complies with RoHS, however plastic material is limited to 85°C,
so excessive proces heat must be avoided.

041213

041213