

# Solid state relays - GA1 and GA8 range

- PCB-mountable (flat pack = GA1, SIP = GA8)
- Rating: 4 A-5 A
- Peak voltage: 600 V
- Will withstand a 1-cycle 100 A surge
- TRIAC outputs
- UL - cUL 3 A approval and CE marking
- Zero voltage or instantaneous switching (5A only)
- Input to output insulation voltage: 4000 V
- Protection by RC filter

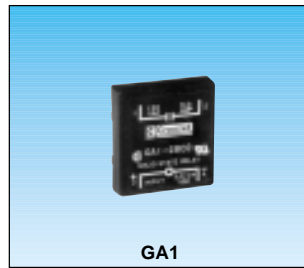

GA1

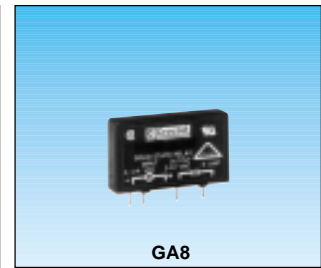

GA8

## Output specifications

	24-280	24-280
Voltage range (Vrms)	24-280	24-280
Peak voltage (Vpeak)	600	850
Maximum current (Vpeak)	4 or 5 depending on part no.	3
Minimum current (Vpeak)	0.05	0.05
Max. 1-cycle surge (Apeak)	100	100
Maximum off-state leakage (mA rms)	6	6
On-state voltage drop at Imax and T = 25°C (V peak)	1.6	1.65
Static (off-state) dv/dt (V/μs)	200	200
Maximum response time (close)	0.5 cycle	0.5 cycle
Supply frequency range	47 to 63	47 to 63

## Input specifications

Input voltage (V)	3-32 $\equiv$
Drop-out voltage (V $\equiv$ )	1
Maximum current at Vmax (mA)	25
Nominal input resistance (kΩ)	regulated

## Characteristics

Operating temperature (°C)	-30 to +80
Storage temperature (°C)	-40 to +100
Input to output insulation voltage (Vrms)	4000
Input/output capacitance (pF)	8
Weight (g)	15

## Zero voltage switching

Rating	Range	Output voltage	Input voltage	
4 A	GA 1	24-280 V ~	3-32 V $\equiv$	84 064 131
	GA 8	24-280 V ~	3-32 V $\equiv$	84 065 131
5 A	GA 8	24-280 V ~	3-32 V $\equiv$	84 065 030
	GA 8	24-480 V ~	3-32 V $\equiv$	84 065 040

## Instantaneous switching

Rating	Range	Output voltage	Input voltage	
5 A	GA 8	24-280 V ~	3-32 V $\equiv$	84 025 030
3 A	GA 8	24-480 V ~	3-32 V $\equiv$	84 025 040

## Accessories

Quick-blow fuses (see page 4/32)

## Equivalent circuits

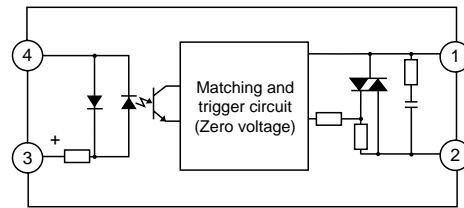

## Dimensions (General tolerances +/- 0.5)

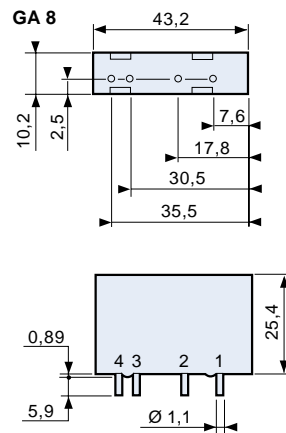
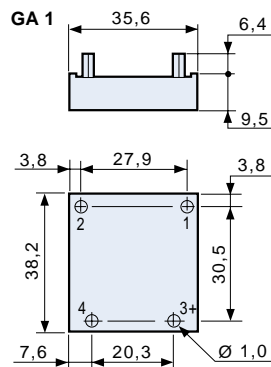

## Curves for temperature-dependent derating

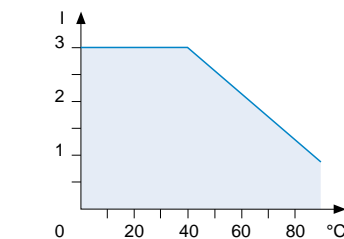
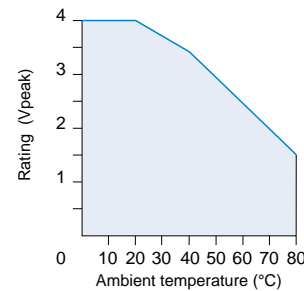

## To order, specify:

Standard products

1 Part number

2 Accessory

Standard products, non stocked

Example: Solid state relay - GA8 range - 84 065 131 - Fuse Z 084 363