



GUARDIAN Electric Manufacturing

ISO 9001 / AS9100 Certified Company

Woodstock, IL 60098 Ph. (815)334-3600 Fax (815)337-0377

Or visit us at our website www.guardian-electric.com

Model 28 AC Frame Solenoid

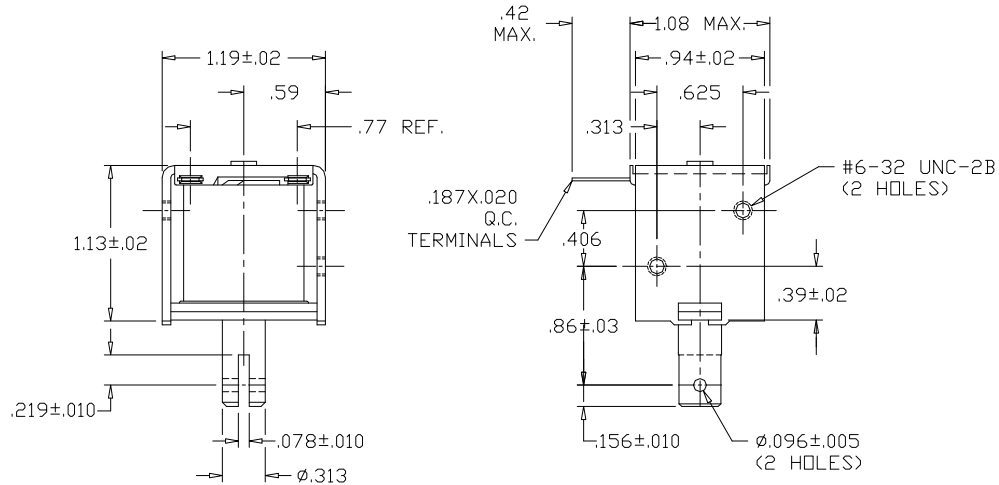

Solenoid shown energized and fully seated.

Spring kits are available (consult factory).

Total Weight: 3.5 oz.

Plunger Weight: .5 oz.

Model No.	Part No.	Duty Cycle	Volts	Res. (Ω)	Power (VA)	Current, Seated (mA)
28-I-120A	A420-065447-00	*Intermittent	120	220	22	183
28-C-120A	A420-065446-00	Continuous	120	400	8	67
28-I-240A	A420-065449-00	*Intermittent	240	900	22	92
28-C-240A	A420-065448-00	Continuous	240	1600	8	33

When ordering, please refer to Part No., as listed above.

Consult factory for custom configurations.

Stroke (in.)	Pull Force (oz.)							Holding Force (oz.)
	0.125	0.250	0.375	0.500	0.625	0.750	1.000	-
Continuous Duty	11	8	6	4	n/a	n/a	n/a	13
*Intermittent Duty	18	14	9	5	n/a	n/a	n/a	15

UL Recognition

Recognized under the  Component Recognition Program of **Underwriters Laboratories, Inc.**

Continuous Duty

100% 'On' Time

*Intermittent Duty

25% 'On' Time, (240 Seconds 'On' Max. Followed By 720 Seconds 'Off' Min.)

RoHS

These parts comply with **RoHS** Directive 2002/95/EC