

Power PCB Relay RT1 bistable

- 1 pole 16A, 1 form C (CO) or 1 form A (NO) contact
- Polarized bistable version with 1 or 2 coils
- 5kV/10mm coil-contact
- Reinforced insulation

Typical applications
Battery powered equipment or applications with "memory function"



F0176-C



Approvals

VDE REG.-Nr. 6106, cULus E214025, cCSAus 14385
Technical data of approved types on request

Contact Data

Contact arrangement	1 form C (CO) or 1 form A (NO)
Rated voltage	250VAC
Max. switching voltage	400VAC
Rated current	16A
Limiting continuous current	16A, UL: 20A
Limiting making current, max. 4s, duty factor 10%	30A
Breaking capacity max.	4000VA
Contact material	AgNi 90/10
Frequency of operation, with/without load	360/72000h ⁻¹
Operate/Reset time max.	10/10ms
Bounce time max., form A/form B	3/6ms

Contact ratings

Type	Contact	Load	Cycles
IEC 61810			
RT314	A (NO)	16A, 250VAC resistive, 85°C	30x10 ³
RT314	C (CO)	16A, 250VAC resistive, 85°C	10x10 ³
UL 508			
RT314	A/B (NO/NC)	20A, 250VAC, general purpose, 85°C	6x10 ³
RT334	A (NO)	16A, 250VAC, general purpose, 85°C	50x10 ³
RT314	A (NO)	1hp, 240VAC, 40°C	1x10 ³

Mechanical endurance >5x10⁶ operations

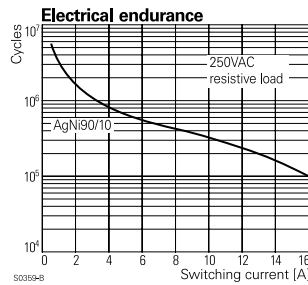
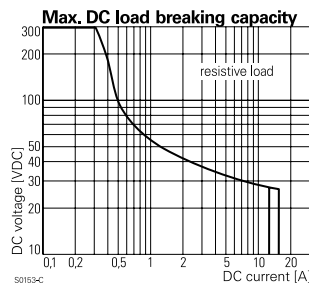

Coil Data, bistable coils

	1 coil	2 coils
Magnetic system	polarized, bistable	
Coil voltage range	3 to 24VDC	
Operative range, IEC 61810	2	
Limiting voltage, % of rated coil voltage	120%	150%
Min./Max. energization duration	30ms/1min at <10% duty factor	
Coil insulation system according UL1446	class F	

Coil versions, bistable coil

Coil code	Rated voltage VDC	Set voltage VDC	Reset voltage VDC	Coil resistance Ω±10%	Rated power mW
bistable 1 coil					
A03	3	2.1	1.7	21	429
A05	5	3.5	2.8	62	403
A06	6	4.2	3.3	90	400
A12	12	8.4	6.6	360	400
A24	24	16.8	13.2	1440	400
bistable 2 coils					
F03	3	2.1	1.7	15	600
F05	5	3.5	2.8	42	595
F06	6	4.2	3.3	55	655
F12	12	8.4	6.6	240	600
F24	24	16.8	13.2	886	650

All figures are given for coil without pre-energization, at ambient temperature +23°C. Other coil voltages on request.

Bistable coils - operation

Version	1 coil				2 coils		
Coil terminals	A1	A2	A1	A3	A2		
Operate	+	-		+	-		
Reset	-	+		-	+		

Contact position not defined at delivery

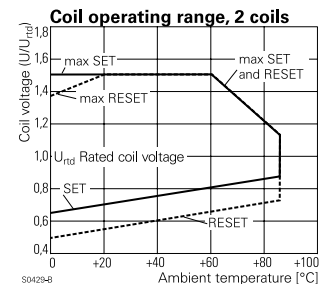
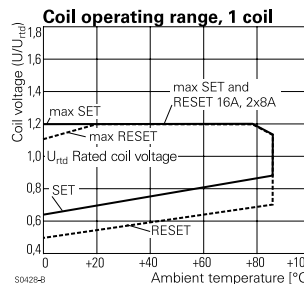

Power PCB Relay RT1 bistable (Continued)

Insulation Data

Initial dielectric strength	
between open contacts	1000V _{rms}
between contact and coil	5000V _{rms}
Clearance/creepage	
between contact and coil	≥ 10/10mm
Material group of insulation parts	IIIa
Tracking index of relay base	PTI 250V

Other Data

Material compliance: EU RoHS/ELV, China RoHS, REACH, Halogen content refer to the Product Compliance Support Center at www.tycoelectronics.com/customersupport/rohssupportcenter

Ambient temperature	
bistable 1 coil	-10 to 85°C
bistable 2 coils	-40 to 85°C
Category of environmental protection	
IEC 61810	RTII - flux proof, RTIII - wash tight
Vibration/shock resistance (functional),	
opening B contact	3/5g
opening closed A contact	6/15g
Shock resistance (destructive)	100g

Other Data (continued)

Terminal type	PCB-THT, plug-in ¹⁾
Weight	14g
Resistance to soldering heat	THT, IEC 60068-2-20
RTII - flux proof	270°C/10s
RTIII - wash tight	260°C/5s
Packaging/unit	tube/20 pcs., box/500 pcs.

¹⁾ socket available for 1 coil version only, see Accessories.

Accessories

For 1 coil version,
details see datasheet [Accessories Industrial Power Relay RT](#)
NOTE: indicated contact ratings and electrical endurance data for direct wiring of relays (according IEC 61810-1); for relays mounted on sockets deratings may apply.

Dimensions

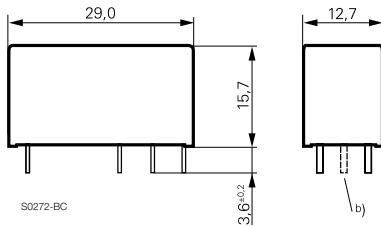

- a) Indicated contact position during or after coil energization with reset voltage.
- b) for 2 coil version only

PCB layout / terminal assignment

Bottom view on solder pins

16A, pinning 5mm, 1 form A (NO) contact

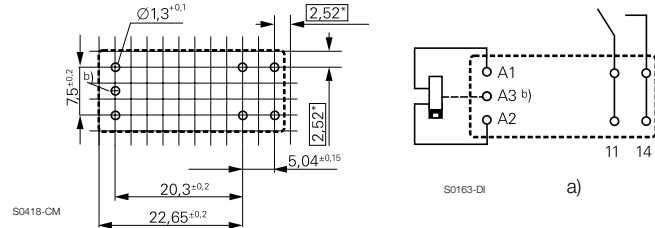

^{*)} With the recommended PCB hole sizes a grid pattern from 2.5mm to 2.54mm can be used.

16A, pinning 5mm, 1 form C (CO) contact

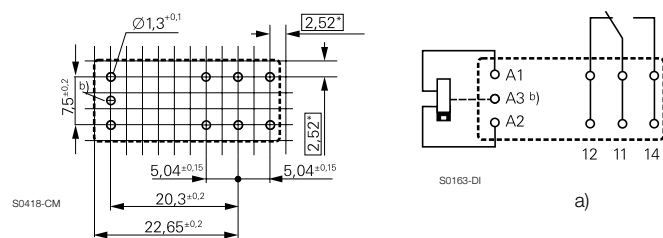

^{*)} With the recommended PCB hole sizes a grid pattern from 2.5mm to 2.54mm can be used.

Power PCB Relay RT1 bistable (Continued)

Product code structure

Typical product code **RT 3 1 4 F24**

Type	RT Power PCB Relay RT1 bistable				
Version	3 16A, pinning 5mm, flux proof	D 16A, pinning 5mm, wash tight			
Contact configuration	1 1 form C (CO) contact	3 1 form A (NO) contact			
Contact material	4 AgNi 90/10				
Coil	Coil code: please refer to coil versions table				

Product code	Version	Contacts	Contact material	Coil version	Coil	Part number
RT314A03	16A;	1 form C (CO)	AgNi 90/10	Bistable 1coil	3VDC	7-1393239-7
RT314A05	pinning 5mm,	contact			5VDC	7-1393239-8
RT314A06	flux proof				6VDC	7-1393239-9
RT314A12					12VDC	8-1393239-0
RT314F03				Bistable 2 coils	3VDC	8-1393239-4
RT314F05					5VDC	8-1393239-5
RT314F06					6VDC	8-1393239-6
RT314F12					12VDC	8-1393239-7
RT314F24					24VDC	8-1393239-8

This list represents the most common types and does not show all variants covered by this datasheet.
Other types on request