

DO NOT SCALE
DIMENSIONS IN mm

METRIC

THIRD ANGLE
PROJECTION

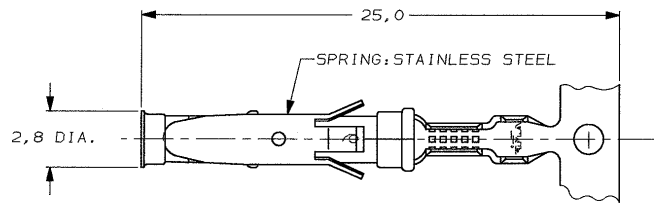

STRIP

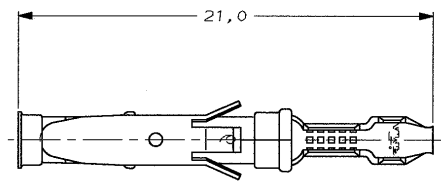

LOOSE-PIECE

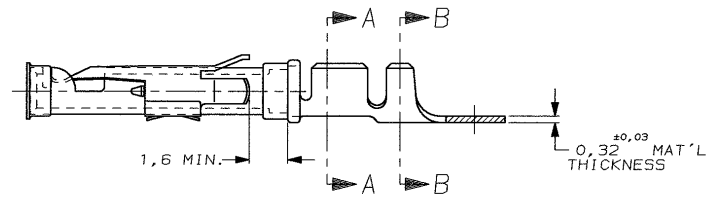

COLOR CODE: BLUE

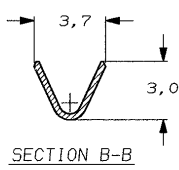
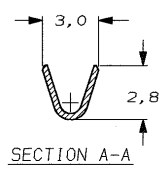

WIRE RANGE : 0,75-1,50 mm² (18-16 AWG)
INSUL. RANGE : 2,0 -2,5 mm (.080-.100)

- NOTES :
- U.L. RECOGNIZED UNDER FILE E28476 VOL. VI SEC. I .
 - FOR CRIMP DETAILS SEE AMP-SPEC. 114-19.000 .
 - MEETS PRODUCT SPECIFICATION 108-10042.
 - SPECIAL REEL WITH 200 PCS FOR REEL-FED HANDTOOL.

DIRECTION OFF TOP OF REEL
AMPOMATOR + MINI-APPL.
107-3-F16.1
107-3-F16.2
107-3-F16.4

5-163083-3			BRASS	ECON. GOLD
5-163083-2			BRASS	SEL. GOLD
5-163083-1			BRASS	EL. TIN
1-163083-4	1-163084-4		BRASS	EL. TIN
1-163083-3	1-163084-3		BRASS	BR. TIN/LEAD
1-163083-2			BRASS	SILVER
1-163083-1			BRASS	ECON. GOLD
1-163083-0	1-163084-0		BRASS	ECON. GOLD
163083-9			BRASS	SILVER
163083-8			BRASS	EL. TIN
163083-7			BRASS	SEL. GOLD
163083-2	163084-2		BRASS	SEL. GOLD
163083-1	163084-1		BRASS	EL. TIN
PARTNUMBER	DIRECTION OF REEL	LOOSE-PIECE	MATERIAL	PLATING

NOTES	MATERIAL	THICKNESS	AREA
△	TIN	2,0 μm	ALL OVER
△	NICKEL		ALL OVER
△	GOLD	0,8 μm	CONTACT AREA
△	TIN/LEAD		BARREL
△	NICKEL	0,8 μm	ALL OVER
△	GOLD		CONTACT AREA
△	GOLD	1,2 μm	ALL OVER
△	NICKEL		CONTACT AREA
△	SILVER	2,5 μm	ALL OVER
△	TIN/LEAD		CONTACT AREA
△	SILVER	1,5-2,5 μm	ALL OVER
△	NICKEL	0,75 μm	ALL OVER
△	SILVER	2,5 μm	ALL OVER
△	NICKEL	1,27 μm	ALL OVER
△	TIN/LEAD	1,27 μm	ALL OVER
△	LUBRICATED		

AZ	EBD0-0003-05	AM	FWK	05/01/05	
AY	EBD0-0335-04	JMS	FWK	02/08/04	
V	EH-1020-98	D.K.	R.V.	08 JUL 98	
U	EH-1347-96	JvL	RV	21-11-96	
T	EH-0302-94	JvL	MvD	03-05-94	
S	ECN H-9813	JvdH	RD	18-05-92	
R	ECN H-9192	MvD	RD	09-10-91	
LTR.	REVISION RECORD	DR.	CHK.	DATE	
DR.	DATE	CHK.	DATE	APP.	DATE

CUSTOMER DRAWING FOR REFERENCE ONLY WILL NOT BE UPDATED.

© COPYRIGHT 19- BY AMP HOLLAND B.V.
ALL INTERNATIONAL RIGHTS RESERVED. AMP PRODUCTS MAY BE COVERED BY U.S. AND FOREIGN AND/OR PATENTS PENDING.
THIS DRAWING IS UNPUBLISHED
RELEASED FOR PUBLICATION

AMP AMP HOLLAND B.V.
's-Hertogenbosch, The Netherlands.

NAME: SOCKET TYPE III CONTACT
SIZE 16

DWG. No. 163083
REV. LTR. AZ
SHEET 1 of 1