

REV.	DATE	DESCRIPTION	BY	C'K'D
01	06/03/02	REVISIONS K. BUIERS	CH	---
02	12/07/04	ADD 82911622A AND 1464A	R. CH	---

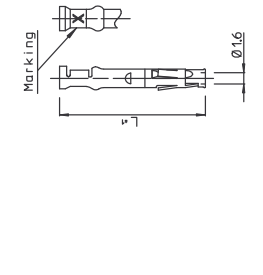

Fig. 1

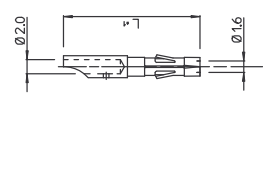

Fig. 2

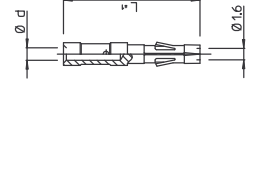

Fig. 3

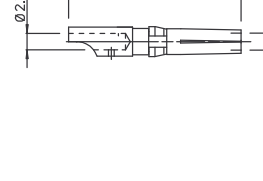

Fig. 4

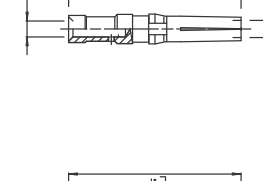

Fig. 5

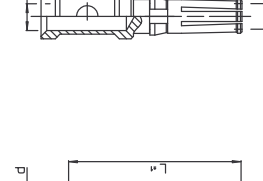

Fig. 6

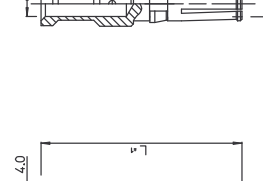

Fig. 7

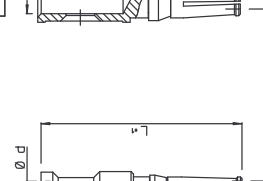

Fig. 8

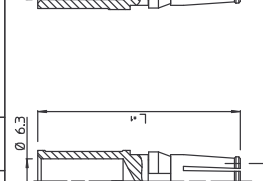

Fig. 9

Catalog number	Plating	Fig.	L	Ø d	Strip-length	Clip ref. force after 5 cycles	Tensile strength(N) MIL-T-7982G	Cable Ø max	Wire Ø max	Wire section AWG	Marking X	Delivery	Extraction tool :	
													Pindiameter 1.6 (Fig1-2-3) :	Pindiameter 5.0 (Fig8-9) :
82911251	Au	1	21.0		4.0 mm	50N min	169-222	2.3	1.68	16-18	X	On reel	Pindiameter 1.6 (Fig1-2-3) :	
82911252	Au	1	21.0		4.0 mm	50N min	84-169	2.3	1.68	18-20	X	On reel	51060210616 (without ejector)	
82911253	Au	1	21.0		4.0 mm	50N min	44-67	1.8	0.8	22-24	X	On reel	51060210916 (with ejector)	
82911254	Au	1	21.0		4.0 mm	50N min	31-44	1.8	0.8	24-26	X	On reel	Pindiameter 2.4 (Fig4-5) :	
82911259	Ni	1	21.0		4.0 mm	50N min	169-222	2.3	1.68	16-18	X	On reel	51060210624 (without ejector)	
82911260	Ni	1	21.0		4.0 mm	50N min	84-169	2.3	1.68	18-20	X	On reel	Pindiameter 3.6 (Fig6-7) :	
82911261	Ni	1	21.0		4.0 mm	50N min	44-67	1.8	0.8	22-24	X	On reel	51060210636 (without ejector)	
82911262	Ni	1	21.0		4.0 mm	50N min	31-44	1.8	0.8	24-26	X	On reel	Pindiameter 5.0 (Fig8-9) :	
82911267	Ni	1	21.0		4.0 mm	50N min	169-222	2.3	1.68	16-18	X	Loose	51060210650 (without ejector)	
82911268	Ni	1	21.0		4.0 mm	50N min	84-169	2.3	1.68	18-20	X	Loose		
82911269	Ni	1	21.0		4.0 mm	50N min	44-67	1.8	0.8	22-24	X	Loose		
82911270	Ni	1	21.0		4.0 mm	50N min	31-44	1.8	0.8	24-26	X	Loose		
82911291	Au	1	21.0		4.0 mm	50N min	169-222	2.3	1.68	16-18	X	Loose		
82911292	Au	1	21.0		4.0 mm	50N min	84-169	2.3	1.68	18-20	X	Loose		
82911293	Au	1	21.0		4.0 mm	50N min	44-67	1.8	0.8	22-24	X	Loose		
82911294	Au	1	21.0		4.0 mm	50N min	31-44	1.8	0.8	24-26	X	Loose		
82911410	Ni+Ag	2	19.2		7-8 mm	60N min	---	3.3	1.95	1.5 max			Stamped and formed contacts :	
82911499	Ni+Au	2	19.2		7-8 mm	60N min	---	3.3	1.95	1.5 max			AWG 16 - 20 : 8291 1133	
82911412	Ni	3	19.2	1.75	7-8 mm	60N min	222	3.3	1.72	16			AWG 20 - 26 : 8291 1385	
82911414	Ni	3	19.2	1.45	7-8 mm	60N min	169	3.3	1.42	18				
82911416	Ni	3	19.2	1.15	7-8 mm	60N min	84	3.3	1.12	20				
82911418	Ni	3	19.2	0.90	7-8 mm	60N min	31-67	3.3	0.87	22-26				
82911412A	Ni+Ag	3	19.2	1.75	7-8 mm	60N min	222	3.3	1.72	16				
82911414A	Ni+Ag	3	19.2	1.45	7-8 mm	60N min	169	3.3	1.42	18				
82911416A	Ni+Ag	3	19.2	1.15	7-8 mm	60N min	84	3.3	1.12	20				
82911418A	Ni+Ag	3	19.2	0.90	7-8 mm	60N min	31-67	3.3	0.87	22-26				
82911420	Ni+Ag	4	24.25		7-8 mm	70N min	---	4.15	2.3	2.5 max				
82911464	Ni	5	22.25	2.25	7-8 mm	70N min	311	4.15	2.22	14				
82911462	Ni	5	22.25	1.75	7-8 mm	70N min	222	4.15	1.72	16				
82911464A	Ni+Ag	5	22.25	2.25	7-8 mm	70N min	311	4.15	2.22	14				
82911462A	Ni+Ag	5	22.25	1.75	7-8 mm	70N min	222	4.15	1.72	16				
82911434	Ni	5	24.25	1.45	7-8 mm	70N min	169	4.15	1.42	18				
82911436	Ni	5	24.25	1.15	7-8 mm	70N min	84	4.15	1.12	20				
82911438	Ni	5	24.25	0.90	7-8 mm	70N min	31-67	4.15	0.87	22-26				
82911670	Ni+Ag	6	28.25		11-12mm	75N min	---	6.50	4.0	6.0 max				
82911676	Ni	7	28.25	1.75	11-12mm	75N min	222	4.15	1.72	16				
82911678	Ni	7	28.25	2.25	11-12mm	75N min	311	4.15	2.22	14				
82911680	Ni	7	28.25	2.85	11-12mm	75N min	489	6.50	2.82	12				
82911682	Ni	7	28.25	3.55	11-12mm	75N min	700	6.50	3.50	10				
82911684	Ni	7	28.25	4.40	11-12mm	75N min	1000	6.50	4.35	8				
82911684A	Ni+Ag	8	28.25	4.40	11-12mm	80N min	1000	6.50	4.35	8				
82911440	Ni+Ag	9	28.5	5.90	11-12mm	80N min	---	8.8	6.3	16.0max				
82911452	Ni	9	28.5	4.40	11-12mm	80N min	1000	8.8	4.35	10				
82911454	Ni	9	28.5	3.55	11-12mm	80N min	1778	8.8	3.5	6				

MACHINED

STAMPED AND FORMED

Extraction tool :

- Pindiameter 1.6 (Fig1-2-3) :
- 51060210616 (without ejector)
- 51060210916 (with ejector)
- Pindiameter 2.4 (Fig4-5) :
- 51060210624 (without ejector)
- Pindiameter 3.6 (Fig6-7) :
- 51060210636 (without ejector)
- 51060210936 (with ejector)
- Pindiameter 5.0 (Fig8-9) :
- 51060210650 (without ejector)
- 51060210950 (with ejector)

Crimp tooling :

- Stamped and formed contacts :
- AWG 16 - 20 : 8291 1133
- AWG 20 - 26 : 8291 1385

Machined contacts :

- Pindiameter 1.6 (Fig3) : 51060210101
- Pindiameter 2.4 (Fig5) : 51060210101
- Pindiameter 3.6 (Fig7) :
- AWG 14 - 16 : 51060210101
- AWG 12 : 51060210501 + 51060215001
- AWG 10 : 51060210501 + 51060215101
- AWG 8 : 51060210501 + 51060215201
- Pindiameter 5.0 (Fig9) :
- AWG 10 : 51060210501 + 51060215101
- AWG 8 : 51060210501 + 51060215201
- AWG 6 : 51060210501 + 51060215301

Materials :

- Stamped and formed contacts : Copper alloy
- Machined contacts : Copper alloy
- Machined contacts retaining clip : Beryllium Copper

RELEASED FOR PRODUCTION

8P CONTACTS FEMALE OVERVIEW
 CAT. No. 8291-2-2
 SOURIAU
 Route Nationale 23
 72470 CHAMPAGNE

APPR.	DATE	SIGN.
DRAFT	03-04-97	K. NIELTJEN
CHECKED		
PROD. MGR.		
PR. ENG. MGR.		
PR. MGT. MGR.		

1DEC ±0.2 1DEC
 ZDEC ±0.1 ZDEC
 WE RESERVE THE RIGHT TO CHANGE
 WITHOUT NOTICE
 ALL DIMENSIONS IN MM
 REFERENCES / REFERENCES
 SCALE
 SOURIAU
 Route Nationale 23
 72470 CHAMPAGNE

ALLE AFWETINGEN IN MM
 100% OF THE DIMENSIONS ARE TO BE USED UNLESS OTHERWISE SPECIFIED
 100% OF THE DIMENSIONS ARE TO BE USED UNLESS OTHERWISE SPECIFIED
 100% OF THE DIMENSIONS ARE TO BE USED UNLESS OTHERWISE SPECIFIED

BS.D . 202333.002.02
 CUSTOMER DRAWING
 DRAWING No. 2
 1 2 3 4 5 6 7 8 9