



Serie 682

## Miniatur Rundsteckverbinder Serie 682 Miniature circular connectors series 682

## Kurzinformation Brief information

Ü  
TI

702  
709  
710  
711  
712  
719  
423  
440  
581  
678  
680  
**682**  
720  
723  
623  
690  
691  
692  
693  
694  
707  
713  
718  
763  
765  
768  
714  
715  
766  
815  
820  
772  
775  
M-A  
M-B  
M-C

### Winkelsteckverbinder

- Winkelsteckverbinder mit Schraubverriegelung nach IEC 130-9
- Schutzart IP 40<sup>1)</sup>
- Metallgehäuse schirmbar (sehr gute EMV Eigenschaften)
- Winkelstellung bei Metallgehäuse in 4 Stellungen einstellbar
- Kostengünstige Kunststoffausführungen
- Innenliegende Zugentlastung

### Cable Connector

- Angeled connector with screw locking according to IEC 130-9
- Degree of protection IP 40<sup>1)</sup>
- Metal housings with good EMC characteristics
- Angled connector adjustable in 4 angled positions (only metal housings)
- Cost-effective plastic versions
- Internal strain relief

Aufbau des Steckverbinders:  
Construction of the connector:



### Flanschsteckverbinder

- 1 Standard: mit Lötanschluss, wird von vorn eingesetzt und von hinten verschraubt.
- 2 Mit Lötanschluss, von vorn verschraubbar, besonders geeignet für vorkonfektionierte Kabelbäume, die nach dem Löten eingebaut werden.
- 3 Mit Tauchlötanschluss, für den Anschluss auf die Leiterplatte (Abbildung vor dem Einbau in das Gehäuse).
- 4 Mit Tauchlötanschluss nach der Gehäusemontage.

1 2

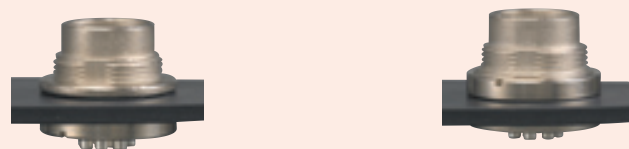

### Chassis sockets

- 1 Standard, with solder termination, mounted from front side and fastened from back side.
- 2 With solder termination, mounted from back side and fastened from front side, especially suited for preassembled cable trees which are mounted after soldering.
- 3 Dip solder termination for connection to PCB (figure: before built in into housing).
- 4 Dip solder termination after installation into housing.

3 4

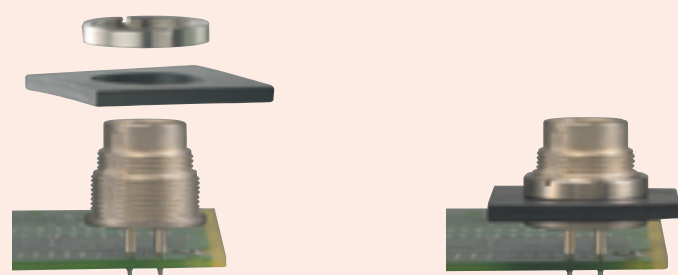

<sup>1)</sup> Erläuterung der Schutzarten siehe Seite TI-3 – TI-4. / <sup>1)</sup> Explanation of protection standards see page TI-3 – TI-4.

<b>Miniatur Rundsteckverbinder Serie 682</b> <b>Miniature circular connectors series 682</b>		<b>Technische Daten <sup>1)</sup></b> <b>Specifications <sup>1)</sup></b>														
Allgemeine Kennwerte		General Characteristics														
Polzahl	Number of contacts	2	3 DIN	4	5	5 DIN	6 DIN	7	7 DIN	8 DIN	12	14	16	19	24	
Verriegelung	Locking system	schrauben / screw														
Anschlussart	Termination	löten, tauchlöten / solder, dip solder														
Anschlussquerschnitt in mm <sup>2</sup>	Wire gauge in mm <sup>2</sup>	max. 0,75						max. 0,25				0,14				
Anschlussquerschnitt in AWG	Wire gauge in AWG	max. 20						max. 24				26				
Kabeldurchlass	Cable outlet	4 - 6 mm (.16 - .24) / 6 - 8 mm (.24 - .32)														
Schutzart Gehäuse	Shell protection	IP 40														
Mechanische Lebensdauer	Mechanical operation	> 500 Steckzyklen / > 500 mating cycles														
Obere Grenztemperatur	Upper temperature	+ 85 °C (+ 185 °F)														
Untere Grenztemperatur	Lower temperature	- 40 °C (- 40 °F)														
Gewicht Kabelsteckverbinder	Weight cable connector	~ 14 g (Kunststoffausführung/plastic version), ~ 40 g (Metallausführung/metal version)														
Gewicht Flanschsteckverbinder	Weight socket	~ 12 g														
Elektrische Kennwerte		Electrical Characteristics														
Bemessungsspannung	Rated voltage	250 V		60 V		250 V		125 V		60 V						
Bemessungs-Stoßspannung	Rated impulse voltage	1500 V		500 V		1500 V		800 V		500 V						
Verschmutzungsgrad	Pollution degree	1														
Überspannungskategorie	Overvoltage categorie	I														
Isolierstoffgruppe	Material group	III														
Prüfstoßspannung	Test voltage	1750 V			550 V		1750 V		910 V		550 V					
Bemessungsstrom (40 °C)	Rated current (40 °C)	7 A		6 A		5 A				3 A		1 A				
Durchgangswiderstand	Contact resistance	≤ 5 mΩ										≤ 3 mΩ				
Isolationswiderstand	Insulation resistance	≥ 10 <sup>10</sup> Ω														
Werkstoffe		Materials														
Kontaktstift	Pin contact	CuZn (Messing/brass)														
Kontaktbuchse	Socket contact	CuSn (Bronze/bronze)														
Kontaktoberfläche	Contact plating	Ag (Silber/silver) / Au (Gold/gold)										Au (Gold/gold)				
Steckerkörper	Male insert	PBT (UL 94 V-0)														
Buchsenkörper	Female Insert	PBT (UL 94 V-0)														
Gehäuse Kunststoffausführung	Housing plastic version	PA 66 (UL 94 HB)														
Gehäuse Metallausführung	Housing metal version	Zink-Druckguss, vernickelt/zinc diecasting, nickel plated														
Flanschgehäuse	Socket	Zink-Druckguss, vernickelt/zinc diecasting, nickel plated														

<sup>1)</sup> Normen und Prüfbedingungen für diese Angaben siehe Seite TI-16/ Standards and test parameters for this data see page TI-16.

Ü  
TI

702  
709  
710  
711  
712  
719  
423  
440  
581  
678  
680  
**682**

720  
723  
623  
690  
691  
692  
693  
694  
707  
713  
718  
763  
765  
768  
714  
715  
766  
815  
820  
772  
775  
M-A  
M-B  
M-C

R

## Miniatur Rundsteckverbinder Serie 682 Miniature circular connectors series 682

## Winkelstecker Male angled cable connectors

Ü

TI

702

709

710

711

712

719

423

440

581

678

680

**682**

720

723

623

690

691

692

693

694

707

713

718

763

765

768

714

715

766

815

820

772







775

M-A

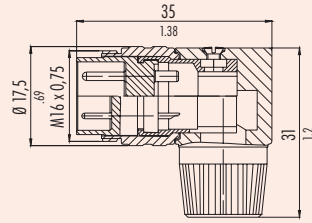

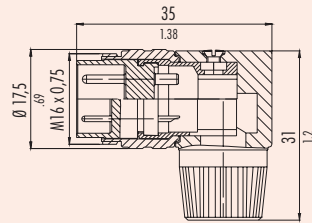

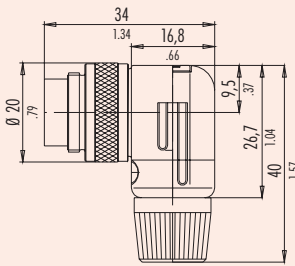

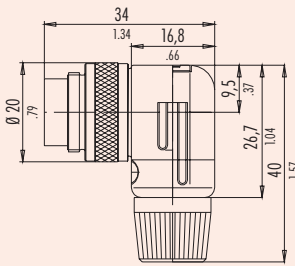
M-B

M-C

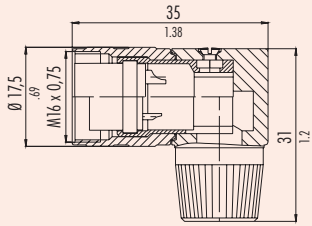
R

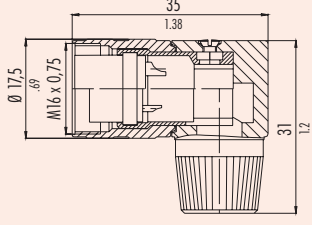
Bezeichnung – Abbildung Description – Figure	Maßzeichnung Drawing	Polzahl Contacts	Bestell-Nr./Ordering-No.	
			versilberte Kontakte silver plated contacts	vergoldete Kontakte gold plated contacts
Winkelstecker, Kabeldurchlass 4 - 6 mm, Kunststoffausführung Male angled connector cable outlet 4 - 6 mm (.16 - .24 in.), plastic version  		2	09-0133-70-02	09-0133-79-02
		3 DIN	09-0135-70-03	09-0135-79-03
		4	09-0137-70-04	09-0137-79-04
		5	09-0139-70-05	09-0139-79-05
		5 (Stereo)	09-0141-70-05	09-0141-79-05
		6 DIN	09-0143-70-06	09-0143-79-06
		7	09-0145-70-07	09-0145-79-07
		7 DIN	09-0177-70-07	–
		8 DIN	09-0153-70-08	09-0153-79-08
		12	–	09-0147-70-12
		14	–	09-0161-70-14
		16	–	09-0185-70-16
		19	–	09-0163-70-19
		24	–	–
Winkelstecker, Kabeldurchlass 6 - 8 mm, Kunststoffausführung Male angled connector cable outlet 6 - 8 mm (.24 - .32 in.), plastic version  		2	09-0133-72-02	09-0133-78-02
		3 DIN	09-0135-72-03	09-0135-78-03
		4	09-0137-72-04	09-0137-78-04
		5	09-0139-72-05	09-0139-78-05
		5 (Stereo)	09-0141-72-05	09-0141-78-05
		6 DIN	09-0143-72-06	09-0143-78-06
		7	09-0145-72-07	09-0145-78-07
		7 DIN	–	–
		8 DIN	09-0153-72-08	09-0153-78-08
		12	–	09-0147-72-12
		14	–	09-0161-72-14
		16	–	09-0185-72-16
		19	–	09-0163-72-19
		24	–	09-0165-72-24
Winkelstecker, Kabeldurchlass 4 - 6 mm, Metallausführung Male angled connector cable outlet 4 - 6 mm (.16 - .24 in.), metal version  		2	99-0133-10-02	–
		3 DIN	99-0135-10-03	–
		4	99-0137-10-04	–
		5	99-0139-10-05	–
		5 (Stereo)	99-0141-10-05	–
		6 DIN	99-0143-10-06	–
		7	99-0145-10-07	–
		7 DIN	99-0177-10-07	–
		8 DIN	99-0153-10-08	–
		12	–	99-0147-10-12
		14	–	99-0161-10-14
		16	–	–
		19	–	99-0163-10-19
		24	–	–
Winkelstecker, Kabeldurchlass 6 - 8 mm, Metallausführung Male angled connector cable outlet 6 - 8 mm (.24 - .32 in.), metal version  		2	99-0133-12-02	–
		3 DIN	99-0135-12-03	–
		4	99-0137-12-04	–
		5	99-0139-12-05	–
		5 (Stereo)	99-0141-12-05	–
		6 DIN	99-0143-12-06	–
		7	99-0145-12-07	–
		7 DIN	–	–
		8 DIN	99-0153-12-08	–
		12	–	99-0147-12-12
		14	–	99-0161-12-14
		16	–	–
		19	–	99-0163-12-19
		24	–	99-0165-12-24

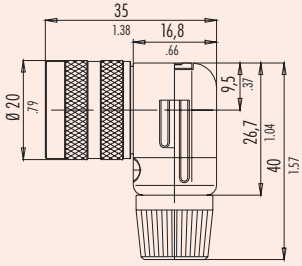

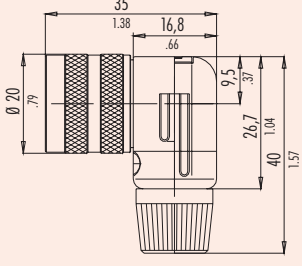
<b>Miniatur Rundsteckverbinder Serie 682</b> <b>Miniature circular connectors series 682</b>		<b>Winkeldosen</b> <b>Female angled cable connectors</b>		
Bezeichnung — Abbildung Description — Figure	Maßzeichnung Drawing	Polzahl Contacts	Bestell-Nr./Ordering-No.	
			versilberte Kontakte silver plated contacts	vergoldete Kontakte gold plated contacts
Winkeldose, Kabeldurchlass 4 - 6 mm, Kunststoffausführung <i>Female angled connector            cable outlet 4 - 6 mm (.16 - .24 in.),            plastic version</i> 		2	09-0134-70-02	09-0134-79-02
		3 DIN	09-0136-70-03	09-0136-79-03
		4	09-0138-70-04	09-0138-79-04
		5	09-0140-70-05	09-0140-79-05
		5 (Stereo)	09-0142-70-05	09-0142-79-05
		6 DIN	09-0144-70-05	09-0144-79-05
		7	09-0146-70-07	09-0146-79-07
		7 DIN	09-0178-70-07	—
		8 DIN	09-0154-70-08	09-0154-79-08
		12	—	09-0148-70-12
		14	—	09-0162-70-14
		16	—	09-0186-70-16
		19	—	09-0164-70-19
		24	—	—
Winkeldose, Kabeldurchlass 6 - 8 mm, Kunststoffausführung <i>Female angled connector            cable outlet 6 - 8 mm (.24 - .32 in.),            plastic version</i> 		2	09-0134-72-02	09-0134-78-02
		3 DIN	09-0136-72-03	09-0136-78-03
		4	09-0138-72-04	09-0138-78-04
		5	09-0140-72-05	09-0140-78-05
		5 (Stereo)	09-0142-72-05	09-0142-78-05
		6 DIN	09-0144-72-06	09-0144-78-06
		7	09-0146-72-07	09-0146-78-07
		7 DIN	—	—
		8 DIN	09-0154-72-08	09-0154-78-08
		12	—	09-0148-72-12
		14	—	09-0162-72-14
		16	—	09-0186-72-16
		19	—	09-0164-72-19
		24	—	09-0166-72-24
Winkeldose, Kabeldurchlass 4 - 6 mm, Metallausführung <i>Female angled connector            cable outlet 4 - 6 mm (.16 - .24 in.),            metal version</i> 		2	99-0134-10-02	—
		3 DIN	99-0136-10-03	—
		4	99-0138-10-04	—
		5	99-0140-10-05	—
		5 (Stereo)	99-0142-10-05	—
		6 DIN	99-0144-10-06	—
		7	99-0146-10-07	—
		7 DIN	—	—
		8 DIN	99-0154-10-08	—
		12	—	99-0148-10-12
		14	—	99-0162-10-14
		16	—	—
		19	—	99-0164-10-19
		24	—	—
Winkeldose, Kabeldurchlass 6 - 8 mm, Metallausführung <i>Female angled connector            cable outlet 6 - 8 mm (.24 - .32 in.),            metal version</i> 		2	99-0134-12-02	—
		3 DIN	99-0136-12-03	—
		4	99-0138-12-04	—
		5	99-0140-12-05	—
		5 (Stereo)	99-0142-12-05	—
		6 DIN	99-0144-12-06	—
		7	99-0146-12-07	—
		7 DIN	—	—
		8 DIN	99-0154-12-08	—
		12	—	99-0148-12-12
		14	—	99-0162-12-14
		16	—	—
		19	—	99-0164-12-19
		24	—	99-0166-12-24

Ü  
 TI  
 702  
 709  
 710  
 711  
 712  
 719  
 423  
 440  
 581  
 678  
 680  
**682**  
 720  
 723  
 623  
 690  
 691  
 692  
 693  
 694  
 707  
 713  
 718  
 763  
 765  
 768  
 714  
 715  
 766  
 815  
 820  
 772  
 775  
 M-A  
 M-B  
 M-C  
 R

Ü

TI

702

709

710

711

712

719

423

440

581

678

680

**682**

720

723

623

690

691

692

693

694

707

713

718

763

765

768

714

715

766

815

820

772

775

M-A

M-B

M-C







R

## Miniatur Rundsteckverbinder Serie 682 Miniature circular connectors series 682

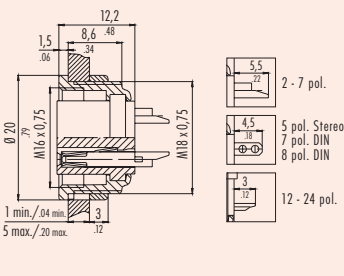
## Flanschstecker Male sockets

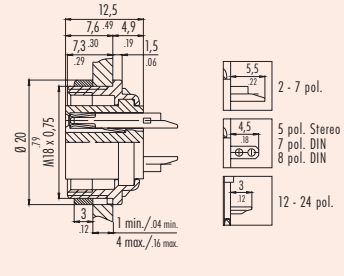
Bezeichnung – Abbildung Description – Figure	Maßzeichnung Drawing	Polzahl Contacts	Bestell-Nr./Ordering-No.	
			versilberte Kontakte silver plated contacts	vergoldete Kontakte gold plated contacts
Flanschstecker, löten Male socket, solder		2	09-0303-00-02	09-0303-09-02
		3 DIN	09-0307-00-03	09-0307-09-03
		4	09-0311-00-04	09-0311-09-04
		5	09-0315-00-05	09-0315-09-05
		5 (Stereo)	09-0319-00-05	09-0319-09-05
		6 DIN	09-0323-00-06	09-0323-09-06
		7	09-0327-00-07	09-0327-09-07
		7 DIN	09-1583-00-07	–
		8 DIN	09-0473-00-08	09-0473-09-08
		12	–	09-0331-00-12
		14	–	09-0053-00-14
		16	–	09-0339-00-16
		19	–	09-0335-00-19
		24	–	09-0197-00-24
Flanschstecker, löten, von vorn verschraubbar Male socket, solder, front fastened		2	09-0303-80-02	09-0303-89-02
		3 DIN	09-0307-80-03	09-0307-89-03
		4	09-0311-80-04	09-0311-89-04
		5	09-0315-80-05	09-0315-89-05
		5 (Stereo)	09-0319-80-05	09-0319-89-05
		6 DIN	09-0323-80-06	09-0323-89-06
		7	09-0327-80-07	09-0327-89-07
		7 DIN	–	–
		8 DIN	09-0473-80-08	09-0473-89-08
		12	–	09-0331-80-12
		14	–	09-0053-80-14
		16	–	09-0339-80-16
		19	–	09-0335-80-19
		24	–	09-0197-80-24
Flanschstecker, tauchlöten, von vorn verschraubbar Male socket, dip solder, front fastened		2	09-0303-90-02	09-0303-99-02
		3 DIN	09-0307-90-03	09-0307-99-03
		4	09-0311-90-04	09-0311-99-04
		5	09-0315-90-05	09-0315-99-05
		5 (Stereo)	09-0319-90-05	09-0319-99-05
		6 DIN	09-0323-90-06	09-0323-99-06
		7	09-0327-90-07	09-0327-99-07
		7 DIN	–	–
		8 DIN	09-0473-90-08	09-0473-99-08
		12	–	09-0331-90-12
		14	–	09-0053-90-14
		16	–	09-0339-90-16
		19	–	09-0335-90-19
		24	–	09-0197-90-24
Flanschstecker mit Flexplatte, von vorn verschraubbar Male socket with flexible PCB, front fastened	<p>Weitere Maße siehe Seite 682-11 Additional dimensions see page 682-11</p>	7	09-0327-65-07	
		8	09-0473-65-08	
		12		09-0331-65-12
		12		09-0331-66-12

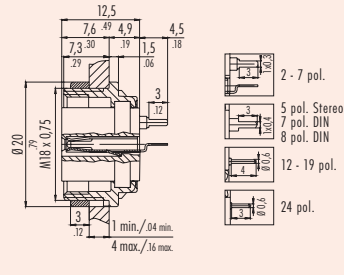
<sup>1)</sup> Flanschstecker von Serie 680 / Sockets from series 680.

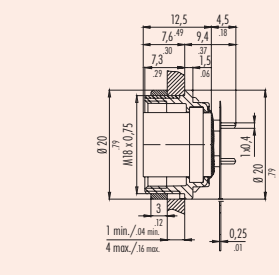
<b>Miniatur Rundsteckverbinder Serie 682</b> <b>Miniature circular connectors series 682</b>		<b>Flanschdosen</b> <b>Female sockets</b>		
Bezeichnung – Abbildung Description – Figure	Maßzeichnung Drawing	Polzahl Contacts	Bestell-Nr./Ordering-No.	
			versilberte Kontakte silver plated contacts	vergoldete Kontakte gold plated contacts
Flanschdose, löten <i>Female socket, solder</i> 		2	09-0304-00-02	09-0304-09-02
		3 DIN	09-0308-00-03	09-0308-09-03
		4	09-0312-00-04	09-0312-09-04
		5	09-0316-00-05	09-0316-09-05
		5 (Stereo)	09-0320-00-05	09-0320-09-05
		6 DIN	09-0324-00-06	09-0324-09-06
		7	09-0328-00-07	09-0328-09-07
		7 DIN	09-1584-00-07	–
		8 DIN	09-0474-00-08	09-0474-09-08
		12	–	09-0332-00-12
		14	–	09-0054-00-14
		16	–	09-0340-00-16
		19	–	09-0336-00-19
		24	–	09-0198-00-24
Flanschdose, löten, von vorn verschraubbar <i>Female socket, solder, front fastened</i> 		2	09-0304-80-02	09-0304-89-02
		3 DIN	09-0308-80-03	09-0308-89-03
		4	09-0312-80-04	09-0312-89-04
		5	09-0316-80-05	09-0316-89-05
		5 (Stereo)	09-0320-80-05	09-0320-89-05
		6 DIN	09-0324-80-06	09-0324-89-06
		7	09-0328-80-07	09-0328-89-07
		7 DIN	–	–
		8 DIN	09-0474-80-08	09-0474-89-08
		12	–	09-0332-80-12
		14	–	09-0054-80-14
		16	–	09-0340-80-16
		19	–	09-0336-80-19
		24	–	09-0198-80-24
Flanschdose, tauchlöten, von vorn verschraubbar <i>Female socket, dip solder, front fastened</i> 		2	09-0304-90-02	09-0304-99-02
		3 DIN	09-0308-90-03	09-0308-99-03
		4	09-0312-90-04	09-0312-99-04
		5	09-0316-90-05	09-0316-99-05
		5 (Stereo)	09-0320-90-05	09-0320-99-05
		6 DIN	09-0324-90-06	09-0324-99-06
		7	09-0328-90-07	09-0328-99-07
		7 DIN	–	–
		8 DIN	09-0474-90-08	09-0474-99-08
		12	–	09-0332-90-12
		14	–	09-0054-90-14
		16	–	09-0340-90-16
		19	–	09-0336-90-19
		24	–	09-0198-90-24
Flanschdose mit Flexplatte, von vorn verschraubbar <i>Female socket with flexible PCB, front fastened</i> 	 <p>Weitere Maße siehe Seite 682-11            Additional dimensions see page 682-11</p>	7	09-0328-65-07	
		8	09-0474-65-08	
		12		09-0332-65-12
		12		09-0332-66-12

 Ü  
 TI

 702  
 709  
 710  
 711  
 712  
 719  
 423  
 440  
 581  
 678  
 680  
 720  
 723  
 623  
 690  
 691  
 692  
 693  
 694  
 707  
 713  
 718  
 763  
 765  
 768  
 714  
 715  
 766

 815  
 820  
 772  
 775  
 M-A  
 M-B  
 M-C

R

<sup>1)</sup> Flanschstecker von Serie 680 / Sockets from series 680.

Ü  
TI

## Miniatur Rundsteckverbinder Serie 682 Miniature circular connectors series 682

## Polbilder Contact arrangements

Polbilder mit Sicht auf die Lötanschlusseite der Steifteinsätze  
Contact arrangements with view on the solder termination side of male inserts

x-y Koordinaten  
x-y Coordinates

2 pol

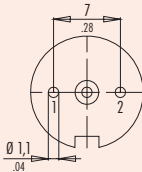

3 pol (DIN 41524)

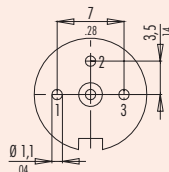

4 pol

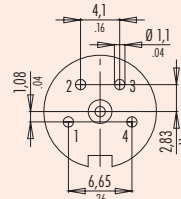

12 pol

	X	Y
A	-0,41	-3,45
B	2,29	-3,61
C	4,10	-1,21
D	3,20	1,34
E	2,71	3,59
F	0,41	3,45
G	-2,29	3,61
H	-4,10	1,21
J	-3,20	-1,34
K	-2,71	-3,59
L	2,00	-1,51
M	-2,00	1,51

5 pol

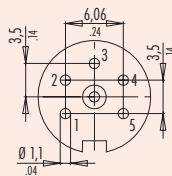

5 pol stereo (DIN 41524)

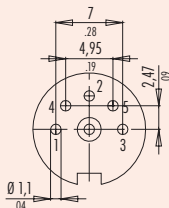

6 pol (DIN 45322)

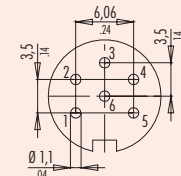

14 pol

	X	Y		X	Y
A	2,50	-4,00	T	-2,40	-0,95
C	4,25	0,00	U	-0,95	-2,40
E	2,30	4,00			
G	-2,30	4,00			
J	-4,25	0,00			
L	-2,50	-4,00			
M	0,95	-2,40			
N	2,40	-0,95			
O	2,40	0,95			
P	0,95	2,40			
R	-0,95	2,40			
S	-2,40	0,95			

7 pol

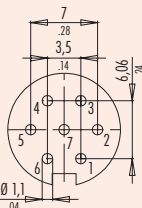

7 pol (DIN 45329)

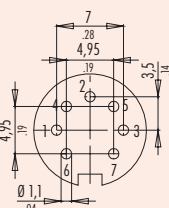

8 pol (DIN 45326)

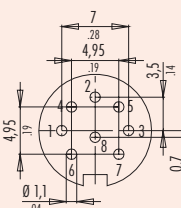

16 pol

	X	Y		X	Y
A	2,50	-4,00	N	2,45	-0,80
B	4,00	-2,25	O	1,50	2,10
C	4,25	0,00	P	-1,50	2,10
D	4,00	2,40	R	-2,45	-0,80
E	2,30	4,00			
F	0,00	4,25			
G	-2,30	4,00			
H	-4,00	2,40			
I	-4,25	0,00			
K	-4,00	-2,25			
L	-2,50	-4,00			
M	0,00	-2,60			

12 pol

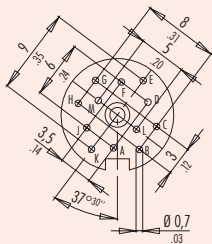

14 pol

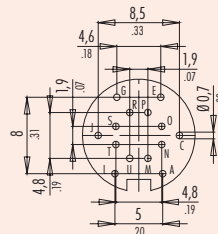

16 pol

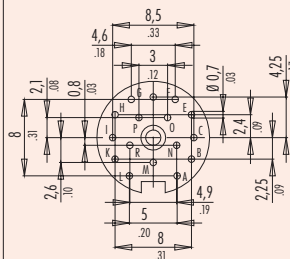

19 pol

	X	Y		X	Y
A	2,50	-4,00	N	2,40	-0,95
B	4,00	-2,25	O	2,40	0,95
C	4,25	0,00	P	0,95	2,40
D	4,00	2,40	R	-0,95	2,40
E	2,30	4,00	S	-2,40	0,95
F	0,00	4,25	T	-2,40	-0,95
G	-2,30	4,00	U	-0,95	-2,40
H	-4,00	2,40			
I	-4,25	0,00			
K	-4,00	-2,25			
L	-2,50	-4,00			
M	0,95	-2,40			

19 pol

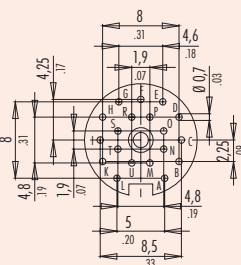

24 pol

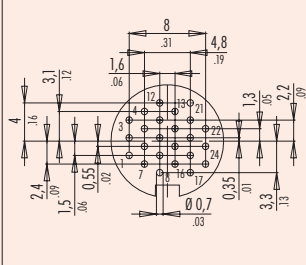

Montageausschnitt  
Panel cut out

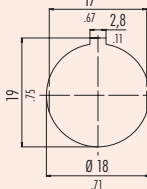

24 pol

	X	Y		X	Y
1	-4,00	-1,50	13	0,80	3,10
2	-4,00	0,35	14	0,80	1,30
3	-4,00	2,20	15	0,80	-0,55
4	-2,40	3,10	16	0,80	-2,40
5	-2,40	1,30	17	2,40	-3,30
6	-2,40	-0,55	18	2,40	-1,50
7	-2,40	-2,40	19	2,40	0,35
8	-0,80	-3,30	20	2,40	2,20
9	-0,80	-1,50	21	2,40	4,00
10	-0,80	0,35	22	4,00	1,30
11	-0,80	2,20	23	4,00	-0,55
12	-0,80	4,00	24	4,00	-2,40

<sup>1)</sup> Polbilder von Serie 680 / Contact arrangements from series 680.

702  
709  
710  
711  
712  
719  
423  
440  
581  
678  
680  
**682**  
720  
723  
623  
690  
691  
692  
693  
694  
707  
713  
718  
763  
765  
768  
714  
715  
766  
815  
820  
772  
775  
M-A  
M-B  
M-C  
R



## Miniatur Rundsteckverbinder Serie 682 Miniature circular connectors series 682

## Einzelteildarstellung Component part drawings

Winkelstecker  
Kunststoffausführung  
Angled connector  
plastic version

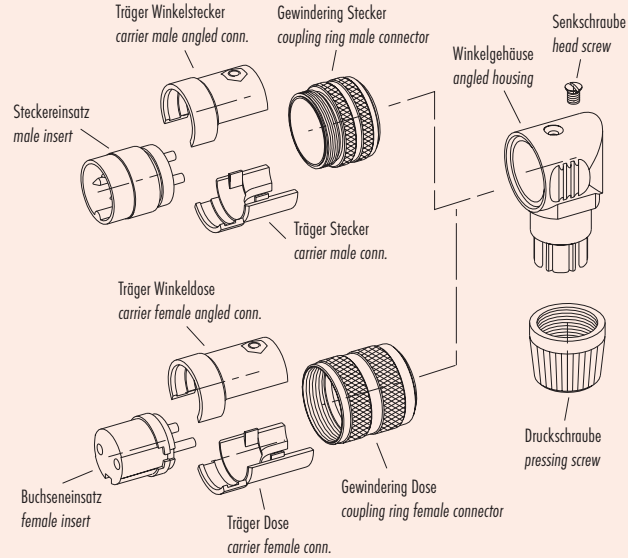

Winkelstecker  
Metallausführung  
Angled connector  
metal version

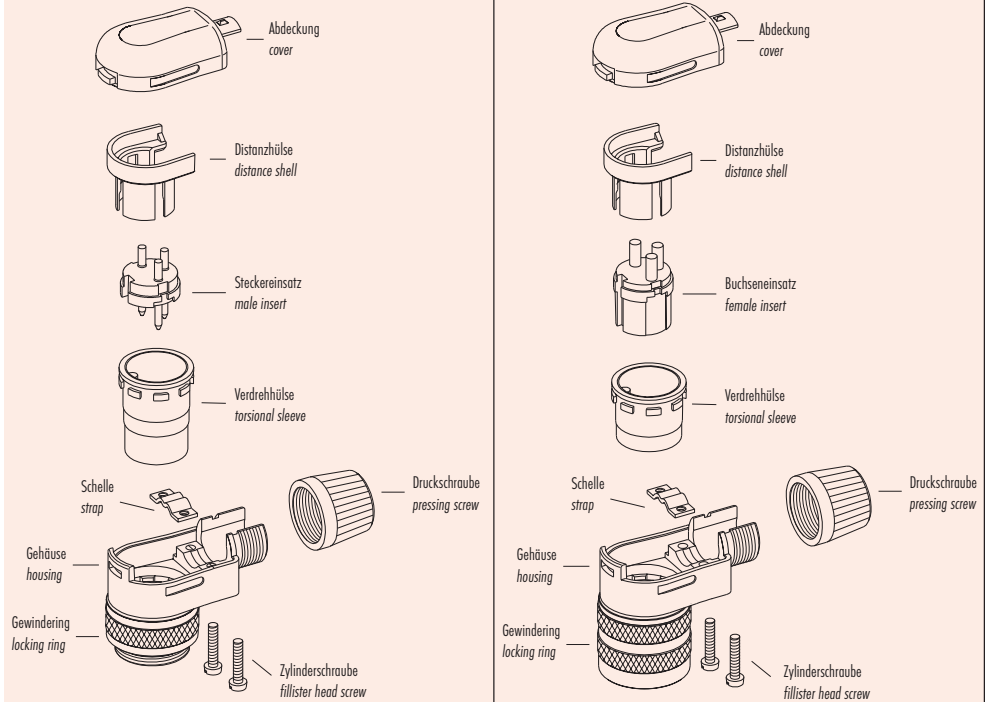

Ü  
TI

702  
709  
710  
711  
712  
719  
423  
440  
581  
678  
680  
**682**

720  
723  
623  
690  
691  
692  
693  
694  
707  
713  
718  
763  
765  
768  
714  
715  
766  
815  
820  
772  
775  
M-A  
M-B  
M-C

R

Ü

TI

702

709

710

711

712

719

423

440

581

678

680

**682**

720

723

623

690

691

692

693

694

707

713

718

763

765

768

714

715

766

815

820

772

775

M-A

M-B

M-C

R

<b>Miniatur Rundsteckverbinder Serie 682</b> <b>Miniature circular connectors series 682</b>		<b>Zubehör</b> <b>Accessories</b>	
Bezeichnung Description	Abbildung Figure	Maßzeichnung Drawing	Bestell-Nr. Ordering-No.
Schutzkappe für Kabelstecker, wasserdicht, IP 67 <i>Protection cap for male cable connector,            waterproof, IP 67</i>			08-1077-000-000
Schutzkappe für Kabeldose, wasserdicht, IP 67 <i>Protection cap for female cable connector,            waterproof, IP 67</i>			08-1078-000-000
Schutzkappe für Flanschstecker, wasserdicht, IP 67 <i>Protection cap for male socket,            waterproof, IP 67</i>			08-1079-000-000
Schutzkappe für Flanschdose, wasserdicht, IP 67 <i>Protection cap for female socket,            waterproof, IP 67</i>			08-1080-000-000
Schutzkappe für Kabel- und Flanschstecker, staubdicht, IP 54 <i>Protection cap for male cable connector and            male socket, dustproof, IP 54</i>			02-0054-000
Schutzkappe für Kabel- und Flanschdose, staubdicht, IP 54 <i>Protection cap for female cable connector and            female socket, dustproof, IP 54</i>			02-0055-001 02-0055-000 (Schwarz/black)
Distanzhülse für Flanschsteckverbinder, Tauchlöttausführung, 2-19 contacts <i>Distance shell for socket,            dip solder version, 2-19 contacts</i>			02-0007-000
Montageschlüssel für Kabelsteckverbinder <i>Mounting spanner for cable connector</i>			02-1785-000
Montageschlüssel für Flanschsteckverbinder <i>Mounting spanner for socket</i>			07-0010-001
Viereckflansch für Flanschsteckverbinder <i>Rectangular flange for socket</i>			04-0106-001
Lötösenring <i>Solder eye ring</i>			04-0186-009
6-kant Mutter <i>Hexagonal nut</i>			01-0146-001 (2,5 mm/.10) 01-5006-001 (5 mm/.20)

## Miniatur Rundsteckverbinder Serie 682 Miniature circular connectors series 682

## Zeichnungen Drawings

09-0327-65-07

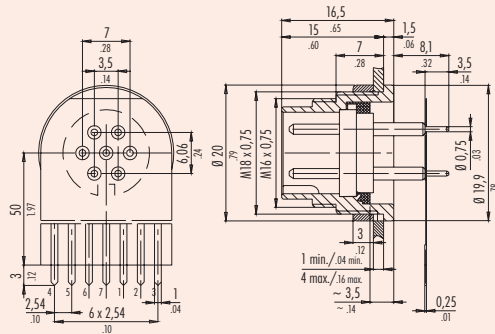

09-0328-65-07

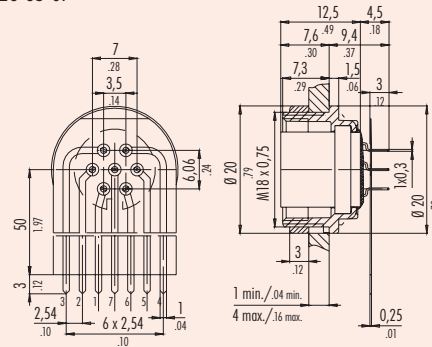

09-0473-65-08

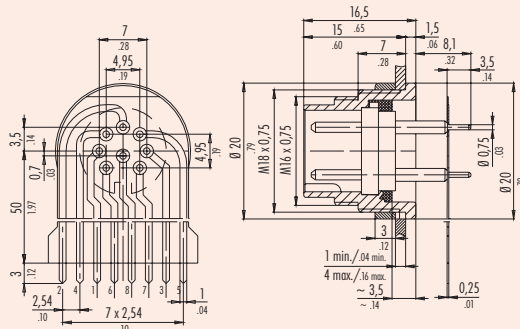

09-0474-65-08

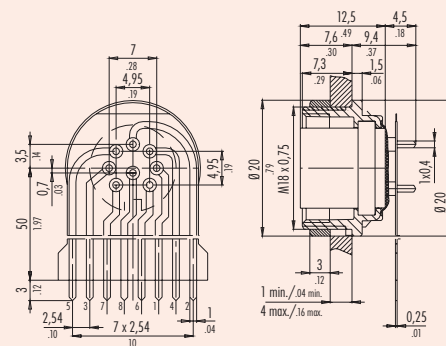

09-0331-65-12

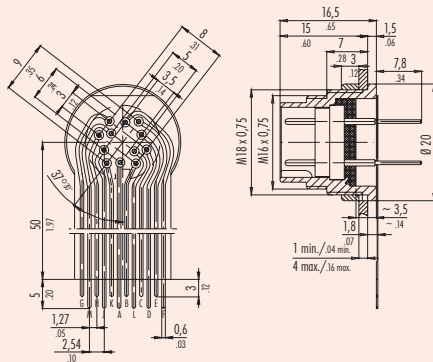

09-0332-65-12

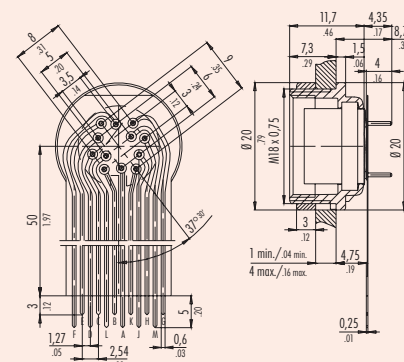

09-0331-66-12

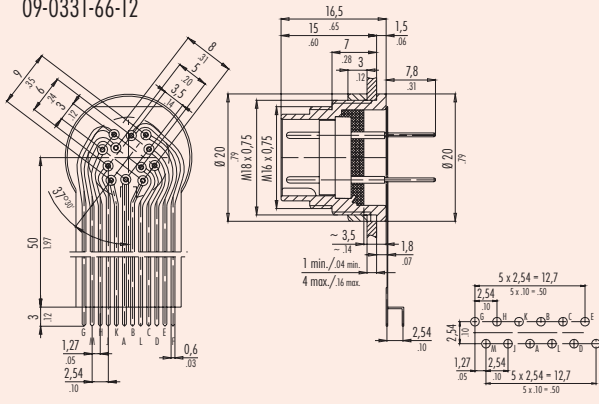

09-0332-66-12

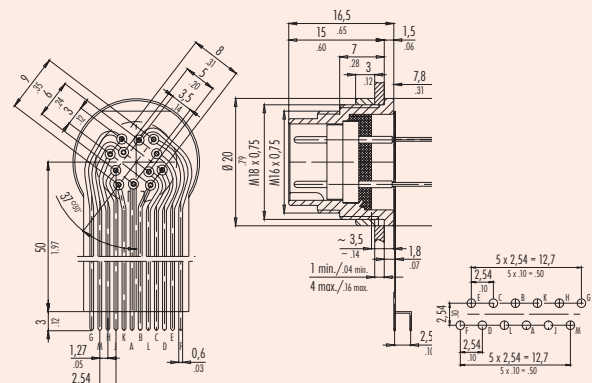

Ü  
TI

702  
709  
710  
711  
712  
719

423  
440  
581  
678  
680

**682**  
720  
723  
623  
690

691  
692  
693  
694

707  
713  
718  
763  
765  
768

714  
715  
766  
815  
820

772  
775  
M-A  
M-B  
M-C

R

Ü

TI

702

709

710

711

712

719

423

440

581

678

680

**682**

720

723

623

690

691

692

693

694

707

713

718

763

765

768

714

715

766

815

820

772

775

M-A

M-B

M-C

R