



SPC  
TECHNOLOGY

ALL RIGHTS RESERVED. NO PORTION OF THIS PUBLICATION, WHETHER IN WHOLE OR IN PART CAN BE REPRODUCED WITHOUT THE EXPRESS WRITTEN CONSENT OF SPC TECHNOLOGY.

SPC-F005.DWG

| REVISONS |      | DOC. NO.    | SPC-F005 | *        | Effective | 7/8/02   | *      | DCP No   | 1398 |
|----------|------|-------------|----------|----------|-----------|----------|--------|----------|------|
| DCP #    | REV  | DESCRIPTION | DRAWN    | DATE     | CHECKD    | DATE     | APPRVI | DATE     |      |
| XX       | XX   | XXXX        | XXXX     | 27-08-08 | XXXX      | 27-08-08 | XXXX   | 27-08-08 |      |
| XXXX     | XXXX |             | XXXX     | 27-08-08 | XXXX      | 27-08-08 | XXXX   | 27-08-08 |      |

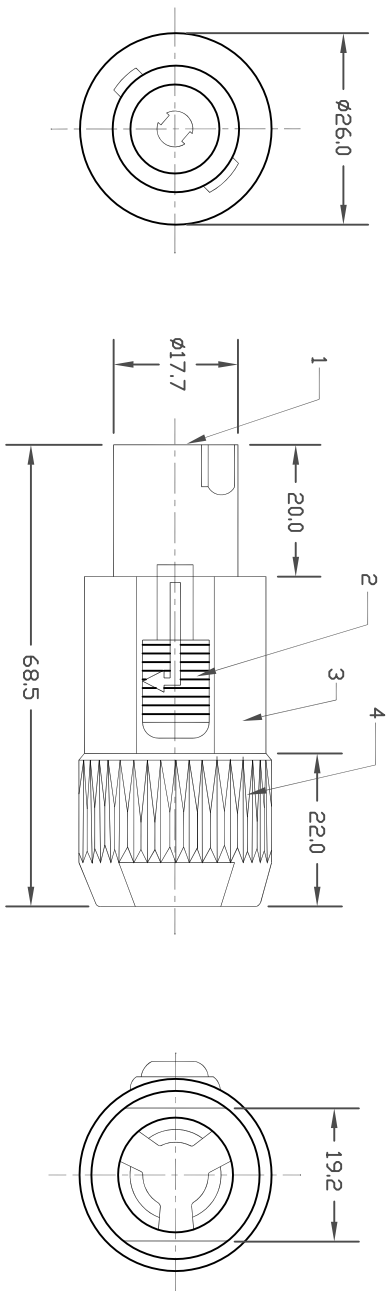

| ITEM | DESCRIPTION | QTY | MATERIAL/FINISH               |
|------|-------------|-----|-------------------------------|
| 1    | PIN         | 1   | PHOSPHOR BRASS, NICKEL PLATED |
| 2    | SWITCH      | 2   | ZINC ALLOY, NICKEL PLATED     |
| 3    | HOUSING     | 1   | NYLON, BLACK                  |
| 4    | HOOD        | 1   | ABS, BLUE                     |

**NOTES:**

1. CABLE O.D RANGE: 5-15MM
2. WIRING: CABLE: SCREWS WITH PROTECTION CUPS OR SOLDERING WIRE SIZE: 12 AVG STANDARD OR SOLID

**SPECIFICATIONS:**

**ELECTRICAL:**

CONTACT RATING : 30A  
 DIELECTRIC STRENGTH : 4000 VAC  
 RATED VOLTAGE : 250 VAC  
 CONTACT RESISTANCE : 3 MILLIOMHS MAX.  
 INSULATION RESISTANCE : 2000 MEGOMHS MIN.

**MECHANICAL:**

LIFE : 5000 CYCLES  
 CABLE RETENTION FORCE : 220N

**ENVIRONMENTAL:**

OPERATING TEMPERATURE : -30°C TO +80°C



RoHS  
Compliant

DISCLAIMER:  
 ALL STATEMENTS AND TECHNICAL INFORMATION CONTAINED HEREIN ARE BASED UPON INFORMATION AND/OR TESTS WE BELIEVE TO BE ACCURATE AND RELIABLE. SINCE CONDITIONS OF USE ARE BEYOND OUR CONTROL, THE USER SHALL DETERMINE THE SUITABILITY OF THE PRODUCT FOR THE INTENDED USE AND ASSUME ALL RISK AND LIABILITY WHATSOEVER IN CONNECTION THEREWITH.

**TOLERANCES:**

UNLESS OTHERWISE SPECIFIED, DIMENSIONS ARE FOR REFERENCE PURPOSES ONLY.

|              |          |
|--------------|----------|
| DRAWN BY:    | DATE:    |
| XXXX         | 27-08-08 |
| CHECKED BY:  | DATE:    |
| XXXX         | 27-08-08 |
| APPROVED BY: | DATE:    |
| XXXX         | 27-08-08 |

|                |          |                 |             |
|----------------|----------|-----------------|-------------|
| DRAWING TITLE: |          | SPEAKER PLUG    |             |
| SIZE           | DWG. NO. | ELECTRONIC FILE | REV         |
| A              | SPC24109 | 14N8169         | XX          |
| SCALE:         | NTS      | U.D.M:          | INCHES [mm] |
|                |          | SHEET:          | 1 OF 1      |