

No.MJ-156L
 3-CONDUCTOR MINIATURE JACK. (SINGLE CLOSED)
 Net Weight : 2.9 gr.
 (φ 3.5)

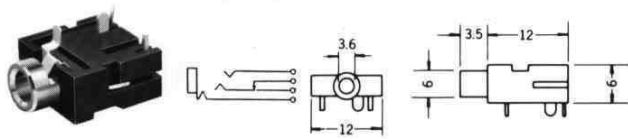

No.MJ-158L
 PANEL MOUNT 3-CON. STEREO MINIATURE JACK. (SINGLE CLOSED)
 Net Weight : 2 gr.
 (φ 3.5)

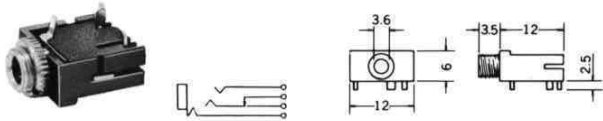

No.MJU-3XF (φ 3.5)
 STEREO

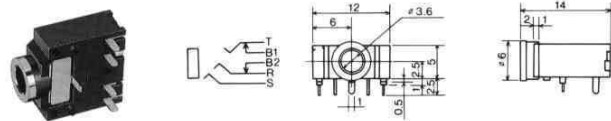

No.MJU-3XG (φ 3.5)
 STEREO
 Net Weight : 1.5 gr.

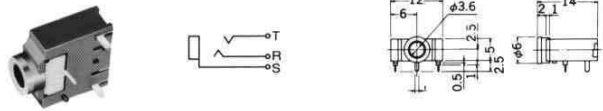

No.MX-386GL (φ 3.5)
 STEREO WATER PROOF

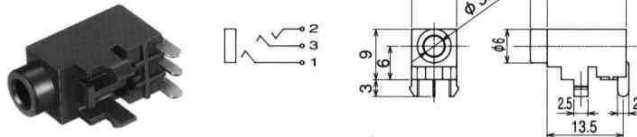

No.MX-345GLB (φ 3.5)
 STEREO
 Net Weight : 1 gr.

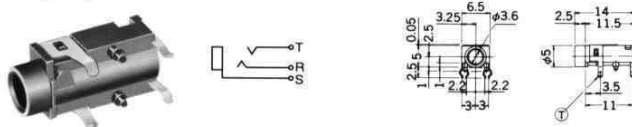

No.MX-387GL (φ 3.5)
 STEREO

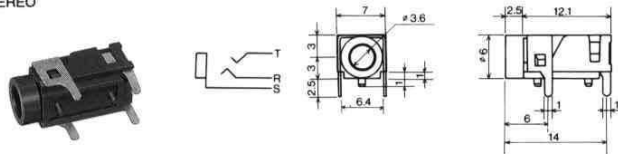

No.M03-610 (φ 3.5)
 STEREO

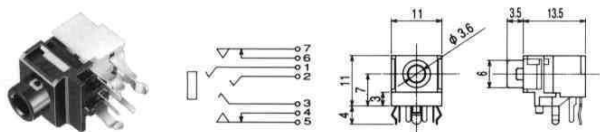

No.MJ-3-249A0
 4-CONDUCTOR

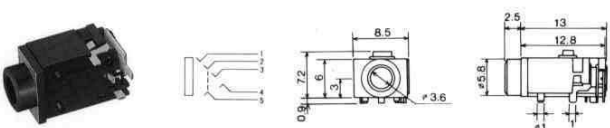

No.MX-328BL (φ 3.5)
 MONO
 Net Weight : 1.5 gr.

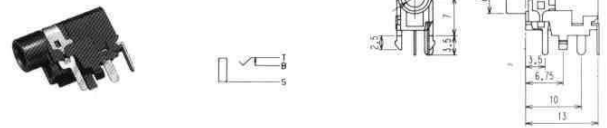

No.M03-772A0 (φ 3.5)
 STEREO

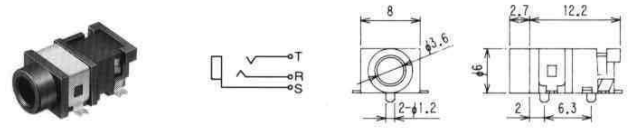

No.MJU-3LLB (φ 3.5)
 MONO
 Net Weight : 2 gr.

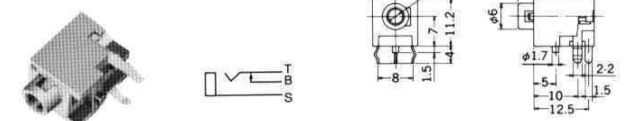

No.MJ-352 (φ 3.5)
 MONO
No.MJ-352N (φ 3.5)
 MONO W/O SCREW THREAD

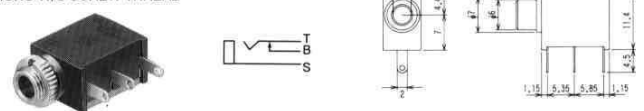

No.MJ-354A0 (φ 3.5)
 MONO

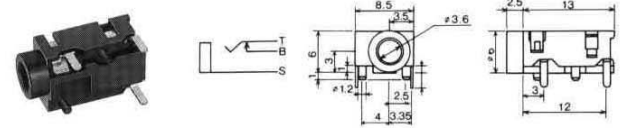

No.M03-663A0 (φ 3.5)
 STEREO

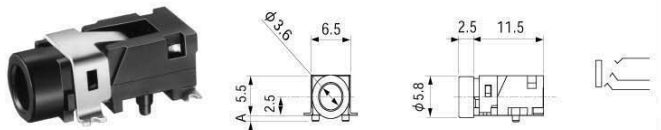

No.MJ-354W (φ 3.5)
 STEREO

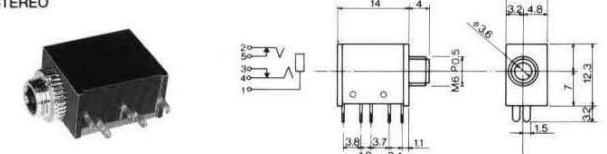

No.MJ-352W-C (φ 3.5)
 STEREO

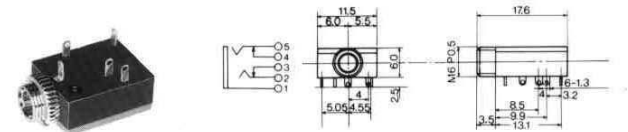

No.MJ-352W-0 (φ 3.5)
 STEREO

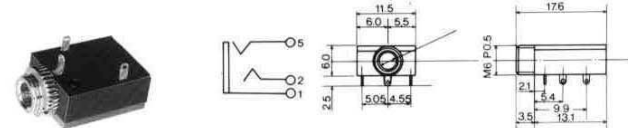

No.MJ-252 (φ2.5)

MONO

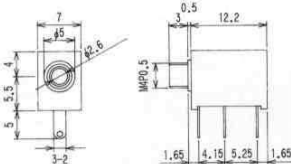
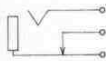

No.MJ-2435 (φ3.5)

STEREO

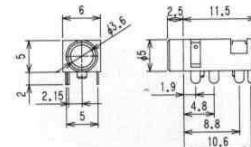

No.MJ-2925-5 (φ2.5)

STEREO

No.MJ-2925A (φ2.5)

STEREO

No.MJ-2925B (φ2.5)

STEREO

No.MJ-2925-3(φ2.5)

STEREO

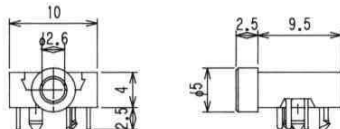

No.MJ-2335 (φ3.5)

STEREO

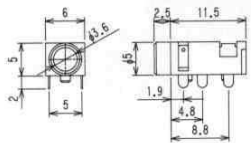
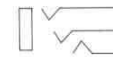

No.MJ-2235 (φ3.5)

MONO

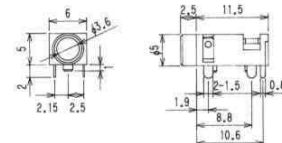

No.MJ-2135 (φ3.5)

4-CONDUCTOR

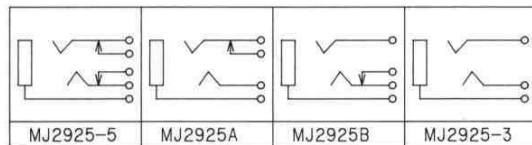
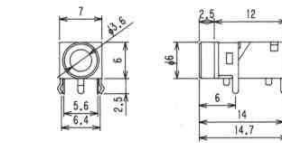
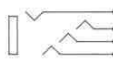

No.M02-815A0 (φ2.5)

STEREO

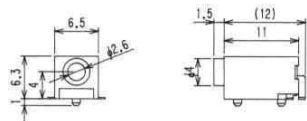
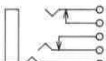

No.MJ-3335-6 (φ3.5)

STEREO

No.MJ-3335-5 (φ3.5)

STEREO

No.MJ-3335-4 (φ3.5)

STEREO

No.MJ-3335-3 (φ3.5)

STEREO

No.MJ-3335M (φ3.5)

MONO

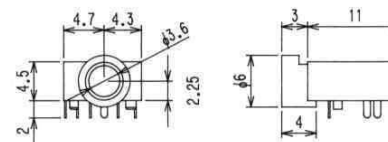

No.MJ-2625 (φ2.5)

MONO

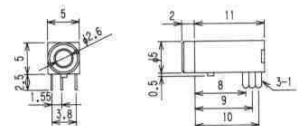
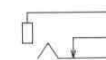

No.MJ-2035 (φ3.5)

STEREO

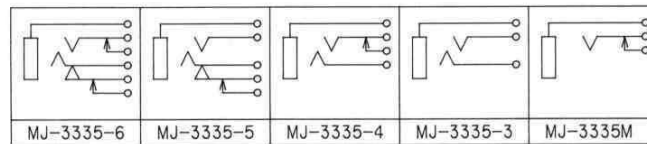
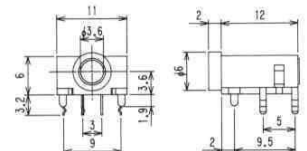
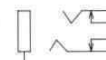

No.MJ-3235 (φ3.5)

MONO

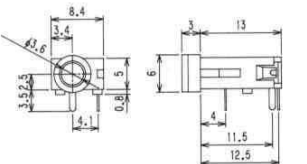
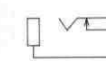

No.M03-798A0 (φ3.5)

STEREO

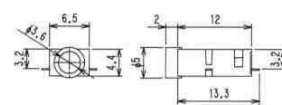
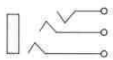

No.M03-749A0

3.5MM STEREO JACK FOR P.C.

WATER PROOF

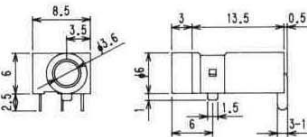
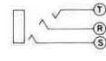

No.MJ-653

3.5MM DOUBLE STEREO JACK FOR P.C.

W/FULL SHIELD HOUSING

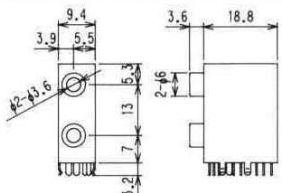
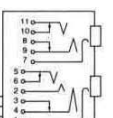

No.MJ-178M

NEW DESIGNED CHASSIS MTG.
3-CON. CLOSED CIRCUIT JACK
Net Weight : 7 gr.

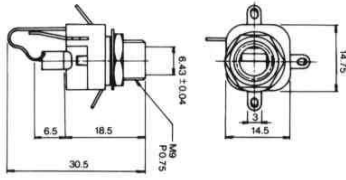

No.MJ-161M

NEW DESIGNED CHASSIS MTG.
3-CON. OPEN CIRCUIT JACK
Net Weight : 6.5 gr.

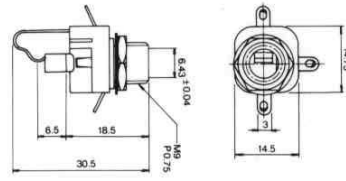

No.MJ-160M

NEW DESIGNED CHASSIS MTG.
2-CON. CLOSED CIRCUIT JACK
Net Weight : 6.5 gr.

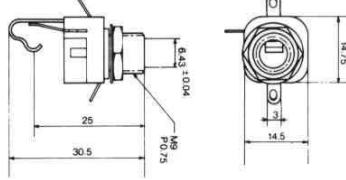

No.MJ-159M

NEW DESIGNED CHASSIS MTG.
2-CON. OPEN CIRCUIT JACK
Net Weight : 6 gr.

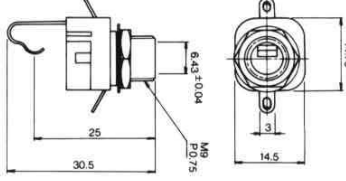

No.MJ-083

BRANDNEW MINIATURE (3.5mm) STEREO JACK
CLOSED CIRCUIT+CHASSIS MTG.
Net Weight : 2 gr.

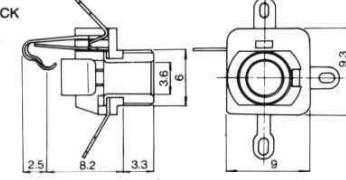

No.MJ-082

BRANDNEW MINIATURE (3.5mm) STEREO JACK
OPEN CIRCUIT+CHASSIS MTG.
Net Weight : 2 gr.

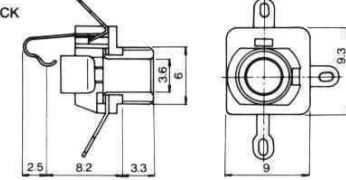

No.MJ-081

NEW DESIGNED MINIATURE (3.5mm) MONO JACK
CLOSED CIRCUIT+CHASSIS MTG.
Net Weight : 1.8 gr.

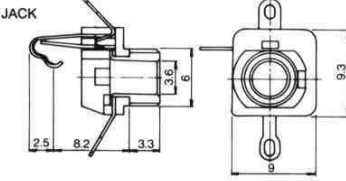

No.MJ-080

NEW DESIGNED MINIATURE (3.5mm) MONO JACK
OPEN CIRCUIT+CHASSIS MTG.
Net Weight : 1.5 gr.

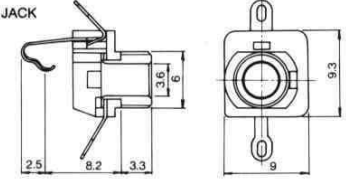

No.MJ-189

3-CONDUCTOR CLOSED CIRCUIT
PHONE JACK
Net Weight : 10 gr.

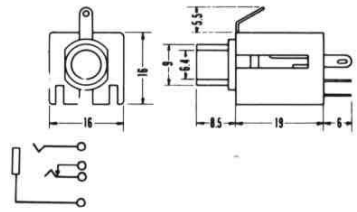

No.MJ-187

3-CONDUCTOR OPEN CIRCUIT
PHONE JACK
Net Weight : 9 gr.

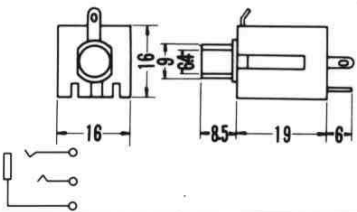

No.MJ-186

2-CONDUCTOR CLOSED CIRCUIT
PHONE JACK
Net Weight : 9 gr.

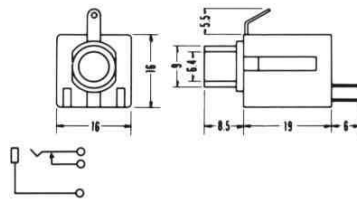

No.MJ-185

2-CONDUCTOR OPEN CIRCUIT
PHONE JACK
Net Weight : 9 gr.

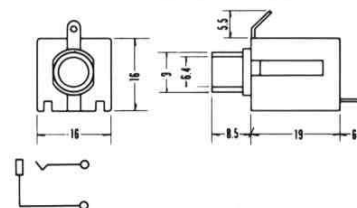

No.MJ-074N

CHASSIS MTG. 3-CON. STEREO
MINIATURE JACK (φ3.5)

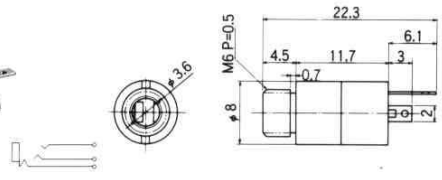

No.MJ-070N

CHASSIS MTG. 3-CON. SUB-MINI. JACK
(φ2.5)

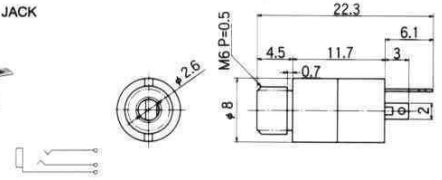

No.MJ-079

CHASSIS MTG. MINI. 4-CONDUCTOR
JACK(φ3.5)

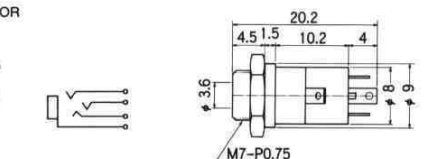

CHASSIS MTG.JACK

- No.MJ-073H (φ3.5) STEREO
- No.MJ-164H (φ3.5) MONO
- No.MJ-064H (φ3.5) 4-CONDUCTOR
- No.MJ-165H (φ2.5) MONO
- No.MJ-071H (φ2.5) STEREO

No.M03-517

3.5MM STEREO JACK FOR P.C.
w/metal sleeve

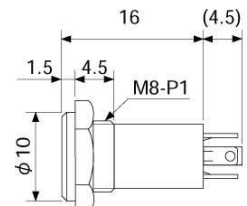
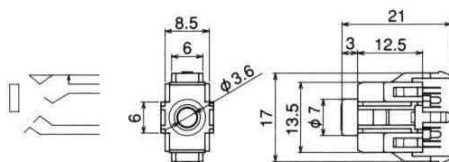

No.MJ-189LP

3-CONDUCTOR CLOSED CIRCUIT
PHONE JACK
Net Weight : 10 gr.

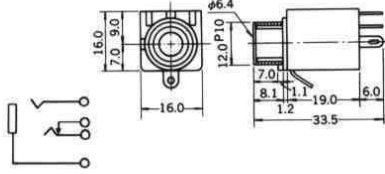

No.MJ-187LP

3-CONDUCTOR OPEN CIRCUIT
PHONE JACK
Net Weight : 9 gr.

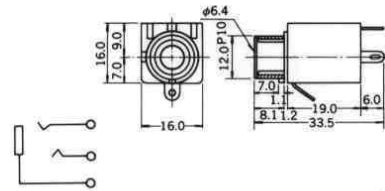

No.MJ-186LP

2-CONDUCTOR CLOSED CIRCUIT
PHONE JACK
Net Weight : 9 gr.

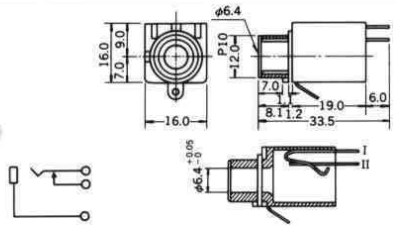

No.MJ-185LP

2-CONDUCTOR OPEN CIRCUIT
PHONE JACK
Net Weight : 9 gr.

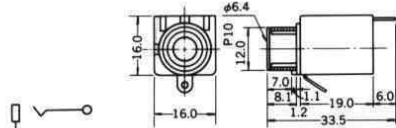

No.MJ-018E

3-CONDUCTOR DOUBLE CLOSED
CIRCUIT PHONE JACK
Net Weight : 13 gr.

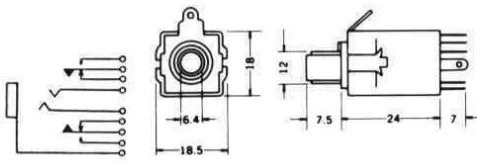

No.MJ-188LP-1~8

PC TYPE 3-CONDUCTOR
CIRCUIT 1/4" PHONE JACK
Net Weight : 11 gr.

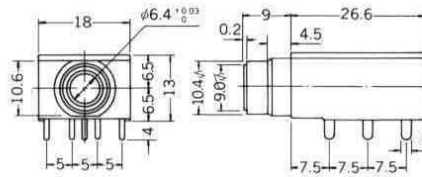

No.MX-616BLB

MONO
Net Weight : 3.5 gr.

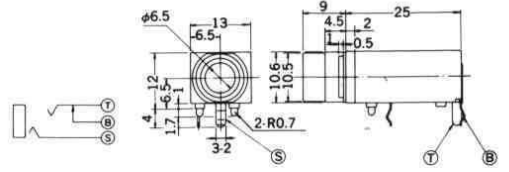

No.MX-616GLB

STEREO
Net Weight : 3.5 gr.

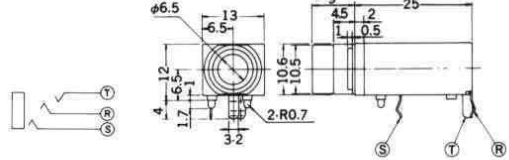

No.MX-617BMB

MONO
Net Weight : 3.5 gr.

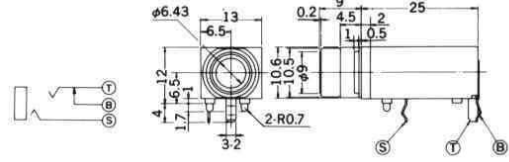

No.MX-617GMB

STEREO
Net Weight : 4 gr.

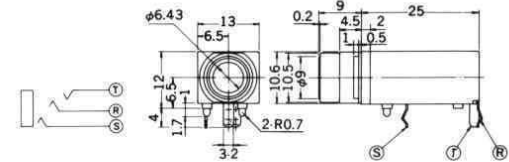

No.MJ-188

3-CONDUCTOR
CIRCUIT PHONE JACK
Net Weight : 12.5 gr.

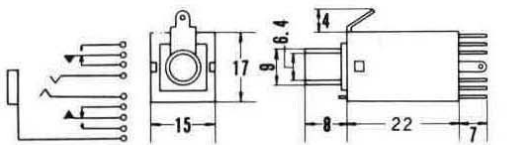

SCHEMATIC

STYLE	Dimensions, I	Dimensions, H				
		6.5	MJ-188LP-8	MJ-188LP-6	MJ-188LP-6S	MJ-188LP-5S
MJ-188LP-5	MJ-188LP-3	MJ-188LP-4	MJ-188LP-2S	MJ-188LP-2	MJ-188LP-1	

No.MJ-073 STEREO
No.MJ-164A MONO (3.5φ)

3-CON. MINIATURE INLINE JACK w/cable protector
Net Weight: 3.5 gr

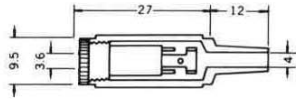

No.MJ-075 STEREO (3.5φ)
No.MJ-164 MONO

Net Weight: 3 gr

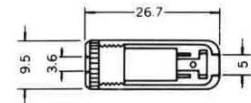

No.MJ-072 STEREO
No.MJ-165A MONO (2.5φ)

Net Weight: 3 gr

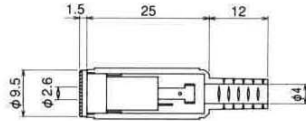

No.MJ-071 STEREO (2.5φ)
No.MJ-165 MONO

SUB-MINIATURE INLINE JACK
Net Weight: 3 gr

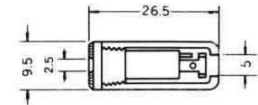

No.MJ-168A MONO(6.3φ)

2-CON. 1/4" PHONE INLINE JACK
Net Weight: 8 gr

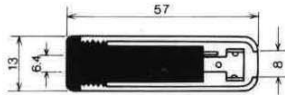

No.MJ-076M STEREO (3.5φ)
No.MJ-166M MONO

Net Weight: 6 gr

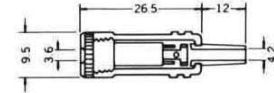

No.MJ-177MS STEREO (6.3φ)
No.MJ-169MS MONO

Net Weight: 12.5 gr

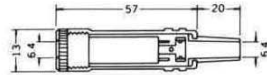

No.MJ-117M STEREO (6.3φ)
No.MJ-116M MONO

Net Weight: 8 gr

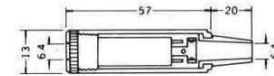

No.MJ-177A STEREO(6.3φ)

3-CON. 1/4" PHONE INLINE JACK w/shielded handle
Net Weight: 12.5 gr

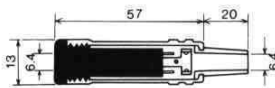

No.MJ-175M STEREO (6.3φ)
No.MJ-168M MONO

Color: Black,Red,Gray
Net Weight: 8 gr

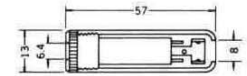

No.MJ-169A MONO(6.3φ)

2-CON. 1/4" PHONE INLINE JACK w/shielded handle
Net Weight: 12.5 gr

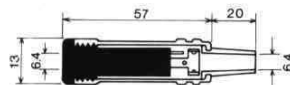

No.MJ-116A MONO(6.3φ)

2-CON. 1/4" PHONE INLINE JACK
Net Weight: 8 gr

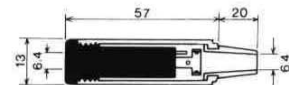

No.MJ-117A STEREO(6.3φ)

3-CON. 1/4" PHONE INLINE JACK
Net Weight: 8 gr

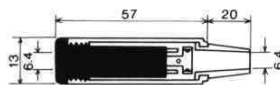

No.MJ-175A STEREO(6.3φ)

3-CON. 1/4" PHONE INLINE JACK
Net Weight: 8 gr

