

AC "Z" SERIES XLR METAL CHASSIS MOUNT CONNECTORS



The metal chassis mount "Z" series connectors are designed for the audio user where durability, reliability and strength across a wide range of applications are important. All AC products are manufactured to the highest quality standards and will withstand the harshest environments. This range complies with IEC268-12 and AES 14-1992 standards. CSA File Number 68598

Features

- The "D" size housing can be either front or rear mounted using the same panel cutout.
- The "P" size housing is the original wide flange front mounting XLR connector. "PN" is the original narrow flange front mounting male connector.
- A leading first mate last break socket contact is standard on all female connectors (Pin 1).
- Solder cup or Vertical PCB versions.
- Connectors are fitted with a grounding system for RFI shielding applications.
- Available in 3, 4, 5, 6A and 7 contact arrangements.
- Compatible with all other XLR brands.

Options

- Solder Bucket termination
- Vertical PCB contacts
- Zinc Diecast Shell - Satin Nickel Finish
- Zinc Diecast Shell - Black Polyester Finish
- Gold, Silver or Tin Plated Contacts
- Bulk Packaging
- Single Bag packs
- Precision machined contacts
- Cost effective stamped contacts on 3 pole
- Latchless versions (Non-Latching) (Female only)

Note: A ground tag is standard on all AC "Z" series connectors. Although the ground tag is intended for RFI shielding applications, Amphenol cannot guarantee its effectiveness in all cases.

The non-conductive Black polyester finish insulates the ground tag from the shell and should not be used in applications requiring ground contact to the shell.

Ordering Codes

We have listed the more common ordering codes in each section. For further options please refer to the part number breakdown charts. Please contact us if you need any further assistance.

Simple steps to guide you in using this catalogue

- 1) Identify the product group listed in Contents on Page 1 and go directly to that page number.
- 2) Each product group cover page then details information and options available.
- 3) Refer to the product detail pages and identify the product you require pictorially.
- 4) Read the product description column for the products standard features.
- 5) Use variations column to determine your choice.
- 6) Identify part number.
- 7) In the event the particular option you require is not listed please refer to the part number breakdown page at the end of each section.
- 8) Please contact us directly if you have any further problems.



Features:

- Zinc Diecast Shell.
- D size housing can be front or rear mounted using the same panel cutout.
- Solder Bucket connections.
- Vertical PCB mounting (not available in 4 contact female).
- Precision machined or Stamped contacts (3 pin only).
- Leading first mate last break socket contact.
- Positive latch lock system.

Options: Stamped contacts (3 contact only), Gold plated contacts, Vertical PCB contacts, Black finish, Non-Latching(Female only), Bulk Pack.

Part Number Breakdown: [Page 24](#)

Specifications: [Page 25](#)

PCB Footprints: [Page 26](#)

Panel Cutouts: [Page 26](#)

PRODUCT - FIGURE	DRAWING	Dimensions in mm (Inches)	DESCRIPTION	VARIATIONS	PART NUMBER
		<p>SOLDER CONTACTS: 2.7 [1.06\"/> </p>	XLR 3 pole male, D Flange, Machined contacts, Nickel Finish	Standard	AC3MMDZ
			Gold Plated Contacts	AC3MMDZ-AU	
			Vertical PCB	AC3MMDZV	
			Bulk Pack	AC3MMDZ BULK	
		<p>SOLDER CONTACTS: 5.5 [.217\"/> </p>	XLR 3 pole male, D Flange, Machined contacts, Black Finish	Standard	AC3MMDZB
			Gold Plated Contacts	AC3MMDZB-AU	
			Vertical PCB	AC3MMDZVB	
			Bulk Pack	AC3MMDZB BULK	
		<p>SOLDER CONTACTS: 2.7 [1.06\"/> </p>	XLR 3 pole male, D Flange, Stamped contacts, Nickel Finish	Standard	AC3MDZ
			Gold Plated Contacts	AC3MDZ-AU	
			Vertical PCB	AC3MDZV	
			Bulk Pack	AC3MDZ BULK	
		<p>SOLDER CONTACTS: 5.5 [.217\"/> </p>	XLR 3 pole male, D Flange, Stamped contacts, Black Finish	Standard	AC3MDZB
			Gold Plated Contacts	AC3MDZB-AU	
			Vertical PCB	AC3MDZVB	
			Bulk Pack	AC3MDZB BULK	
		<p>SOLDER CONTACTS: 6.5 [.256\"/> </p>	XLR 3 pole female, D Flange, Stamped contacts, Nickel Finish	Standard	AC3FDZ
			Gold Plated Contacts	AC3FDZ-AU	
			Vertical PCB	AC3FDZV	
			Bulk Pack	AC3FDZ BULK	
		<p>SOLDER CONTACTS: 5.5 [.217\"/> </p>	XLR 3 pole female, D Flange, Stamped contacts, Black Finish	Standard	AC3FDZB
			Gold Plated Contacts	AC3FDZB-AU	
			Vertical PCB	AC3FDZVB	
			Bulk Pack	AC3FDZB BULK	



PRODUCT - FIGURE	DRAWING	Dimensions in mm (inches)	DESCRIPTION	VARIATIONS	PART NUMBER
			XLR 4 pole male, D Flange, Machined contacts, Nickel Finish	Standard	AC4MDZ
				Gold Plated Contacts	AC4MDZ-AU
			XLR 4 pole male, D Flange, Machined contacts, Black Finish	Vertical PCB	AC4MDZV
				Bulk Pack	AC4MDZ BULK
			XLR 4 pole female, D Flange, Stamped contacts, Nickel Finish	Standard	AC4FDZ
				Gold Plated Contacts	AC4FDZ-AU
			XLR 4 pole female, D Flange, Stamped contacts, Black Finish	Vertical PCB	AC4FDZV
				Bulk Pack	AC4FDZ BULK
			XLR 5 pole male, D Flange, Machined contacts, Nickel Finish	Standard	AC5MDZ
				Gold Plated Contacts	AC5MDZ-AU
			XLR 5 pole male, D Flange, Machined contacts, Black Finish	Vertical PCB	AC5MDZV
				Bulk Pack	AC5MDZ BULK
			XLR 5 pole female, D Flange, Stamped contacts, Nickel Finish	Standard	AC5FDZ
				Gold Plated Contacts	AC5FDZ-AU
			XLR 5 pole female, D Flange, Machined contacts, Black Finish	Vertical PCB	AC5FDZV
				Bulk Pack	AC5FDZ BULK
			XLR 5 pole female, D Flange, Machined contacts, Black Finish	Standard	AC5FDZB
				Gold Plated Contacts	AC5FDZB-AU
				Vertical PCB	AC5FDZVB
				Bulk Pack	AC5FDZB BULK



PRODUCT - FIGURE	DRAWING	Dimensions in mm (inches)	DESCRIPTION	VARIATIONS	PART NUMBER
		<p>Dimensions in mm (inches)</p> <p>19.0 [.748\"/> </p>	XLR 6A pole male, D Flange, Machined contacts, Nickel Finish	Standard	AC6AMDZ
			Gold Plated Contacts	AC6AMDZ-AU	
		<p>Dimensions in mm (inches)</p> <p>19.0 [.748\"/> </p>	XLR 6A pole male, D Flange, Machined contacts, Black Finish	Vertical PCB	AC6AMDZV
			Gold Plated Contacts	AC6AMDZB	
		<p>Dimensions in mm (inches)</p> <p>19.0 [.748\"/> </p>	XLR 6A pole male, D Flange, Machined contacts, Black Finish	Bulk Pack	AC6AMDZ BULK
			Gold Plated Contacts	AC6AMDZB-AU	
		<p>Dimensions in mm (inches)</p> <p>26.0 [1.024\"/> </p>	XLR 6A pole female, D Flange, Machined contacts, Nickel Finish	Vertical PCB	AC6AFDZV
			Gold Plated Contacts	AC6AFDZ	
		<p>Dimensions in mm (inches)</p> <p>26.0 [1.024\"/> </p>	XLR 6A pole female, D Flange, Machined contacts, Black Finish	Bulk Pack	AC6AFDZ BULK
			Gold Plated Contacts	AC6AFDZB	
		<p>Dimensions in mm (inches)</p> <p>26.0 [1.024\"/> </p>	XLR 6A pole female, D Flange, Machined contacts, Black Finish	Vertical PCB	AC6AFDZVB
			Gold Plated Contacts	AC6AFDZB-AU	
		<p>Dimensions in mm (inches)</p> <p>26.0 [1.024\"/> </p>	XLR 6A pole female, D Flange, Machined contacts, Black Finish	Bulk Pack	AC6AFDZB BULK
			Gold Plated Contacts	AC6AFDZB-AU	
		<p>Dimensions in mm (inches)</p> <p>19.0 [.748\"/> </p>	XLR 7 pole male, D Flange, Gold Plated Machined contacts, Nickel Finish	Vertical PCB	AC7MDZV
			Standard	AC7MDZ	
		<p>Dimensions in mm (inches)</p> <p>19.0 [.748\"/> </p>	XLR 7 pole male, D Flange, Gold Plated Machined contacts, Black Finish	Bulk Pack	AC7MDZ BULK
			Standard	AC7MDZB	
		<p>Dimensions in mm (inches)</p> <p>19.0 [.748\"/> </p>	XLR 7 pole male, D Flange, Gold Plated Machined contacts, Black Finish	Vertical PCB	AC7MDZVB
			Standard	AC7MDZB	
		<p>Dimensions in mm (inches)</p> <p>19.0 [.748\"/> </p>	XLR 7 pole male, D Flange, Gold Plated Machined contacts, Black Finish	Bulk Pack	AC7MDZB BULK
			Standard	AC7MDZB	
		<p>Dimensions in mm (inches)</p> <p>26.0 [1.024\"/> </p>	XLR 7 pole female, D Flange, Gold Plated Machined contacts, Nickel Finish	Vertical PCB	AC7FDZV
			Standard	AC7FDZ	
		<p>Dimensions in mm (inches)</p> <p>26.0 [1.024\"/> </p>	XLR 7 pole female, D Flange, Gold Plated Machined contacts, Black Finish	Bulk Pack	AC7FDZ BULK
			Standard	AC7FDZB	
		<p>Dimensions in mm (inches)</p> <p>26.0 [1.024\"/> </p>	XLR 7 pole female, D Flange, Gold Plated Machined contacts, Black Finish	Vertical PCB	AC7FDZVB
			Standard	AC7FDZB	
		<p>Dimensions in mm (inches)</p> <p>26.0 [1.024\"/> </p>	XLR 7 pole female, D Flange, Gold Plated Machined contacts, Black Finish	Bulk Pack	AC7FDZB BULK
			Standard	AC7FDZB	



Features:

- Zinc Diecast shell.
- The P size housing is the original wide flange front mounting XLR connector. PN is the original narrow, front mounting male connector.
- Solder Bucket connections.
- Vertical PCB mounting.
- Precision Machined or Stamped contacts (3 pin only).
- Leading first mate last break socket contact.
- Positive latch lock system.

Options: Stamped contacts (3 contact only), Gold plated contacts, Vertical PCB contacts, Black Finish, Non-Latching (Female only), Bulk Pack.

Part Number Breakdown: Page 24 **Specifications:** Page 25
PCB Footprints: Page 26 **Panel Cutouts:** Page 26



PRODUCT - FIGURE	DRAWING	Dimensions in mm (inches)	DESCRIPTION	VARIATIONS	PART NUMBER
		<p>2.4 [0.094"]</p> <p>25.5 [1.004"]</p> <p>27.0 [1.063"]</p> <p>36.8 [1.449"]</p> <p>22.2 [.874"]</p> <p>32.1 [1.265"]</p> <p>36.5 [1.437"]</p>	<p>XLR 3 pole male, Narrow flange, Machined contacts, Nickel Finish</p>	Standard	AC3MMPNZ
				Gold Plated Contacts	AC3MMPNZ-AU
				Vertical PCB	AC3MMPNZV
				Bulk Pack	AC3MMPNZ BULK
		<p>2.4 [0.094"]</p> <p>25.5 [1.004"]</p> <p>27.0 [1.063"]</p> <p>36.8 [1.449"]</p> <p>22.2 [.874"]</p> <p>32.1 [1.265"]</p> <p>36.5 [1.437"]</p>	<p>XLR 3 pole male, Narrow flange, Machined contacts, Black Finish</p>	Standard	AC3MMPNZB
				Gold Plated Contacts	AC3MMPNZB-AU
				Vertical PCB	AC3MMPNZVB
				Bulk Pack	AC3MMPNZB BULK
		<p>2.4 [0.094"]</p> <p>25.5 [1.004"]</p> <p>27.0 [1.063"]</p> <p>36.8 [1.449"]</p> <p>22.2 [.874"]</p> <p>32.1 [1.265"]</p> <p>36.5 [1.437"]</p>	<p>XLR 3 pole male, Narrow flange, Stamped contacts, Nickel Finish</p>	Standard	AC3MPNZ
				Gold Plated Contacts	AC3MPNZ-AU
				Vertical PCB	AC3MPNZV
				Bulk Pack	AC3MPNZ BULK
		<p>2.4 [0.094"]</p> <p>25.5 [1.004"]</p> <p>27.0 [1.063"]</p> <p>36.8 [1.449"]</p> <p>22.2 [.874"]</p> <p>32.1 [1.265"]</p> <p>36.5 [1.437"]</p>	<p>XLR 3 pole male, Narrow flange, Stamped contacts, Black Finish</p>	Standard	AC3MPNZB
				Gold Plated Contacts	AC3MPNZB-AU
				Vertical PCB	AC3MPNZVB
				Bulk Pack	AC3MPNZB BULK
		<p>2.4 [0.094"]</p> <p>25.0 [0.982"]</p> <p>27.2 [1.070"]</p> <p>26.4 [1.039"]</p> <p>36.7 [1.445"]</p> <p>16.7 [.656"]</p> <p>31.5 [1.238"]</p> <p>36.0 [1.415"]</p>	<p>XLR 3 pole male, Wide flange, Machined contacts, Nickel Finish</p>	Standard	AC3MMP
				Gold Plated Contacts	AC3MMP-AU
				Vertical PCB	AC3MMPV
				Bulk Pack	AC3MMP BULK
		<p>2.4 [0.094"]</p> <p>25.0 [0.982"]</p> <p>27.2 [1.070"]</p> <p>26.4 [1.039"]</p> <p>36.7 [1.445"]</p> <p>16.7 [.656"]</p> <p>31.5 [1.238"]</p> <p>36.0 [1.415"]</p>	<p>XLR 3 pole male, Wide flange, Machined contacts, Black Finish</p>	Standard	AC3MMPB
				Gold Plated Contacts	AC3MMPB-AU
				Vertical PCB	AC3MMPVB
				Bulk Pack	AC3MMPB BULK







PRODUCT - FIGURE	DRAWING	Dimensions in mm (inches)	DESCRIPTION	VARIATIONS	PART NUMBER
			XLR 3 pole male, Wide flange, Stamped contacts, Nickel Finish	Standard	AC3MP
Gold Plated Contacts				AC3MP-AU	
Vertical PCB				AC3MPV	
Bulk Pack				AC3MP BULK	
			XLR 3 pole male, Wide flange, Stamped contacts, Black Finish	Standard	AC3MPB
Gold Plated Contacts				AC3MPB-AU	
Vertical PCB				AC3MPVB	
Bulk Pack				AC3MPB BULK	
			XLR 3 pole female, Wide flange, Stamped contacts, Nickel Finish	Standard	AC3FPZ
Gold Plated Contacts				AC3FPZ-AU	
Vertical PCB				AC3FPZV	
Bulk Pack				AC3FPZ BULK	
			XLR 3 pole female, Wide flange, Stamped contacts, Black Finish	Standard	AC3FPZB
Gold Plated Contacts				AC3FPZB-AU	
Vertical PCB				AC3FPZVB	
Bulk Pack				AC3FPZB BULK	
			XLR 4 pole male, Narrow flange, Machined contacts, Nickel Finish	Standard	AC4MPNZ
Gold Plated Contacts				AC4MPNZ-AU	
Vertical PCB				AC4MPNZV	
Bulk Pack				AC4MPNZ BULK	
			XLR 4 pole male, Narrow flange, Machined contacts, Black Finish	Standard	AC4MPNZB
Gold Plated Contacts				AC4MPNZB-AU	
Vertical PCB				AC4MPNZVB	
Bulk Pack				AC4MPNZB BULK	
			XLR 4 pole male, Wide flange, Machined contacts, Nickel Finish	Standard	AC4MP
Gold Plated Contacts				AC4MP-AU	
Vertical PCB				AC4MPV	
Bulk Pack				AC4MP BULK	
			XLR 4 pole male, Wide flange, Machined contacts, Black Finish	Standard	AC4MPB
Gold Plated Contacts				AC4MPB-AU	
Vertical PCB				AC4MPVB	
Bulk Pack				AC4MPB BULK	



PRODUCT - FIGURE	DRAWING	Dimensions in mm (inches)	DESCRIPTION	VARIATIONS	PART NUMBER
			XLR 4 pole female, Wide flange, Stamped contacts, Nickel Finish	Standard	AC4FPZ
Gold Plated Contacts				AC4FPZ- AU	
Vertical PCB				AC4FPZV	
Bulk Pack				AC4FPZ BULK	
			XLR 4 pole female, Wide flange, Stamped contacts, Black Finish	Standard	AC4FPZB
Gold Plated Contacts				AC4FPZB- AU	
Vertical PCB				AC4FPZVB	
Bulk Pack				AC4FPZB BULK	
			XLR 5 pole male, Narrow flange, Machined contacts, Nickel Finish	Standard	AC5MPNZ
Gold Plated Contacts				AC5MPNZ- AU	
Vertical PCB				AC5MPNZV	
Bulk Pack				AC5MPNZ BULK	
			XLR 5 pole male, Narrow flange, Machined contacts, Black Finish	Standard	AC5MPNZB
Gold Plated Contacts				AC5MPNZB- AU	
Vertical PCB				AC5MPNZVB	
Bulk Pack				AC5MPNZB BULK	
			XLR 5 pole male, Wide flange, Machined contacts, Nickel Finish	Standard	AC5MP
Gold Plated Contacts				AC5MP- AU	
Vertical PCB				AC5MPV	
Bulk Pack				AC5MP BULK	
			XLR 5 pole male, Wide flange, Machined contacts, Black Finish	Standard	AC5MPB
Gold Plated Contacts				AC5MPB- AU	
Vertical PCB				AC5MPVB	
Bulk Pack				AC5MPB BULK	
			XLR 5 pole female, Wide flange, Machined contacts, Nickel Finish	Standard	AC5FPZ
Gold Plated Contacts				AC5FPZ- AU	
Vertical PCB				AC5FPZV	
Bulk Pack				AC5FPZ BULK	
			XLR 5 pole female, Wide flange, Machined contacts, Black Finish	Standard	AC5FPZB
Gold Plated Contacts				AC5FPZB- AU	
Vertical PCB				AC5FPZVB	
Bulk Pack				AC5FPZB BULK	

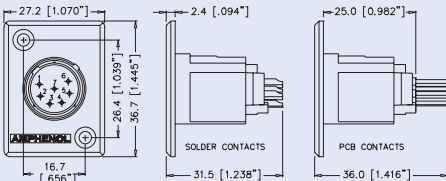

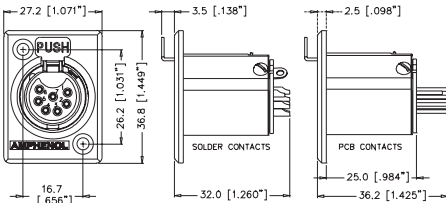
PRODUCT - FIGURE	DRAWING	Dimensions in mm (inches)	DESCRIPTION	VARIATIONS	PART NUMBER
		<p>2.4 [.094"] 25.5 [1.006"] 27.0 [1.063"] 36.8 [1.449"] 22.2 [.874"] 25.5 [1.006"] 32.1 [1.265"] 36.5 [1.435"]</p>	<p>XLR 6A pole male, Narrow flange, Machined contacts, Nickel Finish</p>	Standard	AC6AMPNZ
				Gold Plated Contacts	AC6AMPNZ- AU
				Vertical PCB	AC6AMPNZV
				Bulk Pack	AC6AMPNZ BULK
		<p>2.4 [.094"] 25.5 [1.006"] 27.0 [1.063"] 36.8 [1.449"] 22.2 [.874"] 25.5 [1.006"] 32.1 [1.265"] 36.5 [1.435"]</p>	<p>XLR 6A pole male, Narrow flange, Machined contacts, Black Finish</p>	Standard	AC6AMPNZB
				Gold Plated Contacts	AC6AMPNZB- AU
				Vertical PCB	AC6AMPNZVB
				Bulk Pack	AC6AMPNZB BULK
		<p>2.4 [.094"] 25.0 [0.982"] 27.2 [1.070"] 36.7 [1.445"] 26.4 [1.039"] 16.7 [.656"]</p>	<p>XLR 6A pole male, Wide flange, Machined contacts, Nickel Finish</p>	Standard	AC6AMP
				Gold Plated Contacts	AC6AMP- AU
				Vertical PCB	AC6AMPV
				Bulk Pack	AC6AMP BULK
		<p>2.4 [.094"] 25.0 [0.982"] 27.2 [1.070"] 36.7 [1.445"] 26.4 [1.039"] 16.7 [.656"]</p>	<p>XLR 6A pole male, Wide flange, Machined contacts, Black Finish</p>	Standard	AC6AMPB
				Gold Plated Contacts	AC6AMPB- AU
				Vertical PCB	AC6AMPVB
				Bulk Pack	AC6AMPB BULK
		<p>3.5 [1.138"] 2.5 [0.098"] 27.2 [1.071"] 36.8 [1.449"] 26.2 [1.031"] 16.7 [.656"]</p>	<p>XLR 6A pole female, Wide flange, Machined contacts, Nickel Finish</p>	Standard	AC6AFPZ
				Gold Plated Contacts	AC6AFPZ- AU
				Vertical PCB	AC6AFPZV
				Bulk Pack	AC6AFPZ BULK
		<p>3.5 [1.138"] 2.5 [0.098"] 27.2 [1.071"] 36.8 [1.449"] 26.2 [1.031"] 16.7 [.656"]</p>	<p>XLR 6A pole female, Wide flange, Machined contacts, Black Finish,</p>	Standard	AC6AFPZB
				Gold Plated Contacts	AC6AFPZB- AU
				Vertical PCB	AC6AFPZVB
				Bulk Pack	AC6AFPZB BULK
		<p>2.4 [.094"] 25.5 [1.006"] 27.0 [1.063"] 36.8 [1.449"] 22.2 [.874"] 25.5 [1.006"] 32.1 [1.265"] 36.5 [1.435"]</p>	<p>XLR 7 pole male, Narrow flange, Gold Plated Machined contacts, Nickel Finish</p>	Standard	AC7MPNZ
				Vertical PCB	AC7MPNZV
				Bulk Pack	AC7MPNZ BULK
		<p>2.4 [.094"] 25.5 [1.006"] 27.0 [1.063"] 36.8 [1.449"] 22.2 [.874"] 25.5 [1.006"] 32.1 [1.265"] 36.5 [1.435"]</p>	<p>XLR 7 pole male, Narrow flange, Gold Plated Machined contacts, Black Finish</p>	Standard	AC7MPNZB
				Vertical PCB	AC7MPNZVB
				Bulk Pack	AC7MPNZB BULK

PRODUCT - FIGURE	DRAWING	Dimensions in mm (inches)	DESCRIPTION	VARIATIONS	PART NUMBER		
			XLR 7 pole male, Wide flange, Gold Plated Machined contacts, Nickel Finish	Standard	AC7MP		
				Vertical PCB	AC7MPV		
				Bulk Pack	AC7MP BULK		
					XLR 7 pole male, Wide flange, Gold Plated Machined contacts, Black Finish	Standard	AC7MPB
						Vertical PCB	AC7MPVB
						Bulk Pack	AC7MPB BULK
			XLR 7 pole female, Wide flange, Gold Plated Machined contacts, Nickel Finish	Standard	AC7FPZ		
				Vertical PCB	AC7FPZV		
				Bulk Pack	AC7FPZ BULK		
					XLR 7 pole female, Wide flange, Gold Plated Machined contacts, Black Finish	Standard	AC7FPZB
						Vertical PCB	AC7FPZVB
						Bulk Pack	AC7FPZB BULK



PART NUMBER BREAKDOWN

METAL TYPE FLANGE



E. G . AC3MMPNZVB-AU BULK
AC (Series Prefix), **3** contacts, **Male**, **Machined** Contacts, **PN** (Narrow Flange),
Z (Metal Chassis Series), **Vertical** Printed Circuit Board, **Black** Polyester Finish,
- AU (Gold Plated Contacts), **Bulk** Packaged.

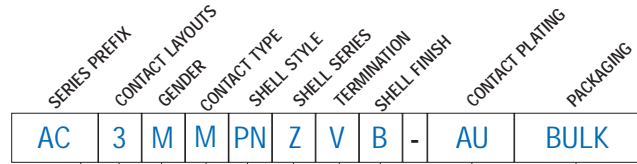

SERIES PREFIX	AC	=	Series Prefix
CONTACT LAYOUTS	3	=	3 Contacts
	4	=	4 Contacts
	5	=	5 Contacts
	6A	=	6 Contacts
	7	=	7 Contacts
GENDER	F	=	Female Socket Contacts
	M	=	Male Pin Contacts
MACHINED CONTACTS	Blank	=	Stamped Contacts
	M	=	Machined Contacts (Applicable 3 male pin contacts only)
NOTE: 4 - 7 contact connectors have machined contacts as standard. They are not available in stamped contacts.			
SHELL STYLE	D	=	Small Flange(front or rear mounting)
	P	=	Large Shell with wide flange
	PN	=	Large Shell with Narrow Flange (male only)
SHELL SERIES	Blank	=	Male P Shell Style only
	Z	=	Metal Chassis Series
TERMINATION	Blank	=	Solder Buckets
	V	=	Vertical Printed Circuit Board
SHELL FINISH	Blank	=	Nickel Plated Finish
	B	=	Black Polyester Finish
CONTACT PLATING	Blank	=	Standard Plating (Silver or Tin - Refer to Standard Data.)
	AU	=	Gold Plated
NOTE: 7 Contact is gold plated as standard.			
PACKAGING	Blank	=	Individual Bags
	BULK	=	Bulk Packed

Note: Non-Latching Versions (Female) available - Please contact us for part number options.

STANDARD DATA AC SERIES CHASSIS - METAL "Z"

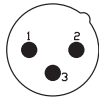
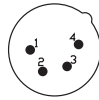
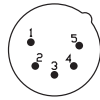
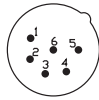
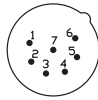
		VALUE				
GENERAL CHARACTERISTICS	Number of contacts	3	4	5	6A	7
	Contact Arrangement (Front view of pin inserts)					
	Termination	Solder Bucket / Printed Circuit Board (PCB)				
	Max. Wire Gauge - Stranded wire:					
	Solder	14AWG	16AWG	18AWG	18AWG	20AWG
	Printed Circuit Board - PCB	N/A	N/A	N/A	N/A	N/A
Flammability rating of plastics	UL94V-0					
Environmental	Complies with RoHS Directive 2002/95/EC					
ELECTRICAL CHARACTERISTICS	Service Voltage RMS	133V ¹⁾				
	Test Voltage AC RMS	1400V				
	Current carrying capacity:					
	Solder	15A	10A	7.5A	7.5A	5A
	Printed Circuit Board (PCB)	15A	10A	7.5A	7.5A	5A
	Typical Contact Resistance	≤ 3mΩ				
Insulation Resistance	≥ 1000MΩ					
CLIMATIC CHARACTERISTICS	Protection Class	IP40				
	Operating Temperature	-25 °C to +75 °C (-13°F to +167°F)				
MECHANICAL CHARACTERISTICS	Weight - Metal ²⁾	31g (0.068lb)	32g (0.070lb)	33g (0.072lb)	33g (0.072lb)	33g (0.072lb)
	Mechanical Operations	1000 mating cycles				
MATERIALS	Connector Shell	Diecast Zinc Alloy				
	Shell Finish	Satin Nickel or Black Polyester				
	Insulators	UL94V-0 PBT Resin or Modified PPE Resin				
	Male Contact					
	Stamped Solder and PCB-(Material/Plating)	Phosphor Bronze / Silver or Gold (optional)				
	Machined Solder-(Material/Plating)	Brass / Silver or Gold (optional)				
	Female Contact					
Stamped Solder and PCB-(Material/Plating)	Phosphor Bronze / Tin or Gold (optional)					
Machined Solder-(Material/Plating)	Brass / Silver or Gold (Optional) - 4 socket is tin plated					



Rev 2 - 09/2005

¹⁾ Not suitable for domestic applications above 50V

²⁾ Approximate weight only, does not include packaging. Please contact us for exact weight for shipping purposes.

AC SERIES CHASSIS METAL "Z"

PCB FOOTPRINTS STRAIGHT (V)

CONNECTOR SIDE OF PCB

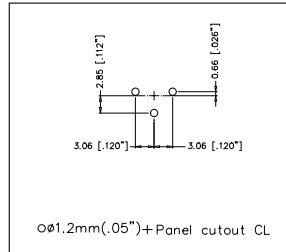

AC3F*ZV

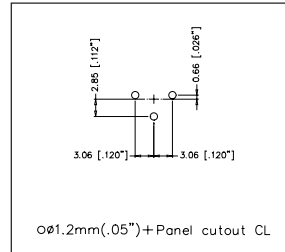

AC3M*ZV

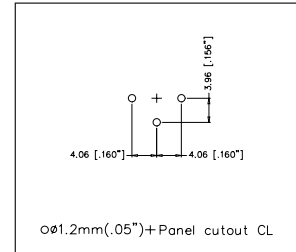

AC3MM*ZV

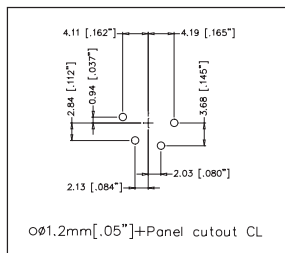

AC4F*ZV

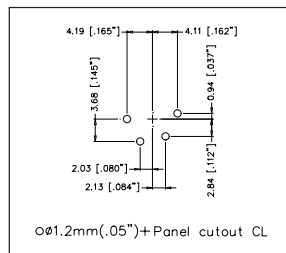

AC4M*ZV

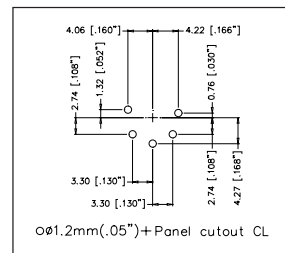

AC5F*ZV

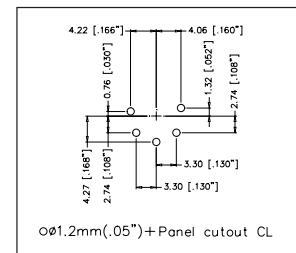

AC5M*ZV

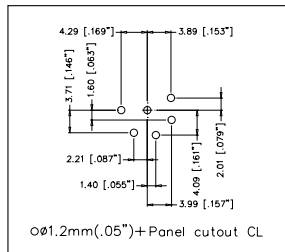

AC6AF*ZV

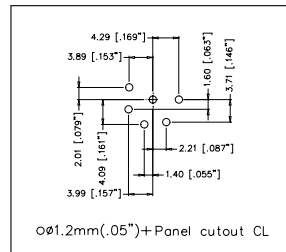

AC6AM*ZV

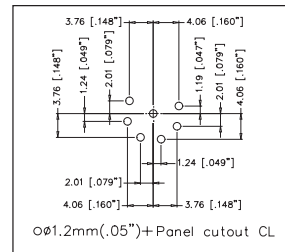

AC7F*ZV

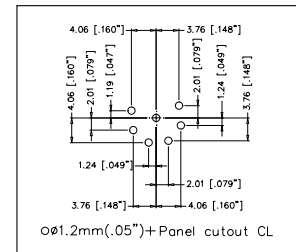

AC7M*ZV

PANEL CUTOUT DIMENSIONS

FRONT VIEW

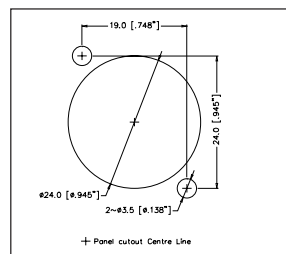

AC*FDZ

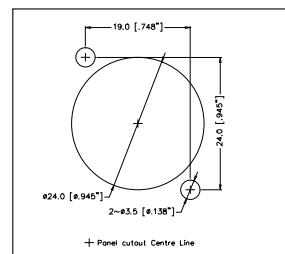

AC*MDZ

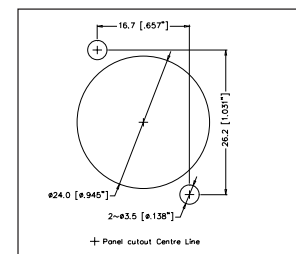

AC*FPZ

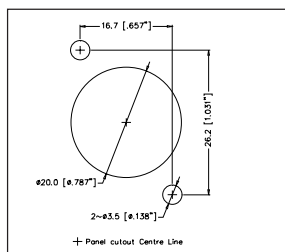

AC*MP

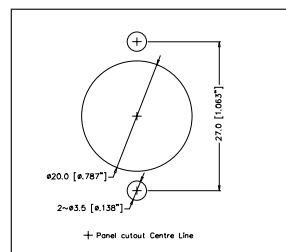

AC*MPNZ

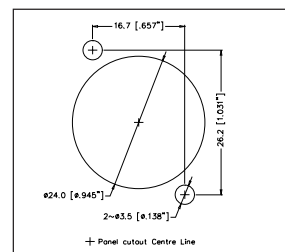

AC-PDN-31-XXX

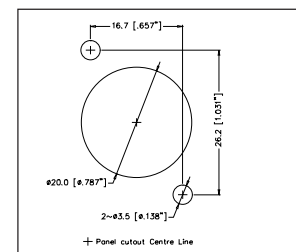

AC-PDN-34-XXX