

4

3

2

1

THIS DRAWING IS UNPUBLISHED. RELEASED FOR PUBLICATION.
 (C) COPYRIGHT IS BY AMP INCORPORATED. ALL RIGHTS RESERVED.

LOC	DIST	REV	DESCRIPTION	DATE	BY	APPD
AG	53	F	LM			
		J	REVISED PER 0650-0064-99	11 MAR 99	LM	JR

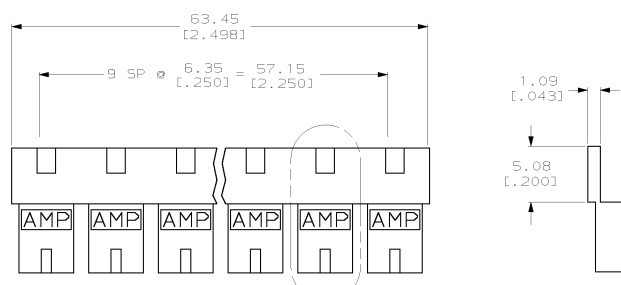

SEE DETAIL A

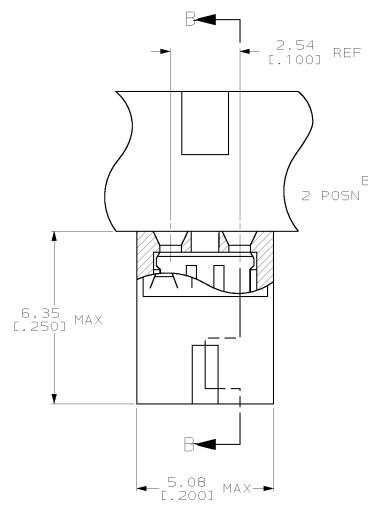

DETAIL A SCALE 10:1

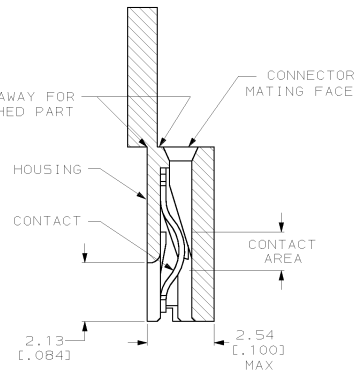

SECTION B-B SCALE 10:1

- 1 MATERIAL: HOUSING; GLASS-FILLED POLYESTER, COLOR-SEE TABLE.
- 2 CONTACT PLATED WITH 0.00254 [0.000100] TIN-LEAD OVER ALL.
- 3 CONTACT PLATED WITH 0.00038 [0.000015] GOLD IN CONTACT AREA OVER 0.00127 [0.000050] NICKEL OVER ALL.
- 4 PART NO. DENOTES INDIVIDUAL TWO POSITION SHUNT, WHICH IS PACKAGED ON BREAKAWAY COMBS OF TEN SHUNTS.
- 5 CONNECTOR MATES WITH WIRE WRAP POSTS, 0.64 [0.025] SQUARE OR ROUND AND 0.56 [0.022] X 0.66 [0.026] POSTS. LENGTH 5.08 [0.200] MINIMUM.
- 6 CONTACT PLATED WITH 0.00013 [0.000005] GOLD IN CONTACT AREA OVER 0.00127 [0.000050] NICKEL OVER ALL.
- 7 PART NO. DENOTES INDIVIDUAL TWO POSITION SHUNT WHICH IS PACKAGED LOOSE PIECE.
- 8 CONTACT PLATED WITH 0.00076 [0.000030] GOLD IN CONTACT AREA OVER 0.00127 [0.000050] NICKEL OVER ALL.

CONTACT MATERIAL	HOUSING COLOR	FINISH	PART NO
PHOSPHOR BRONZE	BLACK	△	2-382811-0
	BLACK	△	1-382811-B
BERYLLIUM COPPER	BLACK	△	1-382811-6
	BLACK	△	1-382811-0
PHOSPHOR BRONZE	RED	△	382811-9
	BLACK	△	382811-8
	BLACK	△	382811-6
	BLACK	△	382811-5
	BLUE	△	382811-4
	BLUE	△	382811-2
	BLUE	△	382811-1
	BLUE	△	382811-1

SUPERSEDED BY 382811-2

THIS DRAWING IS A CONTROLLED DOCUMENT.		DATE	BY	APPD	AMP Incorporated
DRAWN BY: SORAH		8-18-93			Harrisburg, PA 17105-3608
CHECKED BY: TALLEY		8-23-93			
APPROVED BY: HUFFMAN		8-23-93			
DIMENSIONS IN (INCHES)		PROJECT SPEC		108-1476	
TOLERANCES UNLESS SPECIFIED:		APPLICATION SPEC		114-1059	
FRACTIONS		WEIGHT		-	
MATERIAL: SEE TABLE		FINISH: SEE TABLE		CUSTOMER DRAWING	
HOUSING: SEE TABLE		CONTACT: SEE TABLE		SCALE: 4:1	
SHEET 1 OF 1		REV 3		RESTRICTED TO	

382811