



# JB6 Jumper Bars

## Terminal Blocks Accessories

### Features and Benefits

Facilitate & secure your jumper bar assembly process:

- Screwless mounting,
- Pre-cut poles for various circuits configurations,
- Insulated,
- Positive locking.

### Main Technical Data

	IEC	cULus - CSA	Ex e
Rated current	41 A	30 A	
Rated voltage	Standard use 1000 V	600 V	630 V
	Cut extremities 800 V	300 V	Not authorized
	Cut poles 400 V	300 V	Not authorized
Impulse withstand voltage	8000 V		
Protection	IP 20	NEMA 1	

### Mounting Instructions

Screwless

Tool

Torque

Material Specifications	Insulating material	Polyamide	
	Flammability	V0	
	NF F 16 101	I2F2	
Ambient temperature min/max	Service IEC 60068-2-1	-55 +110 °C	-67 +230 F
	Storage	-55 +110 °C	-67 +230 F
	Installing	-5 +40 °C	-23 +104 F

### Ordering Details

#### JB6 Jumper Bars

Description	Type	Order Code	Pack <sup>(mg)</sup> pieces	Weight g (1 pce)	
6 mm 0.236 in spacing	Orange	2 poles	<b>JB6-2</b>	<b>1SNK 906 302 R0000</b>	50 1.30
		3 poles	<b>JB6-3</b>	<b>1SNK 906 303 R0000</b>	50 2.10
		4 poles	<b>JB6-4</b>	<b>1SNK 906 304 R0000</b>	50 2.90
		5 poles	<b>JB6-5</b>	<b>1SNK 906 305 R0000</b>	50 3.60
		10 poles	<b>JB6-10</b>	<b>1SNK 906 310 R0000</b>	20 7.40
		50 poles	<b>JB6-50</b>	<b>1SNK 906 350 R0000</b>	10 38.10

#### JB6 Accessories

Description	Type	Order Code	Pack <sup>(mg)</sup> pieces	Weight g (1 pce)
1 Circuit Separators	Dark Grey	<b>CS</b>	<b>1SNK 900 101 R0000</b>	20 0.20

### JB6 Mounting Instructions

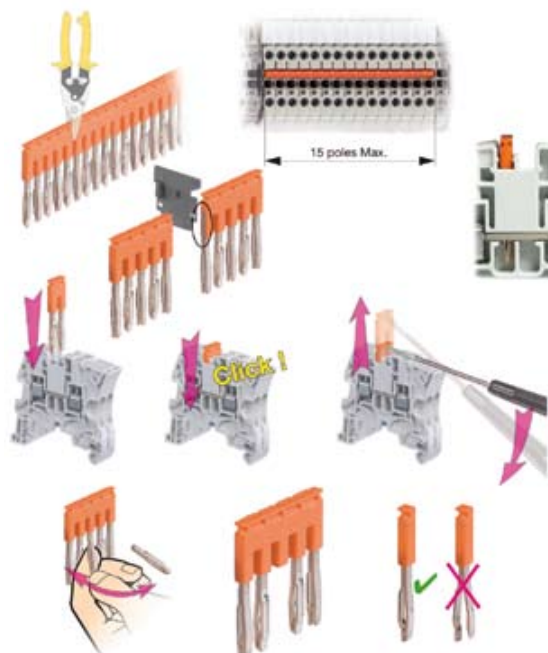

- Caution: use of 50 poles jumper bars or cut jumper bars is not allowed in Explosive atmospheres,
- Jumper bar with cut extremities: when mounted on feed-through or ground terminal blocks: the circuit separator CS must be installed on the cut side,
- Jumper bar with cut poles: for alternated jumpering between terminal blocks.