

JACK SCREWS

- Equivalent to AMP, CANNON & TRW Jack Screws
- "D" subminiature connector mounting screw
- Other sizes upon request

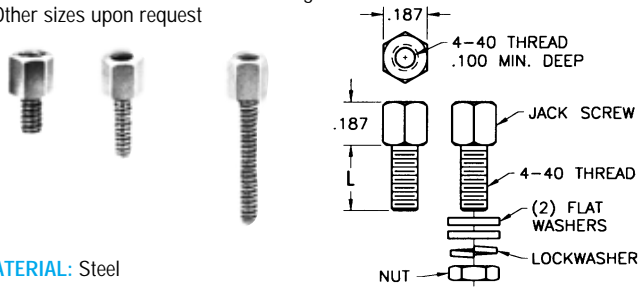

MATERIAL: Steel

JACK ONLY		"L" DIM.	JACK WITH HARDWARE (Supplied Unassembled in Bulk)	
ZINC PLATE & GOLD IRIDITE	ZINC PLATE & CLEAR CHROMATE		ZINC PLATE & GOLD IRIDITE	ZINC PLATE & CLEAR CHROMATE
7228	7228-5	.250	7229	7229-5
7230	7230-5	.312	7231	7231-5
7232	7232-5	.625	7233	7233-5

SEMS JACK SCREWS

- "D" subminiature connector mounting screw
- Captivated helical spring lockwasher, simplifies use
- Flat washer and nut supplied unassembled

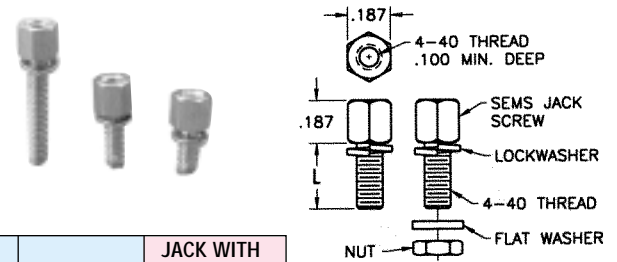

"L" DIM.	JACK ONLY CAT. NO.	JACK WITH HARDWARE (Supplied Unassembled in Bulk)
.285	7235	7236
.347	7237	7238
.660	7239	7240

MATERIAL: Steel, Zinc Plate & Clear Chromate

MOUNTING HARDWARE

Our assortment of standard clips and washers offer the needed flexibility to secure your connectors in the manner best suited to your instrumentation and design.

"U" CLIP

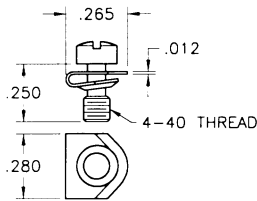

MATERIAL: Clip & Screw: Steel, Zinc Plate & Gold Iridite

CAT. NO. 2062

SADDLE WASHER

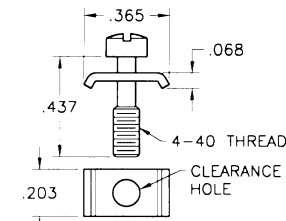

MATERIAL: Clip & Screw: Steel, Zinc Plate & Gold Iridite

CAT. NO. 2063

"BOW TIE" RETAINING CLIP

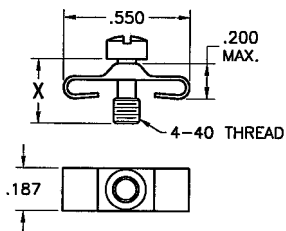

MATERIAL: Clip & Screw: Steel, Zinc Plate & Gold Iridite

CAT. NO.	X
2060	4-40 x 1/4
2061	4-40 x 9/32

TURNABLE JACK SCREWS

Turnable jack screws, available with or without screwdriver slot make mating and disconnecting computer connectors quick and easy.

DIRECT ACCESS

AVAILABLE WITH OR WITHOUT SCREWDRIVER SLOT.

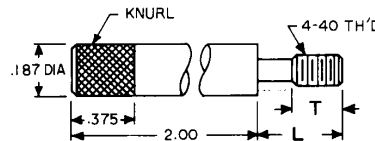

"T" DIM.	"L" DIM.	CAT. NO. WITHOUT SLOT	CAT. NO. WITH SLOT
.125	.250	2064	2065
.250	.437	2066	2067

MATERIAL: Steel, Black Oxide

STRAIGHT KNURL

AVAILABLE WITH OR WITHOUT SCREWDRIVER SLOT.

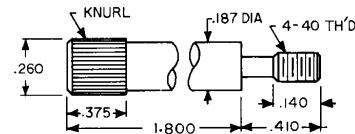

CAT. NO. WITHOUT SLOT	CAT. NO. WITH SLOT
2072	2073

MATERIAL: Steel, Zinc Plate & Clear Chromate

SLIM LINE

AVAILABLE WITH OR WITHOUT SCREWDRIVER SLOT.

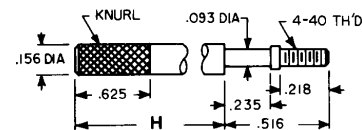

"H" DIM.	CAT. NO. WITHOUT SLOT	CAT. NO. WITH SLOT
1.250	2068	2069
1.750	2070	2071

MATERIAL: Steel, Nickel Plate