

7 6 5 4 3 2 1

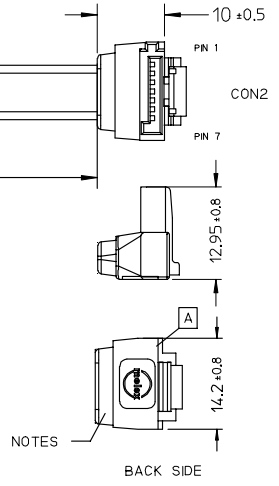
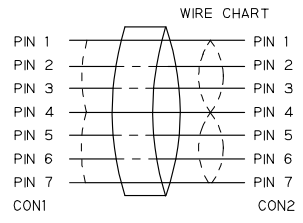
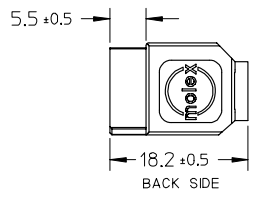
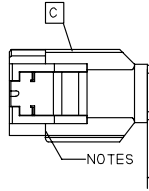
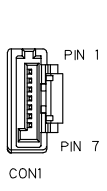

NOTE:
 PHYSICAL
 1. OUTER MOLD WITH BLACK PVC RESIN 887800042.
 INNER MOLD WITH PE RESIN 887800008.
 ELECTRICAL PERFORMANCE:
 2. DIELECTRONIC STRENGTH:500V DC/0.01S.
 3. INSULATION RESISTANCE:100M OHMS MIN.
 4. CONDUCTIVE RESISTOR: 2 OHMS MAX.

MOLEX P/N	LENGTH (mm)	LENGTH (inch)	DESCRIPTION
68561-0017	1000+/-20	40.0+/-0.8	S-ATA LATCHING STRAIGHT TO R/A CABLE, RED
68561-0016	500+/-10	20.0+/-0.4	S-ATA LATCHING STRAIGHT TO R/A CABLE, RED

ITEM	DESCRIPTION	QTY.
C	S-ATA STRAIGHT CONN. 674899002	1
B	2PX26AWG S-ATA CABLE RED 887808052	1
A	S-ATA R/A CONN. 674890002	1

ENTER DESCRIPTION EC NO: DG2005-0125 DRWN: JLU13 CHKD: TEDDY APPR: KAN 2005/04/04 2005/04/04 2005/04/04	QUALITY SYMBOLS 	GENERAL TOLERANCES (UNLESS SPECIFIED)		DIMENSION STYLE MM ONLY		SCALE ---		DESIGN UNITS METRIC		THIRD ANGLE PROJECTION																
		<table border="1"> <thead> <tr> <th></th> <th>mm</th> <th>INCH</th> </tr> </thead> <tbody> <tr> <td>4 PLACES</td> <td>±---</td> <td>±---</td> </tr> <tr> <td>3 PLACES</td> <td>±---</td> <td>±---</td> </tr> <tr> <td>2 PLACES</td> <td>±---</td> <td>±---</td> </tr> <tr> <td>1 PLACE</td> <td>±---</td> <td>±---</td> </tr> </tbody> </table>			mm	INCH	4 PLACES	±---	±---	3 PLACES	±---	±---	2 PLACES	±---	±---	1 PLACE	±---	±---	DRAWN BY JLU13		DATE 2005/04/04		TITLE S-ATA STRAIGHT LATCHING TO R/A LATCHING SIGNAL CBL RED,0.5M,1.0M			
			mm	INCH																						
		4 PLACES	±---	±---																						
3 PLACES	±---	±---																								
2 PLACES	±---	±---																								
1 PLACE	±---	±---																								
ANGULAR ±---°		CHECKED BY TEDDY		DATE 2005/04/04																						
DRAFT WHERE APPLICABLE MUST REMAIN WITHIN DIMENSIONS		APPROVED BY BORON		DATE 2005/04/04		MATERIAL NO. 685610017		DOCUMENT NO. SD-68561-0017		SHEET NO. 1 OF 1																
SIZE A4 THIS DRAWING CONTAINS INFORMATION THAT IS PROPRIETARY TO MOLEX INCORPORATED AND SHOULD NOT BE USED WITHOUT WRITTEN PERMISSION																										

ib_frame_A4_P_ME_T
 Rev. D 2004/04/02

6 5 4 3 2 1

7 6 5 4 3 2 1

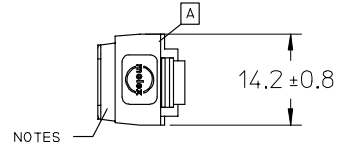
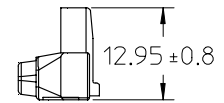
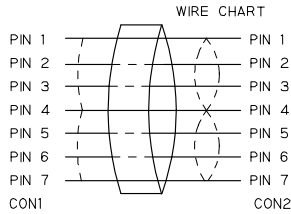
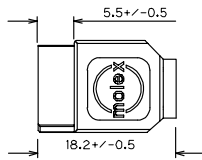
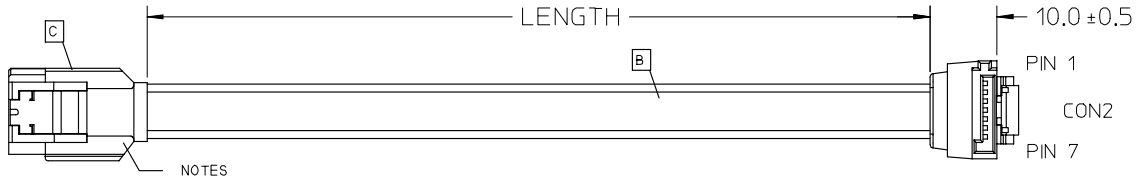
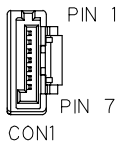

- NOTE:
PHYSICAL
1. OUTER MOLD WITH BLACK PVC RESIN 887800042
- ELECTRICAL PERFORMANCE:
2. DIELECTRIC STRENGTH: 500V DC
3. INSULATION RESISTANCE: 100M OHMS
4. CONDUCTIVE RESISTOR: 2 OHMS

68561-0017	1000+/-20	40.0+/-0.8	S-ATA LATCHING STRAIGHT TO R/A CABLE, RED
68561-0016	500+/-10	20.0+/-0.4	S-ATA LATCHING STRAIGHT TO R/A CABLE, RED
MOLEX P/N	LENGTH (mm)	LENGTH (inch)	DESCRIPTION

C	S-ATA STRAIGHT CONN. 674899002		1
B	2PX26AWG S-ATA CABLE RED 887808052	N/A	1
A	S-ATA R/A CONN. 674890002		1
ITEM	DESCRIPTION	L	QTY.

ENTER DESCRIPTION EC NO: DG2005-0009 DRWNG: GX YANG CHKD: 2004/08/18 APPR: BOCHEN 2004/08/18	QUALITY SYMBOLS ▽=0 ▽=0	GENERAL TOLERANCES (UNLESS SPECIFIED)		DIMENSION STYLE MM ONLY		SCALE ---		DESIGN UNITS METRIC		THIRD ANGLE PROJECTION																
		<table border="1"> <tr> <th></th> <th>mm</th> <th>INCH</th> </tr> <tr> <td>4 PLACES</td> <td>±---</td> <td>±---</td> </tr> <tr> <td>3 PLACES</td> <td>±---</td> <td>±---</td> </tr> <tr> <td>2 PLACES</td> <td>±---</td> <td>±---</td> </tr> <tr> <td>1 PLACE</td> <td>±---</td> <td>±---</td> </tr> </table>			mm	INCH	4 PLACES	±---	±---	3 PLACES	±---	±---	2 PLACES	±---	±---	1 PLACE	±---	±---	DRAWN BY GX YANG		DATE 04/08/10		TITLE S-ATA STRAIGHT LATCHING TO R/A LATCHING SIGNAL CBL RED,0.5M,1.0M			
			mm	INCH																						
		4 PLACES	±---	±---																						
3 PLACES	±---	±---																								
2 PLACES	±---	±---																								
1 PLACE	±---	±---																								
ANGULAR ±---°		CHECKED BY TEDDY		DATE 04/08/10																						
DRAFT WHERE APPLICABLE MUST REMAIN WITHIN DIMENSIONS		MATERIAL NO. 685610016/7		APPROVED BY BORON		DATE 04/08/10		MOLEX INCORPORATED		SHEET NO. 1 OF 1																
THIS DRAWING CONTAINS INFORMATION THAT IS PROPRIETARY TO MOLEX INCORPORATED AND SHOULD NOT BE USED WITHOUT WRITTEN PERMISSION																										

ib_frame_A4_P_ME_T
Rev. D 2004/04/02

6

5

4

3

2

1