

# DC Power Jack

## 16PJ101-EX

**KOBI**CONN

DC Power Jack

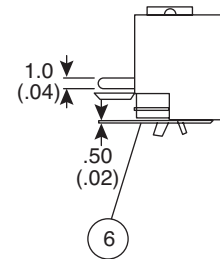
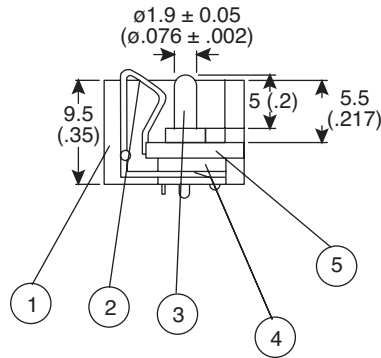
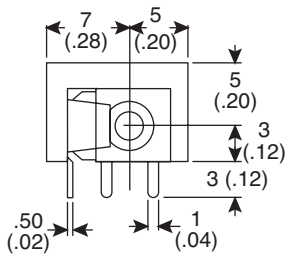
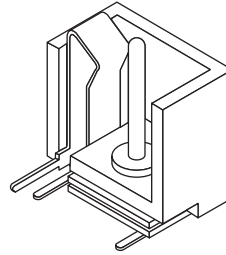
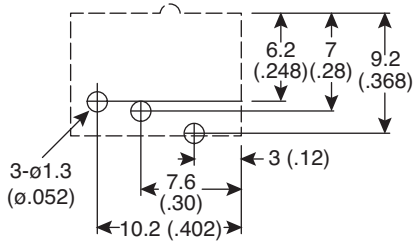

**DIMENSIONS: mm (In.)**

SPECIFICATIONS	
<b>Rated voltage:</b>	12VDC
<b>Rated current:</b>	1A
<b>Withstand voltage:</b>	500VAC
<b>Insulation resistance:</b>	>100MΩ @ 500VAC
<b>Contact resistance:</b>	<60mΩ
RoHS Compliant by Exemption	

Number	Part name	Quantity	Material	Remarks
1	Case	1	PBT	
2	Terminal A	1	Y cut M-EH	Ag plated
3	Center pin	1	Brass	Ag plated
4	Insulator	2	Phenolic resin	
5	Terminal B	1	Brass	Ag plated
6	Terminal C	1	Brass	Ag plated

Date Last Revised: 9-12-06

Available from Mouser Electronics  
1-800-346-6873  
www.mouser.com

KC-300863

16PJ101-EX