

Model 4771 Square Pin Receptacle To Banana Plug

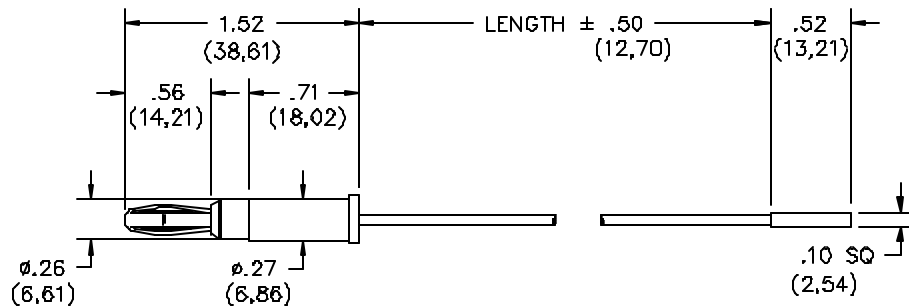

FEATURES:

- This patch cord is excellent for use as a jumper on circuit cards with 0.6 (.025) sq. pins and equipment with 4.2 (.166) dia. pin jacks.
- Mates to Model numbers 5790, 4521, 5360 and 5927.

MATERIALS:

Conn.: In-Line Banana Plug

Material: Spring – Beryllium Copper per QQ-C-533, Alloy 172, Cond. HT. Plug Body – Brass per QQ-B-626, Alloy 360, ½ Hard.

Finish: Nickel plated per QQ-N-290, Class 2, 200/300 microinches.

Insulation: Polypropylene molded to plug body and wire.

Color: Matches color of wire

Wire: 22 AWG, stranding 26 x 36 T.C., PVC Insulated, 1.63 (.064) O.D.

Color: See Ordering Information

Marking: "POMONA 4771-XX"

Conn: 0.64 (.025) Square Pin Receptacle

Material: Phosphor bronze.

Finish: Gold plated.

Housing Insulation: Polypropylene

Color: Matches color of wire.

RATINGS:

Operating Temperature: +50° C. (+122° F.) Max.

Operating Voltage: 1000 VDC

Current: 3 Amperes

ORDERING INFORMATION: Model 4771-XX-*

XX=Cable Lengths, Standard Lengths: 12" (305), 24" (610), 35" (914), & 48" (1219). Additional lengths can be quoted upon request.

*=Color, -0 Black, -2 Red

Ordering Example: 4771-48-2 Indicates 48" in length, color is Red.

All dimensions are in inches. Tolerances (except noted): .xx = ±.02" (.51 mm), .xxx = ±.005" (.127 mm).

All specifications are to the latest revisions. Specifications are subject to change without notice.

Registered trademarks are the property of their respective companies. Made in USA

6/9/99

SY/EH/LS

S:\Engineering\Release\DataSheets\FlukeDataSheet\4771_1_01.doc

Sales: 800-490-2361 Fax: 888-403-3360

Technical Assistance: 800-241-2060

PomonaACCESS 90604 (800) 444-6785 or (425) 446-6010

More drawings available at www.pomonaelectronics.com

Page 1 of 1