

### DESCRIPTION

DATEL's 4320-01069-0 six position connector housings and 4400-01032-0 crimp terminals provide a secure method for making input/output connections to all panel mounted 12-pin DMS series meters. These connectors are ideal for use in low-volume prototype applications. Two connector housings and 12 terminals are required for each meter.

### 6-Position Connector Housing

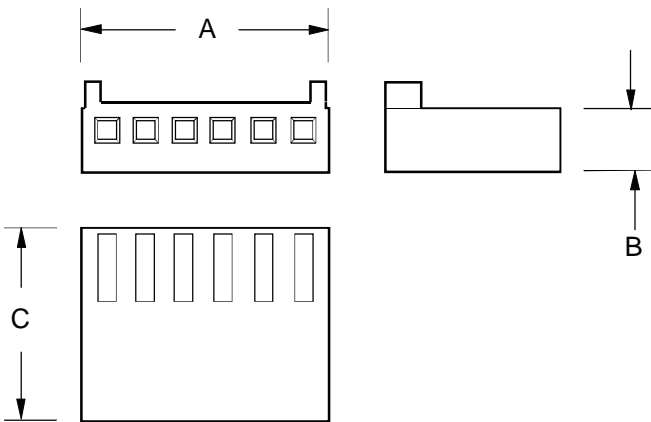

| Connector Housing | A              | B             | C              |
|-------------------|----------------|---------------|----------------|
| 4320-01069-0      | 0.62<br>(15.7) | 0.19<br>(4.8) | 0.50<br>(12.7) |

Dimensions: in. (mm) All dimensions are nominal

| Crimp Terminal | A               | B             | C             | D               |
|----------------|-----------------|---------------|---------------|-----------------|
| 4400-01032-0   | 0.042<br>(1.07) | 0.08<br>(2.0) | 0.08<br>(2.0) | 0.06<br>(1.5)   |
|                | E               | F             | G             | H               |
|                | 0.38<br>(9.7)   | 0.05<br>(1.3) | 0.08<br>(2.0) | 0.075<br>(1.91) |

Dimensions: in. (mm) All dimensions are nominal

### Crimp Terminals

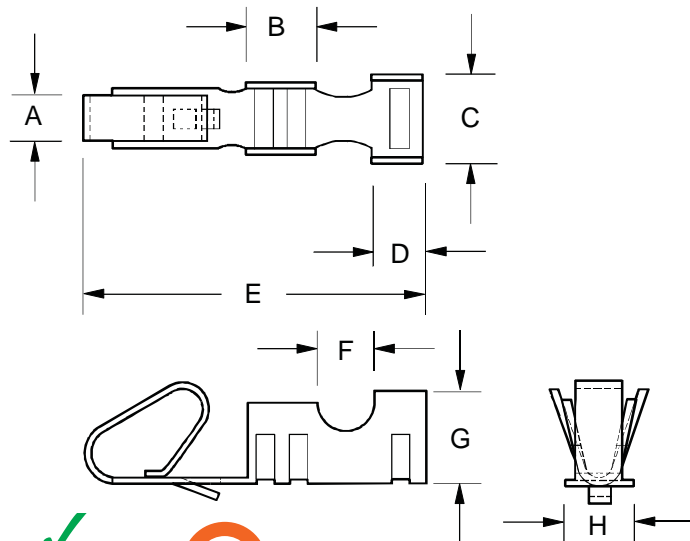

| Electrical Specifications |                                   |
|---------------------------|-----------------------------------|
| Insulator Material:       | Nylon                             |
| Flammability Rating:      | UL94V-0                           |
| Wire Size:                | 22-26 AWG                         |
| Stripping Length:         | 0.100" to 0.125" (2.54 to 3.17mm) |
| Current Rating:           | 2.5A continuous                   |
| Insulation Diameter:      | 0.062" (1.57mm) max.              |

### Crimp Terminal and Housing Installation

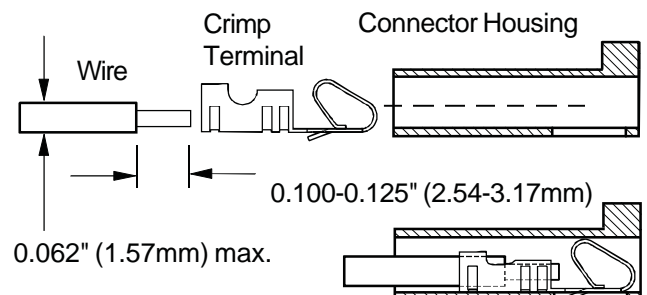

**DESCRIPTION**

DATEL's 6-position SIP and 12-position DIP sockets provide any easy and inexpensive, low profile solution for mounting DMS series meters on printed circuit boards. These are the same rugged, long-life sockets DATEL uses in all its in-house panel meter burn-in boards. Both sockets provide excellent mechanical retention force, and in many applications they can supply all the necessary mechanical force to hold the meters in position (see DMS Application Note 16 for more information). The 6-position SIP's can be used with all 12-pin DMS meters, while the 12-position DIP's are intended for use with "-BCD" models of the DMS-40PC family.

**6-Position SIP Sockets**

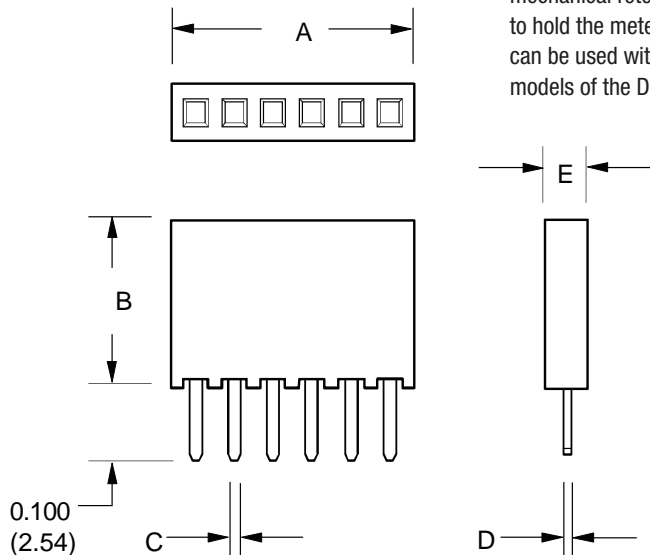

| 12-Position DIP Socket | A               | B               | C               | D               | E               |
|------------------------|-----------------|-----------------|-----------------|-----------------|-----------------|
| 4320-01072-0           | 0.620<br>(15.7) | 0.335<br>(8.51) | 0.031<br>(0.79) | 0.016<br>(0.41) | 0.195<br>(4.95) |
| 6-Position SIP Socket  | A               | B               | C               | D               | E               |
| 4320-01074-0           | 0.620<br>(15.7) | 0.335<br>(8.51) | 0.031<br>(0.79) | 0.016<br>(0.41) | 0.098<br>(2.48) |

Dimensions: in. (mm) All dimensions are nominal

**Meter and Socket Installation**

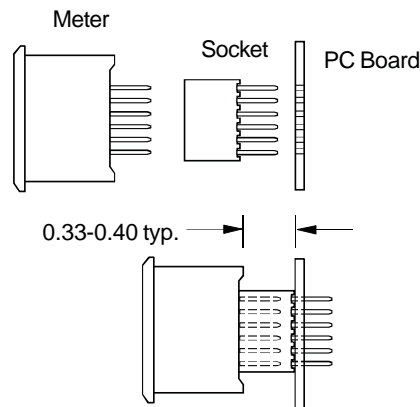

**12-Position DIP Sockets**

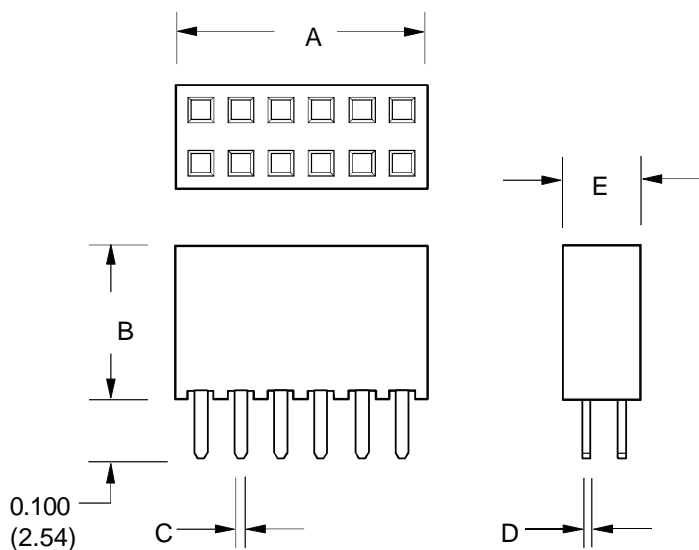

| Electrical Specifications |   |
|---------------------------|---|
| Insulator Material:       | Black liquid crystal polymer                      |
| Flammability Rating:      | UL94V-0   |
| Operating Temperature:    | -65 to +105°C                                     |
| Contact & Tail Plating:   | Matte Tin   |
| PC-board Hole Diameter:   | 0.037 (0.94) to 0.043 (1.09)                      |
| Contact Material:         | Phosphor Bronze                                   |
| Current Rating:           | 3A continuous                                     |
| Withdrawal Force:         | 5 oz. (1.39N) avg./position with 0.025 (0.64) pin |