

NOTES

BUILT TO MEET THE REQUIREMENTS OF INDUSTRIAL AND COMMERCIAL USE. ALL METAL HOUSING—TOUGH EXTRUDED ALUMINUM CASE WITH BLACK POWDER-COATED STEEL COVER.
 HEAVY-DUTY CORD — 14/3 SJTW WIRE FOR EXTREME TEMPERATURE RANGES.
 INTEGRAL MOLDED PLUG AVAILABLE IN STRAIGHT-BLADE (NEMA 5-15P) OR TWIST-LOCK (NEMA L5-15P) CONFIGURATIONS.
 SEPARATE MOUNTING FEET WITH KEYHOLE SLOTS PROVIDE FOR WORK STATION MOUNTING IF DESIRED.
 COMES WITH LIGHTED ON/OFF SWITCH.
 INCLUDES 15A, 125VAC CIRCUIT BREAKER TO PREVENT ACCIDENTAL LINE OVERLOAD.
 CSA CERTIFIED, UL 1363 LISTED.

L.SIDE VIEW

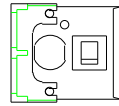

TOP VIEW

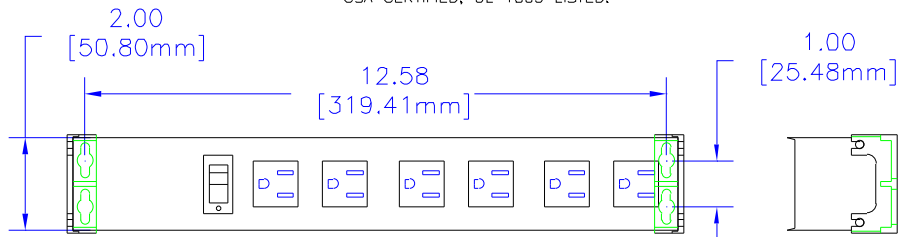

R.SIDE VIEW

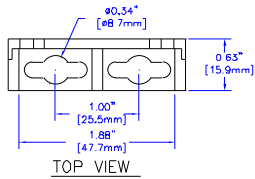

TOP VIEW

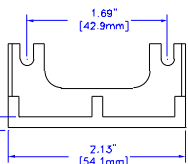

FRONT VIEW

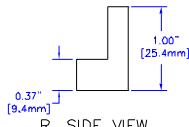

R. SIDE VIEW

MOUNTING FEET DETAIL

SIDE VIEW

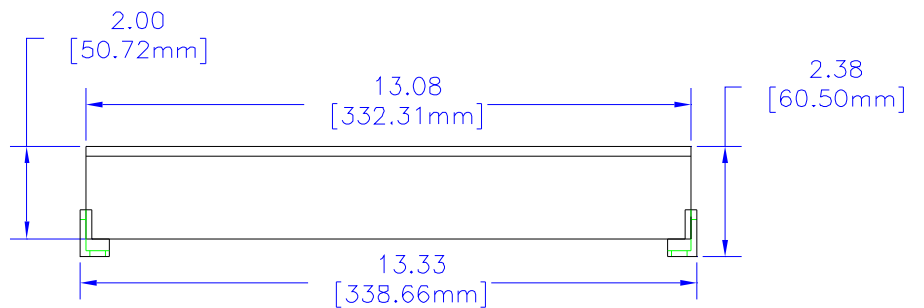

*SEE CATALOG FOR THE COMPLETE PART NUMBER BASED ON THE OPTIONS LISTED IN THE NOTE SECTION

UNLESS OTHERWISE SPECIFIED
 DIMENSIONS ARE IN INCHES
 .x +/- .1
 .xx +/- .02
 .xxx +/- .012
 .000 +/- .005
 .000 +/- .005
 ANGLES +/- .5 DEG.
 DIMENSIONS CLEAR UNLESS SPECIFIED TO THE CONTRARY. THIS DRAWING IS INTENDED TO BE USED AS A REFERENCE FOR INDICATED DIMENSIONS ONLY. THIS INFORMATION MAY NOT BE USED TO MANUFACTURE PARTS WITHOUT THE EXPRESS PERMISSION FROM HAMMOND MANUFACTURING.



HAMMOND
 MANUFACTURING

WEB: WWW.HAMMONDMFG.COM

FILE
 HAMMOND INDUSTRIAL
 GRADE POWER STRIPS
 DRAWN BY NJM DATE 02/09/01
 SCALE PAGE 1 OF 1
 PART NUMBER
 1584H6****