

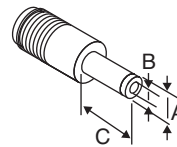

Slim Line Portable Switching AC/DC Adapters

419-1 Series

DIMENSIONS: mm (in.)

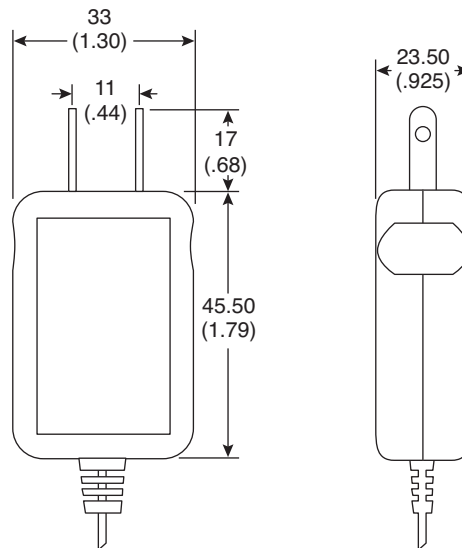
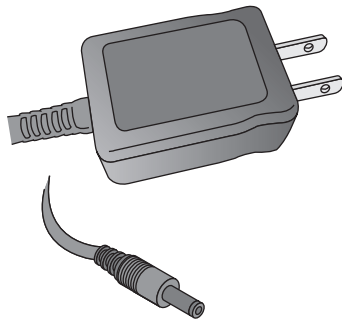

Part No.	Plug Type	Output	
419-10320-3	2.1mm	3VDC	2A
419-13320-3	2.1mm	3.3VDC	2A
419-10416-3	2.1mm	4.5VDC	1.6A
419-10520-1	1.3mm	5VDC	2A
419-10520-2	1.7mm	5VDC	2A
419-10520-3	2.1mm	5VDC	2A
419-10520-4	2.5mm	5VDC	2A
419-10618-3	2.1mm	6VDC	1.8A
419-10913-3	2.1mm	9VDC	1.3A
419-11210-3	2.1mm	12VDC	1.0A
419-11508-3	2.1mm	15VDC	0.8A

Part No. Suffix	A	B	C
-1	3.8	1.35	8-14
-2	4.75	1.7	9.5
-3	5.5	2.1	8-14
-4	5.5	2.5	8-14



File No. E224056

Input/Output Specifications:

- Input Voltage: 100VAC~120VAC, 50/60Hz
- Range Voltage: 90VAC~132VAC, 47~63Hz
- Output Power: 12W
- Over Current Protection: 120%
- Over Voltage Protection: 120%
- Short Protection: Auto Recovery
- Load Regulation: ±5%

Note:

- RoHS Compliant by Exemption

General Specifications:

- Operating Temperature: 0~40°C
- Operating Relative Humidity: 5~95%RH
- Storage Temperature: -20~85°C
- Withstanding Voltage: 2000VAC/Min (between Input & Output), 5mA(Max.)
- Insulation Resistance: 500VDC 100MΩ (Min.) (between Input & Output)
- Efficiency: 70% Min.
- Weight: .188 lbs. (per piece)
- DC Cable Length: 1800mm ± 100mm

XICON PASSIVE COMPONENTS • (800) 628-0544



XC-600019

Specifications are subject to change without notice. No liability or warranty implied by this information. Environmental compliance based on producer documentation.

Date Revised: 6-3-09