

8 7 6 5 4 3 2 1

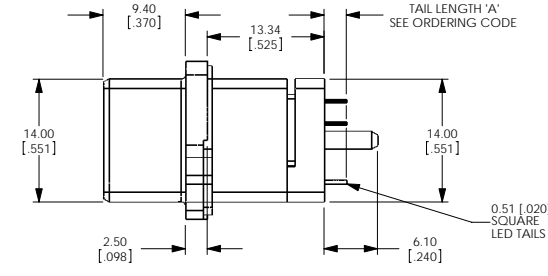

REVISIONS			
REV	ECN, ERN NO.	DATE	APPRD.
B	PRODUCT DRAWING (EAR 13276)	JUN06/08	K.L.

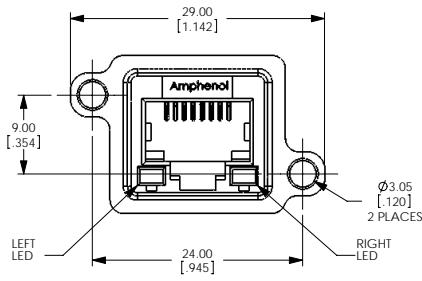
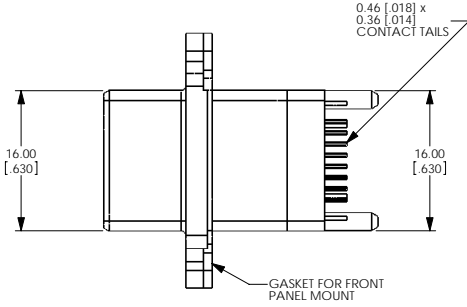
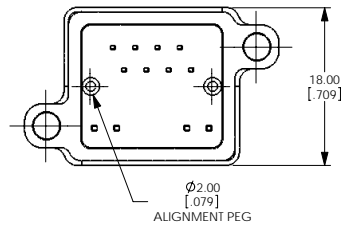

ORDERING CODE: **MRJ-548X-X1**

SERIES, RUGGED RJ  
 RECEPTACLE  
 VERTICAL MOUNT  
 NUMBER OF CONTACTS  
 LED OPTION  
 0=NONE  
 1=GREEN LEFT, YELLOW RIGHT  
 4=YELLOW LEFT, GREEN RIGHT  
 5=GREEN LEFT, GREEN RIGHT

CONTACT TAIL OPTION  
 0=TAIL LENGTH A=2.54 [.100]  
 B=TAIL LENGTH A=3.81 [.150]

SINGLE PORT

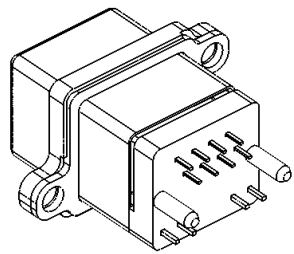
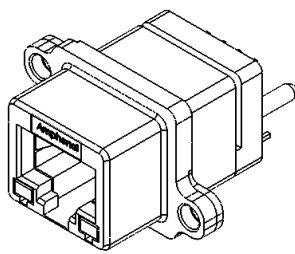

**NOTES:**

- MATERIAL:  
 ALL MATERIALS ARE ROHS COMPLIANT PER EU DIRECTIVE 2002/95/EC AND AMENDMENTS  
 • SHELL - DIECAST ZINC, NICKEL PLATED  
 • CONTACTS - PHOSPHOR BRONZE WITH 50 MICROINCHES (1.27 MICRONS) GOLD OVER 50 MICROINCHES (1.27 MICRONS) MINIMUM NICKEL ON THE MATING AREA AND MATTE TIN OVER NICKEL ON THE CONTACT TAILS  
 • INSERTS - ENGINEERING THERMOPLASTIC, UL FLAMMABILITY RATING 94V-0, REAR INSERTS: BLACK NYLON, FRONT INSERT: CLEAR POLYCARBONATE  
 • GASKET - SILICONE RUBBER  
 • LED'S - EPOXY LENS, STEEL TAILS WITH TIN PLATING
- ENVIRONMENTAL PERFORMANCE PER IEC 60529 CODE IP67 FOR SEAL BETWEEN MATING AREA AND PCB SIDE OF CONNECTOR. GASKET PROVIDES FOR SEAL TO INSIDE FACE OF PANEL.
- CURRENT RATING: 1.5 AMPERES.
- CONTACT RESISTANCE: 30 MILLIOHMS MAXIMUM.
- OPERATING TEMPERATURE: -40°C TO +105°C.
- AVAILABLE MATING AREA COVERS PROVIDE ADDED PROTECTION. CONSULT WITH AMPHENOL CANADA FOR DETAILS.
- CUSTOMER TO VERIFY THAT ANY PROCESS CLEANERS USED ARE COMPATIBLE WITH POLYCARBONATE MATERIAL.



**PROPRIETARY AND CONFIDENTIAL**  
 THIS DOCUMENT CONTAINS PROPRIETARY INFORMATION AND SUCH INFORMATION MAY NOT BE DISCLOSED TO OTHERS FOR ANY PURPOSE OR USED FOR MANUFACTURING PURPOSES WITHOUT THE EXPRESS PERMISSION FROM AMPHENOL CANADA CORP.

UNLESS OTHERWISE SPECIFIED:		DATE:	Amphenol Canada Corp.
DIMENSIONS ARE IN MILLIMETERS	DRAWN: A.DODDS (JUN1410)	TITLE:	MRJ SERIES RUGGED MODULAR JACK, 8 POSITION VERTICAL LED & TAIL LENGTH OPTIONS, FRONT PANEL MOUNT, RoHS COMPLIANT
TOLERANCES:	DESIGNED:	SIZE:	C P-MRJ-548X-X1 B
FRACTIONAL ±	CHECKED: K.LAMBE (JUN1410)	DWG. NO.:	
ANGULAR MATCH ± BEND ±	I.E. APPRD.	REV:	
TWO PLACE DECIMAL ±	C.I.A. APPRD.	ENG. REG. NO.:	EAR E13130
THREE PLACE DECIMAL ±	ENG. APPRD.	CODE ID. NO.:	
NEAREST GEOMETRIC TOLERANCING PER:	APP.:	DIMENSIONS ARE IN:	MILLIMETERS
MATERIAL:	REF:	SCALE:	3:1
NEXT ASSY:	USED ON:	WEIGHT:	
APPLICATION:	DO NOT SCALE DRAWING	SHEET:	1 OF 2

8 7 6 5 4 3 2 1

REVISIONS			
REV	ECN, ERN NO.	DATE	APPRD.
B	PRODUCT DRAWING (EAR 13276)	JUN06/08	K.L.

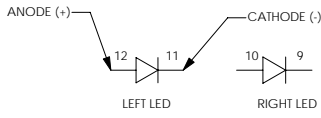
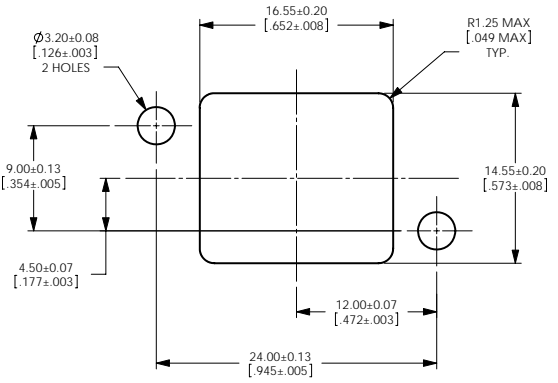
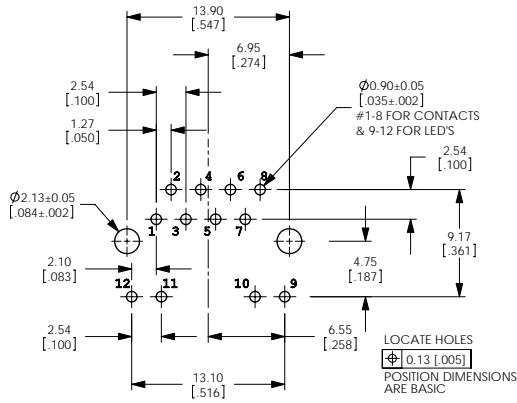

**PROPRIETARY AND CONFIDENTIAL**  
THIS DOCUMENT CONTAINS  
PROPRIETARY INFORMATION AND SUCH  
INFORMATION MAY NOT BE DISCLOSED  
OR USED FOR ANY PURPOSE OR USED  
FOR MANUFACTURING PURPOSES  
WITHOUT THE EXPRESS PERMISSION FROM  
AMPHENOL CANADA CORP.

UNLESS OTHERWISE SPECIFIED:		DATE:	Amphenol Canada Corp. TITLE: MRJ SERIES RUGGED MODULAR JACK, 8 POSITION VERTICAL, LED OPTIONS, FRONT PANEL MOUNT, ROHS COMPLIANT
DIMENSIONS ARE IN MILLIMETERS		DRAWN: A DODDS (JUN14/07)	
TOLERANCES:	DESIGNED:		
FRACTIONAL $\pm$	CHECKED: K LAMBE (JUN14/07)		
ANGULAR MATCH $\pm$ BEND $\pm$	I.E. APPRD:		
TWO PLACE DECIMAL $\pm$	C.A. APPRD:		
THREE PLACE DECIMAL $\pm$	ENG. REL. NO.: EAR F13130		
WEBNET GEOMETRIC: PLUS/MINUS P/S		ENG. APPRD:	SIZE: C
MATERIAL:		REF:	DWG. NO.: P-MRJ-548X-X1
FRIB:	REV:	DIMENSIONS ARE IN MILLIMETERS	CODE ID. NO.:
NEXT ASSY:	USED ON:		SCALE: 4:1
APPLICATION:	DO NOT SCALE DRAWING		WEIGHT:
			SHEET 2 OF 2