

Dimensions: mm (In.)

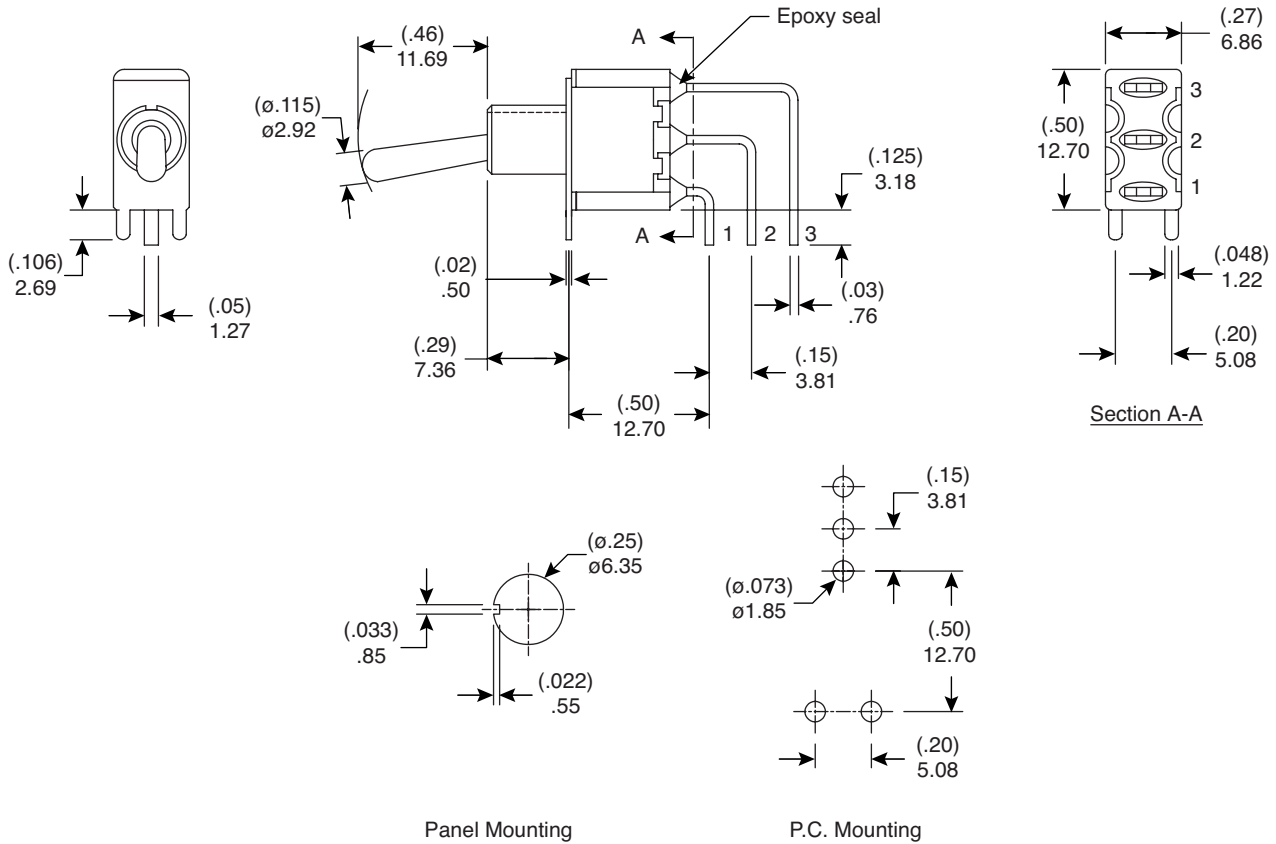
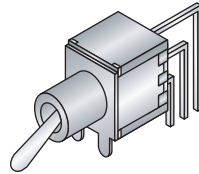

Mechanical Specifications:

- Mechanical Life: 40,000 make-and-break cycles
- Operating Temperature: -30°C to 85°C

Electrical Specifications:

- Rating: 2A / 250VAC, 5A / 120 VAC or 28 VDC
- Contact Resistance: 10mΩ max. initial @ 2-4VDC 100mA
- Insulation Resistance: 1,000MΩ min.
- Dielectric Strength: 1,000 V RMS@sea level

Materials:

- Case: Diallyl phthalate (DAP)(UL94V-0)
- Actuator: Brass, chrome plated
- Bushing: Brass, nickel plated
- Housing: Stainless Steel
- Terminal/Contact: Silver or gold plated
- Switch Support: Brass, Tin plated

Note:

- RoHS Compliant by Exemption

Mouser Stock No.	Type	Circuit
108-0020-EVX	SPDT	On-On
108-0021-EVX	SPDT	On-Off-On
108-0022-EVX	SPDT	On-(On)
108-0023-EVX	SPDT	(On)-Off-(On)

Miniature Toggle Switches

108-0020-EVX, 108-0021-EVX, 108-0022-EVX, 108-0023-EVX



Available from Mouser Electronics

www.mouser.com

1-800-346-6873