

Dimensions: mm (in.)

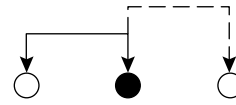

Circuit Diagram

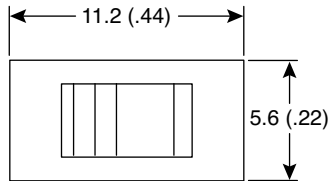
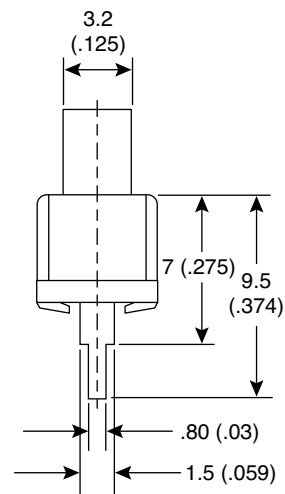
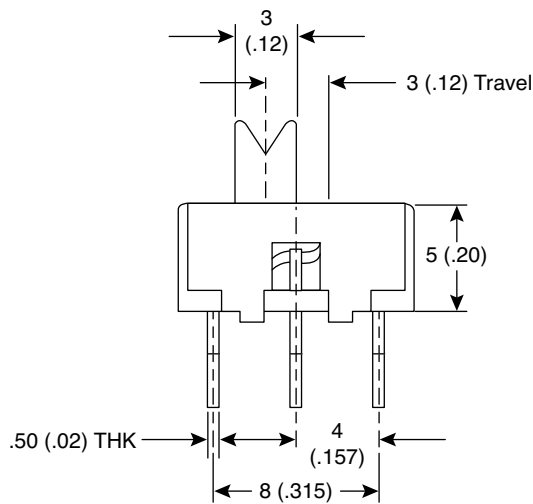

**Electrical Specifications:**

- Rating: 0.5A/50V DC
- Contact Resistance: 30m max.
- Insulation Resistance: 100M min.
- Dielectric Stragth: 500VAC 1 minute

**Mechanical Specifications:**

- Timing: Non-shorting
- Operating Force: 300g ± 150gf
- Life test: 10,000 cycles, 15-18 cycles/min
- Type: SPDT

**Note:**

- RoHS Compliant

Slide Switch  
103-12100-EV



Available from Mouser Electronics

www.mouser.com

1-800-346-6873

Specifications are subject to change without notice. No liability or warranty implied by this information. Environmental compliance based on producer documentation.