

Dimensions: mm (In.)

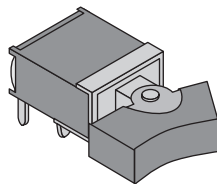

P.C. MOUNTING

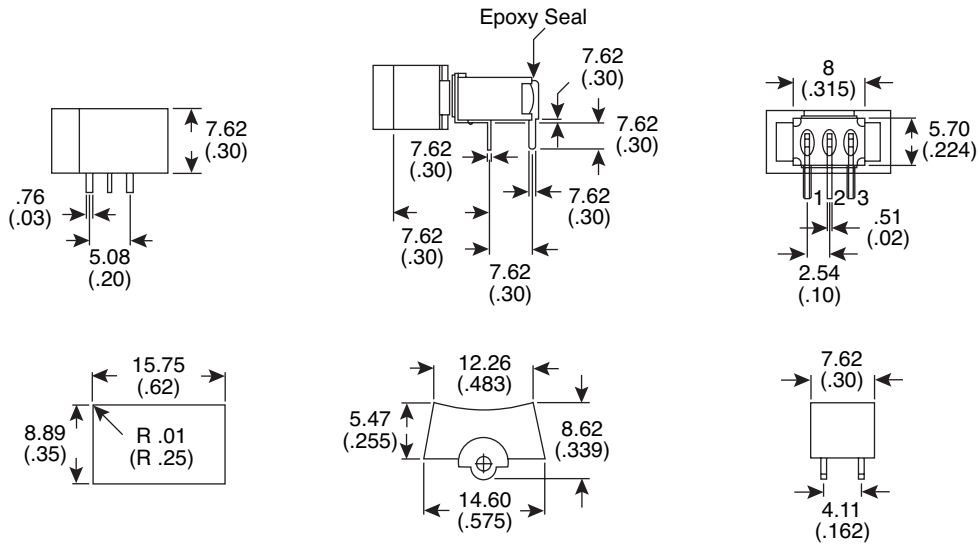
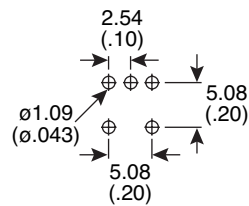

POS. 1	POS. 2	POS. 3
ON	NONE	MOM
2-3		2-1
	OPEN	

SCHEMATIC

Electrical Specifications:

- Rating: 1A/250VAC, 3A/120VAC or 28VDC
- Contact Resistance: 20m Ω max. initial @ 2-4VDC 100mA
- Insulation Resistance: 1,000M Ω min.
- Dielectric Strength: 1,000 V RMS@ sea level

Materials:

- Case & Bushing: glass filled nylon 6/6, retardant, heat stabilized (UL94V-0)
- Actuator: nylon, black std. internal o-ring seal standard with all actuators
- Switch Support: brass or steel, tin plated.
- Terminals / Contact: gold plated copper

Mechanical Specifications:

- Mechanical Life: 30,000 make-and-break cycles.
- Operating Temperature: -30°C to 85°C

Note:

- RoHS compliant by exemption

Sealed Sub-Miniature Rocker Switch
103-7029-EVX

