

Dimensions: mm (In.)

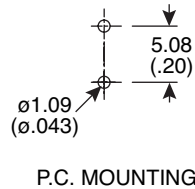

POS. 1	POS. 2
OFF	MOM
OPEN	1-3

SWITCH FUNCTION

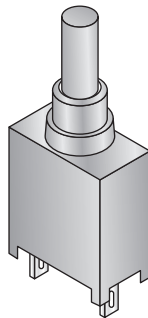
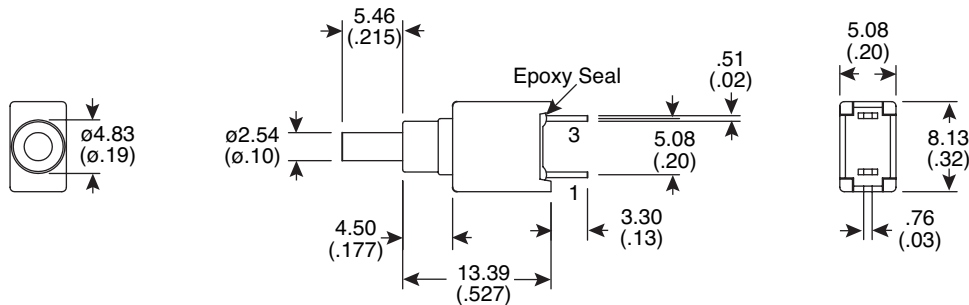

Electrical Specifications:

- Rating: 0.4 Volt-Amps (VA) max. @20V max. (AC or DC)
- Contact Resistance: 20mΩmax. initial @ 2-4VDC 100mA
- Insulation Resistance: 1,000MΩmin.
- Dielectric Strength: 1,000 V RMS@ sea level

Mechanical Specifications:

- Mechanical Life: 50,000 make-and-break cycles.
- Operating Temperature: -30°C to 75°C

Materials:

- Case and Bushing: Glass filled Nylon 6/6, flame retardant, heat stabilized (UL94v-0)
- Plunger: Thenoplastic Polyester (UL 94V-0), with internal O-ring seal.
- Switch Support: Brass or Steel electronitin plated.
- Contact: Gold plated copper alloy

Note:

- RoHS Compliant by Exemption

Sealed Subminiature Pushbutton Switch
107-3013-EVX

