

Dimensions: mm (In.)

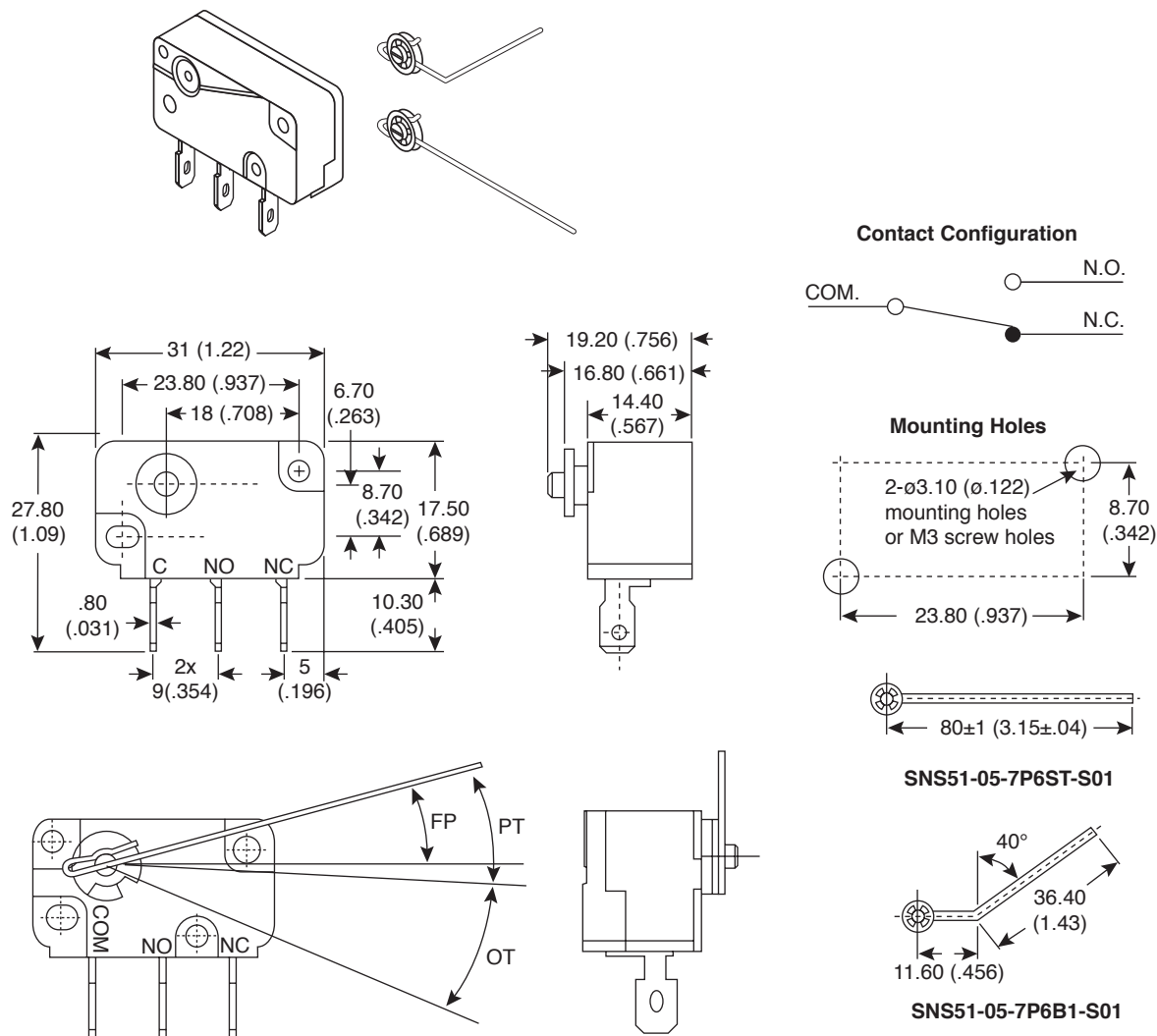

Mechanical Specifications:

- Operating Frequency: 240 operations/min
- Life: 10,000,000 operations min.

Note:

- RoHS Compliant and Process Compatible with 260° solder.

Electrical Specifications:

- Rating: 5A/125VAC/250VAC
- Insulation Resistance (at 500VDC): 100M Ω min.
- Dielectric Strength: 1,000VAC RMS (50-60HZ)
- Operating Frequency: 20 operations/min
- Life: 100,000 operations min.
- Inrush: NC: 15A; NO: 7A

Operating Characteristics:

- Operating torque (OT): 7.6g-cm max.
- Releasing torque (RT): 0.9g-cm min.
- Pretravel (PT): 21° max.
- Overtravel (OT): 17° min.
- Movement differential (MD): 2° min.
- Return travel (RT): 5° min.
- Total travel (TT): 38° min.
- Free position (FP): 15 \pm 3°

Snap Switches

101-51-05-7P6ST-EV, 101-51-05-7P6B1-EV

