

Part Number:

25SP105

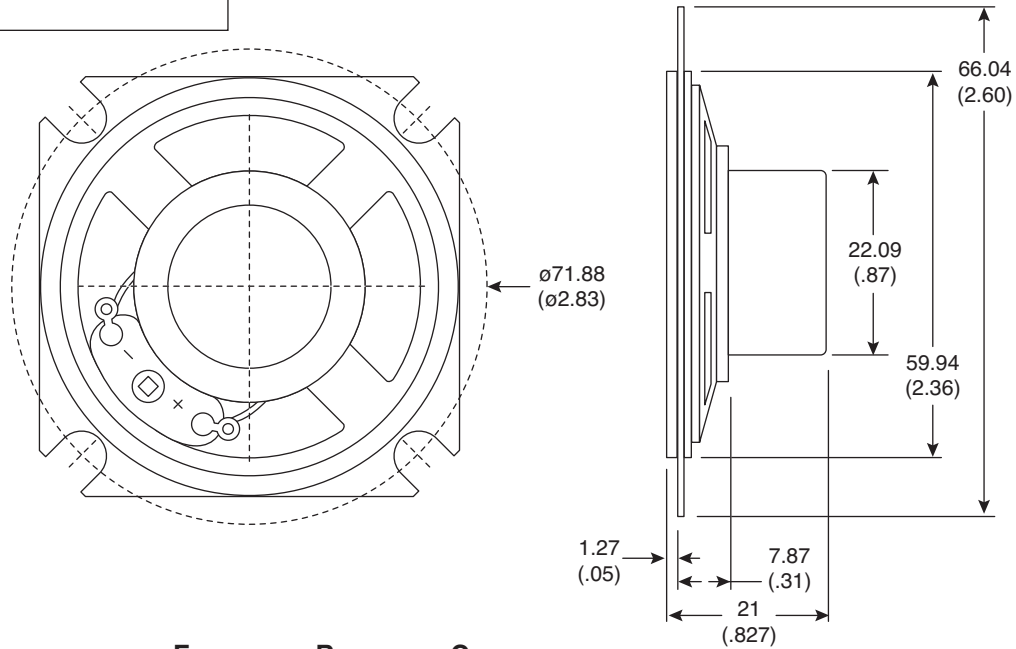

**Frequency Response Curve**

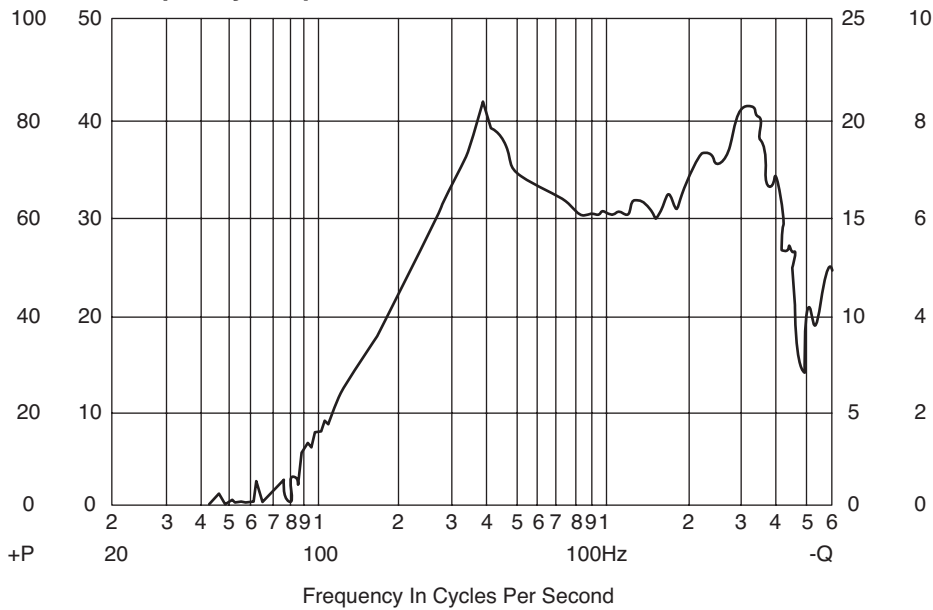

Speaker

KT-400056

**Electrical Specifications:**

- Impedance:  $8\Omega \pm 15\%$
- Rated power: 0.3W
- Max power: 0.6W
- Resonant frequency:  $350\text{Hz} \pm 50\text{Hz}$
- Frequency response: 350-4KHz
- Distortion: 10% max 600Hz, 0.3W

**Material:**

- Magnet: Alnico