

Part Number:

253-CE301-RO

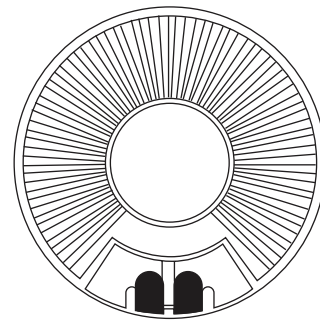

A: Frequency Response, Magn dB re 20.00PA

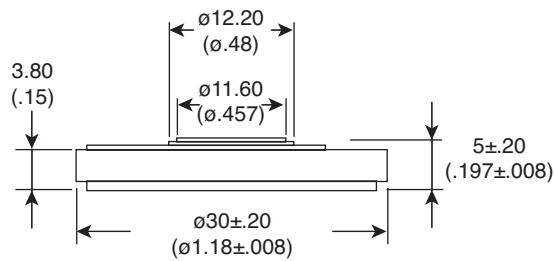
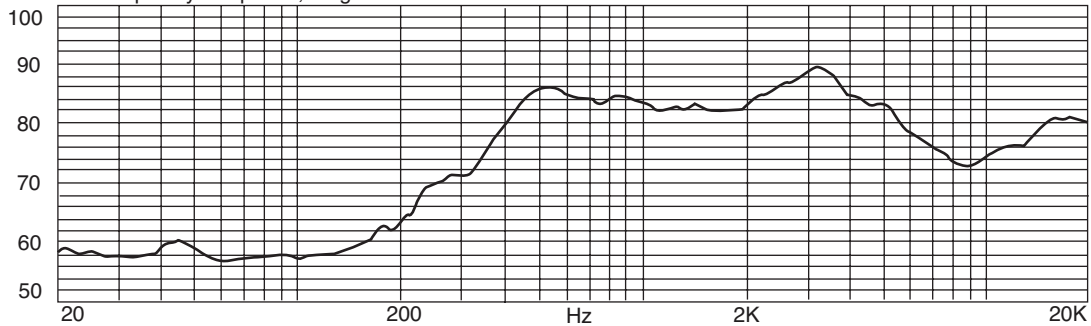

Speaker

KT-400292

Electrical Specifications:

- Impedance: $32\Omega \pm 15\%$
- Rated Power: 0.2W
- Maximum Power: 0.4W
- Resonant Frequency: $550\text{Hz} \pm 20\%$
- Frequency Range: 300 ~ 6.0KHz

Materials:

- Magnet: NdFeb

Note:

- RoHS Compliant