

| 1 | | |
|-------------|----------|--------|
| Description | Material | Finish |
| Body | Brass | Gold |
| Socket | BE CU | Gold |
| Insulation | Teflon | Teflon |
| Crimp Ring | Brass | Gold |

SIDE VIEW

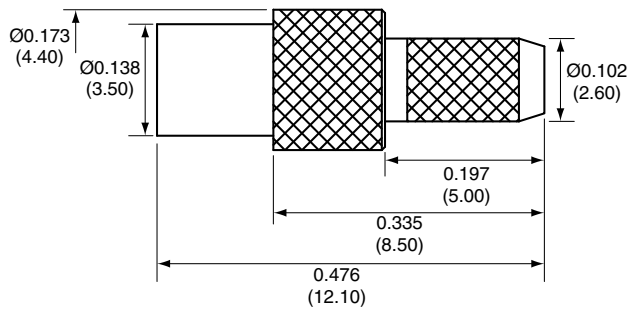

SOCKET

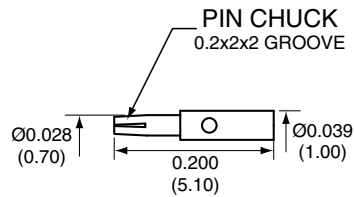

CRIMP RING

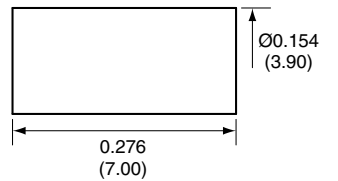

RECOMMENDED CABLE STRIPPING DIMENSIONS

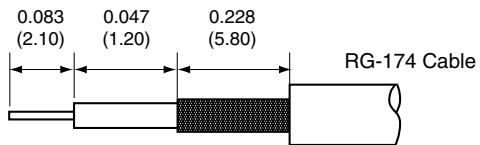

CONMMCX011 ASSEMBLY INSTRUCTIONS

1. Solder the socket to the center conductor.
2. Insert the socket, center conductor, and insulator into the body until the top of the socket is even with the insulation in the body.
3. Wrap the braid around the tail of the body and crimp the ring with a 0.137" hex crimp tool (or one labeled for use with RG-174 cable).

| | | | | | | | |
|-------------|--|-------------|--|-----------------|--|--------------|--|
| Title | | CONMMCX011 | | Revision: 1.0 | | CONMMCX011 | |
| Part No. | | CONMMCX011 | | Revision: 1.0 | | CONMMCX011 | |
| Dimensions: | | INCHES (mm) | | Date: 6/14/2006 | | Sheet 1 of 1 | |

CONNECTOR CITY
159 ORT LANE
MERLIN, OR 97532
PH (541)-471-6256
FAX (541)-471-6251

CONNECTOR CITY
THE VALUE OF CONNECTIONS

1

2

3

4