

REV.	DATE	DESCRIPTION
A	03/27/05	UPDATE DRAWING FORMAT
B	05/12/05	MODIFY BODY DIMENSIONS

STAMP 4 POINTS (SEE REMARKS 1,2)

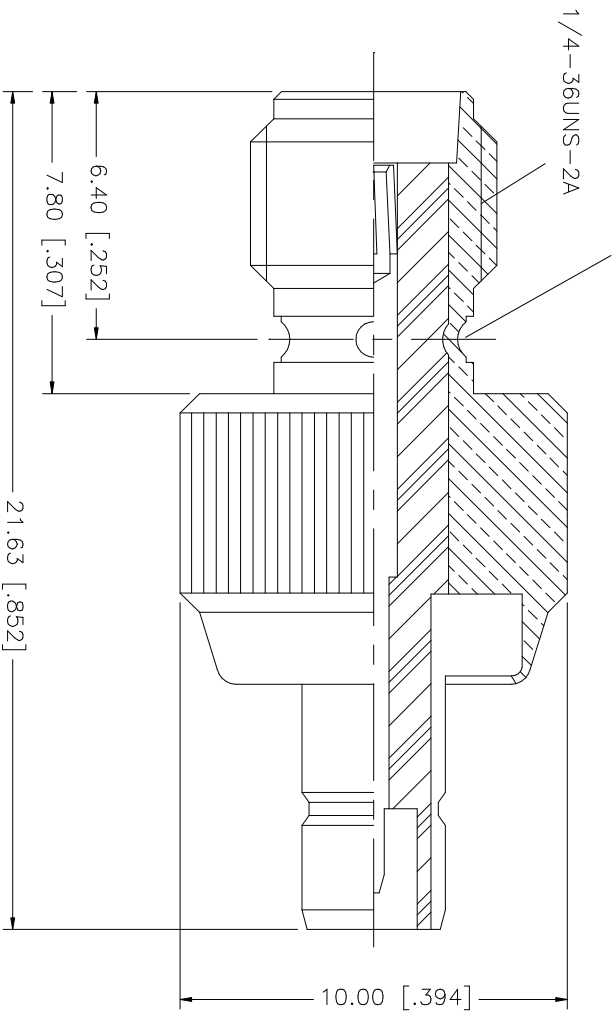

REMARKS:

- NO.2 MUST WITHSTAND A 6LBS. MIN. PUSHOUT FORCE FROM NO.2 AFTER STAMPING OPERATION.
- REMARK 1. IS MAINTAINED BY STAMPING THE FOUR POINTS SHOWN ON THE DRAWING WITHOUT PUNCTURING NO.1

QTY	DESCRIPTION	MATERIAL	FINISH	QTY	DO NOT SCALE DRAWING	APPROVALS	DATE	PART DESCRIPTION	DWG. NO.	REV.	SIZE	SCALE		
1	CONTACT PIN	BER. COPPER	GOLD	1	UNLESS OTHERWISE SPECIFIED DIMENSIONS ARE IN INCHES AND FOR CUSTOMER REFERENCE ONLY. UNLESS OTHERWISE SPECIFIED TOLERANCES FOR MILLIMETERS ARE: 0.5 - 8mm ± 0.20mm 8 - 30mm ± 0.40mm 30 - 120mm ± 0.50mm UNLESS OTHERWISE SPECIFIED TOLERANCES FOR INCHES ARE: .020 - .315 = ± 0.007" .315 - 1.180 = ± 0.015" 1.180 - 4.724 = ± 0.020"									
1	INSULATOR BODY	TEFLON BRASS	NATURAL GOLD	1		DRAWN G.R.S.	05/12/05	SMA JACK TO SMB JACK ADAPTER	242147	B	A	NA		
						CHECKED								
						ISSUED								
						SHEET 1 OF 1								
						CAD FILE C:/242/242147.DWG								

Amphenol Connex

SMA JACK TO SMB JACK ADAPTER

242147