

REV.	DATE	DESCRIPTION
NC	03/21/04	INITIAL RELEASE

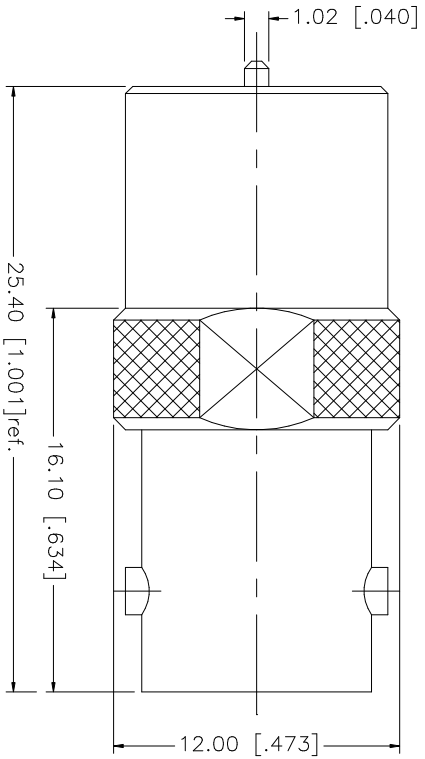

UNLESS OTHERWISE SPECIFIED DIMENSIONS ARE IN MILLIMETERS DIMENSIONS IN [] ARE IN INCHES AND FOR CUSTOMER REFERENCE ONLY.		UNLESS OTHERWISE SPECIFIED DIMENSIONS FOR MILLICENTS ARE:		UNLESS OTHERWISE SPECIFIED DIMENSIONS FOR INCHES ARE:		UNLESS OTHERWISE SPECIFIED DIMENSIONS FOR INCHES ARE:	
8		0.5 - 8mm ± 0.20mm		.020 - .315 = ± 0.007"		DO NOT SCALE DRAWING	
7		8 - 30mm ± 0.40mm		.315 - 1.180 = ± 0.015"			
6		30 - 120mm ± 0.50mm		1.180 - 4.724 = ± 0.020"			
5							
4							
3	CONTACT PIN	PHOS. BRONZE	GOLD	1			
2	INSULATOR	TEFLON	NATURAL	1			
1	BODY	BRASS	NICKEL	1			
DESCRIPTION		MATERIAL	FINISH	QTY			

Amphenol Connex

PART DESCRIPTION
BNC JACK TO F PLUG ADAPTER

PART NO. **242199**

APPROVALS		DATE
DRAWN	G.R.S.	03/21/04
CHECKED		
ISSUED		
SHEET	1 OF 1	

CAD FILE	C:/242/242199.DWG	DWG. NO.	242199.DWG	REV.	NC	SIZE	A	SCALE	NA
----------	-------------------	----------	------------	------	----	------	---	-------	----