

Dimensions: in.

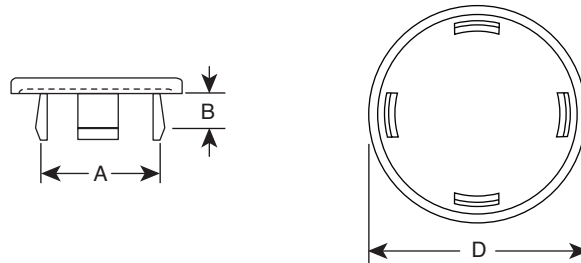

Economical snap-in Poly-Plugs will close unneeded chassis holes, wiring outlets, fill unused accessory openings, cover inspection and production access holes. They can be used as tube end caps and protective bumpers.

Poly plugs are molded in Nylon 6/6 which is abrasion and vibration resistant making them ideal for drawer glides and small appliance feet. Poly Plugs are designed with special flexible and tapered prongs which snugly lock in place with finger pressure but can be removed and reused when necessary. Parts can be furnished in natural nylon or dyed in colors. Poly Plugs are available in smooth, gloss finish or in dull, matte finish.

Mouser Part No.	Head Style	Finish	Panel Thickness B	Hole Size A	Head Size D	Head Height H (+/- .010)
561-12BG09	Binder	Smooth	.031/.094	0.125	0.203	0.04
561-15BG09	Binder	Smooth	.031/.094	0.15	0.25	0.04
561-18BG14	Binder	Smooth	.031/.140	0.187	0.344	0.04
561-25BG06	Binder	Smooth	.031/.062	0.25	0.422	0.04
561-25BM06	Binder	Matte	.031/.062	0.25	0.422	0.04
561-31BG14	Binder	Smooth	.031/.140	0.312	0.453	0.055
561-37BG31	Binder	Smooth	.031/.140	0.375	0.578	0.055
561-43BG17	Binder	Smooth	.031/.171	0.437	0.609	0.055
561-50BG14	Binder	Smooth	.031/.140	0.5	0.672	0.062
561-50BM14B	Binder	Matte	.031/.140	0.5	0.672	0.062
561-56BG14	Binder	Smooth	.031/.140	0.562	0.734	0.062
561-62BG07	Binder	Smooth	.031/.072	0.625	0.797	0.062
561-75BG11	Binder	Smooth	.031/.109	0.75	0.984	0.062
561-87BG11	Binder	Smooth	.031/.109	0.875	1.078	0.062
561-100BG11	Binder	Smooth	.031/.109	1	1.219	0.062