

REV.	DATE	DESCRIPTION
NC	12/13/00	INITIAL RELEASE
A	05/06/07	REVISE BARREL/FERRULE DIMENSIONS/UPDATE DRAWING FORMAT
B	01/06/08	ADD CABLE CALL OUT IN DESCRIPTION. REMOVE NOTE 2

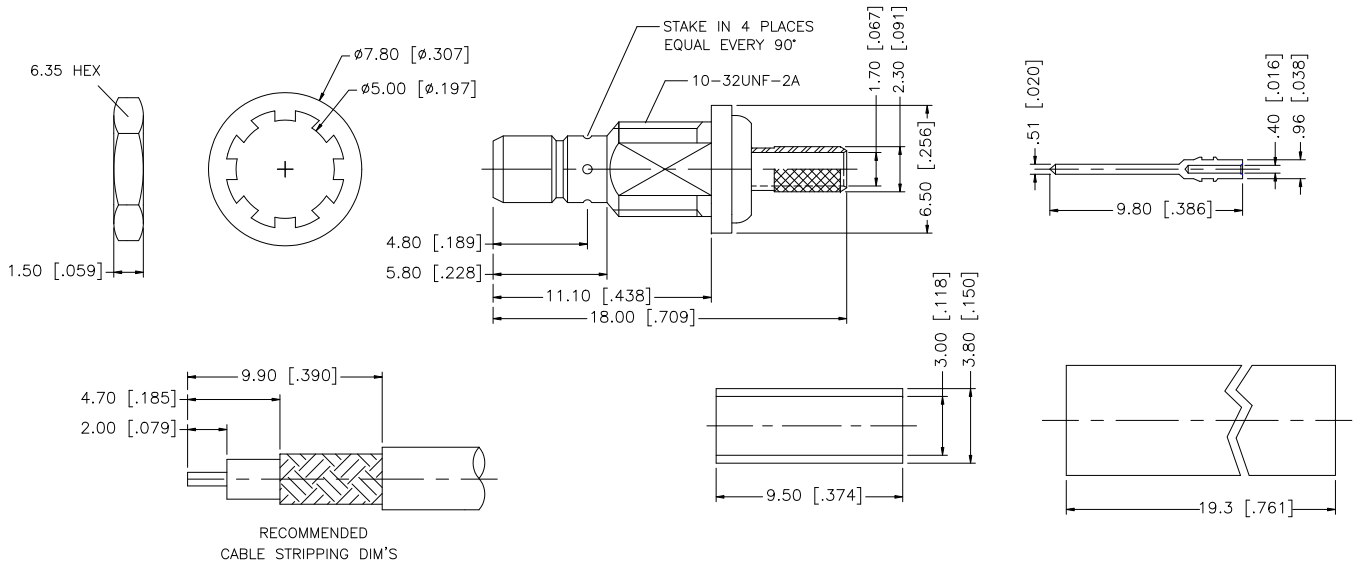
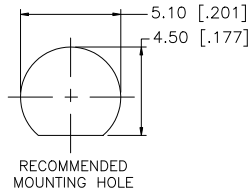

NOTE:
1. CRIMPED FERRULE HEX CRIMP SIZE .128"

DESCRIPTION	MATERIAL	FINISH	QTY	DO NOT SCALE DRAWING	APPROVALS	DATE	<h1 style="color: blue; margin: 0;">Amphenol Connex</h1>
8							
7	HEAT SHRINK TUBE	BLACK	1		DRAWN G.R.S.	01/06/08	
6	HEX NUT	BRASS	NICKEL	1	CHECKED		
5	LOCK WASHER	BRASS	NICKEL	1	ISSUED		
4	FERRULE	COPPER	NICKEL	1	SHEET 1 OF 1		
3	CONTACT PIN	BRASS	GOLD	1			
2	INSULATOR	TEFLON	NATURAL	1			
1	BODY	BRASS	NICKEL	1	CAD FILE C:/142/142179-75.DWG		

UNLESS OTHERWISE SPECIFIED DIMENSIONS ARE IN MILLIMETERS. DIMENSIONS IN [] ARE IN INCHES AND FOR CUSTOMER REFERENCE ONLY.

UNLESS OTHERWISE SPECIFIED TOLERANCES FOR MILLIMETERS ARE:
0.5 - 8mm ± 0.20mm
8 - 30mm ± 0.40mm
30 - 120mm ± 0.50mm

UNLESS OTHERWISE SPECIFIED TOLERANCES FOR INCHES ARE:
.020 - .315 = ± 0.007"
.315 - 1.180 = ± 0.015"
1.180 - 4.724 = ± 0.020"