

# Non-Insulated Ring Connectors

159-1217, 159-1219, 159-1220, 159-1221

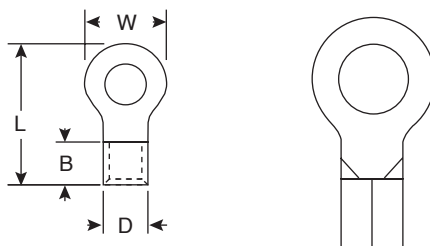

Non-Insulated Ring Connectors



SPECIFICATIONS	
<b>Wire Range:</b>	12-10 AWG
<b>Maximum Electric Current:</b>	48 amps
<b>Terminal Material:</b>	Copper, .039" ( 1.0mm) thick
<b>Seam:</b>	Brazed
<b>Terminals:</b>	Non-insulated

Mouser Stock No.	Stud Size	Dimensions: In.			
		W	L	B	D
159-1217	#8	.374	.780	.268	.220
159-1219	1/4	.472	1.016	.268	.220
159-1220	5/18	.591	1.102	.268	.220
159-1221	5/18	.591	1.102	.268	.220

Date Last Revised: 6-24-05

**Available from Mouser Electronics**  
**1-800-346-6873**  
**www.mouser.com**

KC-300033

159-1217, 159-1219, 159-1220, 159-1221