

Locking Spade Solderless Terminal

159-1644

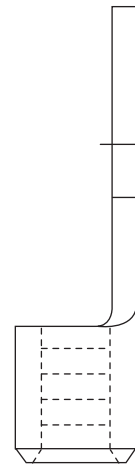

Locking Spade Solderless Terminal

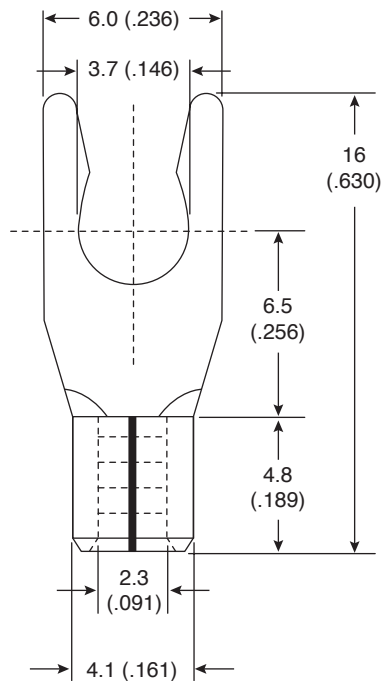

Dimensions: In.

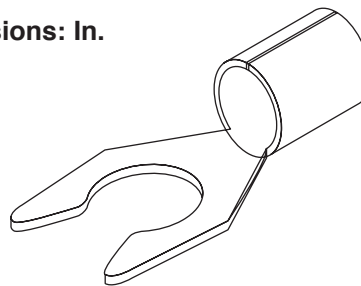
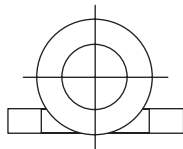

SPECIFICATIONS

Wire Range:	16-14 AWG
Maximum Current:	27 Ampere

Date Last Revised: 7-14-05

Available from Mouser Electronics
1-800-346-6873
www.mouser.com

KC-300712

159-1644