

Features

- Innovative Han-Quick Lock® termination technology
- Field assembly without special tools
- Compatible with Han® 4 A standard inserts
- Reduced wiring times
- Insert suitable for all metal and plastic hoods and housings of the sizes Han® 3 A

Technical characteristics

Protection degree	IP 65 / IP 67
Number of contacts	4 + PE
Electrical data accd. to DIN EN 61 984	10 A 230/400 V 4 kV 3
Rated current	10 A
Rated voltage conductor-ground	230 V
Rated voltage conductor-conductor	400 V
Rated impulse voltage	4 kV
Pollution degree	3
Termination	Han-Quick Lock®
Wire gauge	0.5 bis 2.5 mm ² (AWG 20–14)
Insulation resistance	≥ 10 ¹⁰ Ω
Material	Polycarbonate
Flammability accd. to UL 94	V 0
Mechanical working life	≥ 500 mating cycles

Identification

Part-Number

Drawing

Dimensions in mm

Han® 4 A Quick Lock

Male insert

09 20 004 2633

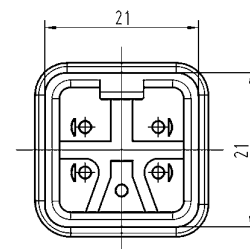
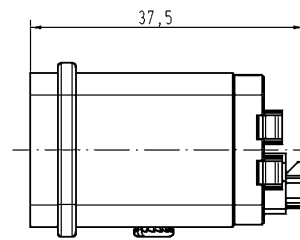

Female insert

09 20 004 2733

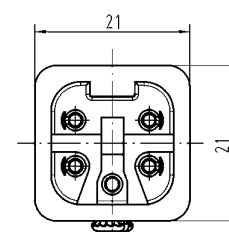
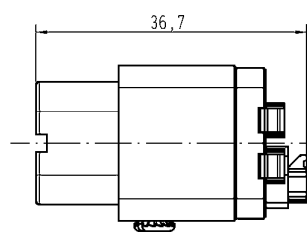

HARTING Electric GmbH & Co. KG | Wilhelm-Harting-Straße 1 | D-32339 Espelkamp

2008-02-21

Fon: +49 57 72 47-97100 | Fax: +49 57 72 47-124

Internet: www.HARTING.com | E-Mail: HARTING.Electric@HARTING.com

Han® Data Sheet 0346-1