

6 5 4 3 2 1

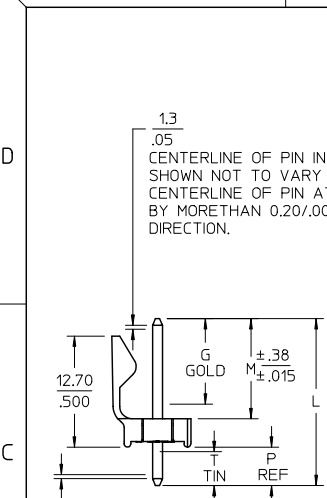

1.3 CENTERLINE OF PIN IN AREA SHOWN NOT TO VARY FROM CENTERLINE OF PIN AT DATUM -D- BY MORE THAN 0.13/.005 IN ANY DIRECTION.

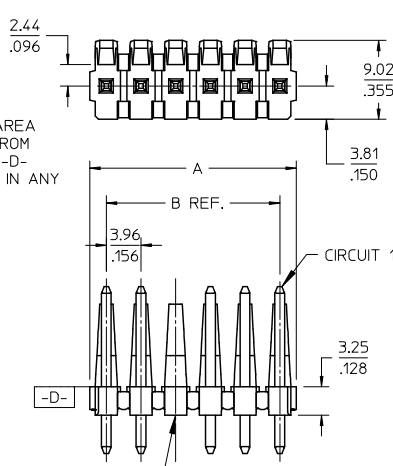

OPTIONAL VOIDED CKT. SEE CHART FOR LOCATIONS

A-41671- * N * * * *
 OPTION -PIN- PACKING
 A-BRASS -2161- BULK PACK
 B-BRASS -2161- TUBE PACK
 C-BRASS -43294- BULK PACK

NO OF CKTS
 DIM M.L.P
 PLATING

VOID LOCATIONS
 BLANK=NO VOIDS
 NO-CKT NO VOIDED
 MULT-VOIDS=51 UP

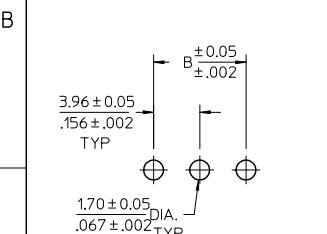

PCB LAYOUT: COMPONENT SIDE
 RECOMMENDED PCB THICKNESS:
 1.57 ± .18 / .062 ± .007

- NOTES:
- MATERIAL: POLYESTER, 94V-0, MOLDED BLACK
 - FINISH: PER ES-88
 - (102) OVERALL TIN: 0.00508/.000200 MIN.
 - OVERALL COPPER: 0.00254/.000100 MIN.
 - (222) OVERALL MATTE TIN: 0.00254/.000100 MIN.
 - OVERALL NICKEL: 0.00127/.000050 MIN.
 - (208) SELECT GOLD: 0.00038/.000015 MIN.
 - *SELECT TIN: 0.00254/.000100 MIN.
 - OVERALL NICKEL UNDERPLATE: 0.00127/.000050 MIN.
 - (228) SELECT GOLD: 0.00076/.000030 MIN.
 - *SELECT TIN: 0.00254/.000100 MIN.
 - OVERALL NICKEL UNDERPLATE: 0.00127/.000050 MIN.
 - (501) OVERALL GOLD: 0.00051/.000020 MIN.
 - OVERALL NICKEL: 0.00076/.000030 MIN.
 - (503) OVERALL GOLD: 0.00076/.000030 MIN.
 - OVERALL NICKEL: 0.00127/.000050 MIN.
 - THE PRIMARY SHIPPING CARTON WILL BE LABELED *COMPLIANT TO RoHS DIRECTIVE 2002/95/EC AND ELV ANNEX II OF DIRECTIVE 2000/53/EC*. CARTONS WITHOUT THIS LABEL MAY CONTAIN PRODUCT WITH TIN-LEAD PLATING.
 - PRODUCT SPECIFICATION: PS-08-50.
 - PACKAGING INFO: SEE TABLE.
 - SOLDERABILITY: PER SMES-152.
 - PIN PUSH-OUT FORCE: PRIOR TO SOLDERING, 3 LB MIN. FORCE IN EITHER DIRECTION SHALL BE REQUIRED TO PUSH THE PIN OUT OF THE HEADER.
 - PARTS ARE STACKABLE END TO END ON 3.96/.156 CENTERS. (SPACING TABS MUST BE REMOVED ON CIRCUIT SIZES 1-23 BEFORE PARTS ARE STACKABLE.
 - THIS PART CONFORMS TO CLASS B REQUIREMENTS OF COSMETIC SPECIFICATION PS-45499-002.

| CKT | B | A |
|-----|-------|-------------|
| 2 | 3.96 | 6.78/7.87 |
| | .156 | .267/1.310 |
| 3 | 7.92 | 10.74/11.84 |
| | .312 | .423/1.466 |
| 4 | 11.89 | 14.71/15.80 |
| | .468 | .579/1.622 |
| 5 | 15.85 | 18.67/19.76 |
| | .624 | .735/1.778 |
| 6 | 19.81 | 22.63/23.72 |
| | .780 | .891/1.934 |
| 7 | 23.77 | 26.59/27.69 |
| | .936 | 1.047/1.090 |
| 8 | 27.74 | 30.56/31.65 |
| | 1.092 | 1.203/1.246 |
| 9 | 31.70 | 34.52/35.61 |
| | 1.248 | 1.359/1.402 |
| 10 | 35.66 | 38.48/39.57 |
| | 1.404 | 1.515/1.558 |
| 11 | 39.62 | 42.44/43.54 |
| | 1.560 | 1.671/1.714 |
| 12 | 43.59 | 46.41/47.50 |
| | 1.716 | 1.827/1.870 |
| 13 | 47.55 | 50.37/51.46 |
| | 1.872 | 1.983/2.026 |
| 14 | 51.51 | 54.33/55.42 |
| | 2.028 | 2.139/2.182 |
| 15 | 55.47 | 58.29/59.39 |
| | 2.184 | 2.295/2.338 |
| 16 | 59.44 | 62.26/63.35 |
| | 2.340 | 2.451/2.494 |
| 17 | 63.40 | 66.22/67.31 |
| | 2.496 | 2.607/2.650 |
| 18 | 67.36 | 70.18/71.27 |
| | 2.652 | 2.763/2.806 |
| 19 | 71.32 | 74.14/75.23 |
| | 2.808 | 2.919/2.962 |
| 20 | 75.29 | 78.11/79.20 |
| | 2.964 | 3.075/3.118 |
| 21 | 79.25 | 82.07/83.16 |
| | 3.120 | 3.231/3.274 |
| 22 | 83.21 | 86.03/87.12 |
| | 3.276 | 3.387/3.430 |
| 23 | 87.17 | 89.94/91.08 |
| | 3.432 | 3.541/3.586 |
| 24 | 91.14 | 93.85/95.00 |
| | 3.588 | 3.695/3.740 |

| | |
|-----|-----|
| 2-* | AJ |
| 1 | AJ |
| SHT | REV |

| | |
|---------------------|-------------|
| CHANGE PIN | DESCRIPTION |
| EC NO: UCP2009-1378 | |
| DRWN:MKIPPER | 2008/12/08 |
| CHKD:SSOUSEK | 2008/12/08 |
| APPR:FSMITH | 2008/12/08 |
| REV | |
| AJ | |

| QUALITY SYMBOLS | GENERAL TOLERANCES (UNLESS SPECIFIED) |
|-----------------|--|
| ▽=0 | mm INCH |
| ▽=0 | 4 PLACES ± --- ± --- |
| | 3 PLACES ± --- ± .010 |
| | 2 PLACES ± 0.25 ± .015 |
| | 1 PLACE ± 0.38 ± --- |
| | ANGULAR ± 1/2° |
| | DRAFT WHERE APPLICABLE MUST REMAIN WITHIN DIMENSIONS |

| DIMENSION STYLE | SCALE | DESIGN UNITS |
|-----------------|---|---------------------------|
| MM/IN | 1.5:1 | INCH |
| DRAWN BY | DATE | TITLE |
| JSCHAFFER | 2004/04/05 | KK 156 HEADER ASSEMBLY |
| CHECKED BY | DATE | FRICITION LOCK STRAIGHT |
| KSAMIEC | 2004/04/05 | BREAKAWAY |
| APPROVED BY | DATE | MOLEX MOLEX INCORPORATED |
| MARGULIS | 2004/04/05 | DOCUMENT NO. SD-41671-001 |
| MATERIAL NO. | | SHEET NO. 1 OF 8 |
| SIZE | THIS DRAWING CONTAINS INFORMATION THAT IS PROPRIETARY TO MOLEX INCORPORATED AND SHOULD NOT BE USED WITHOUT WRITTEN PERMISSION | |

tb_frame_A_P_AM_T Rev. E 2006/04/15 5 4 3 2 1

| Ckts | Material No | Engineer Number | Material No | Engineer Number | Material No | Engineer Number |
|------|-------------------------|-----------------|-----------------------------|-----------------|-----------------------------|-----------------|
| 2 | 26-48-1025 | A-41671-A02A102 | 41671-0001 | A-41671-C02A208 | 41671-0024 | A-41671-C02A228 |
| 3 | 26-48-1035 | A-41671-A03A102 | 41671-0002 | A-41671-C03A208 | 41671-0025 | A-41671-C03A228 |
| 4 | 26-48-1045 | A-41671-A04A102 | 41671-0003 | A-41671-C04A208 | 41671-0026 | A-41671-C04A228 |
| 5 | 26-48-1055 | A-41671-A05A102 | 41671-0004 | A-41671-C05A208 | 41671-0027 | A-41671-C05A228 |
| 6 | 26-48-1065 | A-41671-A06A102 | 41671-0005 | A-41671-C06A208 | 41671-0028 | A-41671-C06A228 |
| 7 | 26-48-1075 | A-41671-A07A102 | 41671-0006 | A-41671-C07A208 | 41671-0029 | A-41671-C07A228 |
| 8 | 26-48-1085 | A-41671-A08A102 | 41671-0007 | A-41671-C08A208 | 41671-0030 | A-41671-C08A228 |
| 9 | 26-48-1095 | A-41671-A09A102 | 41671-0008 | A-41671-C09A208 | 41671-0031 | A-41671-C09A228 |
| 10 | 26-48-1105 | A-41671-A10A102 | 41671-0009 | A-41671-C10A208 | 41671-0032 | A-41671-C10A228 |
| 11 | 26-48-1115 | A-41671-A11A102 | 41671-0010 | A-41671-C11A208 | 41671-0033 | A-41671-C11A228 |
| 12 | 26-48-1125 | A-41671-A12A102 | 41671-0011 | A-41671-C12A208 | 41671-0034 | A-41671-C12A228 |
| 13 | 26-48-1135 | A-41671-A13A102 | 41671-0012 | A-41671-C13A208 | 41671-0035 | A-41671-C13A228 |
| 14 | 26-48-1145 | A-41671-A14A102 | 41671-0013 | A-41671-C14A208 | 41671-0036 | A-41671-C14A228 |
| 15 | 26-48-1155 | A-41671-A15A102 | 41671-0014 | A-41671-C15A208 | 41671-0037 | A-41671-C15A228 |
| 16 | 26-48-1165 | A-41671-A16A102 | 41671-0015 | A-41671-C16A208 | 41671-0038 | A-41671-C16A228 |
| 17 | 26-48-1175 | A-41671-A17A102 | 41671-0016 | A-41671-C17A208 | 41671-0039 | A-41671-C17A228 |
| 18 | 26-48-1185 | A-41671-A18A102 | 41671-0017 | A-41671-C18A208 | 41671-0040 | A-41671-C18A228 |
| 19 | 26-48-1195 | A-41671-A19A102 | 41671-0018 | A-41671-C19A208 | 41671-0041 | A-41671-C19A228 |
| 20 | 26-48-1205 | A-41671-A20A102 | 41671-0019 | A-41671-C20A208 | 41671-0042 | A-41671-C20A228 |
| 21 | 26-48-1215 | A-41671-A21A102 | 41671-0020 | A-41671-C21A208 | 41671-0043 | A-41671-C21A228 |
| 22 | 26-48-1225 | A-41671-A22A102 | 41671-0021 | A-41671-C22A208 | 41671-0044 | A-41671-C22A228 |
| 23 | 26-48-1235 | A-41671-A23A102 | 41671-0022 | A-41671-C23A208 | 41671-0045 | A-41671-C23A228 |
| 24 | 26-48-1245 | A-41671-A24A102 | 41671-0023 | A-41671-C24A208 | 41671-0046 | A-41671-C24A228 |
| | STD TIN CATALOG PRODUCT | | STD 15 GOLD CATALOG PRODUCT | | STD 30 GOLD CATALOG PRODUCT | |

| | | | |
|--|--|--|--------------------------------------|
| REV: AJ | ECR/ECN INFORMATION: EC. NO. UCP2009-1378 DATE: 12/8/2008 | TITLE: KK .156 HEADER ASSEMBLY FRICITION LOCK STRAIGHT 2-24 CKTS. | SHEET No. - 2 - |
| DOCUMENT NUMBER: SD - 41671 - 001 | CREATED / REVISED BY: MKIPPER | CHECKED BY: SSOUSEK | APPROVED BY: FSMITH |

TEMPLATE FILENAME: PRODUCT_SPEC [SIZE_A](V.1). DOC

| Group No: | A-41671-ANA501 | Group No: | A-41671-ANA503 | Group No: | A-41671-AND102 | Group No: | A-41671-ANB102 | |
|--------------|----------------|-----------------|----------------|-----------------|----------------|-----------------|----------------|-----------------|
| Pin No: | 2161-1 (501) | Pin No: | 2161 - 1(503) | Pin No: | 2161-56 (102) | Pin No: | 2161-1 (102) | |
| Plating: | 501 GOLD | Plating: | 503 GOLD | Plating: | 102 TIN | Plating: | 102 TIN | |
| Pin Length L | .750 / 19.05 | Pin Length L | .750 / 19.05 | Pin Length L | .703 / 17.86 | Pin Length L | .750 / 19.05 | |
| Mating M | .450 / 11.43 | Mating M | .450 / 11.43 | Mating M | .450 / 11.43 | Mating M | .523 / 13.28 | |
| Gold Loc G | OVERALL | Gold Loc G | OVERALL | Gold Loc G | NA | Gold Loc G | NA | |
| PC Tail P | .172 / 4.37 | PC Tail P | .172 / 4.37 | PC Tail P | .125 / 3.18 | PC Tail P | .099 / 2.51 | |
| Tin Loc T | NA | Tin Loc T | NA | Tin Loc T | OVERALL | Tin Loc T | OVERALL | |
| Voided Ckts | NONE | Voided Ckts | NONE | Voided Ckts | NONE | Voided Ckts | NONE | |
| Pack Per | PK-41671-001 | Pack Per | PK-41671-001 | Pack Per | PK-41671-001 | Pack Per | PK-41671-001 | |
| Ckts | Material No | Engineer Number | Material No | Engineer Number | Material No | Engineer Number | Material No | Engineer Number |
| 2 | 26-48-2025 | A-41671-A02A501 | 26-48-9026 | A-41671-A02A503 | 26-48-9023 | A-41671-A02D102 | 41671-0064 | A-41671-A02B102 |
| 3 | 26-48-2035 | A-41671-A03A501 | 41671-0047 | A-41671-A03A503 | 26-48-9033 | A-41671-A03D102 | 41671-0065 | A-41671-A03B102 |
| 4 | 26-48-2045 | A-41671-A04A501 | 41671-0048 | A-41671-A04A503 | 26-48-9043 | A-41671-A04D102 | 41671-0066 | A-41671-A04B102 |
| 5 | 26-48-2055 | A-41671-A05A501 | 26-48-9056 | A-41671-A05A503 | 26-48-9053 | A-41671-A05D102 | 41671-0067 | A-41671-A05B102 |
| 6 | 26-48-2065 | A-41671-A06A501 | 41671-0049 | A-41671-A06A503 | 26-48-9063 | A-41671-A06D102 | 41671-0068 | A-41671-A06B102 |
| 7 | 26-48-2075 | A-41671-A07A501 | 41671-0050 | A-41671-A07A503 | 26-48-9073 | A-41671-A07D102 | 41671-0069 | A-41671-A07B102 |
| 8 | 26-48-2085 | A-41671-A08A501 | 41671-0051 | A-41671-A08A503 | 26-48-9083 | A-41671-A08D102 | 41671-0070 | A-41671-A08B102 |
| 9 | 26-48-2095 | A-41671-A09A501 | 26-48-9096 | A-41671-A09A503 | 26-48-9093 | A-41671-A09D102 | 26-48-6095 | A-41671-A09B102 |
| 10 | 26-48-2105 | A-41671-A10A501 | 26-48-9106 | A-41671-A10A503 | 26-48-9103 | A-41671-A10D102 | 41671-0071 | A-41671-A10B102 |
| 11 | 26-48-2115 | A-41671-A11A501 | 41671-0052 | A-41671-A11A503 | 26-48-9113 | A-41671-A11D102 | 41671-0072 | A-41671-A11B102 |
| 12 | 26-48-2125 | A-41671-A12A501 | 26-48-9126 | A-41671-A12A503 | 26-48-9123 | A-41671-A12D102 | 41671-0073 | A-41671-A12B102 |
| 13 | 26-48-2135 | A-41671-A13A501 | 41671-0053 | A-41671-A13A503 | 26-48-9133 | A-41671-A13D102 | 41671-0074 | A-41671-A13B102 |
| 14 | 26-48-2145 | A-41671-A14A501 | 41671-0054 | A-41671-A14A503 | 26-48-9143 | A-41671-A14D102 | 41671-0075 | A-41671-A14B102 |
| 15 | 26-48-2155 | A-41671-A15A501 | 41671-0055 | A-41671-A15A503 | 26-48-9153 | A-41671-A15D102 | 41671-0076 | A-41671-A15B102 |
| 16 | 26-48-2165 | A-41671-A16A501 | 41671-0056 | A-41671-A16A503 | 26-48-9163 | A-41671-A16D102 | 41671-0077 | A-41671-A16B102 |
| 17 | 26-48-2175 | A-41671-A17A501 | 41671-0057 | A-41671-A17A503 | 26-48-9173 | A-41671-A17D102 | 41671-0078 | A-41671-A17B102 |
| 18 | 26-48-2185 | A-41671-A18A501 | 41671-0058 | A-41671-A18A503 | 26-48-9183 | A-41671-A18D102 | 41671-0079 | A-41671-A18B102 |
| 19 | 26-48-2195 | A-41671-A19A501 | 41671-0059 | A-41671-A19A503 | 26-48-9193 | A-41671-A19D102 | 41671-0080 | A-41671-A19B102 |
| 20 | 26-48-2205 | A-41671-A20A501 | 41671-0060 | A-41671-A20A503 | 26-48-9203 | A-41671-A20D102 | 41671-0081 | A-41671-A20B102 |
| 21 | 26-48-2215 | A-41671-A21A501 | 41671-0061 | A-41671-A21A503 | 26-48-9213 | A-41671-A21D102 | 41671-0082 | A-41671-A21B102 |
| 22 | 26-48-2225 | A-41671-A22A501 | 41671-0062 | A-41671-A22A503 | 26-48-9223 | A-41671-A22D102 | 41671-0083 | A-41671-A22B102 |
| 23 | 26-48-2235 | A-41671-A23A501 | 41671-0063 | A-41671-A23A503 | 26-48-9233 | A-41671-A23D102 | 41671-0084 | A-41671-A23B102 |
| 24 | 26-48-2245 | A-41671-A24A501 | 26-48-9246 | A-41671-A24A503 | 26-48-9243 | A-41671-A24D102 | 26-48-6245 | A-41671-A24B102 |

| | | | |
|--|---|--|-------------------------------|
| REV: AJ | ECR/ECN INFORMATION: EC. NO. UCP2009-1378 DATE: 12/8/2008 | TITLE: KK .156 HEADER ASSEMBLY FRICTION LOCK STRAIGHT 2-24 CKTS. | SHEET No. - 3 - |
| DOCUMENT NUMBER: SD - 41671 - 001 | CREATED / REVISED BY: MKIPPER | CHECKED BY: SSOUSEK | APPROVED BY: FSMITH |
| TEMPLATE FILENAME: PRODUCT_SPEC [SIZE_A](V.1). DOC | | | |

| | | | | | | | | |
|--------------|----------------|-----------------|----------------|-----------------|----------------|-----------------|----------------|-----------------|
| Group No: | A-41671-ANF102 | Group No: | A-41671-ANB501 | Group No: | A-41671-ANF501 | Group No: | A-41671-ANN102 | |
| Pin No: | 2161-24 (102) | Pin No: | 2161-1 (501) | Pin No: | 2161-24 (501) | Pin No: | 2161-19 (102) | |
| Plating: | 102 TIN | Plating: | 501 GOLD | Plating: | 501 GOLD | Plating: | 102 TIN | |
| Pin Length L | .800 / 20.32 | Pin Length L | .750 / 19.05 | Pin Length L | .800 / 20.32 | Pin Length L | 1.032 / 26.21 | |
| Mating M | .480 / 12.19 | Mating M | .523 / 13.28 | Mating M | .480 / 12.19 | Mating M | .450 / 11.43 | |
| Gold Loc G | NA | Gold Loc G | OVERALL | Gold Loc G | OVERALL | Gold Loc G | NA | |
| PC Tail P | .192 / 4.88 | PC Tail P | .099 / 2.51 | PC Tail P | .192 / 4.88 | PC Tail P | .454 / 11.53 | |
| Tin Loc T | OVERALL | Tin Loc T | NA | Tin Loc T | NA | Tin Loc T | OVERALL | |
| Voided Ckts | NONE | Voided Ckts | NONE | Voided Ckts | NONE | Voided Ckts | NONE | |
| Pack Per | PK-41671-001 | Pack Per | PK-41671-001 | Pack Per | PK-41671-001 | Pack Per | PK-41671-001 | |
| Ckts | Material No | Engineer Number | Material No | Engineer Number | Material No | Engineer Number | Material No | Engineer Number |
| 2 | 26-48-4026 | A-41671-A02F102 | 26-48-2027 | A-41671-A02B501 | 41671-0250 | A-41671-A02F501 | | A-41671-A02N102 |
| 3 | 26-48-4036 | A-41671-A03F102 | 26-48-2037 | A-41671-A03B501 | 41671-0350 | A-41671-A03F501 | | A-41671-A03N102 |
| 4 | 26-48-4046 | A-41671-A04F102 | 26-48-2047 | A-41671-A04B501 | 41671-0450 | A-41671-A04F501 | | A-41671-A04N102 |
| 5 | 26-48-4056 | A-41671-A05F102 | 26-48-2057 | A-41671-A05B501 | 41671-0550 | A-41671-A05F501 | | A-41671-A05N102 |
| 6 | 26-48-4066 | A-41671-A06F102 | 26-48-2067 | A-41671-A06B501 | 41671-0650 | A-41671-A06F501 | | A-41671-A06N102 |
| 7 | 26-48-4076 | A-41671-A07F102 | 26-48-2077 | A-41671-A07B501 | 41671-0750 | A-41671-A07F501 | | A-41671-A07N102 |
| 8 | 26-48-4086 | A-41671-A08F102 | 26-48-2087 | A-41671-A08B501 | 41671-0850 | A-41671-A08F501 | | A-41671-A08N102 |
| 9 | 26-48-4096 | A-41671-A09F102 | 26-48-2097 | A-41671-A09B501 | 41671-0950 | A-41671-A09F501 | | A-41671-A09N102 |
| 10 | 26-48-4106 | A-41671-A10F102 | 26-48-2107 | A-41671-A10B501 | 41671-1050 | A-41671-A10F501 | | A-41671-A10N102 |
| 11 | 26-48-4116 | A-41671-A11F102 | 26-48-2117 | A-41671-A11B501 | 41671-1150 | A-41671-A11F501 | | A-41671-A11N102 |
| 12 | 26-48-4126 | A-41671-A12F102 | 26-48-2127 | A-41671-A12B501 | 41671-1250 | A-41671-A12F501 | | A-41671-A12N102 |
| 13 | 26-48-4136 | A-41671-A13F102 | 26-48-2137 | A-41671-A13B501 | 41671-1350 | A-41671-A13F501 | | A-41671-A13N102 |
| 14 | 26-48-4146 | A-41671-A14F102 | 26-48-2147 | A-41671-A14B501 | 41671-1450 | A-41671-A14F501 | | A-41671-A14N102 |
| 15 | 26-48-4156 | A-41671-A15F102 | 26-48-2157 | A-41671-A15B501 | 41671-1550 | A-41671-A15F501 | | A-41671-A15N102 |
| 16 | 26-48-4166 | A-41671-A16F102 | 26-48-2167 | A-41671-A16B501 | 41671-1650 | A-41671-A16F501 | | A-41671-A16N102 |
| 17 | 26-48-4176 | A-41671-A17F102 | 26-48-2177 | A-41671-A17B501 | 41671-1750 | A-41671-A17F501 | | A-41671-A17N102 |
| 18 | 26-48-4186 | A-41671-A18F102 | 26-48-2187 | A-41671-A18B501 | 41671-1850 | A-41671-A18F501 | | A-41671-A18N102 |
| 19 | 26-48-4196 | A-41671-A19F102 | 26-48-2197 | A-41671-A19B501 | 41671-1950 | A-41671-A19F501 | | A-41671-A19N102 |
| 20 | 26-48-4206 | A-41671-A20F102 | 26-48-2207 | A-41671-A20B501 | 41671-2050 | A-41671-A20F501 | | A-41671-A20N102 |
| 21 | 26-48-4216 | A-41671-A21F102 | 26-48-2217 | A-41671-A21B501 | 41671-2150 | A-41671-A21F501 | | A-41671-A21N102 |
| 22 | 26-48-4226 | A-41671-A22F102 | 26-48-2227 | A-41671-A22B501 | 41671-2250 | A-41671-A22F501 | | A-41671-A22N102 |
| 23 | 26-48-4236 | A-41671-A23F102 | 26-48-2237 | A-41671-A23B501 | 41671-2350 | A-41671-A23F501 | | A-41671-A23N102 |
| 24 | 26-48-4246 | A-41671-A24F102 | 26-48-2247 | A-41671-A24B501 | 41671-2450 | A-41671-A24F501 | 26-48-8247 | A-41671-A24N102 |

| | | | |
|---|---|--|-------------------------------|
| REV: AJ | ECR/ECN INFORMATION: EC. NO. UCP2009-1378 DATE: 12/8/2008 | TITLE: KK .156 HEADER ASSEMBLY FRICTION LOCK STRAIGHT 2-24 CKTS. | SHEET No. - 4 - |
| DOCUMENT NUMBER: SD - 41671 - 001 | CREATED / REVISED BY: MKIPPER | CHECKED BY: SSOUSEK | APPROVED BY: FSMITH |
| <small>TEMPLATE FILENAME: PRODUCT_SPEC [SIZE_A](V.1). DOC</small> | | | |

| Group No: | A-41671-CNP228 | Group No: | A-41671-CNR208 | Group No: | A-41671-ANT102 | Group No: | A-41671-ANA122 | |
|--------------|----------------|-----------------|----------------|-----------------|----------------|-----------------|----------------|-----------------|
| Pin No: | 43294-0282 | Pin No: | 43294-0344 | Pin No: | 2161-37 (102) | Pin No: | 2161-1 (122) | |
| Plating: | 228 30 GOLD | Plating: | 208 15 GOLD | Plating: | 102 TIN | Plating: | 122 TIN | |
| Pin Length L | .800 / 20.32 | Pin Length L | .870 / 22.10 | Pin Length L | 1.100 / 27.94 | Pin Length L | .750 / 19.05 | |
| Mating M | .523 / 13.28 | Mating M | .450 / 11.43 | Mating M | .486 / 12.34 | Mating M | .450 / 11.43 | |
| Gold Loc G | .350 / 8.89 | Gold Loc G | .400 / 10.16 | Gold Loc G | NA | Gold Loc G | NA | |
| PC Tail P | .149 / 3.78 | PC Tail P | .292 / 7.42 | PC Tail P | .486 / 12.34 | PC Tail P | .172 / 4.37 | |
| Tin Loc T | .200 / 5.08 | Tin Loc T | .200 / 5.08 | Tin Loc T | OVERALL | Tin Loc T | OVERALL | |
| Voided Ckts | NONE | Voided Ckts | NONE | Voided Ckts | NONE | Voided Ckts | NONE | |
| Pack Per | PK-41671-001 | Pack Per | PK-41671-001 | Pack Per | PK-41671-001 | Pack Per | PK-41671-001 | |
| Ckts | Material No | Engineer Number | Material No | Engineer Number | Material No | Engineer Number | Material No | Engineer Number |
| 2 | 41671-2451 | A-41671-C02P228 | 41671-2474 | A-41671-C02R208 | 41671-3400 | A-41671-A02T102 | 41671-3423 | A-41671-A02A122 |
| 3 | 41671-2452 | A-41671-C03P228 | 41671-2475 | A-41671-C03R208 | 41671-3401 | A-41671-A03T102 | 41671-3424 | A-41671-A03A122 |
| 4 | 41671-2453 | A-41671-C04P228 | 41671-2476 | A-41671-C04R208 | 41671-3402 | A-41671-A04T102 | 41671-3425 | A-41671-A04A122 |
| 5 | 41671-2454 | A-41671-C05P228 | 41671-2477 | A-41671-C05R208 | 41671-3403 | A-41671-A05T102 | 41671-3426 | A-41671-A05A122 |
| 6 | 41671-2455 | A-41671-C06P228 | 41671-2478 | A-41671-C06R208 | 41671-3404 | A-41671-A06T102 | 41671-3427 | A-41671-A06A122 |
| 7 | 41671-2456 | A-41671-C07P228 | 41671-2479 | A-41671-C07R208 | 41671-3405 | A-41671-A07T102 | 41671-3428 | A-41671-A07A122 |
| 8 | 41671-2457 | A-41671-C08P228 | 41671-2480 | A-41671-C08R208 | 41671-3406 | A-41671-A08T102 | 41671-3429 | A-41671-A08A122 |
| 9 | 41671-2458 | A-41671-C09P228 | 41671-2481 | A-41671-C09R208 | 41671-3407 | A-41671-A09T102 | 41671-3430 | A-41671-A09A122 |
| 10 | 41671-2459 | A-41671-C10P228 | 41671-2482 | A-41671-C10R208 | 41671-3408 | A-41671-A10T102 | 41671-3431 | A-41671-A10A122 |
| 11 | 41671-2460 | A-41671-C11P228 | 41671-2483 | A-41671-C11R208 | 41671-3409 | A-41671-A11T102 | 41671-3432 | A-41671-A11A122 |
| 12 | 41671-2461 | A-41671-C12P228 | 41671-2484 | A-41671-C12R208 | 41671-3410 | A-41671-A12T102 | 41671-3433 | A-41671-A12A122 |
| 13 | 41671-2462 | A-41671-C13P228 | 41671-2485 | A-41671-C13R208 | 41671-3411 | A-41671-A13T102 | 41671-3434 | A-41671-A13A122 |
| 14 | 41671-2463 | A-41671-C14P228 | 41671-2486 | A-41671-C14R208 | 41671-3412 | A-41671-A14T102 | 41671-3435 | A-41671-A14A122 |
| 15 | 41671-2464 | A-41671-C15P228 | 41671-2487 | A-41671-C15R208 | 41671-3413 | A-41671-A15T102 | 41671-3436 | A-41671-A15A122 |
| 16 | 41671-2465 | A-41671-C16P228 | 41671-2488 | A-41671-C16R208 | 41671-3414 | A-41671-A16T102 | 41671-3437 | A-41671-A16A122 |
| 17 | 41671-2466 | A-41671-C17P228 | 41671-2489 | A-41671-C17R208 | 41671-3415 | A-41671-A17T102 | 41671-3438 | A-41671-A17A122 |
| 18 | 41671-2467 | A-41671-C18P228 | 41671-2490 | A-41671-C18R208 | 41671-3416 | A-41671-A18T102 | 41671-3439 | A-41671-A18A122 |
| 19 | 41671-2468 | A-41671-C19P228 | 41671-2491 | A-41671-C19R208 | 41671-3417 | A-41671-A19T102 | 41671-3440 | A-41671-A19A122 |
| 20 | 41671-2469 | A-41671-C20P228 | 41671-2492 | A-41671-C20R208 | 41671-3418 | A-41671-A20T102 | 41671-3441 | A-41671-A20A122 |
| 21 | 41671-2470 | A-41671-C21P228 | 41671-2493 | A-41671-C21R208 | 41671-3419 | A-41671-A21T102 | 41671-3442 | A-41671-A21A122 |
| 22 | 41671-2471 | A-41671-C22P228 | 41671-2494 | A-41671-C22R208 | 41671-3420 | A-41671-A22T102 | 41671-3443 | A-41671-A22A122 |
| 23 | 41671-2472 | A-41671-C23P228 | 41671-2495 | A-41671-C23R208 | 41671-3421 | A-41671-A23T102 | 41671-3444 | A-41671-A23A122 |
| 24 | 41671-2473 | A-41671-C24P228 | 41671-2496 | A-41671-C24R208 | 41671-3422 | A-41671-A24T102 | 41671-3445 | A-41671-A24A122 |

| | | | |
|---|--|---|--------------------------------------|
| <u>REV:</u> AJ | <u>ECR/ECN INFORMATION:</u> EC. NO. UCP2009-1378 DATE: 12/8/2008 | <u>TITLE:</u> KK .156 HEADER ASSEMBLY FRICTION LOCK STRAIGHT 2-24 CKTS. | <u>SHEET No.</u> - 5 - |
| <u>DOCUMENT NUMBER:</u> SD - 41671 - 001 | <u>CREATED / REVISED BY:</u> MKIPPER | <u>CHECKED BY:</u> SSOUSEK | <u>APPROVED BY:</u> FSMITH |
| <small>TEMPLATE FILENAME: PRODUCT_SPEC [SIZE_A](V.1). DOC</small> | | | |

| | | | | | | | | |
|--------------|--------------------------------|-----------|--------------|--------------------------------|-----------|--------------|--------------------------------|------------------------|
| Group No: | A-41671-ANA102-* REF SEE SHT 1 | | Group No: | A-41671-ANA102-* REF SEE SHT 1 | | Group No: | A-41671-ANA102-* REF SEE SHT 1 | |
| Pin No: | | | Pin No: | | | Pin No: | | |
| Plating: | | | Plating: | | | Plating: | | |
| Pin Length L | | | Pin Length L | | | Pin Length L | | |
| Mating M | | | Mating M | | | Mating M | | |
| Gold Loc G | | | Gold Loc G | | | Gold Loc G | | |
| PC Tail P | | | PC Tail P | | | PC Tail P | | |
| Tin Loc T | | | Tin Loc T | | | Tin Loc T | | |
| Voided Ckts | SEE CHART BELOW | | Voided Ckts | SEE CHART BELOW | | Voided Ckts | SEE CHART BELOW | |
| Pack Per | | | Pack Per | | | Pack Per | | |
| Material No | Engineer Number | Void Ckts | Material No | Engineer Number | Void Ckts | Material No | Engineer Number | Void Ckts |
| 26-50-3030 | A-41671-A03A102-2 | 2 | 26-50-3073 | A-41671-A07A102-3 | 3 | 26-50-3202 | A-41671-A20A102-51 | 2,4,6,8 10,12,14,16 |
| 26-50-3040 | A-41671-A04A102-2 | 2 | 26-50-5080 | A-41671-A08A102-51 | 2,4 | 26-50-3167 | A-41671-A16A102-53 | 2,4,6,8 |
| 26-50-3050 | A-41671-A05A102-2 | 2 | 26-50-3063 | A-41671-A06A102-3 | 3 | 26-50-3152 | A-41671-A15A102-52 | 4,6,8,10,12,14 |
| 26-50-3060 | A-41671-A06A102-2 | 2 | 26-50-3071 | A-41671-A07A102-52 | 2,4,6 | 26-50-3126 | A-41671-A12A102-53 | 2,3,5,6,8,10 |
| 26-50-3070 | A-41671-A07A102-2 | 2 | 26-50-3051 | A-41671-A05A102-51 | 2,4 | 26-50-3240 | A-41671-A24A102-2 | 2 |
| 26-50-3080 | A-41671-A08A102-2 | 2 | 26-50-3062 | A-41671-A06A102-4 | 4 | 26-50-5090 | A-41671-A10A102-55 | 2,5 |
| 26-50-3090 | A-41671-A09A102-2 | 2 | 26-50-3068 | A-41671-A06A102-6 | 6 | 41671-3100 | A-41671-A05A102-3 | 3 |
| 26-50-3100 | A-41671-A10A102-2 | 2 | 26-50-3111 | A-41671-A11A102-51 | 5,10 | 41671-3112 | A-41671-A14A102-12 | 12 |
| 26-50-3110 | A-41671-A11A102-2 | 2 | 26-50-3065 | A-41671-A06A102-5 | 5 | 41671-3113 | A-41671-A14A102-51 | 11, 12 |
| 26-50-3120 | A-41671-A12A102-2 | 2 | 26-50-3054 | A-41671-A05A102-4 | 4 | 41671-3446 | A-41671-A06A102-55 | 1, 3, 5 |
| 26-50-3130 | A-41671-A13A102-2 | 2 | 26-50-3154 | A-41671-A15A102-4 | 4 | | | |
| 26-50-3140 | A-41671-A14A102-2 | 2 | 26-50-3145 | A-41671-A14A102-55 | 2,4,8,12 | | | |
| 26-50-3150 | A-41671-A15A102-2 | 2 | 26-50-3155 | A-41671-A15A102-54 | 3,10,13 | | | |
| 26-50-3160 | A-41671-A16A102-2 | 2 | 26-50-3066 | A-41671-A6A102-54 | 2,4 | | | |
| 26-50-3170 | A-41671-A17A102-2 | 2 | 26-50-3108 | A-41671-A10A102-53 | 3,10 | | | |
| 26-50-3180 | A-41671-A18A102-2 | 2 | 26-50-3103 | A-41671-A10A102-7 | 7 | | | |
| 26-50-3190 | A-41671-A19A102-2 | 2 | 26-50-3087 | A-41671-A8A102-52 | 5,7 | | | |
| 26-50-3200 | A-41671-A20A102-2 | 2 | 26-50-5081 | A-41671-A08A102-6 | 6 | | | |
| 26-50-3210 | A-41671-A21A102-2 | 2 | 26-50-3132 | A-41671-A13A102-5 | 5 | | | |
| 26-50-3220 | A-41671-A22A102-2 | 2 | 26-50-3165 | A-41671-A16A102-52 | 2,15 | | | |
| 26-50-3230 | A-41671-A23A102-2 | 2 | 41671-0085 | A-41671-A10A102-56 | 5,8 | | | |

| | | | |
|---|---|--|-------------------------------|
| REV: AJ | ECR/ECN INFORMATION: EC. NO. UCP2009-1378 DATE: 12/8/2008 | TITLE: KK .156 HEADER ASSEMBLY FRICTION LOCK STRAIGHT 2-24 CKTS. | SHEET No. - 6 - |
| DOCUMENT NUMBER: SD - 41671 - 001 | CREATED / REVISED BY: MKIPPER | CHECKED BY: SSOUSEK | APPROVED BY: FSMITH |

TEMPLATE FILENAME: PRODUCT_SPEC [SIZE_A](V.1). DOC

