

Recommended P.C.B Layout (Top Side)
(PCB BOARD TOLERANCE±0.05)

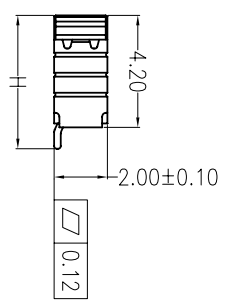
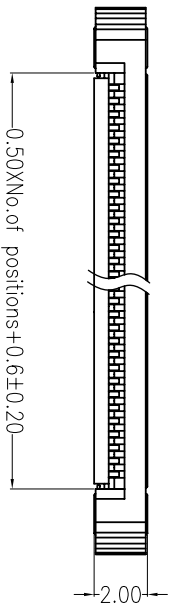
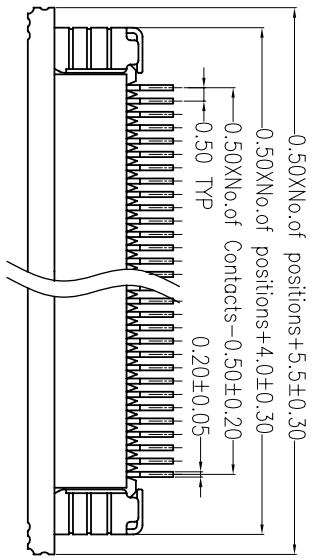
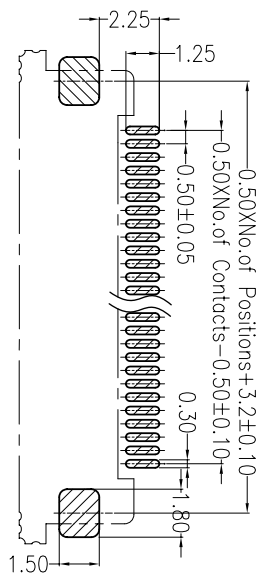

Dimensional & Ordering Information:

Circuit	Part No.	Dimension H
24	SEA8056-24	5.20
28	SEA8056-28	5.20
29	SEA8056-29	5.20
36	SEA8056-36	5.70
45	SEA8058-45	5.70

seacom **LCD'S** TFT, RGB & MONOCHROME

TITLE: 0.5mm FPC 90° SMT Down contact with lock

SEAComp - Displaytech Ltd Americas
5651 Palmer Way, Suite B - Corisbad, CA - 92010 - USA
WWW.displaytech-us.com
sales@displaytech-us.com

NOTES:

- Current Rating: 0.5AMP
- Contact Resistance: 30mΩ max
- Withstand Voltage: 500V AC/DC
- Insulation Resistance: 500MΩ min
- Operation Temperature: -40°C to +85°C

- Contact Material: Phosphor Bronze
- Contact plating: Au or Sn Over Ni
- Barth-Plate Material: Brass
- Barth-plate plating: Sn all over Ni
- Insulator Material: Polyester (UL94V-0)
- Standard: Housing LCP+30%G, F
- Slider PPS+30%G, F

REV	DATE	MODIFICATION DESCRIPTION	CHANGE	APPROVE	OPERATION	DRAW	SCALE
A0	09/01/09	NEW			X.X X.XX X.XXX XXXX	DESIGN CHECK	3:1 mm A4 SHEET 1/1 PROJ.
1					±0.40 ±0.25 ±0.15 Angle ±.3° TOL	CHECK APPROVE	